

| SCHEDULE OF QUANTITIES (SHEET 8)                         |       |      |
|--|-------|------|
| ITEM DESCRIPTION   | UNIT  | QTY. |
| REMOVE EXISTING CONCRETE FOUNDATION                      | EACH  | 1.0  |
| UNDERGROUND CONDUIT, PVC, 90MM DIA.                      | METER | 4.5  |
| ELECTRIC CABLE IN CONDUIT, 600V (XLP-TYPE USE) 1/C NO. 2 | METER | 24.3 |
| ELECTRIC CABLE IN CONDUIT, 600V (XLP-TYPE USE) 1/C NO. 4 | METER | 8.1  |
| LIGHT TOWER FOUNDATION                                   | METER | 9.4  |
| JUNCTION BOX (SPECIAL)                                   | EACH  | 1.0  |
| LIGHT TOWER, INSTALL ONLY                                | EACH  | 1.0  |

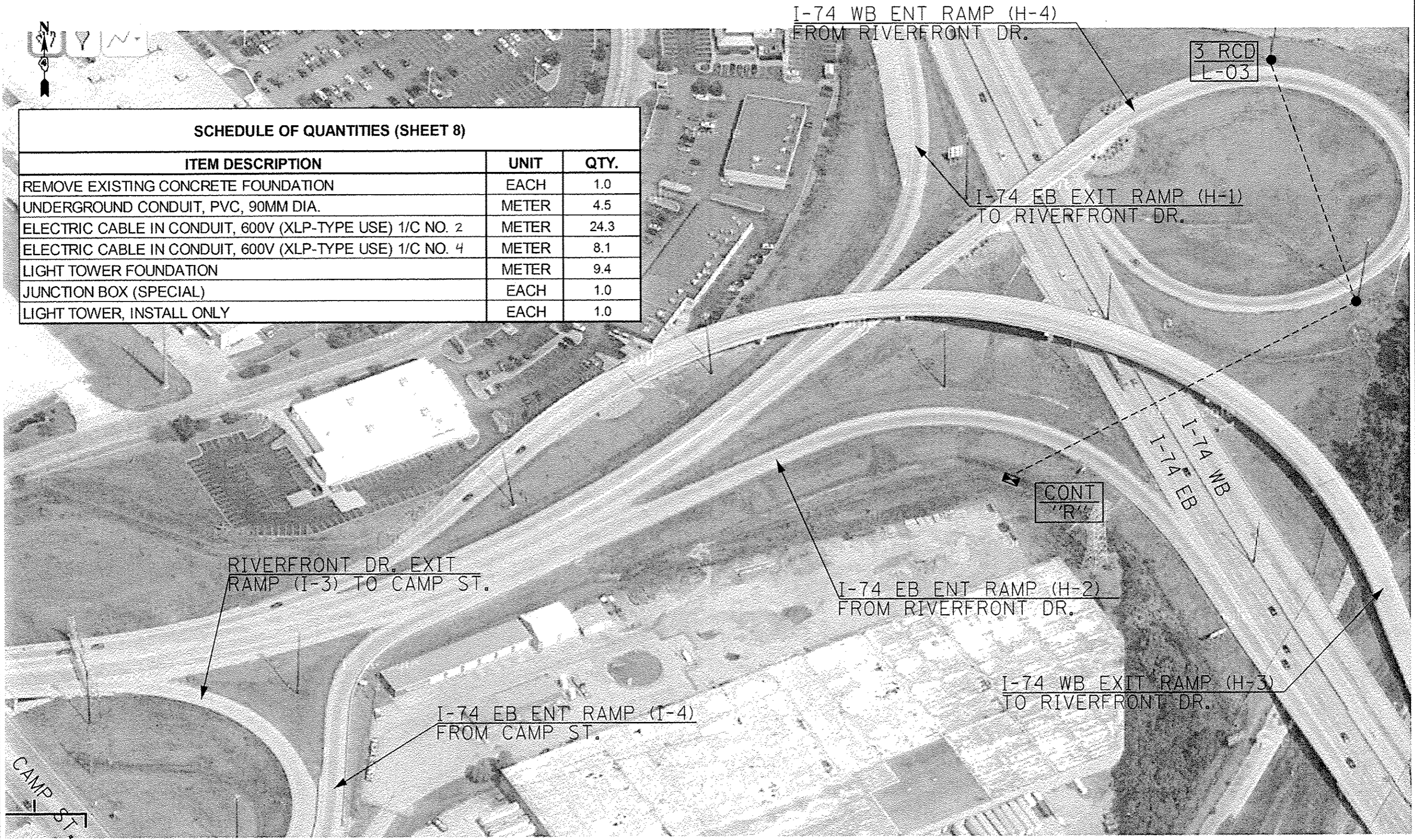

REVISED

|   |                               |                  |                 |   |   |                        |                                 |                           |                                |  |
|---|-------------------------------|------------------|-----------------|---|---|------------------------|---------------------------------|---------------------------|--------------------------------|--|
| FILE NAME = 68888 - High Mast Lighting Repair - (Final) | USER NAME = aubraygg          | DESIGNED - _____ | REVISED - _____ | <b>STATE OF ILLINOIS<br/>DEPARTMENT OF TRANSPORTATION</b> | <b>LIGHT TOWER FOUNDATION REPLACEMENT<br/>I-74 WB ENTRANCE RAMP H-4 (FROM RIVERFRONT DRIVE)</b> | FAI/FAP<br>RTE. 74/150 | SECTION T2(17,911-4;8-1-6);10-1 | COUNTY PEORIA-TAZEWELL    | TOTAL SHEET<br>SHEETS NO. 11 8 |  |
|   | PLOT SCALE = 1/4" = 10' / in. | CHECKED - _____  | REVISED - _____ |   |   | SCALE: _____           | STA. _____ TO STA. _____        | ILLINOIS FED. AID PROJECT |                                |  |
|   | PLOT DATE = 4/18/2014         | DATE - _____     | REVISED - _____ |   |   |                        |                                 |                           |                                |  |
|   |                               |                  |                 |   |   |                        |                                 |                           |                                |  |