

LOCATION NO. 12  
FAP 326 (IL 47)

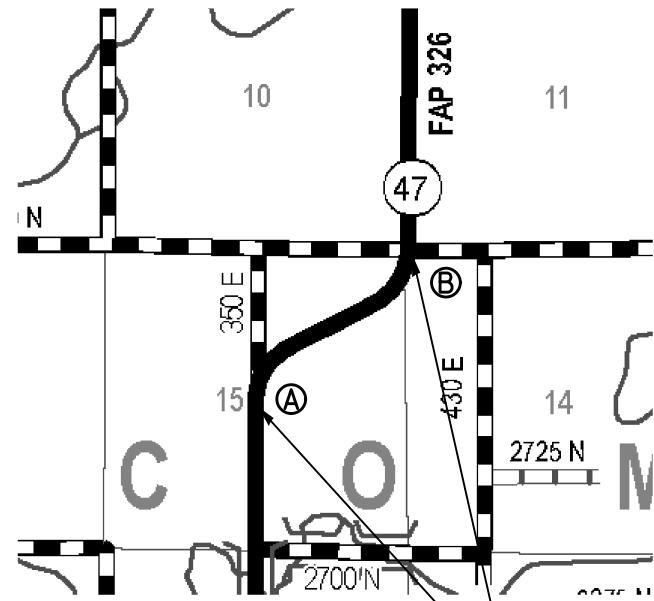

LIMITS OF IMPROVEMENT  
JURISDICTION: STATE

LOCATION NO. 13  
FAI 74 (PRAIRIEVIEW RD TO I 74 EB RAMP)

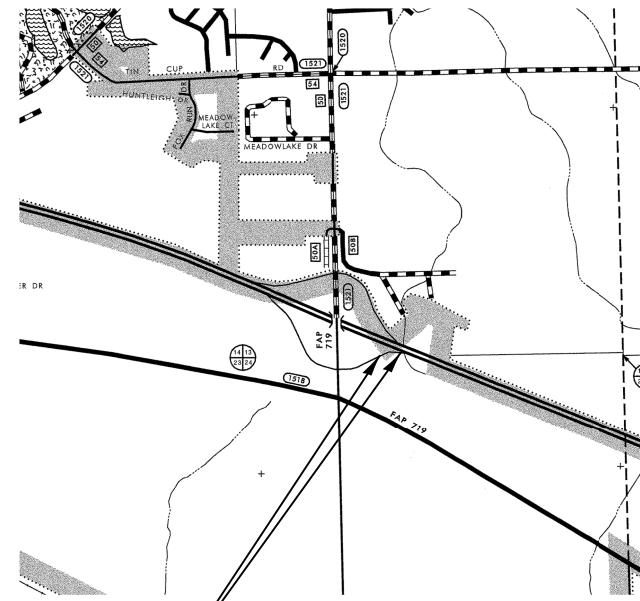

LIMITS OF IMPROVEMENT  
JURISDICTION: STATE

LOCATION NO. 14  
FAI 57 (I 72 EB TO I 57 SB RAMP)

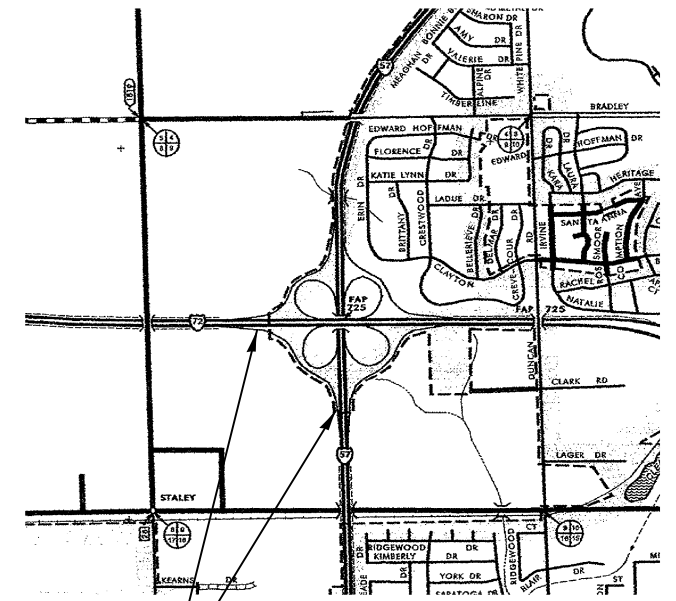

LIMITS OF IMPROVEMENT  
JURISDICTION: STATE

LOCATION NO. 15  
FAI 57 (I 72 WB TO I 57 NB RAMP)

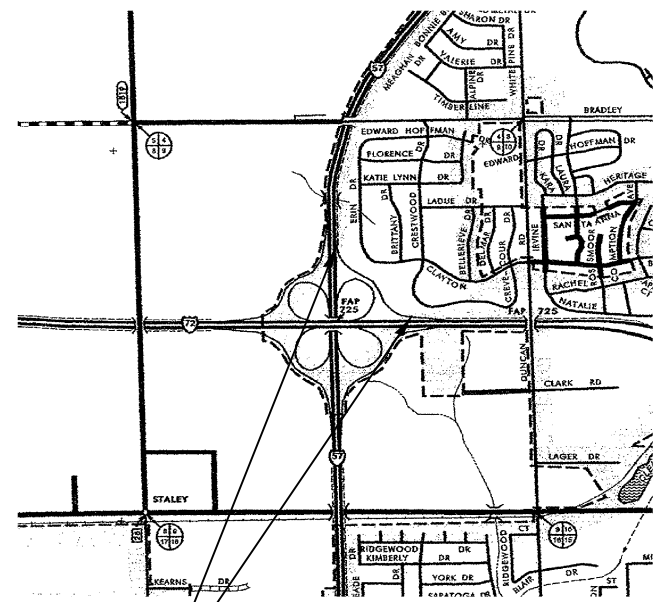

LIMITS OF IMPROVEMENT  
JURISDICTION: STATE

LOCATION NO. 16  
FAU 7185 (PHILO RD)



LIMITS OF IMPROVEMENT  
JURISDICTION: CITY

LOCATION NO. 17  
TR 80 (CR 600E)

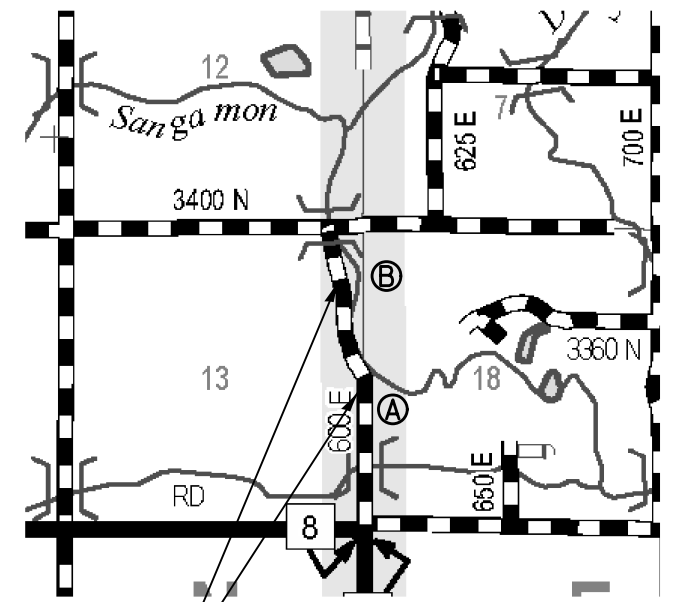

LIMITS OF IMPROVEMENT  
JURISDICTION: TOWNSHIP

FILE NAME =	USER NAME = ceerlockjd	DESIGNED -	REVISED -
ei:\pw\work\p\idot\ceerlockjd\0382855\0570A62-sht-Location_Maps.dgn		DRAWN -	REVISED -
\$MODELNAME\$	PLOT SCALE = 48.0000' / in.	CHECKED -	REVISED -
	PLOT DATE = 3/20/2014	DATE -	REVISED -

STATE OF ILLINOIS  
DEPARTMENT OF TRANSPORTATION

CHAMPAIGN COUNTY LOCATION MAP

SCALE: SHEET 2 OF 3 SHEETS STA. TO STA.

F.A. RTE.	SECTION	COUNTY	TOTAL SHEETS	SHEET NO.
VAR.	•	VARIOUS	22	9
• D5 CURVE SIGNING 2014-1			CONTRACT NO. 70A62	
ILLINOIS FED. AID PROJECT				