

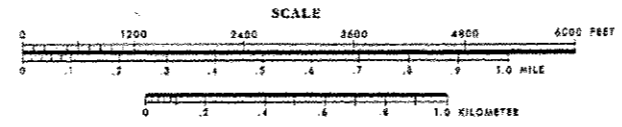

LOCATION MAP #2 MATTIS AVENUE CHAMPAIGN COUNTY

CURRENT TRAFFIC DATA 2013
FAP 811 (MATTIS AVE.) ADT = 21,400

DESIGN DESIGNATION
N/A

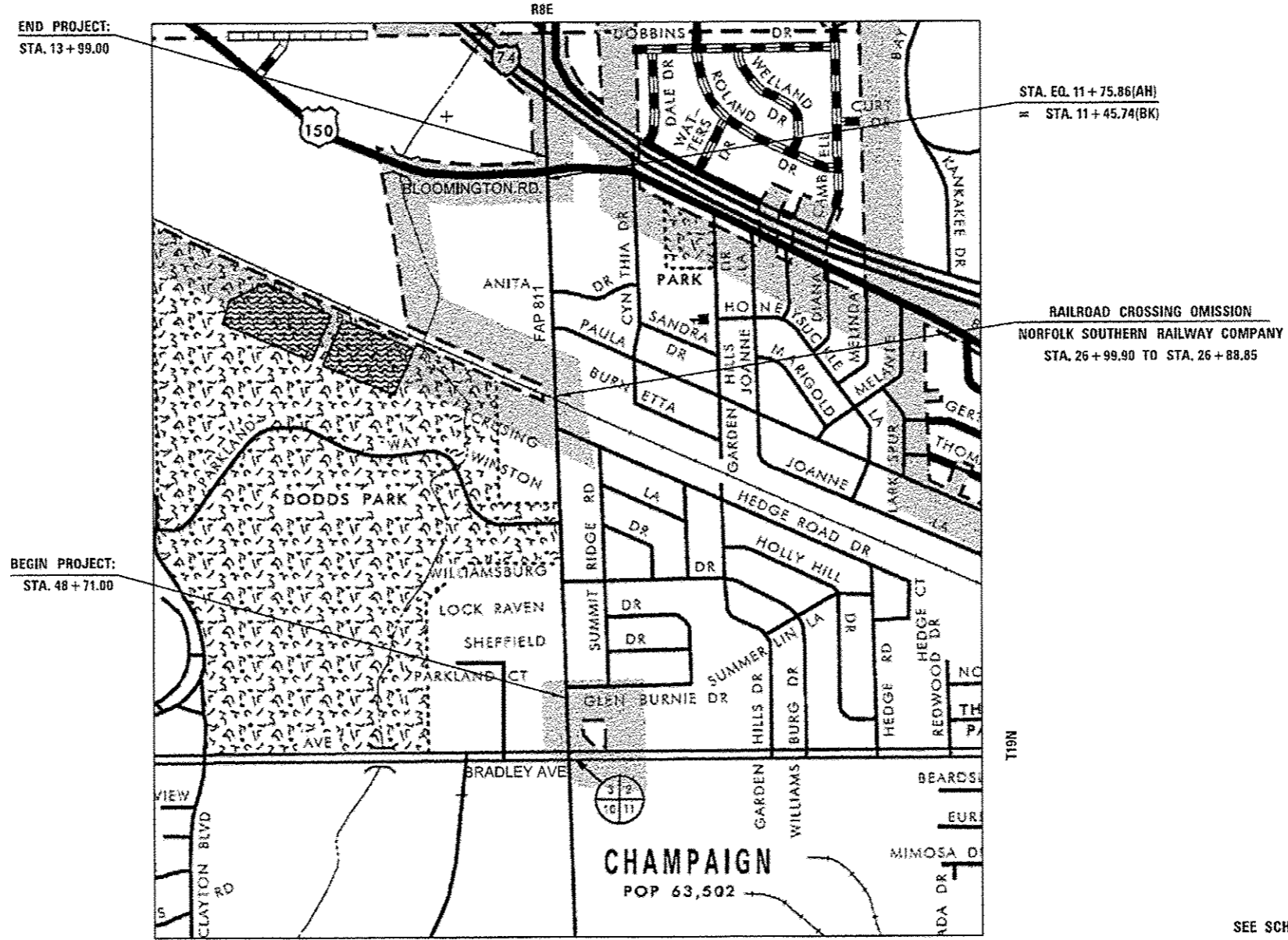

TOTAL LENGTH OF SECTION & PROJECT = 3948.40 FEET = 0.748 MILES
NET LENGTH OF SECTION & PROJECT = 3937.35 FEET = 0.746 MILES

SEE SCHEDULES FOR LOCATIONS OF IMPROVEMENTS

FILE NAME =	USER NAME = avuglob	DESIGNED -	REVISED -	STATE OF ILLINOIS DEPARTMENT OF TRANSPORTATION	LOCATION MAP #2 MATTIS AVENUE	F.A.P. RTE.	SECTION	COUNTY	TOTAL SHEETS	SHEET NO.
et:\work\p1\dot\avuglob\0205126\052070-shr-cover\spring const. fundal.dgn	DRAWN -	REVISED -	811			D5 PATCH & RES 2014-2	CHAMPAIGN	45	6	
PLOT SCALE = 40,0000 1/4 in.	CHECKED -	REVISED -	CONTRACT NO. 70A70							
PLOT DATE = 4/2/2014	DATE -	REVISED -	ILLINOIS FED. AID PROJECT							