

STATE OF ILLINOIS  
DEPARTMENT OF TRANSPORTATION  
DIVISION OF HIGHWAYS

**PROPOSED  
HIGHWAY PLANS**

**FAI ROUTE 57 (1-57)  
SECTION 61-(1,2)RS-4  
MILLING AND RESURFACING  
MARION COUNTY**

F.A.I. RTE.	SECTION	COUNTY	TOTAL SHEETS	SHEET NO.
57	61-(1,2)RS-4	MARION	5	1
				ILLINOIS 76G92

FOR INDEX OF SHEETS, SEE SHEET NO. 2

BRIDGE OMISSIONS

SN.	STA.	TO STA.	RT (NB)/LT(SB)	FEATURE CROSSED
061-0047	1765+71.22	1767+78.20	RT	CROOKED CREEK

TRAFFIC DATA

LOCATION	STA. 1373+06	STA. 1873+88
2013 ADT (CURRENT)	16900 (ACTUAL)	17400 (ACTUAL)
2014 ADT	17100 (ESTIMATED)	17600 (ESTIMATED)
2034 ADT	20900 (ESTIMATED)	21500 (ESTIMATED)
MU%:	33.7	33.9
SU%:	3.0	3.2

D-98-018-14

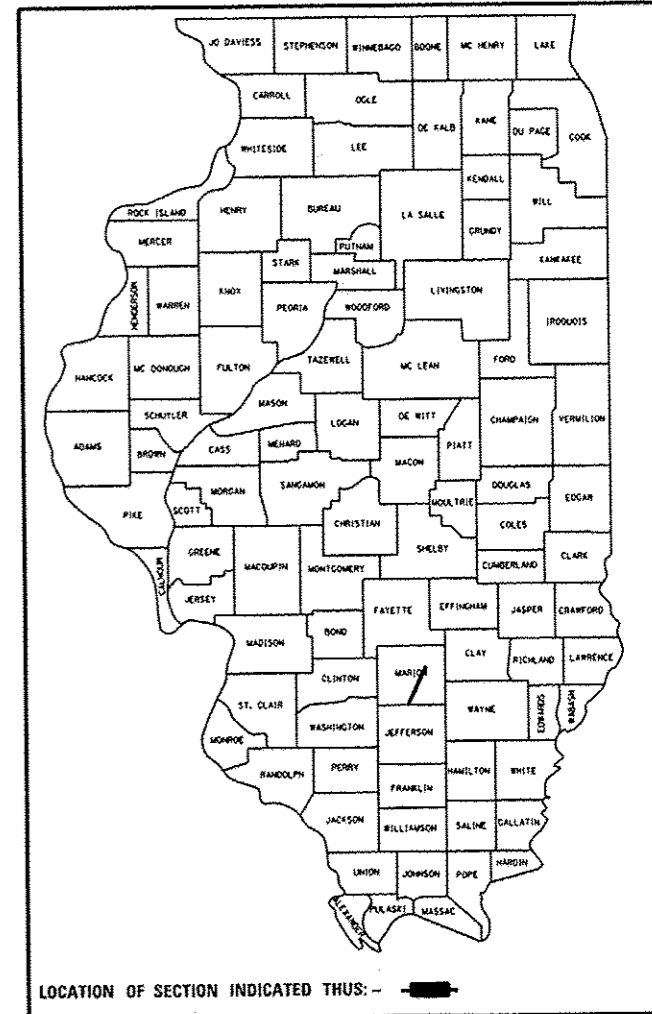

C-98-018-14

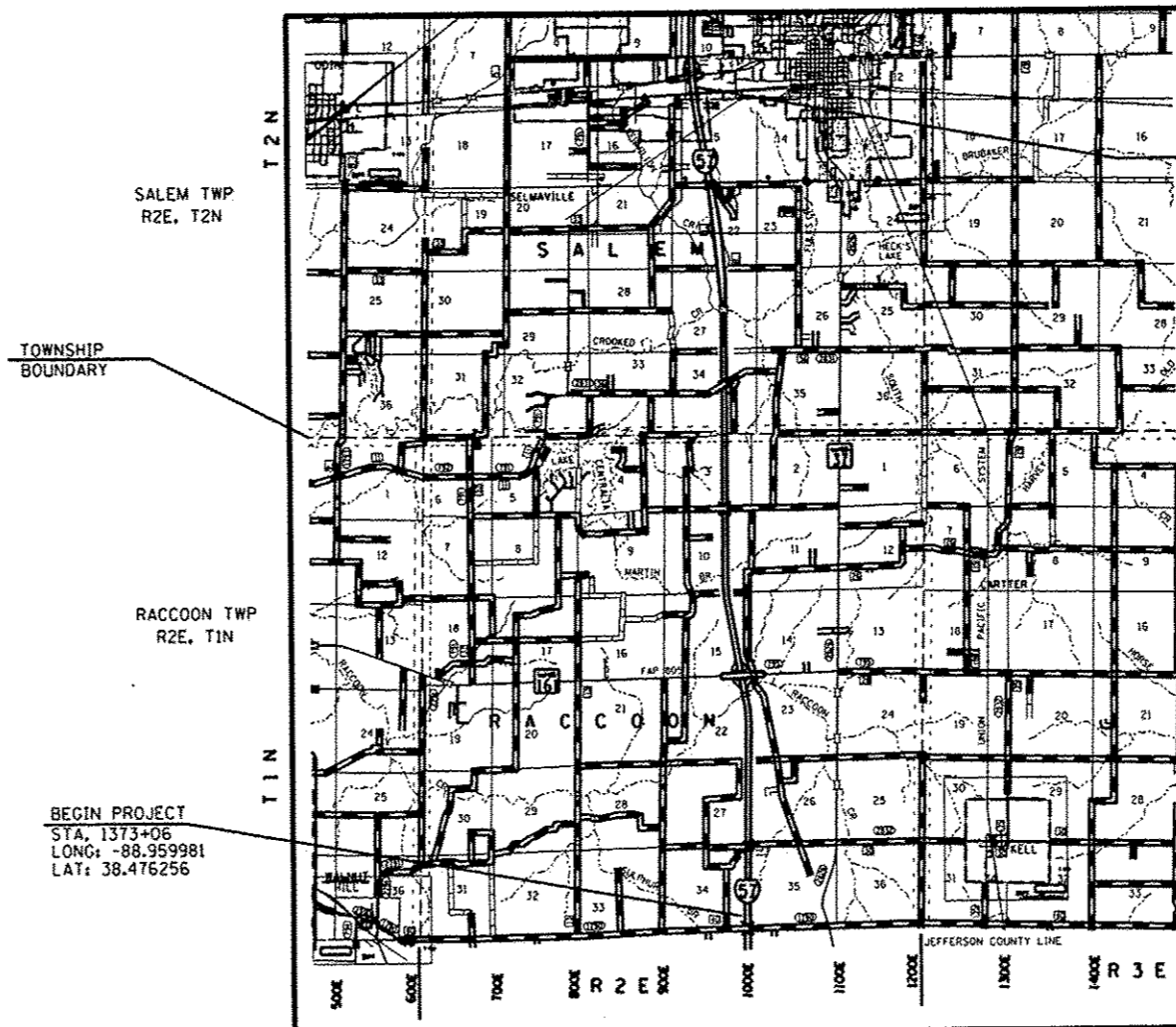

END PROJECT  
STA. 1873+88  
LONG: -88.970801  
LAT: 38.613511

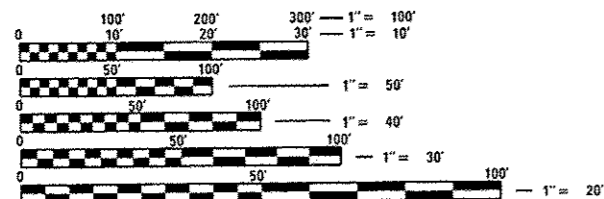

FULL SIZE PLANS HAVE BEEN PREPARED USING STANDARD ENGINEERING SCALES. REDUCED SIZED PLANS WILL NOT CONFORM TO STANDARD SCALES. IN MAKING MEASUREMENTS ON REDUCED PLANS, THE ABOVE SCALES MAY BE USED.

J.U.L.I.E.  
JOINT UTILITY LOCATION INFORMATION FOR EXCAVATION  
1-800-892-0123  
OR 811

BEGIN PROJECT  
STA. 1373+06  
LONG: -88.959981  
LAT: 38.476256

PROJECT ENGINEER: MIKE PRITCHETT (618)346-3180  
PROJECT DESIGNER: DIANA MURRAY (618)346-3454

CONTRACT NO. 76G92

NOT TO SCALE  
GROSS LENGTH = 50,082 FT. = 9.5 MILE  
NET LENGTH = 49,875 FT. = 9.4 MILE

STATE OF ILLINOIS  
DEPARTMENT OF TRANSPORTATION  
DIVISION OF HIGHWAYS

SUBMITTED *Mar 19 20 14*  
*Jefferson K. ...*  
DEPUTY DIRECTOR OF HIGHWAYS, REGION 5 ENGINEER

*Mar 9 20 14*  
*John D. Baranzelli, P.E.*  
ENGINEER OF DESIGN AND ENVIRONMENT

*Mar 9 20 14*  
*Omair Osman, P.E.*  
DIRECTOR OF HIGHWAYS, CHIEF ENGINEER

**PRINTED BY THE AUTHORITY  
OF THE STATE OF ILLINOIS**