

06-13-14 LETTING ITEM 258

STATE OF ILLINOIS  
DEPARTMENT OF TRANSPORTATION  
DIVISION OF HIGHWAYS

**PROPOSED  
HIGHWAY PLANS**

**FAI ROUTE 57 (1-57)  
SECTION 61-(1,2)RS-4  
MILLING AND RESURFACING  
MARION COUNTY**

F.A.I. RTE.	SECTION	COUNTY	TOTAL SHEETS	SHEET NO.
57	61-(1,2)RS-4	MARION	5	1
				76G92

FOR INDEX OF SHEETS, SEE SHEET NO. 2

BRIDGE OMISSIONS

SN.	STA.	TO	STA.	RT (NB)/LT(SB)	FEATURE CROSSED
061-0047	1765+71.22		1767+78.20	RT	CROOKED CREEK

TRAFFIC DATA

LOCATION	STA. 1373+06	STA. 1873+88
2013 ADT (CURRENT)	16900 (ACTUAL)	17400 (ACTUAL)
2014 ADT	17100 (ESTIMATED)	17600 (ESTIMATED)
2034 ADT	20900 (ESTIMATED)	21500 (ESTIMATED)
MU%:	33.7	33.9
SU%:	3.0	3.2

D-98-018-14



C-98-018-14

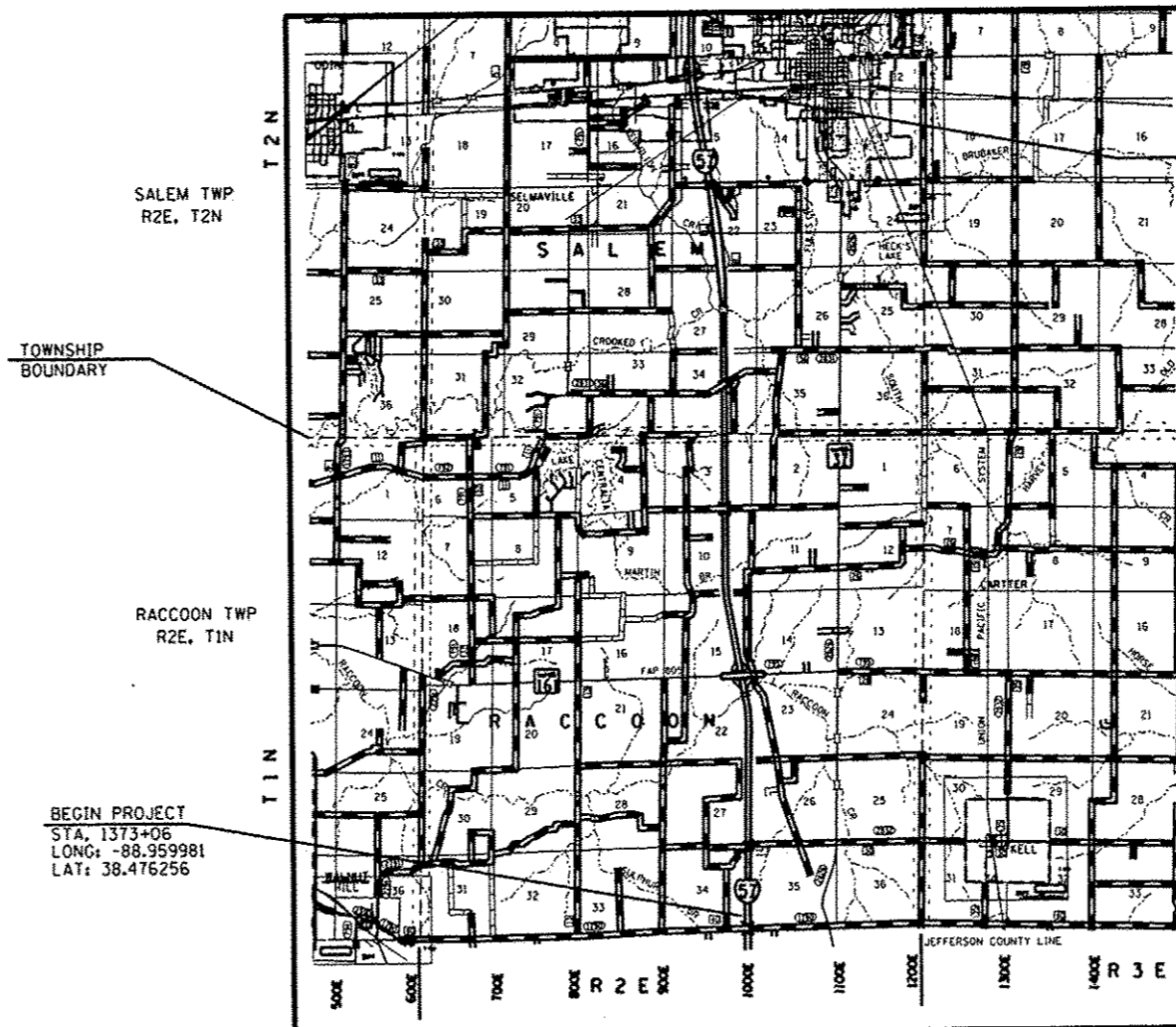

END PROJECT  
STA. 1873+88  
LONG: -88.970801  
LAT: 38.613511

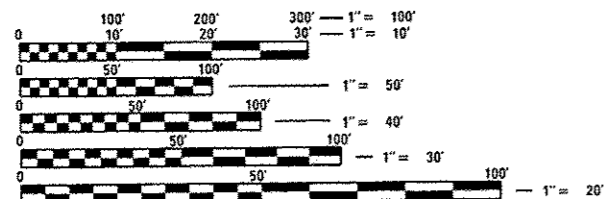

FULL SIZE PLANS HAVE BEEN PREPARED USING STANDARD ENGINEERING SCALES. REDUCED SIZED PLANS WILL NOT CONFORM TO STANDARD SCALES. IN MAKING MEASUREMENTS ON REDUCED PLANS, THE ABOVE SCALES MAY BE USED.

J.U.L.I.E.  
JOINT UTILITY LOCATION INFORMATION FOR EXCAVATION  
1-800-892-0123  
OR 811

BEGIN PROJECT  
STA. 1373+06  
LONG: -88.959981  
LAT: 38.476256

PROJECT ENGINEER: MIKE PRITCHETT (618)346-3180  
PROJECT DESIGNER: DIANA MURRAY (618)346-3454

CONTRACT NO. 76G92

NOT TO SCALE  
GROSS LENGTH = 50,082 FT. = 9.5 MILE  
NET LENGTH = 49,875 FT. = 9.4 MILE

STATE OF ILLINOIS  
DEPARTMENT OF TRANSPORTATION  
DIVISION OF HIGHWAYS

SUBMITTED *Mar 19 20 14*  
*Debra K. K...*  
DEPUTY DIRECTOR OF HIGHWAYS, REGION 5 ENGINEER

*Mar 9 20 14*  
*John D. Baranzelli, P.E.*  
ENGINEER OF DESIGN AND ENVIRONMENT

*Mar 9 20 14*  
*Omair Osman, P.E.*  
DIRECTOR OF HIGHWAYS, CHIEF ENGINEER

**PRINTED BY THE AUTHORITY  
OF THE STATE OF ILLINOIS**

**INDEX OF SHEETS**

- 1 COVER
- 2 INDEX OF SHEETS, GENERAL NOTES, & LIST OF STANDARDS
- 3 SUMMARY OF QUANTITIES
- 4 TYPICAL SECTIONS
- 5 RESURFACING, PAVEMENT MARKING & TEMPORARY RAMP SCHEDULES

**LIST OF STANDARDS**

- 000001-06 STANDARD SYMBOLS, ABBREVIATIONS AND PATTERNS
- 001006 DECIMAL OF AN INCH AND OF A FOOT
- 701101-04 OFF-ROAD OPERATIONS, MULTILANE, 15' (4.5m) TO 24" (600mm) FROM PAVEMENT EDGE
- 701106-02 OFF-ROAD OPERATIONS, MULTILANE, MORE THAN 15' (4.5m) AWAY
- 701400-07 APPROACH TO LANE CLOSURE, FREEWAY / EXPRESSWAY
- 701401-08 LANE CLOSURE, FREEWAY / EXPRESSWAY
- 701406-08 LANE CLOSURE, FREEWAY/EXPRESSWAY, DAY OPERATIONS ONLY
- 701428 TRAFFIC CONTROL, SETUP AND REMOVAL, FREEWAY/EXPRESSWAY
- 701901-03 TRAFFIC CONTROL DEVICES
- 780001-04 TYPICAL PAVEMENT MARKINGS
- 781001-03 TYPICAL APPLICATIONS RAISED REFLECTIVE PAVMENT MARKERS

**GENERAL NOTE**

- 1. THE STANDARDS AND REVISION NUMBERS SHALL APPLY TO THIS PROJECT.
- 2. ILLINOIS STATE LAW REQUIRES A 48 HOUR NOTICE TO BE GIVEN TO ALL UTILITIES BEFORE DIGGING. FIELD MARKING OF FACILITIES MAY BE OBTAINED BY CONTACTING J.U.L.I.E. OR FOR NON MEMBERS, THE UTILITY COMPANY DIRECTLY. AGENCIES KNOWN TO HAVE FACILITIES WITHIN THE PROJECT AREA ARE AS FOLLOWS:

UTILITY	ABOVE GROUND	BELOW GROUND
•AMEREN ILLINOIS	X	X
•AT&T ILLINOIS	X	X
•CHARTER COMMUNICATIONS	X	X
•CITY OF SALEM (GAS)		X
•CITY OF SALEM (WATER & SANITARY SEWER)		X
•COUNTRYMARK COOPERATIVE, LLP		X
•ENABLE - MISSISSIPPI RIVER TRANSMISSION, LLC		X
•RACCOON WATER COMPANY		X
•TRI-COUNTY ELECTRIC COOPERATIVE	X	X
•US SONET, LLC	X	X
•VILLAGE OF ODIN		X
•WOODRIVER BP AMOCO PIPELINE		X
• = JULIE MEMBER		

- 3. THE THICKNESS OF THE HMA MIXTURE SHOWN ON THE PLANS IS THE NOMINAL THICKNESS. DEVIATIONS FROM THE NOMINAL THICKNESS WILL BE PERMITTED WHEN SUCH DEVIATIONS OCCUR DUE TO IRREGULARITIES IN THE EXISTING SURFACE OR BASE ON WHICH THE HMA MIXTURE IS PLACED.
- 4. AN ESTIMATED 7,448 TONS OF HMA WILL BE REMOVED.
- 5. ALL AREAS DISTURBED FOR ANY REASON SHALL BE SEEDED AND MULCHED AS DIRECTED BY THE ENGINEER. NUTRIENTS SHALL CONFORM TO ARTICLE 250.04 OF THE STANDARD SPECIFICATIONS. NO EXTRA PAYMENT WILL BE MADE FOR SUCH WORK.
- 6. THE CONTRACTOR SHALL VERIFY ALL DIMENSIONS AND CONDITIONS IN THE FIELD PRIOR TO CONSTRUCTION AND ORDERING OF MATERIALS.
- 7. "ROAD CONSTRUCTION AHEAD" SIGNS SHALL BE PLACED AT THE BEGINNING OF THE PROJECT PLUS ALL INTERSECTING SIDE ROADS AND RAMPS AND WILL BE INCLUDED IN THE TRAFFIC CONTROL PAY ITEMS. ALL CONSTRUCTION SIGNS SHALL BE 48" FLUORESCENT ORANGE.
- 8. THE PORTABLE CHANGEABLE MESSAGE SIGNS SHALL BE PLACED AS DIRECTED BY THE ENGINEER. NO ADDITIONAL COMPENSATION SHALL BE ALLOWED FOR RELOCATION OF THESE SIGNS.

9. THE PAY PERFORMANCE ITEMS AND QUANTITIES ARE AS FOLLOWS:  
HMA POLY SURFACE COURSE - 7,448 TONS

10. DOUBLE LANE LINE MARKERS SHALL BE UTILIZED ACCORDING TO STANDARD 781001-3.

11. THE CONTRACTOR SHOULD BE AWARE THERE ARE HORIZONTAL CURVES WITHIN THE PROJECT LIMITS THAT MAY BE SUPERELEVATED. THE CONTRACTOR SHALL VERIFY THE EXISTING SUPERELEVATION AND MATCH EXISTING CROSS-SLOPE. THESE CROSS-SLOPES MAY BE CONTRARY TO THE TYPICAL SECTIONS.

**COMMITMENTS**

NONE

**MIXTURE REQUIREMENTS**

ROUTE	I-57
SECTION	61-(1,2)RS-4
COUNTY	MARION
CONTRACT	76092

DESCRIPTION:	MILLING AND RESURFACING ON I-57 FROM JEFFERSON COUNTY LINE TO 0.8 MILES SOUTH OF US 50.
--------------	---

MIXTURE USE	POLY SURFACE				
AC/PG	SBS PG 76-22				
DESIGN AIR VOIDS	4.0% @ Ndes=90				
MIX COMPOSITION					
(GRADATION MIXTURE)	IL 9.5				
FRICTION AGG	MIXTURE "E"				

\*\* Top Lift Shoulders - Design this mix at 2.0% voids and add asphalt to reduce voids 1.5%

Plan quantities for HMA items are calculated using a unit weight of 112 lb/sq yd/in (59.8 kg/sq m/25 mm thickness).

# SUMMARY OF QUANTITIES

100% STATE

100% STATE

SUMMARY OF QUANTITIES			TOTAL QUANTITIES	CONSTRUCTION TYPE CODE	
CODE NO	ITEM	UNIT		0005 RURAL	
40600990	TEMPORARY RAMPS	SO YD	36	36	
40603570	POLYMERIZED HOT-MIX ASPHALT SURFACE COURSE, MIX "E", N90	TON	7448	7448	
44000157	HOT-MIX ASPHALT SURFACE REMOVAL, 2"	SO YD	66500	66500	
67100100	MOBILIZATION	L SUM	1	1	
70100700	TRAFFIC CONTROL AND PROTECTION, STANDARD 701406	L SUM	1	1	
70100800	TRAFFIC CONTROL AND PROTECTION, STANDARD 701401	L SUM	1	1	
70300100	SHORT TERM PAVEMENT MARKING	FOOT	13965	13965	
70300240	TEMPORARY PAVEMENT MARKING - LINE 6"	FOOT	62344	62344	
70301000	WORK ZONE PAVEMENT MARKING REMOVAL	SO FT	34663	34663	
* 78001130	PAINT PAVEMENT MARKING - LINE 6"	FOOT	49875	49875	
* 78004230	PREFORMED PLASTIC PAVEMENT MARKING TYPE B, INLAID - 6"	FOOT	12469	12469	
* 78100100	RAISED REFLECTIVE PAVEMENT MARKER	EACH	1247	1247	
78300200	RAISED REFLECTIVE PAVEMENT MARKER REMOVAL	EACH	1247	1247	
X0323583	SPEED INDICATOR SIGN	CAL DAY	88	88	
X7010410	SPEED DISPLAY TRAILER	CAL MO	3	3	

SUMMARY OF QUANTITIES			TOTAL QUANTITIES	CONSTRUCTION TYPE CODE	
CODE NO	ITEM	UNIT		0005 RURAL	
X4060110	BITUMINOUS MATERIALS (PRIME COAT)	POUND	29925	29925	
Z0034105	MATERIAL TRANSFER DEVICE	TON	7448	7448	
Z0076600	TRAINEE	HOURS			
3					

15

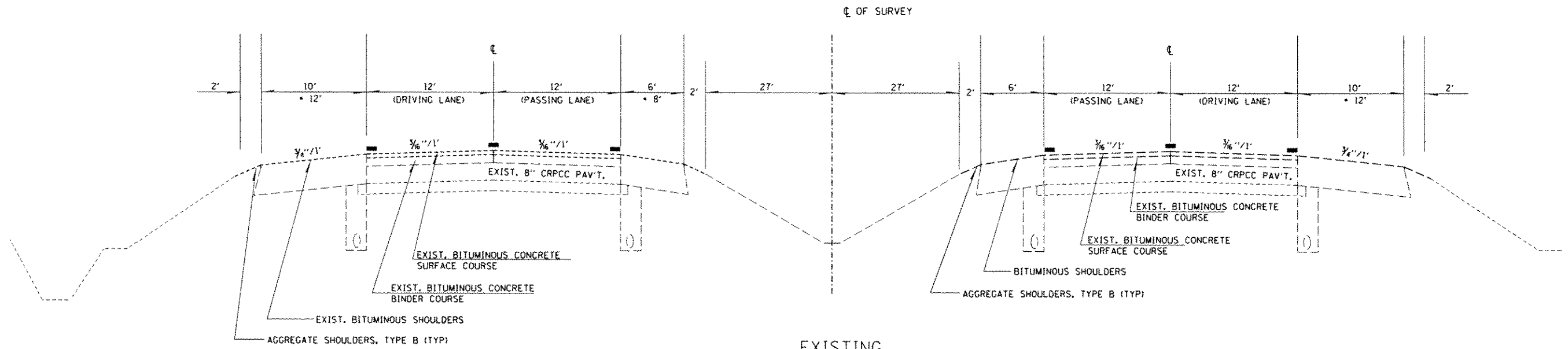

EXISTING  
TYPICAL TANGENT SECTION FAI ROUTE 57

SOUTHBOUND  
STATION 1373+06 TO STATION 1765+88  
STATION 1767+94 TO STATION 1873+88

NORTHBOUND  
STATION 1373+06 TO STATION 1765+71  
STATION 1767+78 TO STATION 1873+88

— PAINT PAVEMENT  
MARKING-LINE 4"

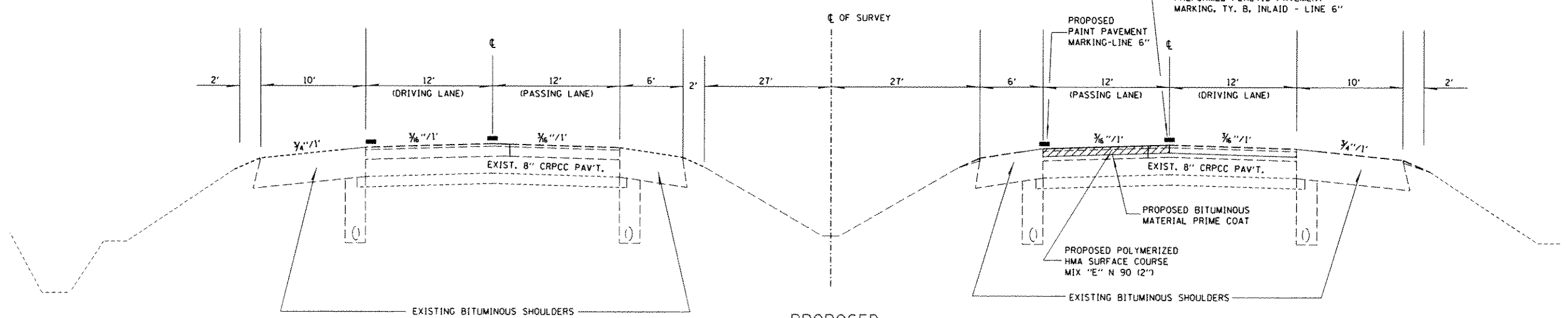

PROPOSED  
TYPICAL TANGENT SECTION FAI ROUTE 57

SOUTHBOUND  
STATION 1373+06 TO STATION 1765+88  
STATION 1767+94 TO STATION 1873+88

NORTHBOUND  
STATION 1373+06 TO STATION 1765+71  
STATION 1767+78 TO STATION 1873+88

HMA SURFACE REMOVAL 2"

FILE NAME :	USER NAME : DEFAULT	DESIGNED :	REVISED :	<b>STATE OF ILLINOIS DEPARTMENT OF TRANSPORTATION</b>	<b>TYPICAL SECTIONS</b>			F.A.I. RTE.	SECTION	COUNTY	TOTAL SHEETS	SHEET NO.
23\p\work\pav\dot\murray\gld\0373195\ub97	eg92-shs\plan.dgn	DRAWN :	REVISED :					57	61-11.21RS-4	MARION	5	4
	PLOT SCALE : 1/8"=1'-0"	CHECKED :	REVISED :		SCALE: _____ SHEET NO. _____ OF _____ SHEETS STA. _____ TO STA. _____			CONTRACT 76C92				
	PLOT DATE : 3/17/2014	DATE :	REVISED :		FED. ROAD DIST. NO. _____ ILLINOIS FED. AID PROJECT							

RESURFACING SCHEDULE							
LOCATION			LENGTH (FOOT)	WIDTH (FOOT)	HMA SURFACE REMOVAL 2"	BITUMINOUS MATERIAL (PRIME COAT)	POLY-HMA SURF CRSE, MIX E, N90, 2"
STA.	TO	STA.					
NORTHBOUND							
1373+06	TO	1765+71	39265	12	52354	23559	5864
1767+78	TO	1873+88	10610	12	14146	6366	1584
TOTAL:					66500	29925	7448

PAVEMENT MARKING SCHEDULE												
STATION TO STATION	DIR	LENGTH	SHORT TERM PAVEMENT MARKING	TEMPORARY PAVEMENT MARKING		RAISED REFLECTIVE PAVEMENT MARKER REMOVAL	RAISED REFLECTIVE PAVEMENT MARKERS	PAINT PAVEMENT MARKING	PREFORMED PLASTIC PAVEMENT MARKING, TY. B INLAID	WORK ZONE PAVEMENT MARKING REMOVAL	AREA	
				6" SOLID YELLOW	6" SKIP-DASH WHITE						FOOT	SQ FT
MAINLINE												
1373+06	TO	1765+71	NB	39265	10994	39265	9816	982	982	39265	9816	27289
1767+78	TO	1873+88	NB	10610	2971	10610	2653	265	265	10610	2653	7374
SUBTOTAL				13965	49875	12469	1247	1247	49875	12469		
TOTAL				13965	62344	1247	1247	49875	12469	34663		

TEMPORARY RAMP SCHEDULE				
DIR	STATION	LTH	WTH	AREA
		FT	FT	SQ YD
MAINLINE				
NB	1373+06.00	7	12	9
NB	1765+71.22	7	12	9
NB	1767+78.20	7	12	9
NB	1873+88.00	7	12	9
TOTAL				36