

MATCHLINE STA. 569+00

MATCHLINE STA. 583+00

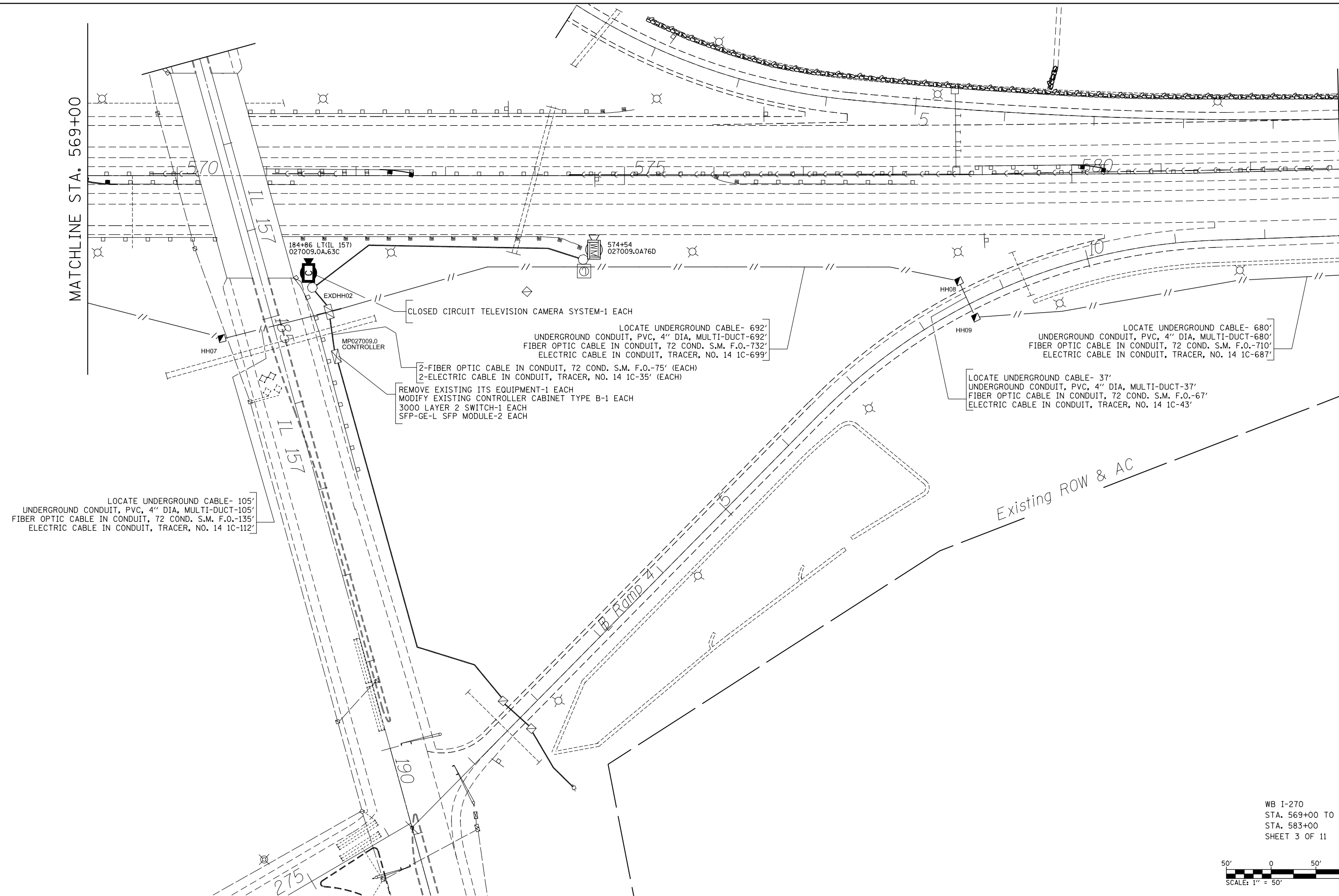

LOCATE UNDERGROUND CABLE- 105'
 UNDERGROUND CONDUIT, PVC, 4" DIA, MULTI-DUCT-105'
 FIBER OPTIC CABLE IN CONDUIT, 72 COND. S.M. F.O.-135'
 ELECTRIC CABLE IN CONDUIT, TRACER, NO. 14 1C-112'

CLOSED CIRCUIT TELEVISION CAMERA SYSTEM-1 EACH
 LOCATE UNDERGROUND CABLE- 692'
 UNDERGROUND CONDUIT, PVC, 4" DIA, MULTI-DUCT-692'
 FIBER OPTIC CABLE IN CONDUIT, 72 COND. S.M. F.O.-732'
 ELECTRIC CABLE IN CONDUIT, TRACER, NO. 14 1C-699'
 2-FIBER OPTIC CABLE IN CONDUIT, 72 COND. S.M. F.O.-75' (EACH)
 2-ELECTRIC CABLE IN CONDUIT, TRACER, NO. 14 1C-35' (EACH)
 REMOVE EXISTING ITS EQUIPMENT-1 EACH
 MODIFY EXISTING CONTROLLER CABINET TYPE B-1 EACH
 3000 LAYER 2 SWITCH-1 EACH
 SFP-GE-L SFP MODULE-2 EACH

LOCATE UNDERGROUND CABLE- 680'
 UNDERGROUND CONDUIT, PVC, 4" DIA, MULTI-DUCT-680'
 FIBER OPTIC CABLE IN CONDUIT, 72 COND. S.M. F.O.-710'
 ELECTRIC CABLE IN CONDUIT, TRACER, NO. 14 1C-687'
 LOCATE UNDERGROUND CABLE- 37'
 UNDERGROUND CONDUIT, PVC, 4" DIA, MULTI-DUCT-37'
 FIBER OPTIC CABLE IN CONDUIT, 72 COND. S.M. F.O.-67'
 ELECTRIC CABLE IN CONDUIT, TRACER, NO. 14 1C-43'

Existing ROW & AC

Ramp 4

WB I-270
 STA. 569+00 TO
 STA. 583+00
 SHEET 3 OF 11

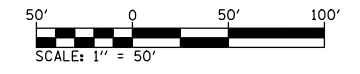

FILE NAME =	USER NAME = prestonme	DESIGNED -	REVISED -
et:\pw\work\p\dot\prestonme\d0355968\d876995-sh1-ITS.dgn		DRAWN -	REVISED -
	PLOT SCALE = 100.0000' / in.	CHECKED -	REVISED -
	PLOT DATE = 3/20/2014	DATE -	REVISED -

**STATE OF ILLINOIS
 DEPARTMENT OF TRANSPORTATION**

ITS PLAN 3 & OF 11

SCALE: SHEET NO. OF SHEETS STA. TO STA.

F.A.I. RTE.	SECTION	COUNTY	TOTAL SHEETS	SHEET NO.
270	DIST 8 ITS 2014-2	MADISON	37	11
FED. ROAD DIST. NO. ILLINOIS FED. AID PROJECT			CONTRACT NO. 76C95	