

• POLYUREA PAVEMENT MARKING - LINE 4"
- STA. 313+12.96 TO STA. 318+50.04

NOTE: RESURFACING (13) OVER THE EXISTING SHOULDER SHALL BE PAID FOR AS HMA SURFACE COURSE.

TYPICAL SECTION #4
F.A.P. 310 (U.S. 67)
STA. 312+10.96 TO STA. 313+12.96
BRIDGE OMISSION - STA. 313+12.96 TO STA. 318+50.04
STA. 318+50.04 TO STA. 319+72.04

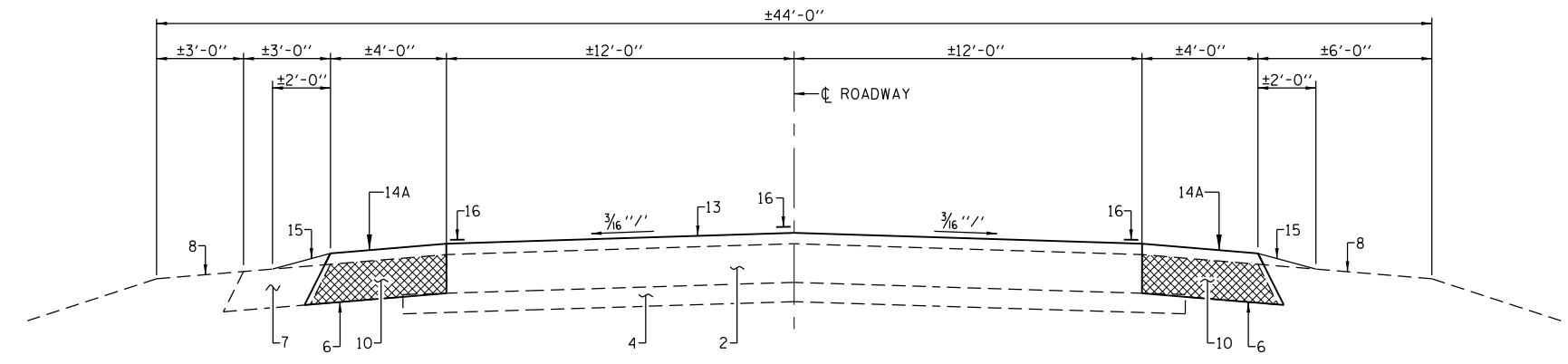

- INDICATES HMA SURFACE REMOVAL
- INDICATES HMA SHOULDER REMOVAL

TYPICAL SECTION #5
F.A.P. 310 (U.S. 67)
STA. 327+10.99 TO STA. 345+02

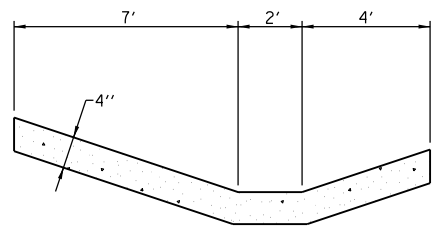

TYPICAL SECTION - PAVED DITCH (SPECIAL)
STA. 287+53 TO STA. 290+44

PAVEMENT LEGEND

1. EX 9"-6"-9" PCC PVMT
2. EX PCC PVMT
3. EX PCC BASE CRSE WIDENING
4. EX SUB-BASE
5. EX BIT OVERLAYS
6. EX HMA SHLDRS 8"
7. EX AGG SHLDRS, TY A
8. EX EARTH SHLDR
9. PR HMA SURF REMOVAL 3/4"
10. PR HMA SHOULDER REMOVAL
11. PR BIT MATERIAL & AGGREGATE (PRIME COAT)
12. PR HMA SURFACE COURSE 2 1/4"
13. PR HMA SURFACE COURSE 2 1/2"
14. PR HMA SHOULDERS, 9 1/2"
- 14A. PR HMA SHOULDERS, 10 1/2"
15. PR AGG WEDGE SHOULDER, TYPE B
16. PR THERMOPLASTIC PVMT MARKING
17. PR STRIP REFLECTIVE CRACK CONTROL

USER NAME = *USER*	DESIGNED -	REVISED -	Allen Henderson & Associates, Inc. Civil and Structural Engineers Springfield, IL 62703 Phone: (217)544-8033 IL Design Firm No. 184-001907	TYPICAL ROADWAY SECTIONS		F.A.P. RTE. 310	SECTION (55,56)RS-3	COUNTY GREENE	TOTAL SHEETS 15	SHEET NO. 7	
PLOT SCALE = *SCALE*	CHECKED -	REVISED -		SCALE: NONE	SHEET NO. 2 OF 2 SHEETS	STA. + TO STA. +	CONTRACT NO. 76H12				
PLOT DATE = *DATE*	DATE -	REVISED -		FED. ROAD DIST. NO. ILLINOIS FED. AID PROJECT							