

F.A.P. RTE.	SECTION	COUNTY	TOTAL SHEETS	SHEET NO.
• (31,37,32,39,S-1,12,45,86)I-1	MADISON	ILLINOIS	12	1
FED. ROAD DIST. NO.		CONTRACT NO. 76H21		
• FAP 793/690/692				

06-13-14 LETTING ITEM 143

STATE OF ILLINOIS
DEPARTMENT OF TRANSPORTATION
DIVISION OF HIGHWAYS

**PROPOSED
HIGHWAY PLANS**

FAP ROUTE 793/690/692 (US 40 / IL 160)
SECTION (31,37,32,39,S-1,12,45,86)I-1
MADISON COUNTY
C-98-048-14

FOR INDEX OF SHEETS, GENERAL NOTES
AND STANDARDS SEE SHEET NO. 2

TRAFFIC DATA

FAP 793	FAP 690 (IL 160)	FAP 692
US 40	SYCAMORE ST.	IL 160
2013 ADT = 14,000	2013 ADT = 3,000	2013 ADT = 6,600
SU = 5.89%	SU = 2.76%	SU = 8.20%
MU = 3.57%	MU = 1.72%	MU = 3.20%

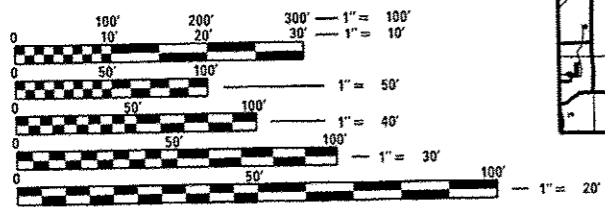
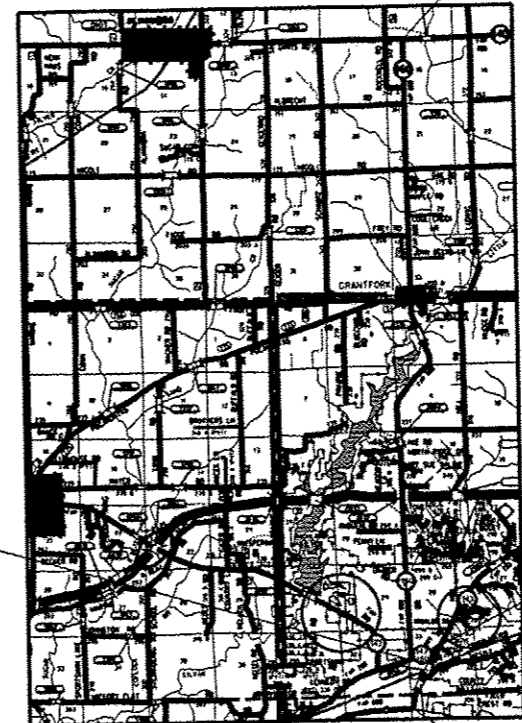
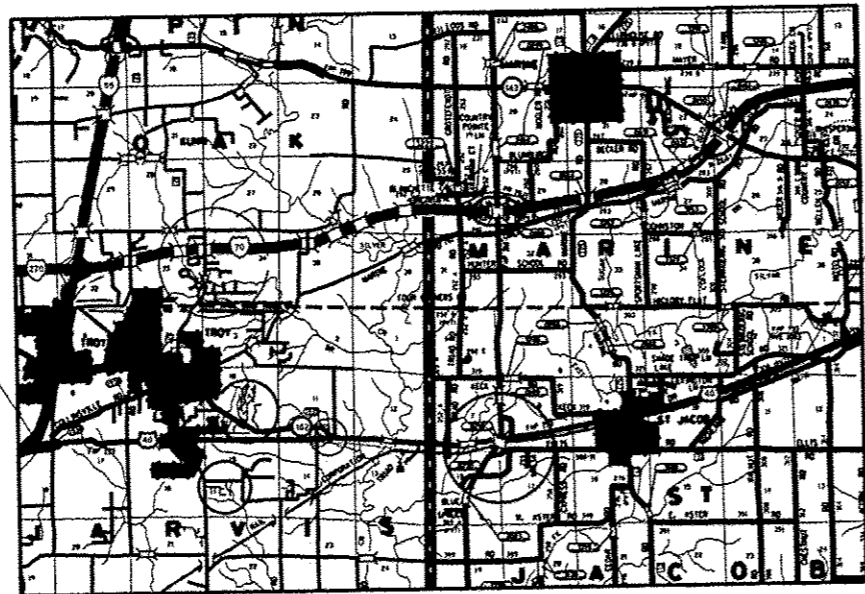

FULL SIZE PLANS HAVE BEEN PREPARED USING STANDARD ENGINEERING SCALES. REDUCED SIZED PLANS WILL NOT CONFORM TO STANDARD SCALES. IN MAKING MEASUREMENTS ON REDUCED PLANS, THE ABOVE SCALES MAY BE USED.

J.U.L.I.E.
JOINT UTILITY LOCATION INFORMATION FOR EXCAVATION
1-800-892-0123
OR 811

LOCATION MAP

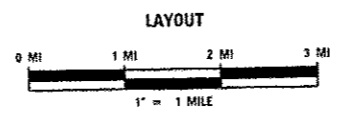

PROJECT GROSS LENGTH = 20.75 miles (109,560 ft)
PROJECT NET LENGTH = 20.75 miles (109,560 ft)

PROJECT ENGINEER MICHAEL PRITCHETT (618)346-3180
DESIGNER ALVIN NIEVES-ROSARIO (618)346-3454

CONTRACT NO. 76H21

STATE OF ILLINOIS
DEPARTMENT OF TRANSPORTATION
DIVISION OF HIGHWAYS

SUBMITTED April 11 20 14

[Signature]
DEPUTY DIRECTOR OF HIGHWAYS, REGION ENGINEER

May 9 20 14
[Signature]
ENGINEER OF DESIGN AND ENVIRONMENT

May 9 20 14
[Signature]
DIRECTOR OF HIGHWAYS, CHIEF ENGINEER

**PRINTED BY THE AUTHORITY
OF THE STATE OF ILLINOIS**

CODE NO.	ITEM	UNIT	TOTAL QUANTITY	100% STATE	
				CONSTRUCTION CODE	
				ROADWAY 0005 URBAN	ROADWAY 0005 RURAL
44201789	CLASS D PATCHES, TYPE II, 12 INCH	SQ YD	1130	88	1042
44201794	CLASS D PATCHES, TYPE III, 12 INCH	SQ YD	36		36
44201827	CLASS D PATCHES, TYPE II, 15 INCH	SQ YD	87	87	
67100100	MOBILIZATION	L SUM	1	0.3	0.7
70100310	TRAFFIC CONTROL AND PROTECTION, STANDARD 701421	L SUM	1	1	
70100450	TRAFFIC CONTROL AND PROTECTION, STANDARD 701201	L SUM	1	0.2	0.8
70100600	TRAFFIC CONTROL AND PROTECTION, STANDARD 701336	L SUM	1	0.2	0.8
70102620	TRAFFIC CONTROL AND PROTECTION, STANDARD 701501	L SUM	1	1	
70102635	TRAFFIC CONTROL AND PROTECTION, STANDARD 701701	L SUM	1	1	
* 78000200	THERMOPLASTIC PAVEMENT MARKING - LINE 4"	FOOT	70201	39196	31005
* 78100100	RAISED REFLECTIVE PAVEMENT MARKER	EACH	1105	487	618
X4406230	PARTIAL DEPTH REMOVAL, TYPE II, 3"	SQ YD	4679	1904	2775
X4406430	PARTIAL DEPTH REMOVAL, TYPE III, 3"	SQ YD	2628	1612	1016
X4406630	PARTIAL DEPTH REMOVAL, TYPE IV, 3"	SQ YD	21911	11349	10562
Ø Z0076604	TRAINEES TRAINING PROGRAM GRADUATE	HOUR	500	250	250

* SPECIALTY ITEM

Ø 0042

CODE NO.	ITEM	UNIT	TOTAL QUANTITY	100% STATE	
				CONSTRUCTION CODE	
				ROADWAY 0005 URBAN	ROADWAY 0005 RURAL
X4421000	PARTIAL DEPTH PATCHING	TON	4909	2497	2412

FILE NAME	USER NAME	DESIGNED - GEL	REVISED -
en:\p\work\p\dot\in\evase\08380125\087821-1\tr-plan.dgn		DRAWN - LAC	REVISED -
PLOT SCALE * 100.0000 1/16"		CHECKED - MDP	REVISED -
PLOT DATE * 4/11/2014		DATE - 3/20/2012	REVISED -

STATE OF ILLINOIS
DEPARTMENT OF TRANSPORTATION

SUMMARY OF QUANTITIES

F.A.P. RTE.	SECTION	COUNTY	TOTAL SHEETS	SHEET NO.
*	(31,37,32,39,S-1,12,45,86)-1	MADISON	12	3
CONTRACT NO. 76H21				
ILLINOIS FED. AID PROJECT				

SCALE: SHEET NO. OF SHEETS STA. TO STA.

15

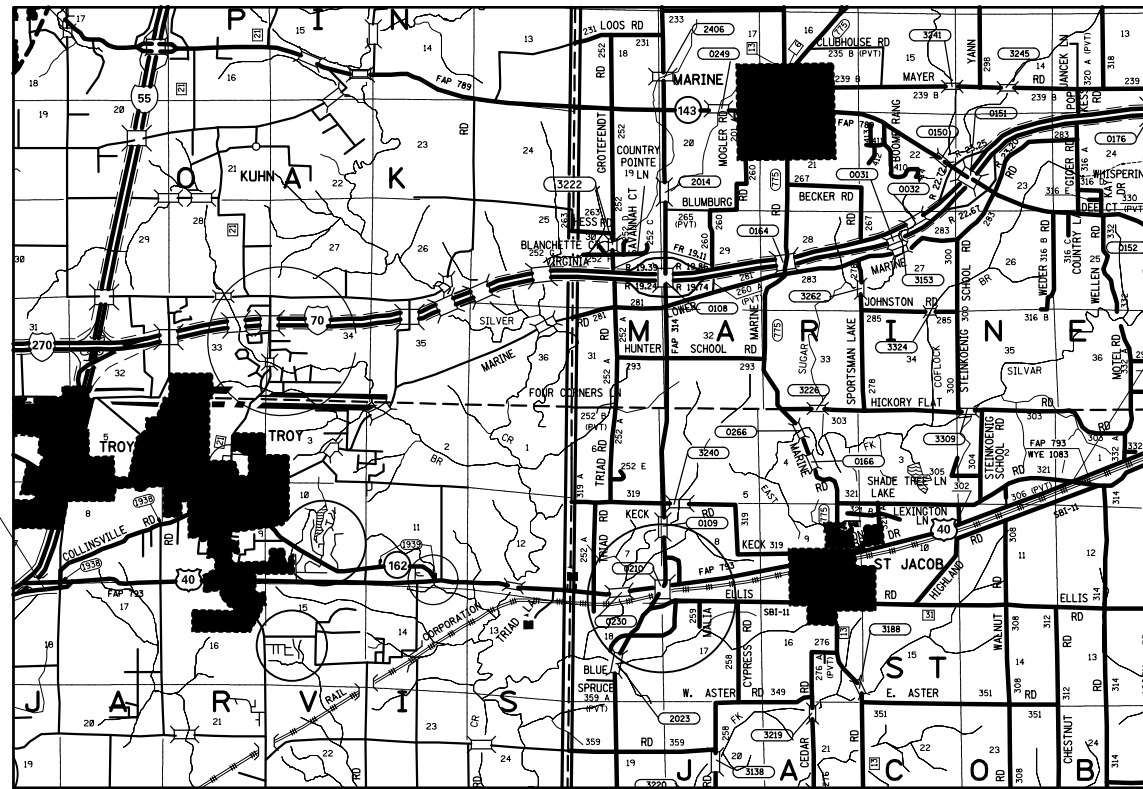

FAP 793 (US 40)

MS 0.0
FAP 793
LAT. 38.71756389
LONG. -89.91390643

MS 10.4
FAP 793
LAT. 38.73185021
LONG. -89.72221138

MS 9.45
FAP 692
LAT. 38.88851382
LONG. -89.66959919

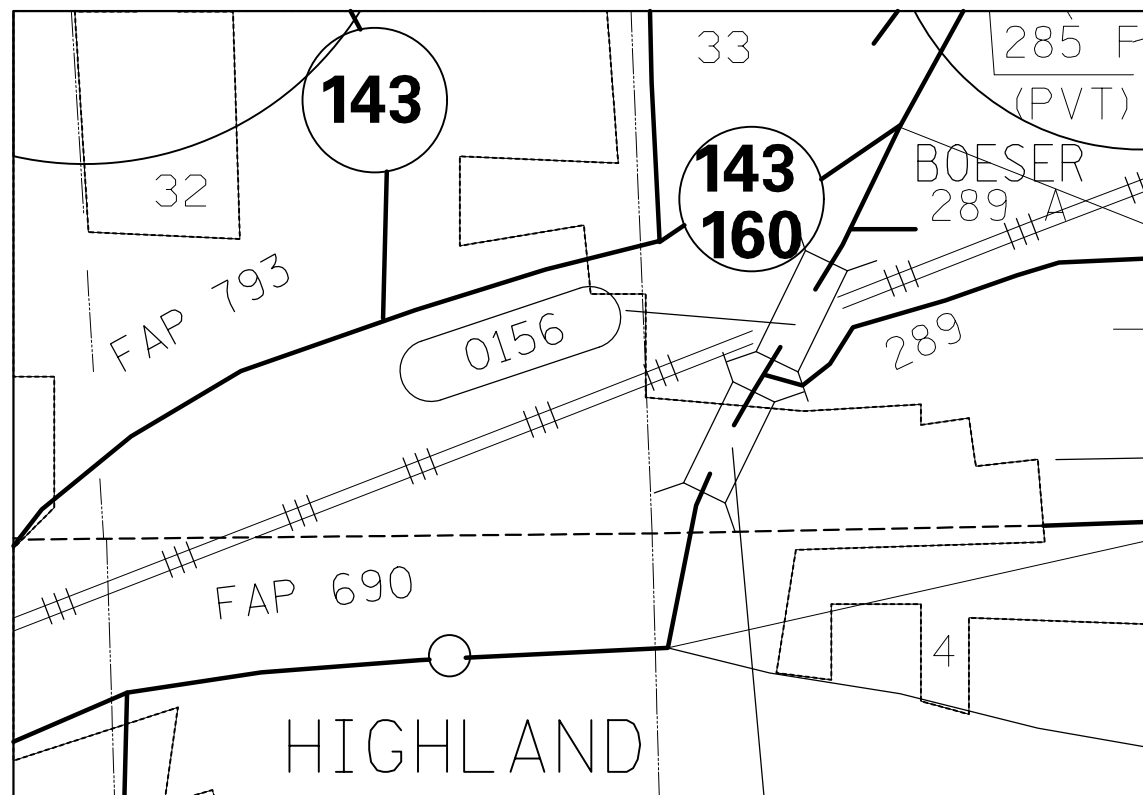

FAP 690 (IL 160)

MS 0.9
FAP 690
LAT. 38.75356738
LONG. -89.66358682

MS 0.0
FAP 690
LAT. 38.73995518
LONG. -89.67147333

MS 0.0
FAP 692
LAT. 38.75054063
LONG. -89.6717715

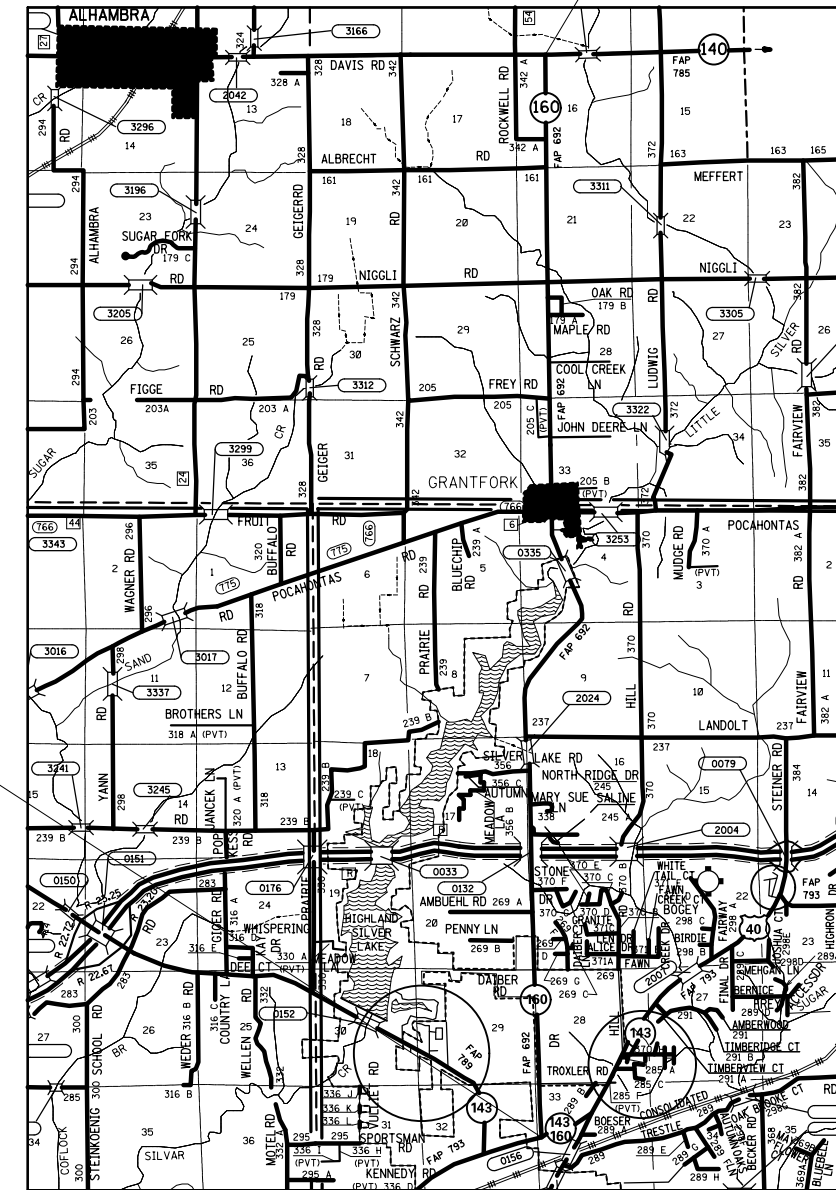

FAP 692 (IL 160)

FILE NAME =	USER NAME = nivesa	DESIGNED - GEL	REVISED -
et:\pw\work\p\dot\nivesa\d0388125\d876h21-sh1-plan.dgn		DRAWN - LAC	REVISED -
	PLOT SCALE = 100.0000' / in.	CHECKED - MDP	REVISED -
	PLOT DATE = 4/11/2014	DATE - 3/20/2012	REVISED -

STATE OF ILLINOIS
DEPARTMENT OF TRANSPORTATION

LOCATION MAP

SCALE: SHEET NO. OF SHEETS STA. TO STA.

FAP 793/690/692

F.A.P. R.T.E.	SECTION	COUNTY	TOTAL SHEETS	SHEET NO.
(31,37,32,39,S-1,12,45,86)I-1		MADISON	12	4
CONTRACT NO. 76H21			ILLINOIS FED. AID PROJECT	

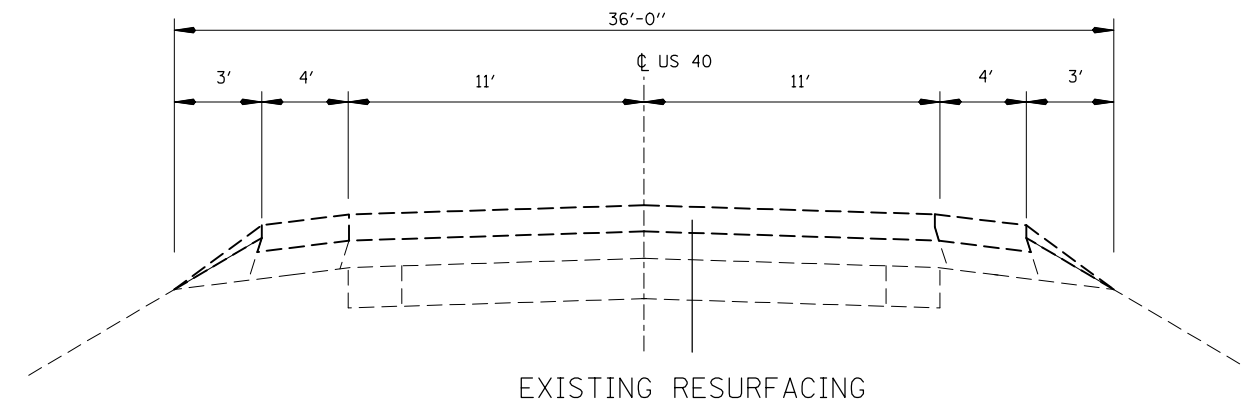
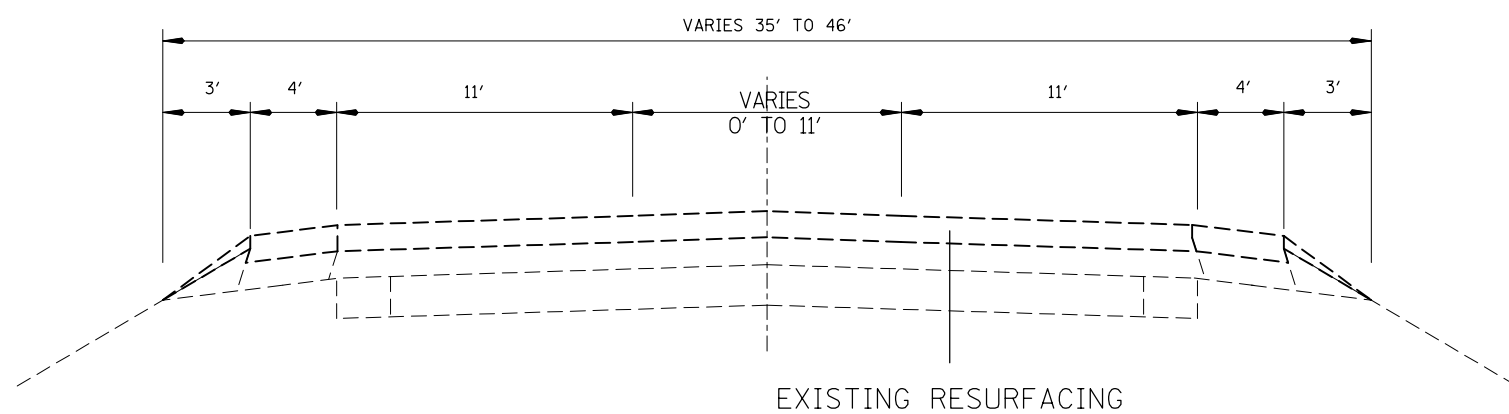
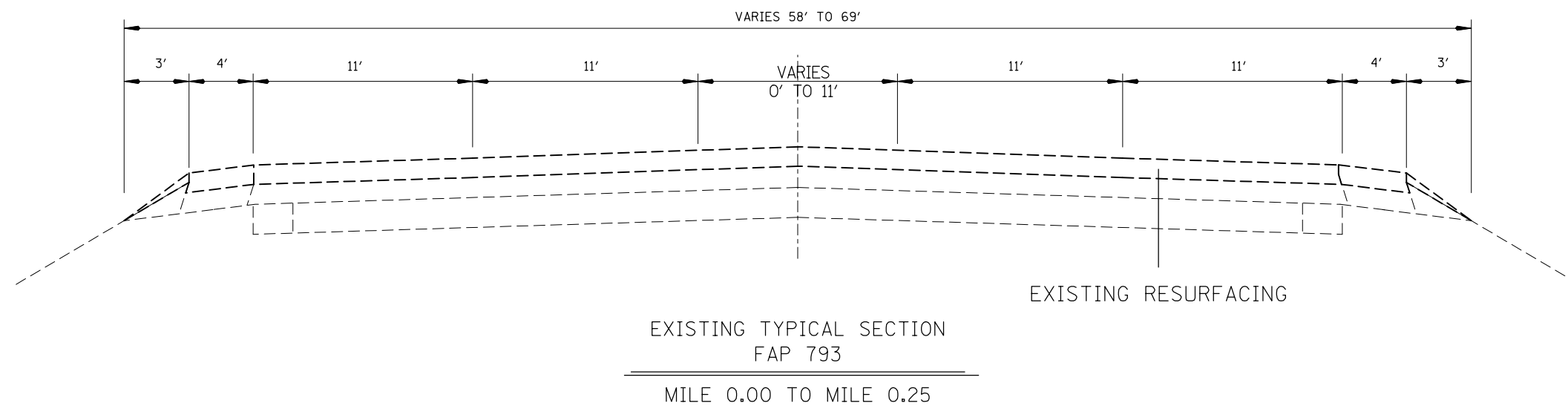

FILE NAME =	USER NAME = nievesa	DESIGNED - GEL	REVISED -
et:\pw\work\p\dot\nievesa\d0388125\d876h21-sh-t-plan.dgn		DRAWN - LAC	REVISED -
	PLOT SCALE = 100.0000' / in.	CHECKED - MDP	REVISED -
	PLOT DATE = 4/11/2014	DATE - 3/20/2012	REVISED -

**STATE OF ILLINOIS
DEPARTMENT OF TRANSPORTATION**

TYPICAL SECTIONS

SCALE: SHEET NO. OF SHEETS STA. TO STA.

• FAP 793/690/692

F.A.P. RTE.	SECTION	COUNTY	TOTAL SHEETS	SHEET NO.
•	(31,37,32,39,S-1,12,45,86)I-1	MADISON	12	5
CONTRACT NO. 76H21				
ILLINOIS FED. AID PROJECT				

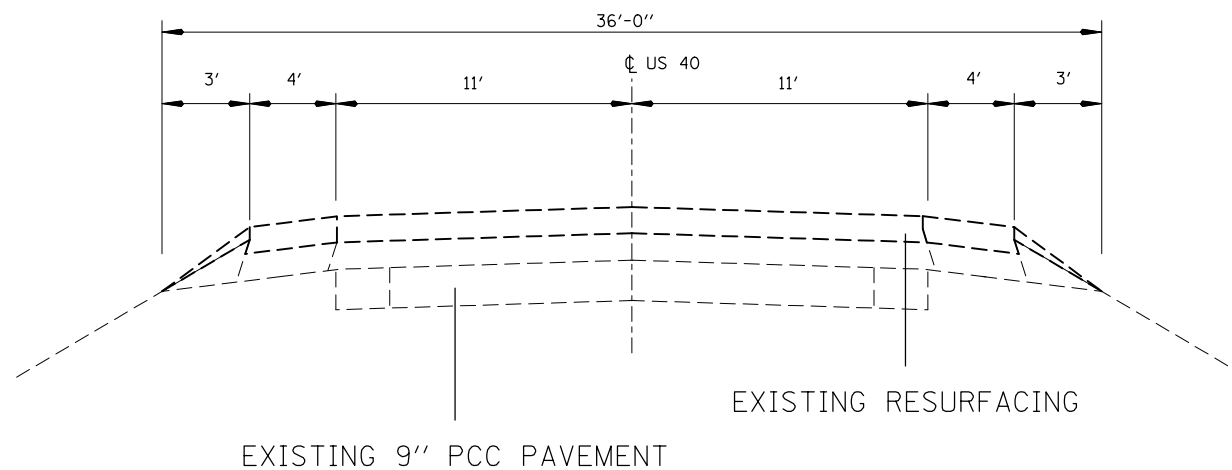

EXISTING TYPICAL SECTION
 FAP 690
 MILE 0.00 TO MILE 0.90

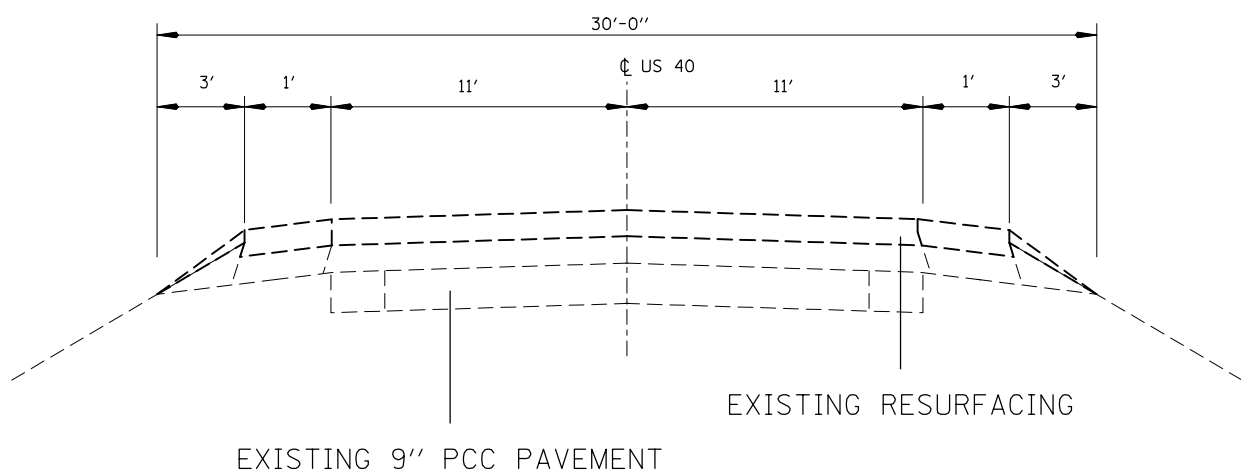

EXISTING TYPICAL SECTION
 FAP 692
 MILE 0.00 TO MILE 0.30
 MILE 0.60 TO MILE 9.45

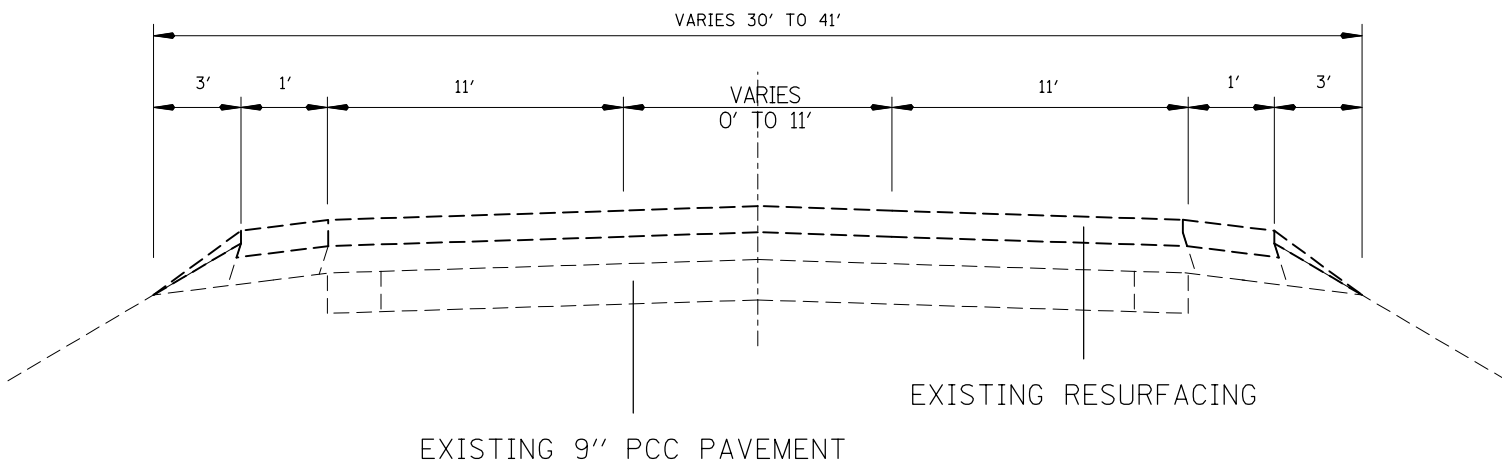

EXISTING TYPICAL SECTION
 FAP 692
 MILE 0.30 TO MILE 0.60

FILE NAME =	USER NAME = nivesa	DESIGNED - GEL	REVISED -
et:\pw\work\p\dot\nivesa\d0388125\d876h21-11-11-11.dgn		DRAWN - LAC	REVISED -
	PLOT SCALE = 100.0000' / in.	CHECKED - MDP	REVISED -
	PLOT DATE = 4/11/2014	DATE - 3/20/2012	REVISED -

**STATE OF ILLINOIS
 DEPARTMENT OF TRANSPORTATION**

TYPICAL SECTIONS			
SCALE:	SHEET NO.	OF SHEETS	STA. TO STA.

• FAP 793/690/692				
F.A.P. RTE.	SECTION	COUNTY	TOTAL SHEETS	SHEET NO.
•	(31,37,32,39,S-1,12,45,86)I-1	MADISON	12	6
				CONTRACT NO. 76H21
ILLINOIS FED. AID PROJECT				

PAVEMENT MARKING FAP 793 (US 40) EB						
LOCATION			RT/LT	THERMOPLASTIC PAVEMENT MARKING - LINE 4", SOLID	THERMOPLASTIC PAVEMENT MARKING - LINE 4", SKIP DASH	RAISED REFLECTIVE PAVEMENT MARKERS
				YELLOW FOOT	WHITE FOOT	WHITE EACH
0.01	TO	0.02	LT	30	10	1
0.02	TO	0.03	LT	60	20	1
0.04	TO	0.05	LT	60	20	1
0.04	TO	0.06	LT	80	20	1
0.12	TO	0.30	LT	950	240	12
SUBTOTAL				1180	310	16

PAVEMENT MARKING FAP 793 (US 40) EB						
LOCATION			RT/LT	THERMOPLASTIC PAVEMENT MARKING - LINE 4", SOLID	THERMOPLASTIC PAVEMENT MARKING - LINE 4", SKIP DASH	RAISED REFLECTIVE PAVEMENT MARKERS
				WHITE FOOT	YELLOW FOOT	AMBER EACH
0.42	TO	0.44		80	20	1
0.50	TO	0.51		60	20	1
0.56	TO	0.58		100	30	2
0.70	TO	0.70		12	10	1
0.70	TO	1.30		3168	800	40
0.80	TO	0.80		12	10	1
0.90	TO	0.90		12	10	1
0.98	TO	0.98		12	10	1
1.00	TO	1.00		12	10	1
1.04	TO	1.04		12	10	1
1.08	TO	1.08		12	10	1
1.09	TO	1.09		12	10	1
1.12	TO	1.12		12	10	1
1.14	TO	1.14		12	10	1
1.20	TO	1.20		12	10	1
1.30	TO	1.30		12	10	1
1.70	TO	2.25		2904	730	37
1.73	TO	1.73		12	10	1
1.77	TO	1.77		12	10	1
1.83	TO	1.83		12	10	1
1.84	TO	1.84		12	10	1
1.86	TO	1.87		40	10	1
1.91	TO	1.91		12	10	1
2.00	TO	2.00		12	10	1
2.20	TO	2.20		12	10	1
2.20	TO	2.22		100	30	2
2.30	TO	2.30		12	10	1
2.40	TO	2.41		60	20	1
2.56	TO	2.56		12	10	1
2.70	TO	2.70		12	10	1
3.10	TO	4.30		6336	1590	80
3.10	TO	3.10		12	10	1
3.20	TO	3.21		40	20	1
3.22	TO	3.22		12	10	1
3.28	TO	3.28		12	10	1
3.33	TO	3.34		30	10	1
3.35	TO	3.35		20	10	1
3.37	TO	3.38		30	10	1
3.50	TO	3.50		12	10	1
3.60	TO	3.60		12	10	1
3.60	TO	3.61		60	20	1
3.80	TO	3.80		12	10	1
3.90	TO	3.90		12	10	1
4.00	TO	4.00		12	10	1
4.10	TO	4.10		12	10	1
4.40	TO	4.43		160	40	2
4.60	TO	4.60		12	10	1
4.60	TO	4.61		40	20	1
4.70	TO	4.70		12	10	1
4.70	TO	4.70		20	10	1
4.80	TO	4.81		60	20	1
4.80	TO	4.80		12	10	1
4.80	TO	5.00		1056	270	14
5.00	TO	5.00		12	10	1
5.00	TO	5.00		12	10	1
5.00	TO	5.00		12	10	1
5.20	TO	5.21		40	20	1
5.50	TO	5.50		12	10	1
5.60	TO	5.60		12	10	1
5.60	TO	5.60		12	10	1
6.00	TO	6.01		40	20	1
7.50	TO	7.50		12	10	1
7.60	TO	7.60		12	10	1
7.70	TO	7.70		12	10	1
7.80	TO	7.80		12	10	1
10.10	TO	10.40		1584	400	20
SUBTOTAL				16556	4140	207

PAVEMENT MARKING FAP 793 (US 40) WB						
LOCATION			RT/LT	THERMOPLASTIC PAVEMENT MARKING - LINE 4", SOLID	THERMOPLASTIC PAVEMENT MARKING - LINE 4", SKIP DASH	RAISED REFLECTIVE PAVEMENT MARKERS
				WHITE FOOT	YELLOW FOOT	WHITE EACH
0.01	TO	0.01	LT	12	10	1
0.06	TO	0.07	LT	40	10	1
0.06	TO	0.07	LT	40	10	1
0.10	TO	0.11	RT	60	20	1
0.13	TO	0.13	RT	12	10	1
0.20	TO	0.21	LT	40	10	1
0.25	TO	0.26	LT	60	20	1
SUBTOTAL				72	192	90

PAVEMENT MARKING FAP 793 (US 40) WB						
LOCATION			RT/LT	THERMOPLASTIC PAVEMENT MARKING - LINE 4", SOLID	THERMOPLASTIC PAVEMENT MARKING - LINE 4", SKIP DASH	RAISED REFLECTIVE PAVEMENT MARKERS
				WHITE FOOT	YELLOW FOOT	AMBER EACH
0.40	TO	0.42		100	30	2
0.50	TO	0.51		60	20	1
0.55	TO	1.30		3960	990	50
0.70	TO	0.70		12	10	1
0.80	TO	0.80		12	10	1
0.90	TO	0.90		12	10	1
0.98	TO	0.98		12	10	1
1.00	TO	1.00		12	10	1
1.04	TO	1.04		12	10	1
1.08	TO	1.08		12	10	1
1.09	TO	1.09		12	10	1
1.12	TO	1.12		12	10	1
1.14	TO	1.14		12	10	1
1.20	TO	1.20		12	10	1
1.30	TO	1.30		12	10	1
1.73	TO	1.73		12	10	1
1.80	TO	2.25		2376	600	30
1.83	TO	1.83		12	10	1
1.84	TO	1.84		12	10	1
1.86	TO	1.87		40	10	1
1.91	TO	1.91		12	10	1
2.00	TO	2.00		12	10	1
2.20	TO	2.20		12	10	1
2.30	TO	2.30		12	10	1
2.40	TO	2.41		60	20	1
2.56	TO	2.56		12	10	1
2.70	TO	2.70		12	10	1
3.10	TO	4.30		6336	1590	80
3.10	TO	3.10		12	10	1
3.20	TO	3.21		40	20	1
3.22	TO	3.22		12	10	1
3.28	TO	3.28		12	10	1
3.33	TO	3.34		30	10	1
3.35	TO	3.35		20	10	1
3.37	TO	3.38		30	10	1
3.50	TO	3.50		12	10	1
3.60	TO	3.60		12	10	1
3.60	TO	3.61		60	20	1
3.80	TO	3.80		12	10	1
3.90	TO	3.90		12	10	1
4.00	TO	4.00		12	10	1
4.10	TO	4.10		12	10	1
4.10	TO	4.12		80	30	2
4.20	TO	4.22		80	30	2
4.25	TO	4.27		120	30	2
4.30	TO	4.32		120	30	2
4.50	TO	4.52		80	30	2
4.60	TO	4.60		12	10	1
4.70	TO	4.70		12	10	1
5.00	TO	5.00		12	10	1
5.00	TO	5.00		12	10	1
5.10	TO	5.11		60	20	1
5.20	TO	5.22		80	30	2
5.20	TO	5.21		40	20	1
5.50	TO	5.50		12	10	1
5.60	TO	5.60		12	10	1
5.60	TO	5.60		12	10	1
7.50	TO	7.50		12	10	1
7.60	TO	7.60		12	10	1
7.70	TO	7.70		12	10	1
7.80	TO	7.80		12	10	1
10.10	TO	10.40		1584	400	20
SUBTOTAL				15970	4400	248
TOTAL FAP 793				42910		478

FILE NAME =	USER NAME = nivesa	DESIGNED - GEL	REVISED -	STATE OF ILLINOIS DEPARTMENT OF TRANSPORTATION	SCHEDULE OF QUANTITIES			F.A.P. RTE.	SECTION	COUNTY	TOTAL SHEETS	SHEET NO.
et:\pw_work\p\dot\nivesa\d0388125\d876h21-sh-p1en.dgn	DRAWN - LAC	RECHECKED - MDP	REVISED -					•	(31,37,32,39,S-1,12,45,86)I-1	MADISON	12	7
PLOT SCALE = 100.0000' / in.	CHECKED - MDP	DATE - 3/20/2012	REVISED -		SCALE:	SHEET NO.	OF SHEETS	STA.	TO STA.	ILLINOIS FED. AID PROJECT	CONTRACT NO. 76H21	
PLOT DATE = 4/11/2014	DATE - 3/20/2012	REVISED -										

• FAP 793/690/692

PAVEMENT MARKING FAP 690 (IL 160) NB					
LOCATION			THERMOPLASTIC PAVEMENT MARKING - LINE 4", SOLID	THERMOPLASTIC PAVEMENT MARKING - LINE 4", SKIP DASH	RAISED REFLECTIVE PAVEMENT MARKERS
			WHITE FOOT	YELLOW FOOT	AMBER EACH
0.10	TO	0.16	300	80	4
0.20	TO	0.21	40	10	1
0.30	TO	0.30	12	10	1
0.30	TO	0.30	12	10	1
0.40	TO	0.40	12	10	1
0.40	TO	0.40	8	10	1
0.40	TO	0.40	12	10	1
0.50	TO	0.50	8	10	1
0.50	TO	0.50	12	10	1
0.60	TO	0.62	100	30	2
0.60	TO	0.60	12	10	1
0.70	TO	0.70	10	10	1
0.80	TO	0.80	8	10	1
0.90	TO	0.91	40	10	1
SUBTOTAL			586	230	18

PAVEMENT MARKING FAP 690 (IL 160) SB					
LOCATION			THERMOPLASTIC PAVEMENT MARKING - LINE 4", SOLID	THERMOPLASTIC PAVEMENT MARKING - LINE 4", SKIP DASH	RAISED REFLECTIVE PAVEMENT MARKERS
			WHITE FOOT	YELLOW FOOT	AMBER EACH
0.30	TO	0.30	12	10	1
0.30	TO	0.30	12	10	1
0.40	TO	0.40	12	10	1
0.40	TO	0.40	12	10	1
0.50	TO	0.50	8	10	1
0.50	TO	0.50	12	10	1
0.60	TO	0.62	100	30	2
0.60	TO	0.60	8	10	1
0.60	TO	0.60	12	10	1
0.80	TO	0.80	8	10	1
0.90	TO	0.91	40	10	1
SUBTOTAL			236	130	12
TOTAL FAP 690			1182		30

ROUTE	THERMOPLASTIC PAVEMENT MARKING - LINE 4"	RAISED REFLECTIVE PAVEMENT MARKERS
	FOOT	EACH
FAP 793 US 40)	42910	478
FAP 690 (IL 160)	1182	30
FAP 692 IL 160)	26108	597
TOTAL	70201	1105

• FAP 793/690/692

FILE NAME =	USER NAME = nivesa	DESIGNED - GEL	REVISED -
et:\pw\work\p1dot\nivesa\d0388125\d876h21-sh-t-pln.dgn		DRAWN - LAC	REVISED -
	PLOT SCALE = 100.0000' / in.	CHECKED - MDP	REVISED -
	PLOT DATE = 4/11/2014	DATE - 3/20/2012	REVISED -

**STATE OF ILLINOIS
DEPARTMENT OF TRANSPORTATION**

SCHEDULE OF QUANTITIES

SCALE: SHEET NO. OF SHEETS STA. TO STA.

F.A.P. RTE.	SECTION	COUNTY	TOTAL SHEETS	SHEET NO.
•	(31,37,32,39,S-1,12,45,86)I-1	MADISON	12	9
			CONTRACT NO. 76H21	
ILLINOIS FED. AID PROJECT				

CLASS D PATCHING FAP 690 (IL 160) NB			
MILE	WIDTH	LENGTH	CLASS D 15"
			TYPE II SQ YD
0.50	12	8	10.7
0.60	12	8	10.7
0.70	12	10	13.3
0.80	12	8	10.7
SUBTOTAL			45

CLASS D PATCHING FAP 690 (IL 160) SB			
MILE	WIDTH	LENGTH	CLASS D 15"
			TYPE II SQ YD
0.50	12	8	10.7
0.60	12	8	10.7
0.80	12	8	10.7
SUBTOTAL			32.0
12% SUBTOTAL FAP 690			9.3
TOTAL FAP 690			87

CLASS D PATCHING FAP 692 (IL 160) NB				
MILE	WIDTH	LENGTH	CLASS D 12"	
			TYPE II	TYPE III
			SQ YD	
0.04	12	8	10.7	
0.10	12	8	10.7	
0.56	12	8	10.7	
0.60	12	8	10.7	
0.63	12	10	13.3	
0.72	12	8	10.7	
0.77	12	6	8.0	
0.88	12	8	10.7	
1.00	12	8	10.7	
1.26	12	6	8.0	
1.27	12	6	8.0	
1.32	12	10	13.3	
1.60	12	8	10.7	
1.68	12	8	10.7	
1.80	12	8	10.7	
2.00	12	6	8.0	
2.02	12	6	8.0	
2.10	12	8	10.7	
2.20	12	6	8.0	
2.30	12	6	8.0	
2.57	12	8	10.7	
2.82	12	6	8.0	
5.30	12	6	8.0	
5.75	12	6	8.0	
5.90	12	10	13.3	
6.25	12	10	13.3	
6.40	12	10	13.3	
6.56	12	8	10.7	
6.65	12	10	13.3	
6.80	12	6	8.0	
6.87	12	8	10.7	
6.88	12	8	10.7	
7.00	12	8	10.7	
7.10	12	6	8.0	
7.17	12	12		16.0
7.20	12	8	10.7	
7.40	12	8	10.7	
7.45	12	8	10.7	
7.60	12	8	10.7	
7.82	12	10	13.3	
7.92	12	6	8.0	
8.05	12	6	8.0	
8.40	12	8	10.7	
8.51	12	8	10.7	
8.60	12	8	10.7	
8.80	12	8	10.7	
8.90	12	8	10.7	
9.03	12	8	10.7	
9.10	12	8	10.7	
9.25	12	8	10.7	
SUBTOTAL			504	16

CLASS D PATCHING FAP 692 (IL 160) SB				
MILE	WIDTH	LENGTH	CLASS D 12"	
			TYPE II	TYPE III
			SQ YD	
0.04	12	8	10.7	
0.10	12	8	10.7	
0.25	16	8	14.2	
0.63	12	10	13.3	
0.72	12	8	10.7	
0.77	12	6	8.0	
0.88	12	8	10.7	
1.00	12	8	10.7	
1.10	12	8	10.7	
1.14	12	6	8.0	
1.26	12	6	8.0	
1.27	12	6	8.0	
1.32	12	10	13.3	
1.40	12	8	10.7	
1.80	12	8	10.7	
2.00	12	6	8.0	
2.02	12	6	8.0	
2.10	12	8	10.7	
2.20	12	6	8.0	
2.30	12	6	8.0	
2.57	12	8	10.7	
2.82	12	6	8.0	
5.30	12	6	8.0	
5.75	12	6	8.0	
5.90	12	10	13.3	
6.25	12	10	13.3	
6.40	12	10	13.3	
6.56	12	8	10.7	
6.65	12	10	13.3	
6.80	12	6	8.0	
6.87	12	8	10.7	
6.88	12	8	10.7	
7.00	12	8	10.7	
7.10	12	6	8.0	
7.17	12	12		16.0
7.20	12	8	10.7	
7.40	12	8	10.7	
7.45	12	8	10.7	
7.60	12	8	10.7	
7.82	12	10	13.3	
7.92	12	6	8.0	
8.05	12	6	8.0	
8.40	12	8	10.7	
8.51	12	8	10.7	
8.60	12	8	10.7	
8.80	12	8	10.7	
8.90	12	8	10.7	
9.03	12	8	10.7	
9.10	12	8	10.7	
9.25	12	8	10.7	
SUBTOTAL			505	16
12% SUBTOTAL FAP 692			121.1	3.8
TOTAL FAP 692			1130	36

ROUTE	PARTIAL DEPTH REMOVAL 3"			PARTIAL DEPTH PATCHING TON	CLASS D PATCHES 15"		CLASS D PATCHES 12"	
	TYPE II	TYPE III	TYPE IV		TYPE II	TYPE III	TYPE III	
	SQ YD				SQ YD		SQ YD	
FAP 793 (US 40)	1935	1687	18991	3799				
FAP 690 (IL 160)	336	299		107	87			
FAP 692 (IL 160)	2407	642	2920	1003		1130	36	
TOTAL	4679	2628	21911	4909	87	1130	36	

FILE NAME =	USER NAME = nivesa	DESIGNED - GEL	REVISED -
et:\pw\work\p1dot\nivesa\d0388125\d876h21-sh-t-pln.dgn		DRAWN - LAC	REVISED -
PLOT SCALE = 100.0000' / in.		CHECKED - MDP	REVISED -
PLOT DATE = 4/11/2014		DATE - 3/20/2012	REVISED -

**STATE OF ILLINOIS
DEPARTMENT OF TRANSPORTATION**

SCHEDULE OF QUANTITIES			
SCALE:	SHEET NO.	OF SHEETS	STA. TO STA.

• FAP 793/690/692

F.A.P. RTE.	SECTION	COUNTY	TOTAL SHEETS	SHEET NO.
•	(31,37,32,39,S-1,12,45,86)I-1	MADISON	12	12
				CONTRACT NO. 76H21
ILLINOIS FED. AID PROJECT				