

F.A.P. RTE.	SECTION	COUNTY	TOTAL SHEETS	SHEET NO.
885	110B-1	JOHNSON	52	1
D-99-004-12		ILLINOIS	CONTRACT NO. 78279	

STATE OF ILLINOIS
DEPARTMENT OF TRANSPORTATION
DIVISION OF HIGHWAYS

**PROPOSED
HIGHWAY PLANS**

FAP ROUTE 885 (IL-146)
SECTION 110B-1
PROJECT ACF-0885 (049)
JOHNSON COUNTY
C-99-005-12
STRUCTURE REPLACEMENT
OVER BAY CREEK

INDEX OF SHEETS

SHEET NO.	DESCRIPTION
1	COVER SHEET
2	GENERAL NOTES & STANDARDS
3 - 6	SUMMARY OF QUANTITIES
7	TYPICAL SECTIONS
8	SCHEDULES OF QUANTITIES
9	ALIGNMENT, TIES, & BENCHMARKS
10	REMOVAL PLAN
11 - 12	PLAN AND PROFILE SHEET
13	TRAFFIC CONTROL AND STAGING
14	WIDE LOAD DETOUR SIGNING
15	TEMPORARY EROSION CONTROL PLAN
16	RIGHT-OF-WAY SHEET
17	DRAINAGE DETAILS & SCHEDULES
18 - 19	DISTRICT 9 STANDARDS
20 - 23	CROSS SECTIONS
24 - 52	BRIDGE PLANS

FOR LIST OF HIGHWAY STANDARDS, SEE SHEET NO. 2

UTILITY NOTE

THE LOCATIONS OF THOSE BURIED AND ABOVEGROUND UTILITIES SHOWN ARE APPROXIMATE, ARE SHOWN FOR CONTRACTOR INFORMATIONAL USE ONLY, AND ARE NOT TO BE REFERENCED FOR CONSTRUCTION PURPOSES. THE IMPLIED PRESENCE OR ABSENCE OF UTILITIES IS NOT TO BE CONSTRUED BY THE OWNER, ENGINEER, CONTRACTOR, OR SUBCONTRACTORS TO BE AN ACCURATE AND COMPLETE REPRESENTATION OF UTILITIES THAT MAY OR MAY NOT EXIST ON THE CONSTRUCTION SITE. BURIED AND ABOVEGROUND UTILITY LOCATION, IDENTIFICATION, AND MARKING ARE THE SOLE RESPONSIBILITY OF THE CONTRACTOR. REROUTING, DISCONNECTION, PROTECTION, ETC. OF AN UTILITIES MUST BE COORDINATED BETWEEN THE CONTRACTOR, UTILITY COMPANY, AND OWNER. SITE SAFETY, INCLUDING THE AVOIDANCE OF HAZARDS ASSOCIATED WITH BURIED AND ABOVEGROUND UTILITIES, REMAIN THE SOLE RESPONSIBILITY OF THE CONTRACTOR



Know what's below.
Call before you dig.

J.U.L.I.E.
JOINT UTILITY LOCATION INFORMATION FOR EXCAVATION
1-800-892-0123
OR 811

PROJECT MANAGER - DAVID PICHE (618) 549-2171
CONTRACT NO. 78279

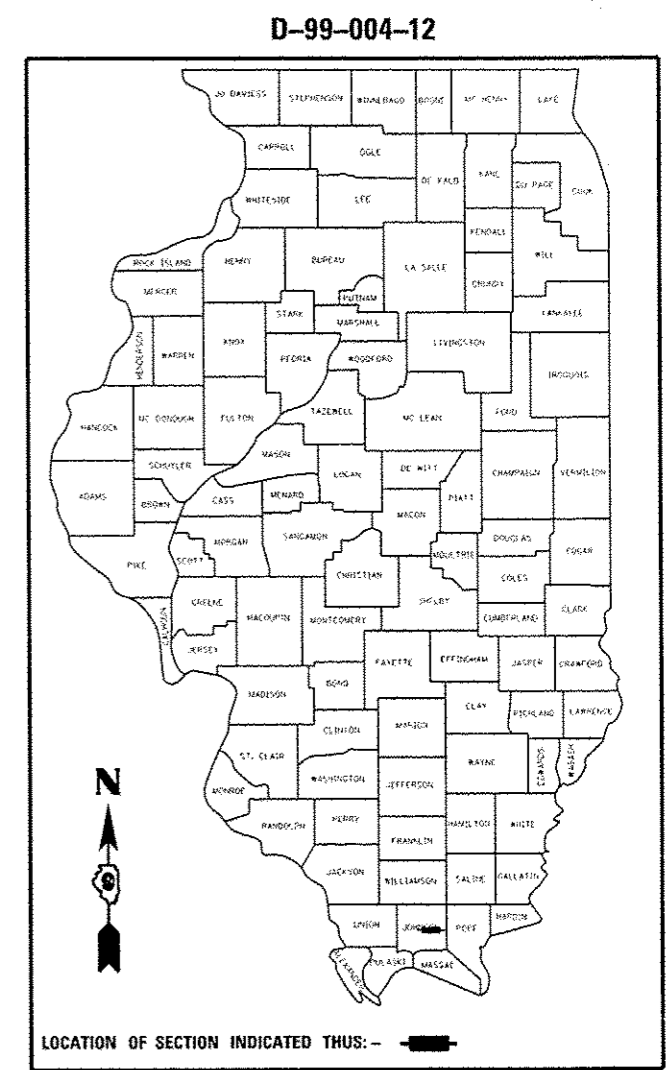

FUNCTIONAL CLASSIFICATION
MINOR ARTERIAL (NON-URBAN)
2011 ADT = 1170
P.V. = 94.9% S.U. = 3.4% M.U. = 1.7%
ROAD DISTRICT #1

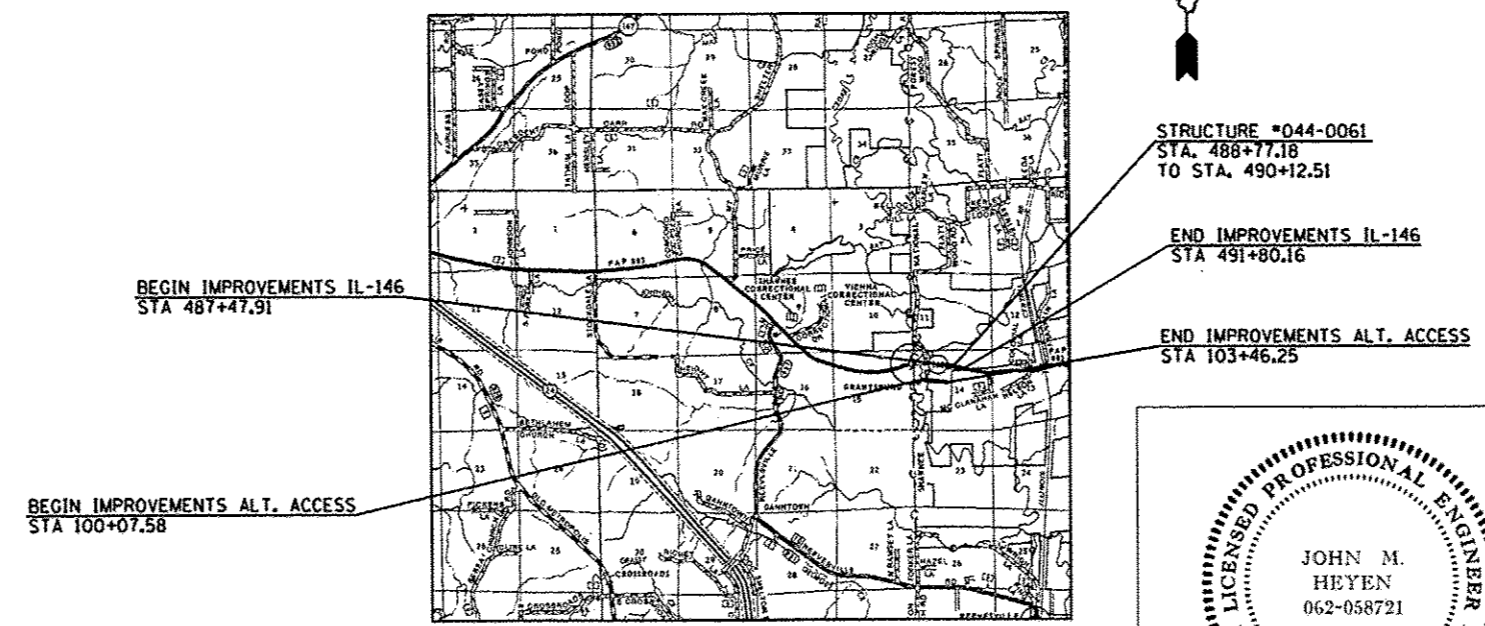

AREA LOCATION PLAN



GROSS LENGTH = 770.92 FT. = 0.146 MILES
NET LENGTH = 770.92 FT. = 0.146 MILES



STRUCTURE #044-0061
STA. 488+77.18
TO STA. 490+12.51

END IMPROVEMENTS IL-146
STA 491+80.16

END IMPROVEMENTS ALT. ACCESS
STA 103+46.25

JOHN M. HEYEN
062-058721

SIGNATURE: *J. M. Heyen*
DATE SIGNED: 3-7-14
LICENSE EXP.: 11-30-15

© Copyright Hanson Professional Services Inc. 2014



STATE OF ILLINOIS
DEPARTMENT OF TRANSPORTATION
DIVISION OF HIGHWAYS

SUBMITTED March 18, 2014

Jeffrey S. Keenan
DEPUTY DIRECTOR OF HIGHWAYS, REGION ENGINEER

May 9, 2014
John D. Baranzelli, P.E.
ENGINEER OF DESIGN AND ENVIRONMENT

May 9, 2014
Omer Osman, P.E.
DIRECTOR OF HIGHWAYS, CHIEF ENGINEER

**PRINTED BY THE AUTHORITY
OF THE STATE OF ILLINOIS**