

**GENERAL NOTES**

- GRADE RAISE OF ROADWAY WILL BE PERFORMED UNDER STANDARD 701201
- ACCESS ROAD SHOULD BE FINISHED DURING STAGE 1 OF CONSTRUCTION

**STAGE 1 CONSTRUCTION**

**LEGEND**

- [Hatched Box] APPROACH SLAB REMOVAL
- [Diagonal Lines Box] STRUCTURE REMOVAL
- [Cross-hatched Box] IMPACT ATTENUATOR

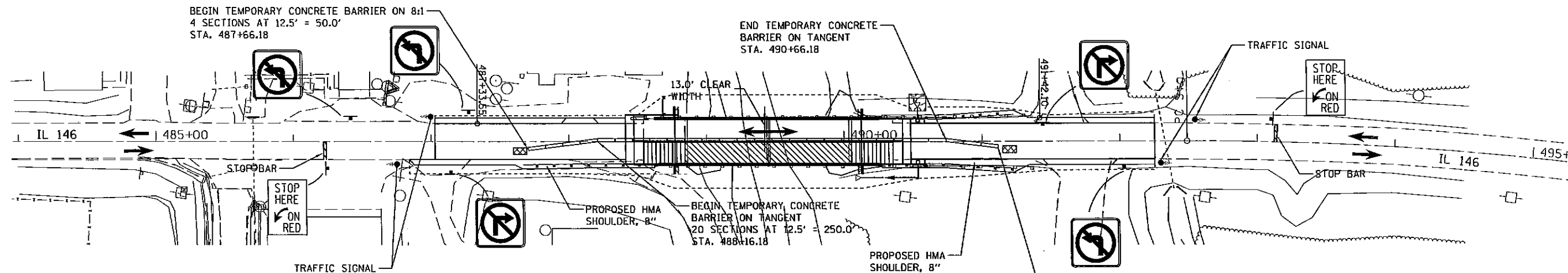
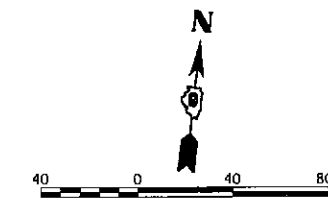

**GENERAL NOTES**

- GRADE RAISE OF ROADWAY WILL BE PERFORMED UNDER STANDARD 701201

- REFER TO STANDARDS:
- 701001 - OFF-RD OPERATIONS, 2L, 2W, MORE THAN 15' AWAY
  - 701006 - OFF-RD OPERATIONS, 2L, 2W, 15' TO 24" FROM PAVEMENT EDGE
  - 701011 - OFF-RD MOVING OPERATIONS, 2L, 2W, DAY ONLY
  - 701201 - LANE CLOSURE, 2L, 2W, DAY ONLY, FOR SPEEDS >= 45 MPH
  - 701301 - LANE CLOSURE, 2L, 2W, SHORT TIME OPERATIONS
  - 701321 - LANE CLOSURE, 2L, 2W, BRIDGE REPAIR WITH BARRIER
  - 701326 - LANE CLOSURE, 2L, 2W, PAVEMENT WIDENING, FOR SPEEDS >= 45 MPH
  - 701901 - TRAFFIC CONTROL DEVICES
  - 704001 - TEMPORARY CONCRETE BARRIER
  - 720001 - SIGN PANEL MOUNTING DETAILS
  - 720006 - SIGN PANEL ERECTION DETAILS

**STAGE 2 CONSTRUCTION**

**LEGEND**

- [Hatched Box] APPROACH SLAB REMOVAL
- [Diagonal Lines Box] STRUCTURE REMOVAL
- [Cross-hatched Box] IMPACT ATTENUATOR

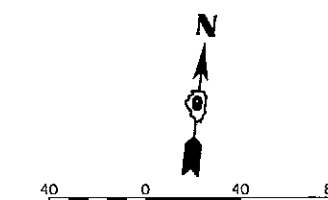

LAYOUT	B/C	2/7/11
DRAWN	B/C	2/7/11
REVIEWED	MH	2/28/11

FILE NAME =	USER NAME = halsteadtw	DESIGNED - CAD	REVISED -
D:\Program Development\Studies and Plans\Bridges\Hydraulics\Work\NSN 044-0820\Submittals\Drawings\Submittal\CAD\4000_Files\097827		CHECKED - MH	REVISED -
MODEL = #400EL3	PLOT SCALE = 79.9998' / in.	DATE - 02/17/14	REVISED -
	PLOT DATE = 3/24/2014		

STATE OF ILLINOIS  
DEPARTMENT OF TRANSPORTATION

IL-146 TRAFFIC CONTROL AND STAGING

SCALE: SHEET NO. OF SHEETS

F.A.P. RTE.	SECTION	COUNTY	TOTAL SHEETS	SHEET NO.
885	1108-1	JOHNSON	52	13
FED. ROAD DIST. NO. [ILLINOIS] FED. AID PROJECT			CONTRACT NO. 78279	