

**GENERAL NOTES**

The deck surface shall have its final finish lined according to Article 420.09(a)(1) of the Standard Specifications. Cost Included with Concrete Superstructure.  
 Reinforcement bars designated (E) shall be epoxy coated.  
 All structural steel shall conform to AASHTO M 270 Grade 36 unless otherwise noted. No field welding is permitted except as specified in the contract documents.  
 Prior to pouring the new concrete section, all heavy or loose rust, loose mill scale, and other loose or potentially detrimental foreign material shall be removed from the surfaces in contact with concrete. Tightly adhered paint may remain unless otherwise noted. Removal shall be accomplished by methods that will not damage the steel and the cost will be included in CONCRETE REMOVAL.  
 Plan dimensions and details relative to existing plans are subject to nominal construction variations. The Contractor shall field verify existing dimensions and details affecting new construction and make necessary approved adjustments prior to construction or ordering of materials. Such variations shall not be cause for additional compensation for a change in scope of the work, however, the Contractor will be paid for the quantity actually furnished at the unit price bid for the work.  
 Existing reinforcement bars extending into the removal area shall be cleaned, straightened, and incorporated into the new construction. Any reinforcement bars that are damaged during concrete removal shall be replaced with an approved bar splicer or anchorage system. Cost included in CONCRETE REMOVAL.  
 Joint openings shall be adjusted according to Article 520.04 of the Std. Specs. when the deck is poured at an ambient temperature other than 50°F.  
 Existing structural steel shall only be cleaned and painted as required by the Special Provision "Cleaning and Painting Adjacent Areas of Existing Steel Structures." The existing structural steel coating contains lead. The Contractor shall take appropriate precautions to deal with the presence of lead on this project.  
 Fasteners shall be AASHTO M164 Type 1, mechanically galvanized bolts. Bolts - 3/4" φ, 1/8" φ holes, unless otherwise noted.  
 The exterior surfaces of the floor drains shall be painted with the finish coat as specified in the special provisions for Cleaning and Painting New Steel Structures. The exterior surfaces of the drain shall be cleaned and given a washcoat pretreatment in accordance with Society of Protective Coatings Spec. SSPC-SPI & SSPC Paint 27 prior to painting. The color of the exterior surfaces shall be Blue (Munsell No. 10B 3/6). Cost included with Floor Drain Extensions.  
 All structural steel shall be shop painted with inorganic zinc rich primer per AASHTO M300, Type 1. Cost included with Floor Drain Extensions.

**SCOPE OF WORK**

- 1) Setup TC&P 701402 with barrier for Stage I work in the EB & WB driving lanes of I-64.
- 2) Perform joint reconstruction.
- 3) Adjust TC&P 701402 for Stage II with barrier work in the EB & WB passing lanes of I-64.
- 4) Perform joint reconstruction.
- 5) Floor Drains
- 6) Structural Repair of Concrete
- 7) Remove TC&P 701402.

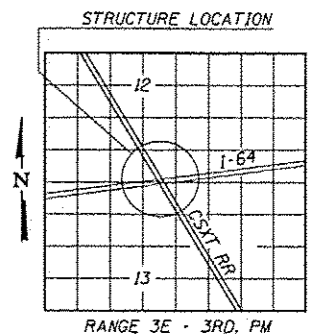

**TOTAL BILL OF MATERIAL**

ITEM	UNIT	QUANTITY
Concrete Removal	Cu. Yd.	33.8
Concrete Superstructure	Cu. Yd.	33.4
Reinforcement Bars, Epoxy Coated	Pound	4800
Bar Splicers	Each	56
Preformed Joint Strip Seal	Foot	224
Floor Drain Extension	Each	16
Plug Existing Deck Drains	Each	12
Structural Repair of Concrete (Depth Equal to or Less Than 5 Inches)	Sq. Ft.	79

**GENERAL PLAN**

**FAI 64 OVER CSXT RR**  
**SECTION D9 CM BRIDGE REPAIR 2014-2**  
**JEFFERSON COUNTY**  
**STRUCTURE NUMBER 041-0070 (EB) & 041-0071 (WB)**

**DESIGN STRESSES**

ORIGINAL CONSTRUCTION FIELD UNITS	NEW CONSTRUCTION FIELD UNITS
$f_c = 1,400$ psi (Super. & Sub.)	$f_c = 3,500$ psi
$f_s = 20,000$ psi (Reinf.)	$f_s = 60,000$ psi (Reinf.)
$f_s = 20,000$ psi (Struct.) A-36	
$v_c = 75$ psi (Figs.)	
$n = 10$	
$\frac{1}{4}$ Defl. = L/1000	
Loading HS20-44& All.	

**ELEVATION**

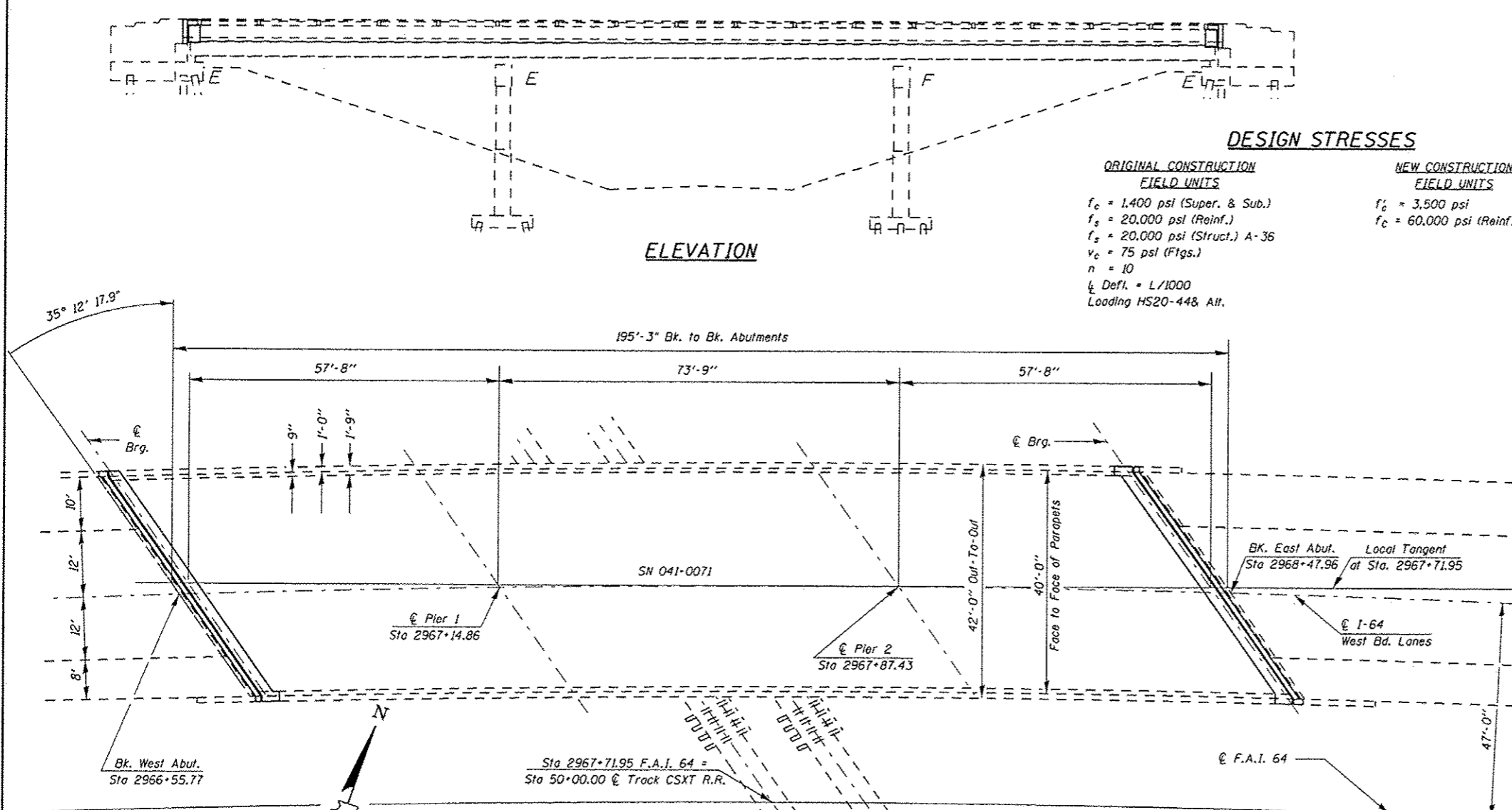

**PLAN**

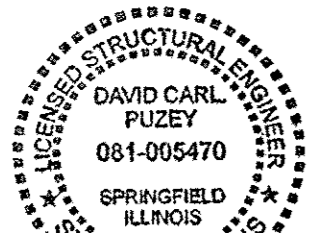
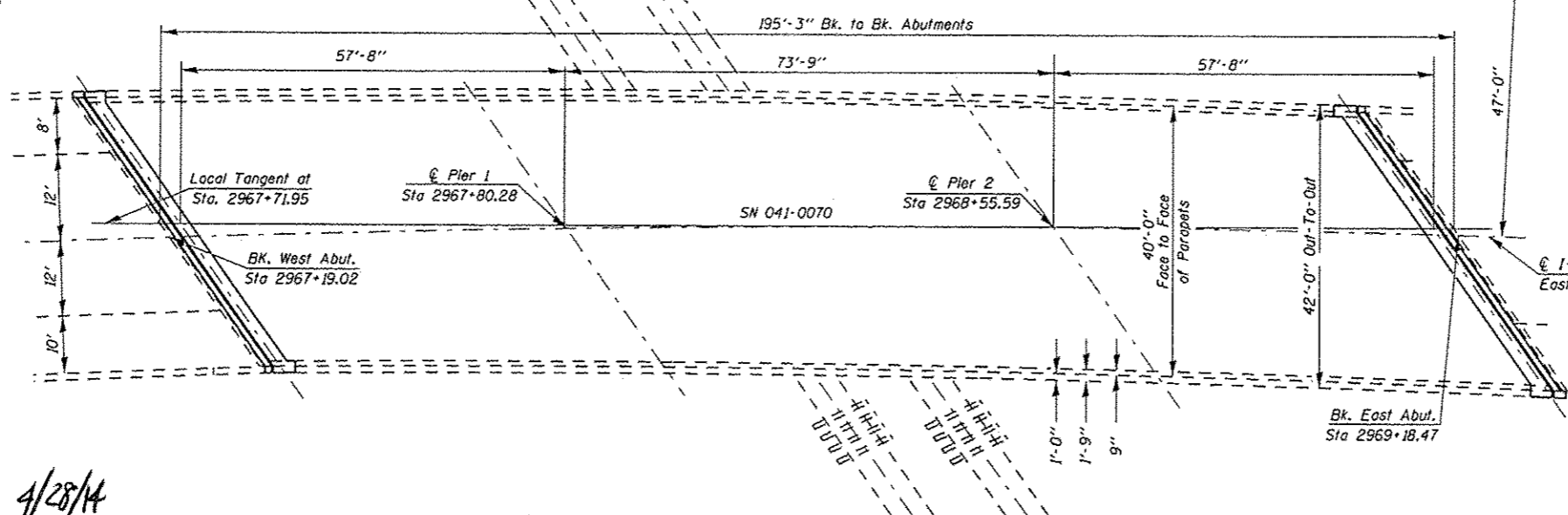

*David Carl Puzey*  
 Expires 11/30/14

FILE NAME: c:\p-work\pvidot\adamsam\10379162\7837	USER NAME: *USER*	DESIGNED: <b>AMA</b>	REVISED: -	<b>STATE OF ILLINOIS DEPARTMENT OF TRANSPORTATION</b>	<b>GENERAL PLAN AND ELEVATION</b>			F.A.I. RTE. 64	SECTION	COUNTY	TOTAL SHEETS	SHEET NO.
	ahs-plandgn	DRAWN: -	REVISED: -		<b>SN 041-0070 &amp; 041-0071</b>					JEFFERSON	12	4
	PLOT SCALE = 30.0000' / 1"	CHECKED: <b>SJR</b>	REVISED: -		SCALE:	SHEET 1	OF	SHEETS	STA.	TO STA.	ILLINOIS FED. AID PROJECT	
	PLOT DATE = 4/14/2014	DATE: -	REVISED: -							CONTRACT NO. 78371		