

STATE OF ILLINOIS
DEPARTMENT OF TRANSPORTATION
DIVISION OF HIGHWAYS

**PROPOSED
HIGHWAY PLANS**

FAP 322 ROUTE US 51
SECTION 4RS-5
PROJECT ACF-0322 (105)
PATCHING AND RESURFACING
PERRY COUNTY

C-99-039-14

F.A.P. RTE.	SECTION	COUNTY	TOTAL SHEETS	SHEET NO.
322	4RS-5	PERRY	24	1
		ILLINOIS	CONTRACT NO. 78413	

FOR INDEX OF SHEETS, SEE SHEET NO. 3

US 51 (FAP 332)
TRAFFIC DATA
POPLAR ST.

	(2013)	(2034)
PC =	5,420	6,680
SU =	250	310
MU =	130	160
ADT =	5,800	7,150

US 51 (FAP 332)
TRAFFIC DATA
WASHINGTON ST.

	(2013)	(2034)
PC =	12,120	14,935
SU =	500	615
MU =	180	220
ADT =	12,800	15,770

D-99-033-14

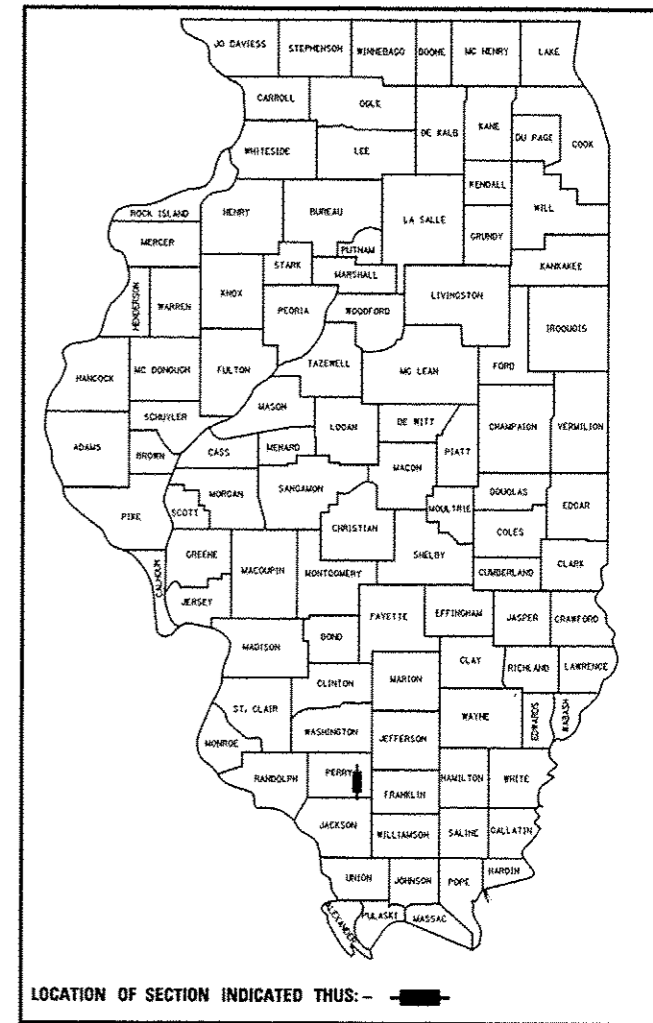

END PROJECT
STA. 100+21
US 51 (HICKORY ST.)

PAVING OMISSION
SN 073-0033
STA. 2+15 TO STA. 16+20

BEGIN PROJECT
STA. 977+00
US 51 (WASHINGTON ST.)

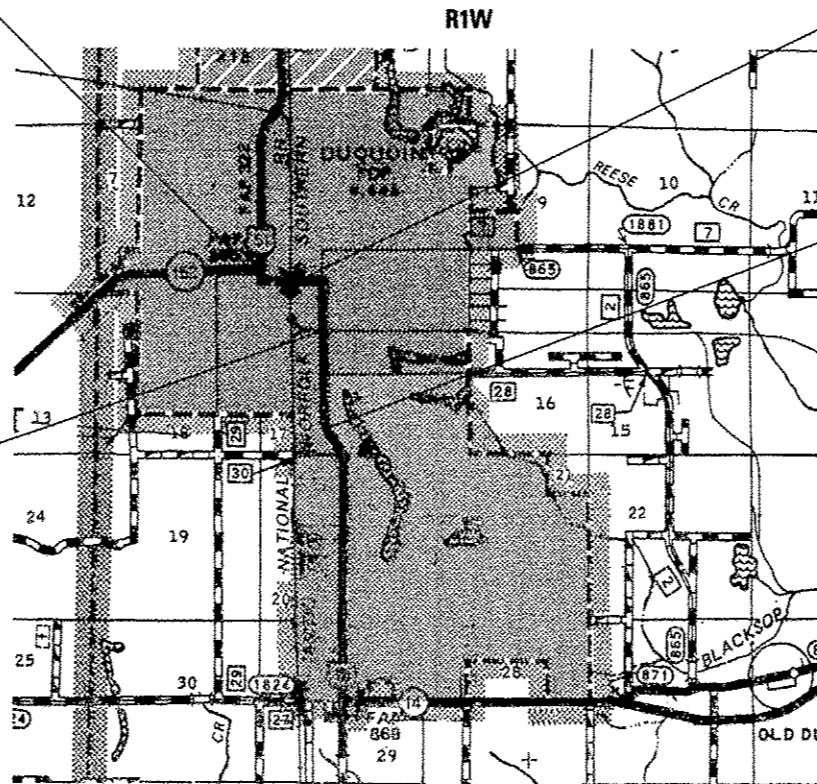

OMISSION
RAILROAD
STA. 1006+39 TO STA. 1006+47

TOWNSHIP: DUQUOIN

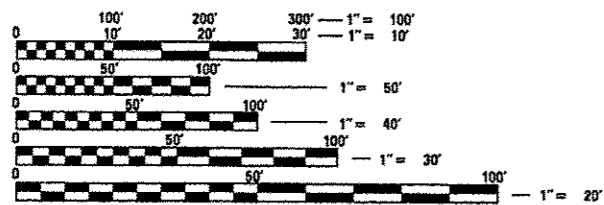

FULL SIZE PLANS HAVE BEEN PREPARED USING STANDARD ENGINEERING SCALES. REDUCED SIZED PLANS WILL NOT CONFORM TO STANDARD SCALES. IN MAKING MEASUREMENTS ON REDUCED PLANS, THE ABOVE SCALES MAY BE USED.

J.U.L.I.E.
JOINT UTILITY LOCATION INFORMATION FOR EXCAVATION
1-800-892-0123
OR 811

PROJECT ENGINEER: CHARLES STEIN
DESIGNER: MELISSA COLE

CONTRACT NO. 78413

GROSS LENGTH = 6,515 FT. = 1.2 MILE
NET LENGTH = 5,102 FT. = 0.97 MILE

STATE OF ILLINOIS
DEPARTMENT OF TRANSPORTATION
DIVISION OF HIGHWAYS

SUBMITTED *March 19 20 2014*

Jeffrey A. Keenan
DEPUTY DIRECTOR OF HIGHWAYS, REGION ENGINEER

May 9 20 14
John D. Baranzelli PE
ENGINEER OF DESIGN AND ENVIRONMENT

May 9 20 14
Omer Osman PE
DIRECTOR OF HIGHWAYS, CHIEF ENGINEER

PRINTED BY THE AUTHORITY
OF THE STATE OF ILLINOIS