

DEPARTMENT OF TRANSPORTATION
DIVISION OF HIGHWAYS

PLANS FOR PROPOSED FEDERAL AID HIGHWAY

HPP FUNDING
VILLAGE OF BOURBONNAIS
6000N (BOURBONNAIS PARKWAY)
SECTION 04-00066-00-WR
PROJECT NO. HPP-4066 (002)
JOB NO. C-93-108-09

1	COVER SHEET, INDEX OF SHEETS AND STANDARDS
2	GENERAL NOTES, PAVEMENT DESIGN AND LEGEND
3	SUMMARY OF QUANTITIES
4	TYPICAL ROADWAY CROSS SECTIONS & STAGING DIAGRAM
5	SCHEDULE OF QUANTITIES
6	STORM SEWER STRUCTURE SCHEDULE
7-9	PLAN & PROFILE
10	STAGING PLAN (STAGE 1)
11	STAGING PLAN (STAGE 2)
12	STRIPING AND SIGNAGE PLAN
13	STRIPING AND SIGNAGE DETAILS
14-16	STORM WATER POLLUTION PREVENTION PLAN
17	STORM WATER POLLUTION PREVENTION DETAILS
18-21	CROSS SECTIONS

STANDARDS

000001-06	STANDARD SYMBOLS, ABBREVIATIONS AND PATTERNS
280001-07	TEMPORARY EROSION CONTROL SYSTEMS
424001-07	PERPENDICULAR CURB RAMPS FOR SIDEWALKS
602301-04	INLET, TYPE A
602306-03	INLET, TYPE B
602406-06	MANHOLE, TYPE A, 1.8M (6') DIAMETER
602416-04	MANHOLE, TYPE A, 2.4M (8') DIAMETER
602601-03	PRECAST REINFORCED CONCRETE FLAT SLAB TOP
602701-02	MANHOLE STEPS
604001-03	FRAME AND LIDS, TYPE 1
604006-04	FRAME AND GRATE, TYPE 3
606001-05	CONCRETE CURB TYPE B AND COMBINATION CONCRETE CURB AND GUTTER
701326-04	LANE CLOSURE, 2L, 2W, PAVEMENT WIDENING, FOR SPEEDS ≥ 45 MPH
701502-06	URBAN LANE CLOSURE, 2L, 2W, WITH BIDIRECTIONAL LEFT TURN LANE
701901-03	TRAFFIC CONTROL DEVICES
720001-01	SIGN PANEL MOUNTING DETAILS
720006-04	SIGN PANEL ERECTION DETAILS
720011-01	METAL POSTS FOR SIGNS, MARKERS, AND DELINEATORS
720021-02	SIGN PANELS, EXTRUDED ALUMINUM TYPE
780001-04	TYPICAL PAVEMENT MARKINGS
BLR 22-7	TYPICAL APPLICATION OF TRAFFIC CONTROL DEVICES FOR CONSTRUCTION ON RURAL LOCAL HIGHWAYS (2L,2W RURAL TRAFFIC) (ROAD CLOSED TO THRU TRAFFIC)

DESIGN DESIGNATION - MINOR ARTERIAL

DESIGN SPEED = 50 MPH
6000N(BOURBONNAIS PARKWAY) - STA. 53+00 TO STA. 62+50
2014 ADT = 856 M.U. 5% S.U. 10% P.V. 85%
DESIGN 2034 ADT = 11700 M.U. 5% S.U. 10% P.V. 85%
SEE SHEET 2 FOR PAVEMENT DESIGN

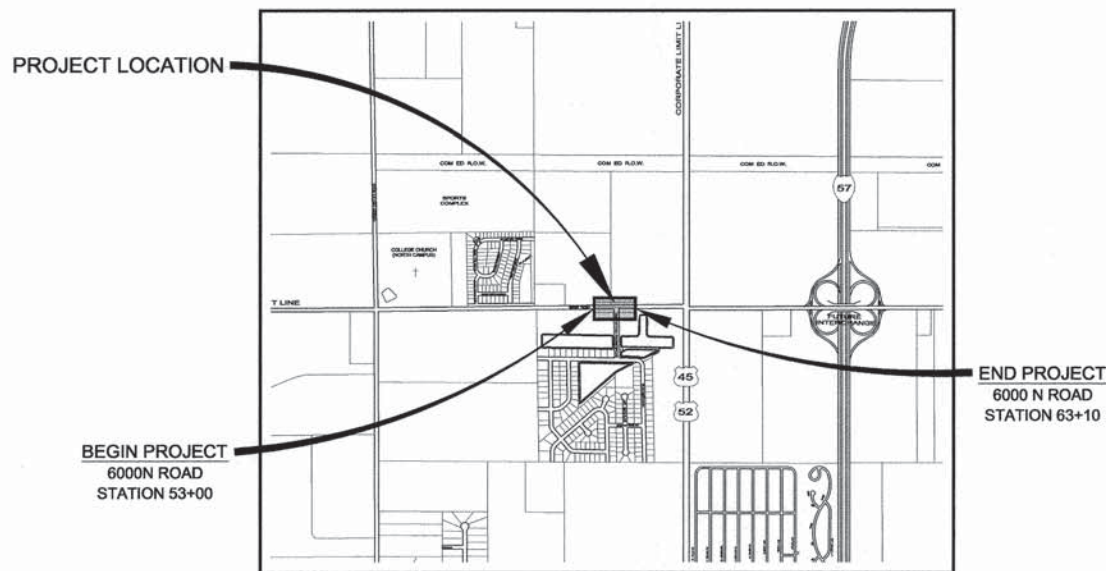

LOCATION MAP
NOT TO SCALE

GROSS LENGTH OF IMPROVEMENT = 950 FEET = 0.18 MILES
NET LENGTH OF IMPROVEMENT = 950 FEET = 0.18 MILES

STANDARD SCALES

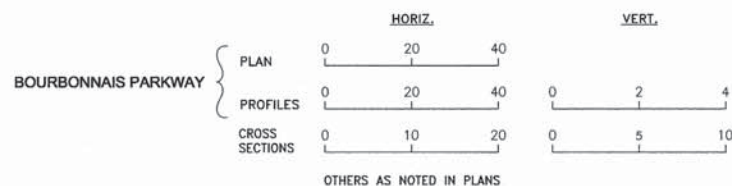

CALL J.U.L.I.E. BEFORE YOU DIG
(Joint Utility Locating Information For Excavators)
PH.# 1-800-892-0123



PREPARED IN ACCORDANCE WITH THE POLICIES OF THE LOCAL ROADS MANUAL

STATE OF ILLINOIS
DEPARTMENT OF TRANSPORTATION
DIVISION OF HIGHWAYS

APPROVED April 3, 2014
Paul Schol
VILLAGE PRESIDENT, VILLAGE OF BOURBONNAIS

PASSED 4/8, 2014
Don R. E.
DISTRICT 3 ENGINEER OF LOCAL ROADS & STREETS

RELEASED FOR BID BASED ON LIMITED REVIEW 4/8, 2014
Paul A. Witte
DEPUTY DIRECTOR OF HIGHWAYS, REGION 2 ENGINEER

SRM 4-3-14
STEVEN R. McBURNET P.E.# 062-058252 DATE
EXPIRATION DATE OF P.E. LICENSE: 11-30-15



REVISIONS				
NO.	DATE	BY	GENERAL DESCRIPTION	SHEETS CHANGED
1	3/25/14	NRD	PER I.D.O.T. REVIEW	ALL

SECTION	COUNTY	TOTAL SHEETS	SHEET NO.
04-00066-00-WR	KANKAKEE	21	1
CONTRACT NO. 87398			
FED. ROAD DIST. NO. ILLINOIS FED. AID PROJECT			
FAU6226 04-00066-00-WR			
 Tyson ENGINEERING 367 South Schuyler Avenue Kankakee, Illinois 60901 Phone (815) 932-7400			
This document and the ideas and designs incorporated herein, as an instrument of professional service, is the property of Tyson Engineering Inc. and is not to be used in whole or in part, for any other project without written authorization of Tyson Engineering Inc. Do not scale drawings. Use dimensions only. Contractor shall be responsible for verifying all dimensions. Information herein and herein is confidential.			
REVISIONS			
NO.	DATE	BY	DESCRIPTION
1	3/25/14	NRD	PER I.D.O.T. REV.
COVER SHEET, INDEX OF SHEETS AND STANDARDS			
PROJECT: VILLAGE OF BOURBONNAIS 6000 NORTH ROAD IMPROVEMENTS PHASE I BOURBONNAIS, ILLINOIS			
SECTION 04-00066-00-WR			
DATE:	2/14/14	JOB NO.	E09108
SCALE:	N/A	FILE NO.	
DRAWN BY:	NRD	SHEET	1
CHECKED BY:	SRM		21

GENERAL NOTES

LEGEND

- DATUM USED FOR SURVEY IS U.S.G.S.
- ALL STATIONING IS ALONG CENTERLINE OF ROADWAY, EXCEPT AS OTHERWISE NOTED.
- ACCESS TO ENTRANCES - ACCESS TO ENTRANCES SHALL BE MAINTAINED BY THE USE OF TEMPORARY SURFACE AGGREGATE IN ACCORDANCE WITH ARTICLE 107.09 OF THE STANDARD SPECIFICATIONS. HOWEVER THE COST OF FURNISHING, PLACING AND REMOVING THE TEMPORARY SURFACE AGGREGATE WILL BE PAID FOR AT THE CONTRACT PRICE PER SQ.YD. FOR AGGREGATE SURFACE COURSE TYPE A AND NO OTHER COMPENSATION WILL BE ALLOWED.
- THE THICKNESS OF BITUMINOUS MIXTURES SHOWN ON THE PLANS IS THE NOMINAL THICKNESS. DEVIATION FROM THE NOMINAL THICKNESS WILL BE PERMITTED WHEN SUCH DEVIATIONS OCCUR DUE TO IRREGULARITIES IN THE EXISTING SURFACE OR BASE ON WHICH THE BITUMINOUS MIXTURE IS PLACED.
- EXCEPT AS NOTED IN THE PLANS, PAVEMENT GRADES SHOWN ARE AT THE TOP OF PAVEMENT SURFACES.
- ALL EXCAVATION UNDER PAVEMENT, SIDEWALK, AND CURB & GUTTER SHALL BE BACKFILLED AND COMPACTED WITH MATERIAL MEETING THE REQUIREMENTS OF SECTION 209. SEPARATE PAYMENT FOR TRENCH BACKFILL SHALL BE MADE ONLY WHEN SPECIFIED IN THE PLANS.
- THE ENGINEER SHALL BE THE SOLE JUDGE CONCERNING CURING TIME FOR THE VARIOUS BITUMINOUS LIFTS.
- ONLY THOSE TREES DESIGNATED BY THE ENGINEER OR LISTED IN THE TREE REMOVAL SCHEDULE SHALL BE REMOVED. THE CONTRACTOR WILL PROTECT ALL REMAINING TREES FROM DAMAGE DUE TO HIS OPERATIONS.
- ALL SAWCUTTING OF EXISTING PAVEMENT SHALL BE CONSIDERED INCIDENTAL TO THE CONTRACT. THE MINIMUM SAW CUT DEPTH IN THE PAVEMENT SHALL BE 2 INCHES, UNLESS OTHERWISE SPECIFIED IN A DETAIL IN THE PLANS.
- THE CONTRACTOR SHALL PROVIDE TEMPORARY DRAINAGE.
- ALL REQUIRED SAW CUTTING SHALL BE INCIDENTAL TO THE REMOVAL PAY ITEM INVOLVED.

- FOR NEW CONSTRUCTION, PLACE SIDEWALK RAMPS FOR THE HANDICAPPED (STD 2356) AT ALL LOCATIONS WHERE PROPOSED SIDEWALK ABUTS CURB AT STREET ENTRANCES.
- THE EXISTING ROAD SIGNS THAT INTERFERE WITH CONSTRUCTION SHALL BE REMOVED OR RELOCATED AS DIRECTED BY THE ENGINEER. AFTER THE CONSTRUCTION IS COMPLETED, THE CONTRACTOR SHALL REPLACE THE SIGNS AS DIRECTED BY THE ENGINEER. THIS WORK WILL NOT BE PAID FOR SEPARATELY BUT SHALL BE CONSIDERED INCIDENTAL TO THE CONTRACT AND NO COMPENSATION WILL BE ALLOWED.
- ABANDONED UNDERGROUND UTILITY ITEMS WHICH CONFLICT WITH CONSTRUCTION SHALL BE DISPOSED OUTSIDE THE LIMITS OF THE RIGHT OF WAY ACCORDING TO ARTICLE 202.03 OF THE STANDARD SPECIFICATIONS, AND AS DIRECTED BY THE ENGINEER. THIS WORK WILL NOT BE PAID FOR SEPARATELY BUT SHALL BE CONSIDERED INCIDENTAL TO EARTH EXCAVATION AND NO ADDITIONAL COMPENSATION WILL BE ALLOWED.
- ANY REFERENCE TO A STANDARD IN THESE PLANS SHALL BE INTERPRETED TO MEAN THE EDITION AS INDICATED BY THE SUB-NUMBER LISTED IN THE INDEX OF SHEETS, OR THE COPY OF THE STANDARD INCLUDED IN THESE PLANS.
- THE CONTRACTOR SHALL BE RESPONSIBLE FOR PROTECTING UTILITY PROPERTY FROM CONSTRUCTION OPERATIONS AS OUTLINED IN ARTICLE 107.31 OF THE STANDARD SPECIFICATIONS. THE JULIE NUMBER IS 1-800-892-0123. A MINIMUM OF FORTY EIGHT (48) HOURS ADVANCE NOTICE IS REQUIRED.
- ALL WATER MAINS SHALL BE PROTECTED FROM CONTAMINATION. STATE CODE SECTION 653.119 EXPLAINS THE METHODS OF PROTECTION AND WHEN THEY ARE REQUIRED.
- PROTECTIVE COAT SHALL BE APPLIED TO THE SURFACES OF NEW CONCRETE ACCORDING TO ARTICLES 420.18 AND/OR 503.19 OF THE STANDARD SPECIFICATIONS.
- THERMOPLASTIC PAVEMENT MARKINGS AND PAINT STRIPING QUANTITIES ARE APPROXIMATE ONLY. PAYMENT WILL BE MADE FOR ACTUAL QUANTITIES USED AS MEASURED IN THE FIELD.
- THE FOLLOWING UTILITY COMPANIES HAVE UTILITIES WITHIN THE LIMITS OF CONSTRUCTION. ADJUSTMENT OF UTILITY LOCATIONS WILL BE MADE BY THE OWNER, UNLESS OTHERWISE NOTED ON THE PLANS.

- IRON ROD RECOVERED
- ⊗ RIGHT-OF-WAY MARKER
- IRON PIPE RECOVERED
- ⊗ PK NAIL RECOVERED
- ⊗ EXIST. MAILBOX
- ⊗ EXIST. FLAG POLE
- ⊗ EXIST. GUY WIRE
- ⊗ EXIST. POWER POLE
- ⊗ EXIST. STREET LIGHT
- ⊗ EXIST. LIGHT POLE
- ⊗ EXIST. TELEPHONE PEDESTAL
- ⊗ EXIST. GAS VALVE
- ⊗ EXIST. FIRE HYDRANT
- ⊗ EXIST. WATER VALVE
- ⊗ EXIST. BUFFALO BOX
- ⊗ EXIST. WATER METER
- ⊗ EXIST. FLARED END SECTION
- ⊗ EXIST. INLET
- ⊗ EXIST. MANHOLE
- ⊗ EXIST. STOP SIGN
- ⊗ EXIST. SIGN
- ⊗ EXIST. DITCH FLOW LINE
- ⊗ EXIST. SWALE FLOW LINE
- ⊗ GRADE
- ⊗ EXIST. TREE/PINE
- ⊗ EXIST. BUSH
- ⊗ EXIST. TREE STUMP, SIZE
- ⊗ EXIST. CULVERT
- ⊗ EXIST. WATER
- ⊗ EXIST. STORM SEWER
- ⊗ EXIST. SANITARY SEWER
- ⊗ EXIST. FENCE
- ⊗ EXIST. EDGE OF PAVEMENT & SIDEWALK
- ⊗ EXIST. CURB & GUTTER
- ⊗ EXIST. RIGHT OF WAY
- ⊗ (680.70) NEW SPOT ELEVATION
- ⊗ NEW MANHOLE
- ⊗ NEW INLET
- ⊗ NEW FLARED END SECTION
- ⊗ NEW STORM SEWER
- ⊗ NEW EASEMENT
- ⊗ NEW RIGHT OF WAY
- ⊗ NEW CURB & GUTTER
- ⊗ DETECTABLE WARNINGS FOR CURB RAMPS ON SIDEWALKS
- ⊗ REMOVE OBJECT

PAVEMENT DESIGN

6000N (BOURBONNAIS PARKWAY)

Class II, 2-lane pavement
 D.P. - 20 years
 Design Traffic
 Existing ADT: 850 1% growth
 Proposed ADT: 11,700
 PV (85%): 9945 SU (10%): 1170 MU (5%): 585
 80,000 pound load limit
 Critical subgrade Eri: 3ksi
 T.F. = D.P. (0.073PV+56.03SU+192.72MU)
 1,000,000

T.F. = 3.580
 Subgrade support rating: fair
 use PG 64-28 for surface and binder
 use pg 58-22 for base
 mixture temperature: 78.5
 Eac: 585
 design strain: 71
Pavement thickness required: 11.7"

USE: 11.75"

UTILITY	STATUS OF RELOCATION	
	DATE	
POWER COMMONWEALTH EDISON CO. 2500 SOUTH GOVERNORS HIGHWAY UNIVERSITY PARK, IL 60466	PRELIMINARY PLANS SET 9/28/09 FINAL PLAN SET 10/30/09	RELOCATION PRIOR TO CONSTRUCTION
TELEPHONE AT&T 65 WEST WEBSTER JOLIET, IL 60431	PRELIMINARY PLANS SET 9/28/09 FINAL PLAN SET 10/30/09	RELOCATION PRIOR TO CONSTRUCTION
CABLE TV COMCAST 17700 HOFFMAN WAY HOMEWOOD, IL 60430	PRELIMINARY PLANS SET 9/28/09 FINAL PLAN SET 10/30/09	RELOCATION PRIOR TO CONSTRUCTION
GAS NORTHERN ILLINOIS GAS CO. 1844 FERRY ROAD NAPERVILLE, IL 60563	PRELIMINARY PLANS SET 9/28/09 FINAL PLAN SET 10/30/09	RELOCATION PRIOR TO/ DURING CONSTRUCTION
WATER AQUA ILLINOIS 1000 SOUTH SCHUYLER AVE. KANKAKEE, IL 60901	PRELIMINARY PLANS SET 9/28/09 FINAL PLAN SET 10/30/09	RELOCATION PRIOR TO CONSTRUCTION

HMA TABLE			
	HMA Binder	HMA Surface	HMA BASE COURSE, 8"
PG Grade**	PG64-22	PG64-22	PG64-22
Design Air Voids	4.0% @ N50	4.0% @ N50	4.0% @ N50
Mixture Composition	IL 19.0FG	IL 9.5	IL 19.0FG
Friction Aggregate	-	Mixture C	
Density Test Method	Cores	Cores	Cores

* Material shall be compacted to 93.0-97.4 percent of the maximum theoretical density, except that when placed as first lift on an unimproved subgrade the minimum percent compaction shall be 92.0 percent. The maximum theoretical density shall be determined from the moving average as specified in the QC/QA Specification.
 ** When RAP/RAS ABR exceeds 20 percent, the high and low virgin asphalt binder grades shall each be reduced by one grade (i.e. 25% ABR would require a virgin asphalt binder grade of PG64-22 to be reduced to PG58-28.

FAU. RE.	SECTION	COUNTY	TOTAL SHEETS	SHEET NO.								
*	**	KANKAKEE	21	2								
CONTRACT NO. 87398												
FED. ROAD DIST. NO. ILLINOIS FED. AID PROJECT												
FAU6226 ** 04-00066-00-WR  This document and the ideas and designs incorporated herein, as an instrument of professional service, is the property of Tyson Engineering Inc. and shall not be used in whole or in part, for any other project without written authorization of Tyson Engineering Inc. Do not scale drawings. Use dimensions only. Contractor shall be responsible for verifying all dimensions. Information herein and herein is confidential.												
REVISIONS <table border="1"> <thead> <tr> <th>NO.</th> <th>DATE</th> <th>BY</th> <th>DESCRIPTION</th> </tr> </thead> <tbody> <tr> <td>1</td> <td>3/25/14</td> <td>NRD</td> <td>PER I.D.O.T. REV.</td> </tr> </tbody> </table>					NO.	DATE	BY	DESCRIPTION	1	3/25/14	NRD	PER I.D.O.T. REV.
NO.	DATE	BY	DESCRIPTION									
1	3/25/14	NRD	PER I.D.O.T. REV.									
GENERAL NOTES, PAVEMENT DESIGN AND LEGEND												
VILLAGE OF BOURBONNAIS 6000 NORTH ROAD IMPROVEMENTS PHASE I BOURBONNAIS, ILLINOIS												
SECTION 04-00066-00-WR												
DATE:	2/14/14	JOB NO.:	E09108									
SCALE:	N/A	FILE NO.:										
DRAWN BY:	NRD	SHEET:	2									
CHECKED BY:	SRM											

01/2013/2014/2015/2016/2017/2018/2019/2020/2021/2022/2023/2024/2025/2026/2027/2028/2029/2030/2031/2032/2033/2034/2035/2036/2037/2038/2039/2040/2041/2042/2043/2044/2045/2046/2047/2048/2049/2050/2051/2052/2053/2054/2055/2056/2057/2058/2059/2060/2061/2062/2063/2064/2065/2066/2067/2068/2069/2070/2071/2072/2073/2074/2075/2076/2077/2078/2079/2080/2081/2082/2083/2084/2085/2086/2087/2088/2089/2090/2091/2092/2093/2094/2095/2096/2097/2098/2099/2100/2101/2102/2103/2104/2105/2106/2107/2108/2109/2110/2111/2112/2113/2114/2115/2116/2117/2118/2119/2120/2121/2122/2123/2124/2125/2126/2127/2128/2129/2130/2131/2132/2133/2134/2135/2136/2137/2138/2139/2140/2141/2142/2143/2144/2145/2146/2147/2148/2149/2150/2151/2152/2153/2154/2155/2156/2157/2158/2159/2160/2161/2162/2163/2164/2165/2166/2167/2168/2169/2170/2171/2172/2173/2174/2175/2176/2177/2178/2179/2180/2181/2182/2183/2184/2185/2186/2187/2188/2189/2190/2191/2192/2193/2194/2195/2196/2197/2198/2199/2200/2201/2202/2203/2204/2205/2206/2207/2208/2209/2210/2211/2212/2213/2214/2215/2216/2217/2218/2219/2220/2221/2222/2223/2224/2225/2226/2227/2228/2229/2230/2231/2232/2233/2234/2235/2236/2237/2238/2239/2240/2241/2242/2243/2244/2245/2246/2247/2248/2249/2250/2251/2252/2253/2254/2255/2256/2257/2258/2259/2260/2261/2262/2263/2264/2265/2266/2267/2268/2269/2270/2271/2272/2273/2274/2275/2276/2277/2278/2279/2280/2281/2282/2283/2284/2285/2286/2287/2288/2289/2290/2291/2292/2293/2294/2295/2296/2297/2298/2299/2300/2301/2302/2303/2304/2305/2306/2307/2308/2309/2310/2311/2312/2313/2314/2315/2316/2317/2318/2319/2320/2321/2322/2323/2324/2325/2326/2327/2328/2329/2330/2331/2332/2333/2334/2335/2336/2337/2338/2339/2340/2341/2342/2343/2344/2345/2346/2347/2348/2349/2350/2351/2352/2353/2354/2355/2356/2357/2358/2359/2360/2361/2362/2363/2364/2365/2366/2367/2368/2369/2370/2371/2372/2373/2374/2375/2376/2377/2378/2379/2380/2381/2382/2383/2384/2385/2386/2387/2388/2389/2390/2391/2392/2393/2394/2395/2396/2397/2398/2399/2400/2401/2402/2403/2404/2405/2406/2407/2408/2409/2410/2411/2412/2413/2414/2415/2416/2417/2418/2419/2420/2421/2422/2423/2424/2425/2426/2427/2428/2429/2430/2431/2432/2433/2434/2435/2436/2437/2438/2439/2440/2441/2442/2443/2444/2445/2446/2447/2448/2449/2450/2451/2452/2453/2454/2455/2456/2457/2458/2459/2460/2461/2462/2463/2464/2465/2466/2467/2468/2469/2470/2471/2472/2473/2474/2475/2476/2477/2478/2479/2480/2481/2482/2483/2484/2485/2486/2487/2488/2489/2490/2491/2492/2493/2494/2495/2496/2497/2498/2499/2500/2501/2502/2503/2504/2505/2506/2507/2508/2509/2510/2511/2512/2513/2514/2515/2516/2517/2518/2519/2520/2521/2522/2523/2524/2525/2526/2527/2528/2529/2530/2531/2532/2533/2534/2535/2536/2537/2538/2539/2540/2541/2542/2543/2544/2545/2546/2547/2548/2549/2550/2551/2552/2553/2554/2555/2556/2557/2558/2559/2560/2561/2562/2563/2564/2565/2566/2567/2568/2569/2570/2571/2572/2573/2574/2575/2576/2577/2578/2579/2580/2581/2582/2583/2584/2585/2586/2587/2588/2589/2590/2591/2592/2593/2594/2595/2596/2597/2598/2599/2600/2601/2602/2603/2604/2605/2606/2607/2608/2609/2610/2611/2612/2613/2614/2615/2616/2617/2618/2619/2620/2621/2622/2623/2624/2625/2626/2627/2628/2629/2630/2631/2632/2633/2634/2635/2636/2637/2638/2639/2640/2641/2642/2643/2644/2645/2646/2647/2648/2649/2650/2651/2652/2653/2654/2655/2656/2657/2658/2659/2660/2661/2662/2663/2664/2665/2666/2667/2668/2669/2670/2671/2672/2673/2674/2675/2676/2677/2678/2679/2680/2681/2682/2683/2684/2685/2686/2687/2688/2689/2690/2691/2692/2693/2694/2695/2696/2697/2698/2699/2700/2701/2702/2703/2704/2705/2706/2707/2708/2709/2710/2711/2712/2713/2714/2715/2716/2717/2718/2719/2720/2721/2722/2723/2724/2725/2726/2727/2728/2729/2730/2731/2732/2733/2734/2735/2736/2737/2738/2739/2740/2741/2742/2743/2744/2745/2746/2747/2748/2749/2750/2751/2752/2753/2754/2755/2756/2757/2758/2759/2760/2761/2762/2763/2764/2765/2766/2767/2768/2769/2770/2771/2772/2773/2774/2775/2776/2777/2778/2779/2780/2781/2782/2783/2784/2785/2786/2787/2788/2789/2790/2791/2792/2793/2794/2795/2796/2797/2798/2799/2800/2801/2802/2803/2804/2805/2806/2807/2808/2809/2810/2811/2812/2813/2814/2815/2816/2817/2818/2819/2820/2821/2822/2823/2824/2825/2826/2827/2828/2829/2830/2831/2832/2833/2834/2835/2836/2837/2838/2839/2840/2841/2842/2843/2844/2845/2846/2847/2848/2849/2850/2851/2852/2853/2854/2855/2856/2857/2858/2859/2860/2861/2862/2863/2864/2865/2866/2867/2868/2869/2870/2871/2872/2873/2874/2875/2876/2877/2878/2879/2880/2881/2882/2883/2884/2885/2886/2887/2888/2889/2890/2891/2892/2893/2894/2895/2896/2897/2898/2899/2900/2901/2902/2903/2904/2905/2906/2907/2908/2909/2910/2911/2912/2913/2914/2915/2916/2917/2918/2919/2920/2921/2922/2923/2924/2925/2926/2927/2928/2929/2930/2931/2932/2933/2934/2935/2936/2937/2938/2939/2940/2941/2942/2943/2944/2945/2946/2947/2948/2949/2950/2951/2952/2953/2954/2955/2956/2957/2958/2959/2960/2961/2962/2963/2964/2965/2966/2967/2968/2969/2970/2971/2972/2973/2974/2975/2976/2977/2978/2979/2980/2981/2982/2983/2984/2985/2986/2987/2988/2989/2990/2991/2992/2993/2994/2995/2996/2997/2998/2999/3000/3001/3002/3003/3004/3005/3006/3007/3008/3009/3010/3011/3012/3013/3014/3015/3016/3017/3018/3019/3020/3021/3022/3023/3024/3025/3026/3027/3028/3029/3030/3031/3032/3033/3034/3035/3036/3037/3038/3039/3040/3041/3042/3043/3044/3045/3046/3047/3048/3049/3050/3051/3052/3053/3054/3055/3056/3057/3058/3059/3060/3061/3062/3063/3064/3065/3066/3067/3068/3069/3070/3071/3072/3073/3074/3075/3076/3077/3078/3079/3080/3081/3082/3083/3084/3085/3086/3087/3088/3089/3090/3091/3092/3093/3094/3095/3096/3097/3098/3099/3100/3101/3102/3103/3104/3105/3106/3107/3108/3109/3110/3111/3112/3113/3114/3115/3116/3117/3118/3119/3120/3121/3122/3123/3124/3125/3126/3127/3128/3129/3130/3131/3132/3133/3134/3135/3136/3137/3138/3139/3140/3141/3142/3143/3144/3145/3146/3147/3148/3149/3150/3151/3152/3153/3154/3155/3156/3157/3158/3159/3160/3161/3162/3163/3164/3165/3166/3167/3168/3169/3170/3171/3172/3173/3174/3175/3176/3177/3178/3179/3180/3181/3182/3183/3184/3185/3186/3187/3188/3189/3190/3191/3192/3193/3194/3195/3196/3197/3198/3199/3200/3201/3202/3203/3204/3205/3206/3207/3208/3209/3210/3211/3212/3213/3214/3215/3216/3217/3218/3219/3220/3221/3222/3223/3224/3225/3226/3227/3228/3229/3230/3231/3232/3233/3234/3235/3236/3237/3238/3239/3240/3241/3242/3243/3244/3245/3246/3247/3248/3249/3250/3251/3252/3253/3254/3255/3256/3257/3258/3259/3260/3261/3262/3263/3264/3265/3266/3267/3268/3269/3270/3271/3272/3273/3274/3275/3276/3277/3278/3279/3280/3281/3282/3283/3284/3285/3286/3287/3288/3289/3290/3291/3292/3293/3294/3295/3296/3297/3298/3299/3300/3301/3302/3303/3304/3305/3306/3307/3308/3309/3310/3311/3312/3313/3314/3315/3316/3317/3318/3319/3320/3321/3322/3323/3324/3325/3326/3327/3328/3329/3330/3331/3332/3333/3334/3335/3336/3337/3338/3339/3340/3341/3342/3343/3344/3345/3346/3347/3348/3349/3350/3351/3352/3353/3354/3355/3356/3357/3358/3359/3360/3361/3362/3363/3364/3365/3366/3367/3368/3369/3370/3371/3372/3373/3374/3375/3376/3377/3378/3379/3380/3381/3382/3383/3384/3385/3386/3387/3388/3389/3390/3391/3392/3393/3394/3395/3396/3397/3398/3399/3400/3401/3402/3403/3404/3405/3406/3407/3408/3409/3410/3411/3412/3413/3414/3415/3416/3417/3418/3419/3420/3421/3422/3423/3424/3425/3426/3427/3428/3429/3430/3431/3432/3433/3434/3435/3436/3437/3438/3439/3440/3441/3442/3443/3444/3445/3446/3447/3448/3449/3450/3451/3452/3453/3454/3455/3456/3457/3458/3459/3460/3461/3462/3463/3464/3465/3466/3467/3468/3469/3470/3471/3472/3473/3474/3475/3476/3477/3478/3479/3480/3481/3482/3483/3484/3485/3486/3487/3488/3489/3490/3491/3492/3493/3494/3495/3496/3497/3498/3499/3500/3501/3502/3503/3504/3505/3506/3507/3508/3509/3510/3511/3512/3513/3514/3515/3516/3517/3518/3519/3520/3521/3522/3523/3524/3525/3526/3527/3528/3529/3530/3531/3532/3533/3534/3535/3536/3537/3538/3539/3540/3541/3542/3543/3544/3545/3546/3547/3548/3549/3550/3551/3552/3553/3554/3555/3556/3557/3558/3559/3560/3561/3562/3563/3564/3565/3566/3567/3568/3569/3570/3571/3572/3573/3574/3575/3576/3577/3578/3579/3580/3581/3582/3583/3584/3585/3586/3587/3588/3589/3590/3

SUMMARY OF QUANTITIES

PAY ITEM NUMBER	ITEM	PLAN QUANTITY	UNIT
* 20200100	Earth Excavation	2,145	CU YD
20201200	Removal and Disposal of Unsuitable Material	3,277	CU YD
20400800	Furnished Excavation	8,734	CU YD
21001000	Geotechnical Fabric for Ground Stabilization	3,449	SQ YD
* 25000210	Seeding, Class 2A	2.30	ACRE
25100125	Mulch, Method 3	2.30	ACRE
25100630	Erosion Control Blanket	1,900	SQ YD
28000250	Temporary Erosion Control Seeding	255.0	POUND
28000400	Perimeter Erosion Barrier	693	FOOT
28000500	Inlet and Pipe Protection	12	EACH
* 30300112	Aggregate Subgrade Improvement 12"	3095	SQ YD
35101800	Aggregate Base Course, Type B 6"	407	SQ YD
35102200	Aggregate Base Course, Type B 10"	330	SQ YD
35501316	Hot-Mix Asphalt Base Course, 8"	2,822	SQ YD
40603082	Hot-Mix Asphalt Binder Course, IL-19.0 FG, N50	440	TON
40603310	Hot-Mix Asphalt Surface Course, Mix "C", N50	424	TON
42300400	Portland Cement Concrete Driveway Pavement, 8 inch	89	SQ YD
42400100	Portland Cement Concrete Sidewalk 4 inch	4120	SQ FT
* 42400800	Detectable Warnings	80	SQ FT
44000100	Pavement Removal	2230	SQ YD
44000500	Combination Curb and Gutter Removal	128	FOOT
48100500	Aggregate shoulders, Type A 6"	144	SQ YD
54001001	Box Culvert End Sections, Culvert No. 1	2	EACH
54010903	Precast Concrete Box Culverts 9' X 3'	120	FOOT
542D0217	Pipe Culverts, Class D, Type 1 12"	888	FOOT
550A0050	Storm Sewers, Class A, Type 1 12"	194	FOOT
550A0190	Storm Sewers, Class A, Type 1 48"	699	FOOT
55101200	Storm Sewer Removal 24"	1,147	FOOT
* 60223800	Manholes, Type A, 6'-Diameter, Type 1 Frame, Closed Lid	3	EACH
* 60224459	Manholes, Type A, 8'-Diameter, Type 1 Frame, Closed Lid	1	EACH
60234200	Inlets, Type A, Type 1 Frame, Open Lid	2	EACH
60235700	Inlets, Type A, Type 3 Frame and Grate	3	EACH
60240210	Inlets, Type B, Type 1 Frame, Open Lid	1	EACH
60240220	Inlets, Type B, Type 3 Frame and Grate	1	EACH
60255500	Manholes to be Adjusted	2	EACH
* 60266800	Valve Boxes to be Adjusted	2	EACH
60500040	Removing Manholes	6	EACH
60603800	Combination Concrete Curb and Gutter, Type B-6.12	208	FOOT
60605000	Combination Concrete Curb and Gutter, Type B-6.24	620	FOOT
* 67100100	Mobilization	1.00	L SUM
70103815	Traffic Control Surveillance	60	CAL DA
70300220	Temporary Pavement Marking-Line, 4"	1,290	FOOT
70301000	Work Zone Pavement Marking Removal	337	SQ FT
△ 78000100	Thermoplastic Pavement Marking - Letters and Symbols	31	SQ FT
△ 78000400	Thermoplastic Pavement Marking - Line 6"	1518	FOOT
△ 78000800	Thermoplastic Pavement Marking - Line 12"	270	FOOT
△ 78000650	Thermoplastic Pavement Marking - Line 24"	26	FOOT
* X2080250	Trench Backfill, Special	133	CU YD
* X4060110	Bituminous Materials (Prime Coat)	635	POUND
* X5010523	Remove Concrete End Section	3	EACH
* X6023506	Inlets, Type A, With Special Frame, Open Lid	2	EACH
* X6023508	Inlets, Type A, With Special Frame and Grate	2	EACH
* X6024502	Inlets, Type B, With Special Frame and Grate	2	EACH
* X7010216	Traffic Control and Protection, (Special)	1.00	L SUM
* X7240500	Relocate Existing Signs	2	EACH
X6026051	Sanitary Mahole to be Reconstructed	1	EACH

* See Special Provisions
 △ Specialty Item
 Construction Code: 0004

FAU. NO.	SECTION	COUNTY	TOTAL SHEETS	SHEET NO.
*	**	KANKAKEE	21	3

CONTRACT NO. 87398

FED. ROAD DIST. NO. ILLINOIS FED. AID PROJECT

* FAU6226
 ** 04-0006600-WR



This document and the ideas and designs incorporated herein, as an instrument of professional service, is the property of Tyson Engineering Inc. and is not to be used in whole or in part, for any other project without written authorization of Tyson Engineering Inc.
 Do not scale drawings. Use dimensions only.
 Contractor shall be responsible for verifying all dimensions.
 Information hereon and herein is confidential.

REVISIONS			
NO.	DATE	BY	DESCRIPTION
1	3/25/14	NRD	PER I.D.O.T. REV.

SUMMARY OF QUANTITIES

**VILLAGE OF BOURBONNAIS
 6000 NORTH ROAD
 IMPROVEMENTS
 PHASE I
 BOURBONNAIS, ILLINOIS**

SECTION
 04-00066-00-WR

DATE:	2/14/14	JOB NO. E09108
SCALE:	N/A	FILE NO.
DRAWN BY:	NRD	SHEET 3
CHECKED BY:	SRM	21

TYPICAL EXISTING ROADWAY CROSS SECTION

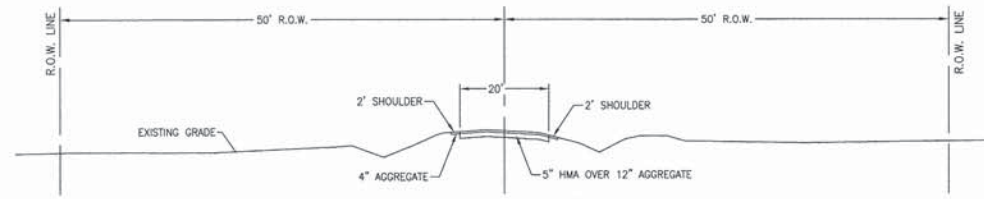

6000N (BOURBONNAIS PARKWAY) - STA. 53+00 TO STA. 59+95
NOT TO SCALE

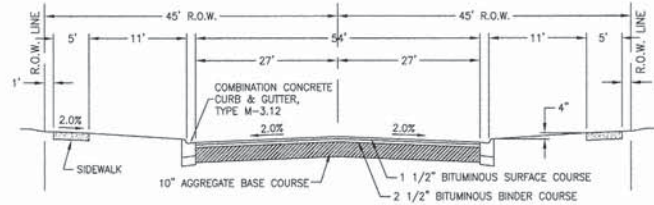

STONEBRIDGE BOULEVARD TYPICAL PAVEMENT SECTION
NOT TO SCALE

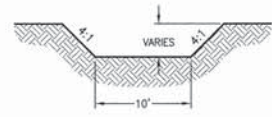

SPECIAL DITCH CROSS-SECTION
NOT TO SCALE

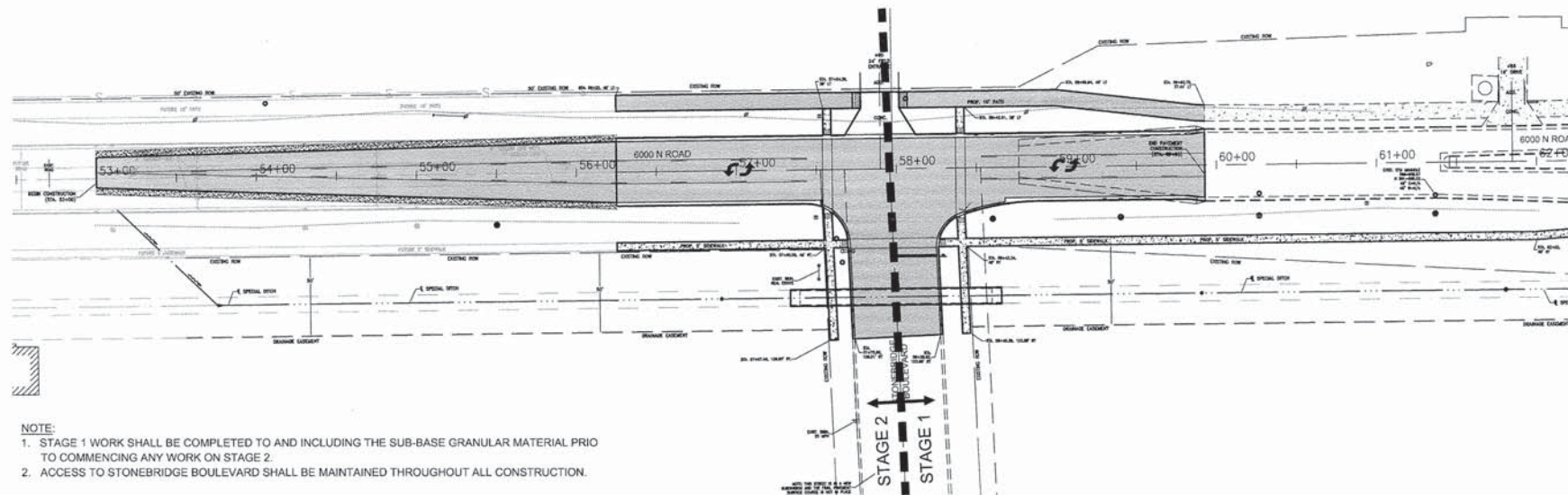

NOTE:
1. STAGE 1 WORK SHALL BE COMPLETED TO AND INCLUDING THE SUB-BASE GRANULAR MATERIAL PRIOR TO COMMENCING ANY WORK ON STAGE 2.
2. ACCESS TO STONEBRIDGE BOULEVARD SHALL BE MAINTAINED THROUGHOUT ALL CONSTRUCTION.

STAGING DIAGRAM
(NOT TO SCALE)

TYPICAL PROPOSED ROADWAY CROSS SECTIONS

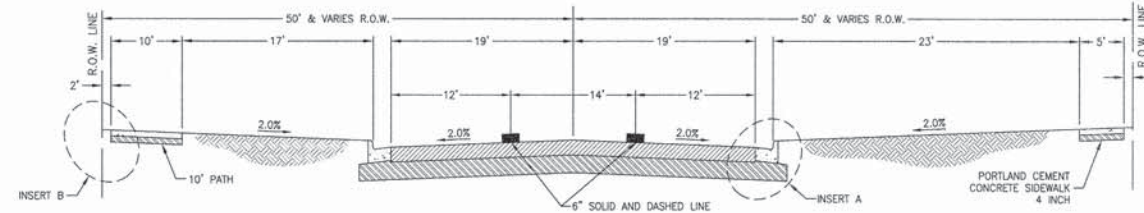

6000N (BOURBONNAIS PARKWAY) - STA. 56+25 TO STA. 59+95
NOT TO SCALE

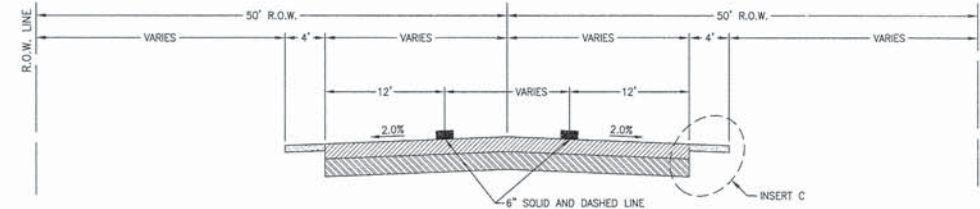

6000N (BOURBONNAIS PARKWAY) - STA. 53+00 TO STA. 56+25
NOT TO SCALE

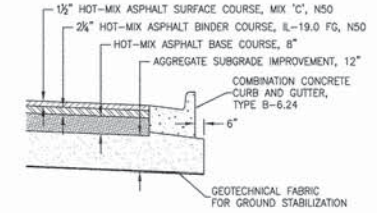

INSERT A
NOT TO SCALE

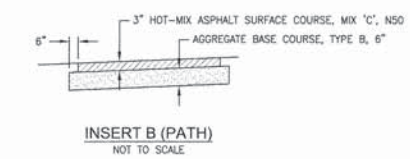

INSERT B (PATH)
NOT TO SCALE

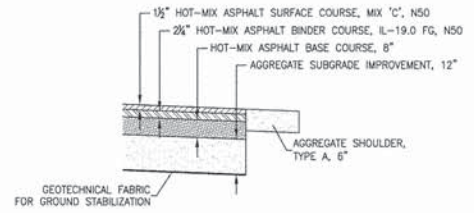

INSERT C
NOT TO SCALE

FAU. RITE	SECTION	COUNTY	TOTAL SHEETS	SHEET NO.
	**	KANKAKEE	21	4
CONTRACT NO. 87398				
FED. ROAD DIST. NO. ILLINOIS FED. AID PROJECT				
* FAUG226				
** 04-0006-00-WR				

This document and the ideas and designs incorporated herein, as an instrument of professional service, is the property of Tyson Engineering Inc. and shall not be used in whole or in part, for any other project without written authorization of Tyson Engineering Inc. Contractor shall be responsible for verifying all dimensions. Information herein is confidential.

TYSON ENGINEERING
367 South Schuyler Avenue
Kankakee, Illinois 60001
Phone (815) 932-7406

This document and the ideas and designs incorporated herein, as an instrument of professional service, is the property of Tyson Engineering Inc. and is not to be used in whole or in part, for any other project without written authorization of Tyson Engineering Inc.
Do not scale drawings. Use dimensions only.
Contractor shall be responsible for verifying all dimensions.
Information herein and herein is confidential.

REVISIONS				
NO.	DATE	BY	DESCRIPTION	
1	3/25/14	NRD	PER I.D.O.T. REV.	

TYPICAL ROADWAY CROSS SECTIONS

PROJECT:
**VILLAGE OF BOURBONNAIS
6000 NORTH ROAD
IMPROVEMENTS
PHASE I**
BOURBONNAIS, ILLINOIS

SECTION
04-00066-00-WR

DATE:	2/14/14	JOB NO.	E09108
SCALE:	N/A	FILE NO.	
DRAWN BY:	NRD	SHEET	4
CHECKED BY:	SRM		

LOCATION	PAVEMENT SCHEDULE										
	GEOTECHNICAL FABRIC FOR GROUND STABILIZATION (SQ YD)	AGGREGATE SUBGRADE 12" (SQ YD)	AGGREGATE BASE COURSE TYPE B		PORTLAND CEMENT CONCRETE DRIVEWAY PAVEMENT 8" (SQ YD)	AGGREGATE SHOULDERS TYPE A 5" (SQ YD)	COMBINATION CONCRETE CURB AND GUTTER		HOT-MIX ASPHALT SURFACE COURSE 7" (SQ YD)	HOT-MIX ASPHALT BINDER COURSE IL-19.0, N50 (TON)	HOT-MIX ASPHALT BINDER COURSE IL-19.0, N50 (TON)
			6" (SQ YD)	10" (SQ YD)			TYPE B-6.12 (FOOT)	TYPE B-6.24 (FOOT)			
STA 53+00 TO 56+25	1065	1065				144			1029	115	144
STA 56+25 TO 57+44	582	582						238	502	56	70
STA 56+25 TO 57+73 LT			180							37	
STA 57+44 TO 58+90	944	944					98	176	856	96	120
STA 57+90 LT						89					
STA 57+98 RT	354			330				110		36	45
STA 58+07 TO 59+93 LT			227							35	
STA 58+90 TO 59+93	504	504						206	435	49	61
TOTAL	3449	3095	407	330	89	144	208	620	2822	424	440

EARTH EXCAVATION SCHEDULE			
LOCATION	EARTH EXCAVATION (CU YD)	REMOVAL AND DISPOSAL OF UNSUITABLE MATERIAL (CU YD)	EMBANKMENT (CU YD)
STA 53+00 TO 62+50	2145	3277	8783
TOTAL	2145	3277	8783

REMOVALS SCHEDULE					
LOCATION	PAVEMENT REMOVAL (SQ YD)	COMBINATION CURB & GUTTER REMOVAL (FOOT)	STORM SEWER REMOVAL 24" (FOOT)	REMOVING MANHOLES (EACH)	REMOVE CONCRETE FLARED END SECTIONS (EACH)
STA 53+00 TO 59+93	1540			1	
STA 53+20 - 27 RT			403		
STA 53+20 TO 57+23 RT					1
STA 57+16 - 24 RT			9		
STA 57+16 TO 57+23 RT				1	
STA 57+23 - 37 RT			78		
STA 57+23 TO 58+67 RT			144		
STA 57+70 - 100 RT				1	
STA 57+70 RT		65			
STA 57+70 TO 58+27 RT			57		
STA 57+97 RT	690				
STA 58+27 RT		53			
STA 58+27 - 96 RT				1	
STA 58+27 TO 58+07 RT			70		
STA 58+67 - 38 RT				1	
STA 58+67 TO 62+24 RT			357		
STA 58+67 TO 58+73 RT			9		
STA 58+73 - 24 RT					1
STA 59+88 TO 59+93 LT		5			
STA 59+88 TO 59+93 RT		5			
STA 62+24 - 45 RT				1	
STA 62+24 TO 62+46 RT			20		
STA 62+46 - 39 RT					1
TOTAL	2230	128	1147	6	3

SIDEWALK SCHEDULE		
LOCATION	PORTLAND CEMENT CONCRETE SIDEWALK 4" (SQ FT)	DETECTABLE WARNINGS (SQ FT)
STA 56+25 TO 57+69 RT	720	8
STA 57+57 RT	405	8
STA 57+57 LT	80	8
STA 57+73 TO 57+78 LT	50	16
STA 58+02 TO 58+07 LT	50	16
STA 58+26 TO 63+00 RT	2370	8
STA 58+40 RT	365	8
STA 58+40 LT	80	8
TOTAL	4120	80

PAVEMENT MARKING SCHEDULE				
LOCATION	THERMOPLASTIC PAVEMENT MARKING			
	LETTERS AND SYMBOLS (SQ FT)	LINE 6" (FOOT)	LINE 12" (FOOT)	LINE 24" (FOOT)
STA 53+85 TO 56+25		564		LINE YELLOW
STA 56+25 TO 57+50 LT		156		LINE YELLOW
STA 56+25 TO 57+50 RT		156		LINE YELLOW
STA 57+57		84	78	CROSS WALK WHITE
STA 57+97 RT		108	102	CROSS WALK WHITE & STOP BAR
STA 58+48		92	90	CROSS WALK WHITE
STA 58+50 TO 59+93 LT		179		LINE YELLOW
STA 58+50 TO 59+93 RT		179		LINE YELLOW
STA 59+00	31.2			DOUBLE ARROW WHITE
TOTAL	31.2	1518	270	28

EROSION CONTROL SCHEDULE				
LOCATION	EROSION CONTROL BLANKET (SQ YD)	TEMP. EROSION CONTROL SEEDING (POUND)	PERIMETER EROSION BARRIER (FOOT)	INLET AND PIPE PROTECTION (EACH)
STA 53+00 TO 62+50	1900	255		
STA 53+00 TO 59+93 LT			693	
STA 53+75 RT				1
STA 56+90 RT				1
STA 58+00 RT				4
STA 58+60				2
STA 59+80				2
STA 59+90 RT				1
STA 61+80 RT				1
TOTAL	1900	255	693	12

TURF ESTABLISHMENT SCHEDULE		
LOCATION	SEEDING CLASS 2A (ACRE)	MULCH METHOD 3 (ACRE)
STA 53+00 TO 59+93 LT	0.45	0.45
STA 53+00 TO 57+68 RT	0.95	0.95
STA 58+26 TO 62+73 RT	0.90	0.90
TOTAL	2.30	2.30

TRENCH BACKFILL SCHEDULE		
LOCATION	TRENCH BACKFILL SPECIAL (CU YD)	
STA 57+63 TO 58+45 - 32 RT	95	STONEBRIDGE
STA 57+53 TO 57+62 - 80 RT	8	SIDEWALK
STA 57+68 TO 58+28 - 80 RT	12	STONEBRIDGE
STA 57+70 TO 58+28 - 89 RT	3	STONEBRIDGE
STA 58+36 TO 58+45 - 80 RT	8	SIDEWALK
STA 58+60	3	6000N
STA 59+40	4	6000N
TOTAL	133	

STORM SEWER STRUCTURE SCHEDULE								
LOCATION	MANHOLES TYPE A, TYPE 1 FRAME		INLETS					
	6" - CLOSED LID (EACH)	8" - CLOSED LID (EACH)	TYPE A, TYPE 1 FRAME OPEN LID (EACH)	TYPE A, SPECIAL FRAME OPEN LID (EACH)	TYPE A, SPECIAL FRAME AND GRATE (EACH)	TYPE B, SPECIAL FRAME AND GRATE (EACH)	TYPE B, TYPE 1 FRAME OPEN LID (EACH)	TYPE B, TYPE 3 FRAME AND GRATE (EACH)
STA 53+75 - 80RT			1					
STA 55+50 - 32RT	1							
STA 56+90 - 80RT				1				
STA 57+72 - 88RT						1		
STA 57+72 - 98RT				1				
STA 58+27 - 90RT						1		
STA 58+27 - 100RT				1				
STA 58+50 - 20LT					1			
STA 58+60 - 32RT	1							
STA 58+60 - 20LT							1	
STA 59+30 - 20RT						1		
STA 59+30 - 20LT						1		
STA 59+40 - 32RT	1							
STA 59+40 - 20RT								1
STA 59+40 - 20LT								1
STA 59+90 - 80RT				1				
STA 60+23 - 32RT	1							
STA 61+39 - 32RT	1							
STA 61+80 - 80RT				1				
STA 62+49 - 32RT		1						
STA 62+56 - 50RT							1	
TOTAL	5	1	2	2	2	3	2	3

MISCELLANEOUS SCHEDULE				
LOCATION	MANHOLES TO BE ADJUSTED (EACH)	VALVE BOXES TO BE ADJUSTED (EACH)	SANITARY MANHOLES TO BE RECONSTRUCTED (EACH)	RELOCATE EXISTING SIGNS (EACH)
STA 57+65 - 58RT	1			
STA 58+06 - 44LT	1		1	
STA 58+29 - 54RT				1 STOP
STA 58+42 - 46RT		1		
STA 58+43 - 29LT		1		
STA 59+35 - 24RT				1 SPEED LIMIT 45MPH
STA 61+69 - 46LT				
STA 61+98 - 40LT				
TOTAL	2	2	1	2

STORM SEWER PIPE SCHEDULE					
LOCATION	PRECAST CONCRETE BOX CULVERTS 9'x3' (FOOT)	PIPE CULVERTS CLASS D, TYPE 1 12" (FOOT)	STORM SEWER, CLASS A, TYPE 1		BOX CULVERT END SECTIONS CULVERT NO. 1 (EACH)
			12" (FOOT)	48" (FOOT)	
STA 53+75 TO 56+90 RT		315			
STA 55+50 TO 58+60 RT					310
STA 56+90 TO 59+90 RT		300			
STA 57+33 TO 58+65 RT	120				2
STA 58+00 RT				80	
STA 58+60				62	
STA 58+60 TO 59+40 RT				80	
STA 59+40				72	
STA 59+40 TO 60+23 RT					83
STA 59+50 TO 61+80 RT		190			
STA 60+23				14	
STA 60+23 TO 61+37 RT					114
STA 61+37				12	
STA 61+37 TO 62+49 RT					112
STA 61+80 TO 62+56 RT		83			
TOTAL	120	888	240	699	2

FALL SHEET	SECTION	COUNTY	TOTAL SHEETS	SHEET NO.
*	**	KANKAKEE	21	5
CONTRACT NO. 87398				
FED. ROAD DIST. NO. ILLINOIS FED. AD PROJECT				
* FAU6226				
** 04-00066-00-WR				
				
<small>This document and the ideas and designs incorporated herein, as an instrument of professional service, is the property of Tyson Engineering Inc. and is not to be used in whole or in part, for any other project without written authorization of Tyson Engineering Inc. Do not scale drawings. Use dimensions only. Contractor shall be responsible for verifying all dimensions. Information hereon and herein is confidential.</small>				
REVISIONS				
NO.	DATE	BY	DESCRIPTION	
1	3/25/14	NRD	PER I.D.O.T. REV.	
SCHEDULE OF QUANTITIES				
VILLAGE OF BOURBONNAIS 6000 NORTH ROAD IMPROVEMENTS PHASE I BOURBONNAIS, ILLINOIS				
SECTION 04-00066-00-WR				
DATE:	2/14/14	JOB NO.	E09108	
SCALE:	N/A	FILE NO.		
DRAWN BY:	NRD	SHEET	5	
CHECKED BY:	SRM		21	

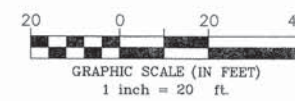
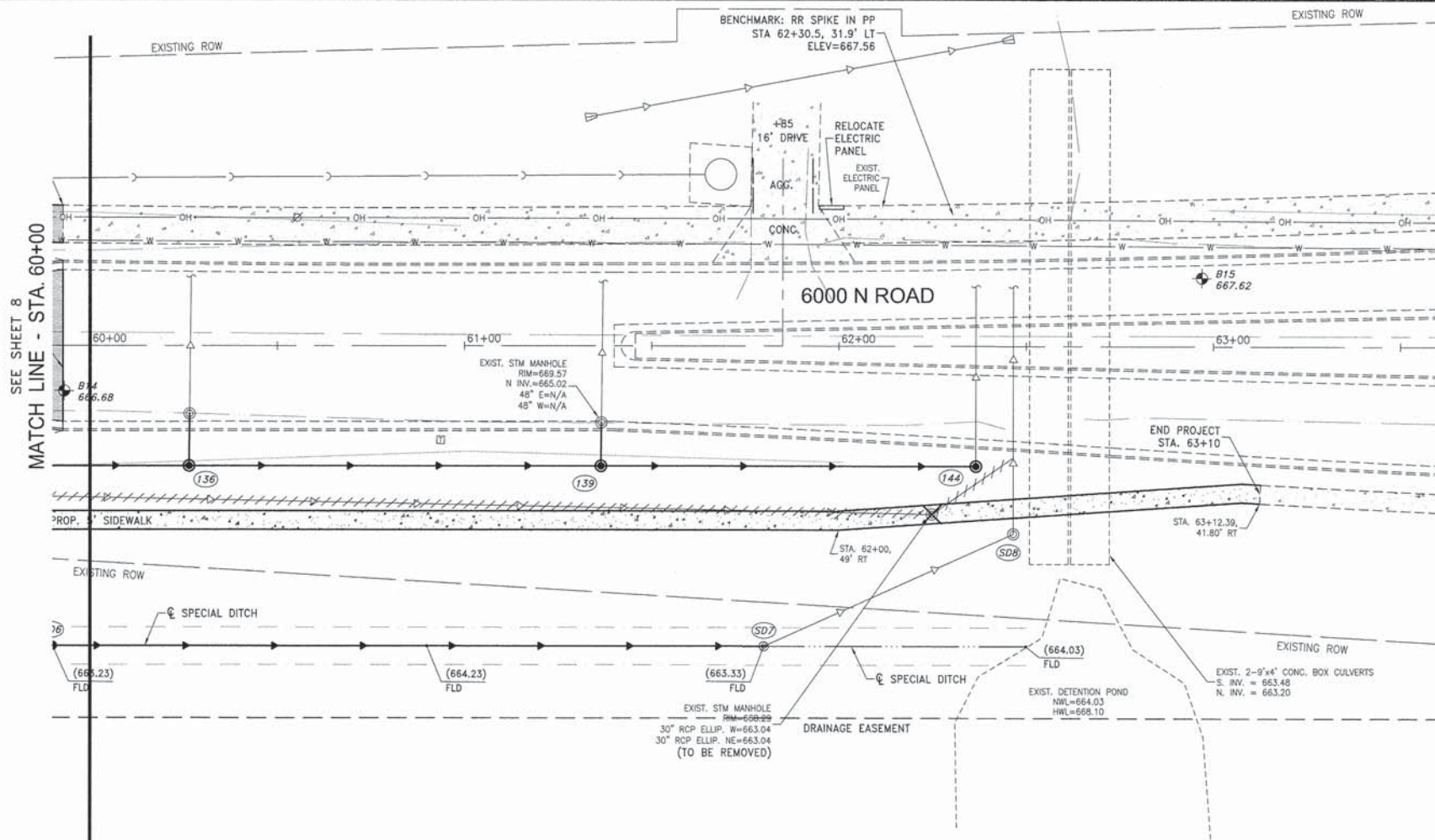

FALL RY.	SECTION	COUNTY	TOTAL SHEETS	SHEET NO.
**	**	KANKAKEE	21	9

CONTRACT NO. 87398
 FED. ROAD DIST. NO. ILLINOIS FED. AID PROJECT

* FAU6226
 ** 04-0006-00-WR

This document and the ideas and designs incorporated herein, as an instrument of professional service, is the property of Tyson Engineering Inc. and is not to be used in whole or in part, for any other project without written authorization of Tyson Engineering Inc.

Do not scale drawings. Use dimensions only. Contractor shall be responsible for verifying all dimensions. Information hereon and herein is confidential.

REVISIONS

NO.	DATE	BY	DESCRIPTION
1	3/25/14	NRD	PER I.D.O.T. REV.

6000 N ROAD
 PLAN AND PROFILE
 STA. 56+25 TO STA. 59+50

PROJECT:
 VILLAGE OF BOURBONNAIS
6000 NORTH ROAD IMPROVEMENTS PHASE I
 BOURBONNAIS, ILLINOIS

SECTION
 04-00066-00-WR

DATE: 2/14/14 JOB NO. E09108

SCALE: HORZ.: 1"=20' FILE NO.
 VERT.: 1"=2'

DRAWN BY: NRD SHEET

CHECKED BY: SRM SHEET **9**

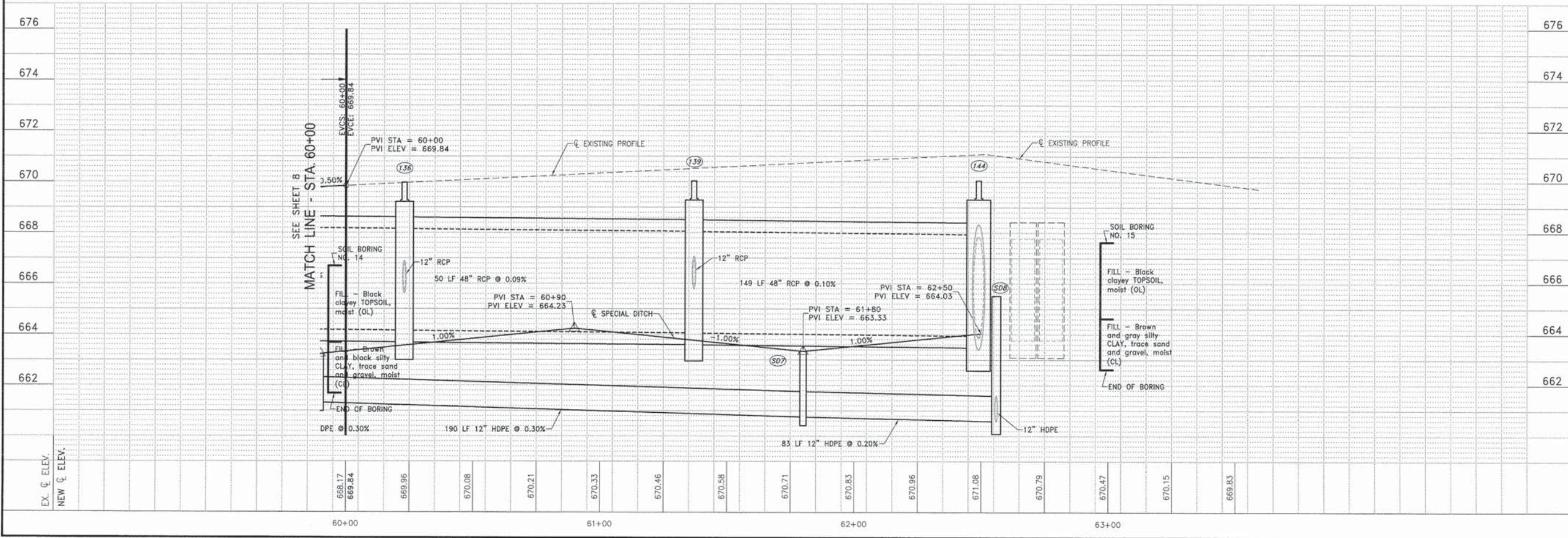

ALBERTSON & ASSOCIATES, INC. 2014-02-14 10:43:25 AM

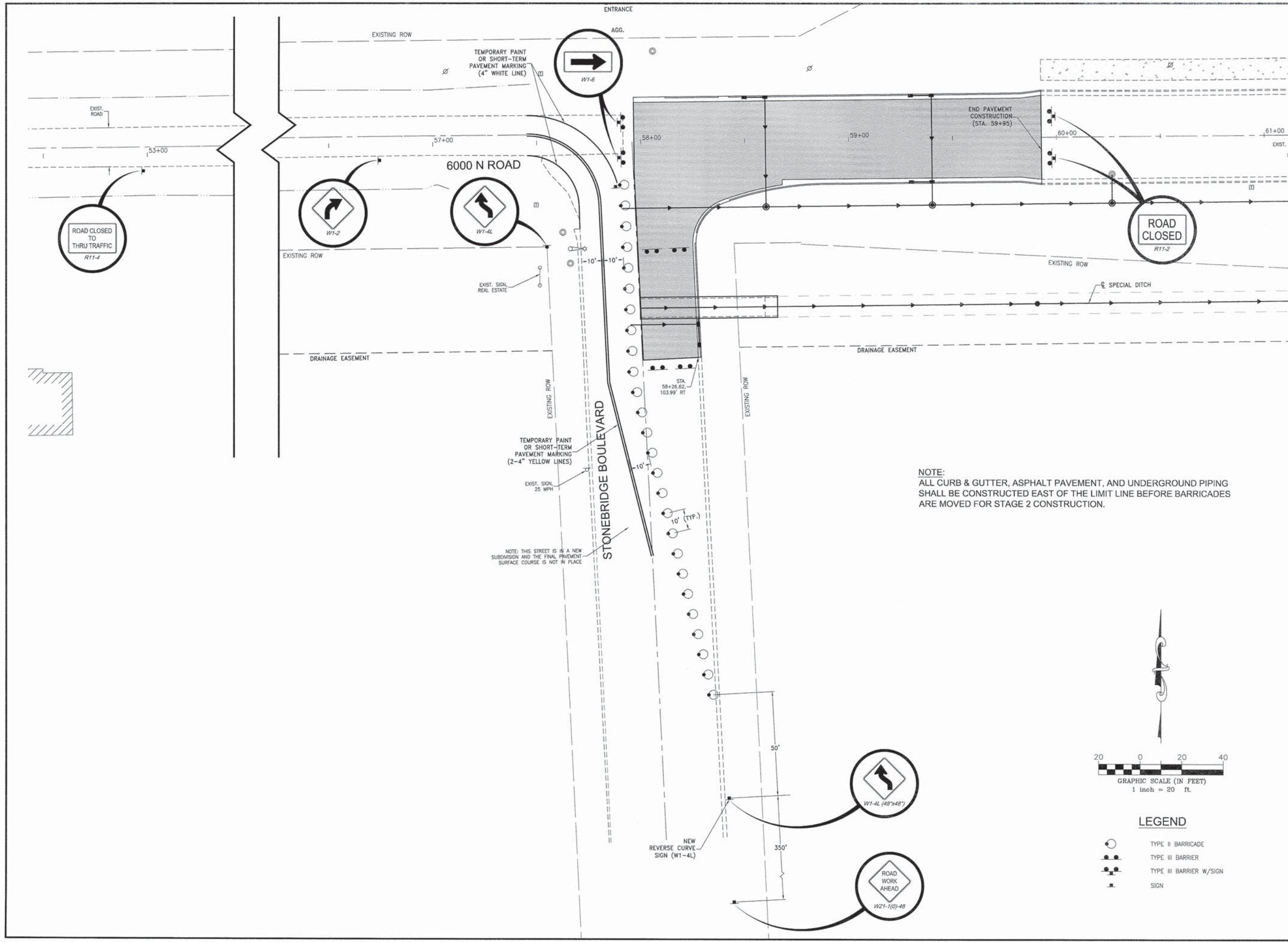

FAU. R/O.	SECTION	COUNTY	TOTAL SHEETS	SHEET NO.
	**	KANKAKEE	21	10

CONTRACT NO. 87398
 FED. ROAD DIST. NO. ILLINOIS FED. AID PROJECT

* FAU6226
 ** 04-00066-00-WR

This document and the ideas and designs incorporated herein, as an instrument of professional service, is the property of Tyson Engineering Inc. and is not to be used in whole or in part, for any other project without written authorization of Tyson Engineering Inc. Contractor shall be responsible for verifying all dimensions. Information herein and herein is confidential.

TYSON ENGINEERING
 367 South Schuyler Avenue
 Kankakee, Illinois 60901
 Phone: (815) 932-7406

Do not scale drawings. Use dimensions only.
 Contractor shall be responsible for verifying all dimensions.
 Information herein and herein is confidential.

REVISIONS			
NO.	DATE	BY	DESCRIPTION
1	3/25/14	NRD	PER I.D.O.T. REV.

STAGE 1
 STAGING PLAN

PROJECT:
**VILLAGE OF BOURBONNAIS
 6000 NORTH ROAD
 IMPROVEMENTS
 PHASE I**
 BOURBONNAIS, ILLINOIS

SECTION 04-00066-00-WR	
DATE: 2/14/14	JOB NO. E09108
SCALE: 1"=20'	FILE NO.
DRAWN BY: NRD	SHEET 10
CHECKED BY: SRM	21

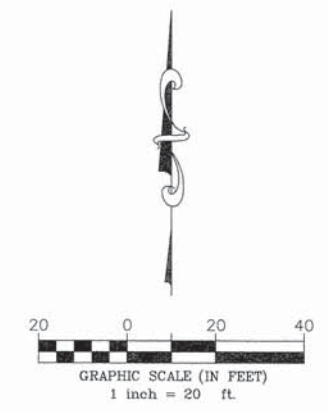

LEGEND	
	TYPE II BARRICADE
	TYPE III BARRIER
	TYPE III BARRIER W/SIGN
	SIGN

K:\2014\2014-03-25\2014-03-25-001.dwg, 10:00:00 AM, 3/25/14, 10:00:00 AM, 3/25/14, 10:00:00 AM

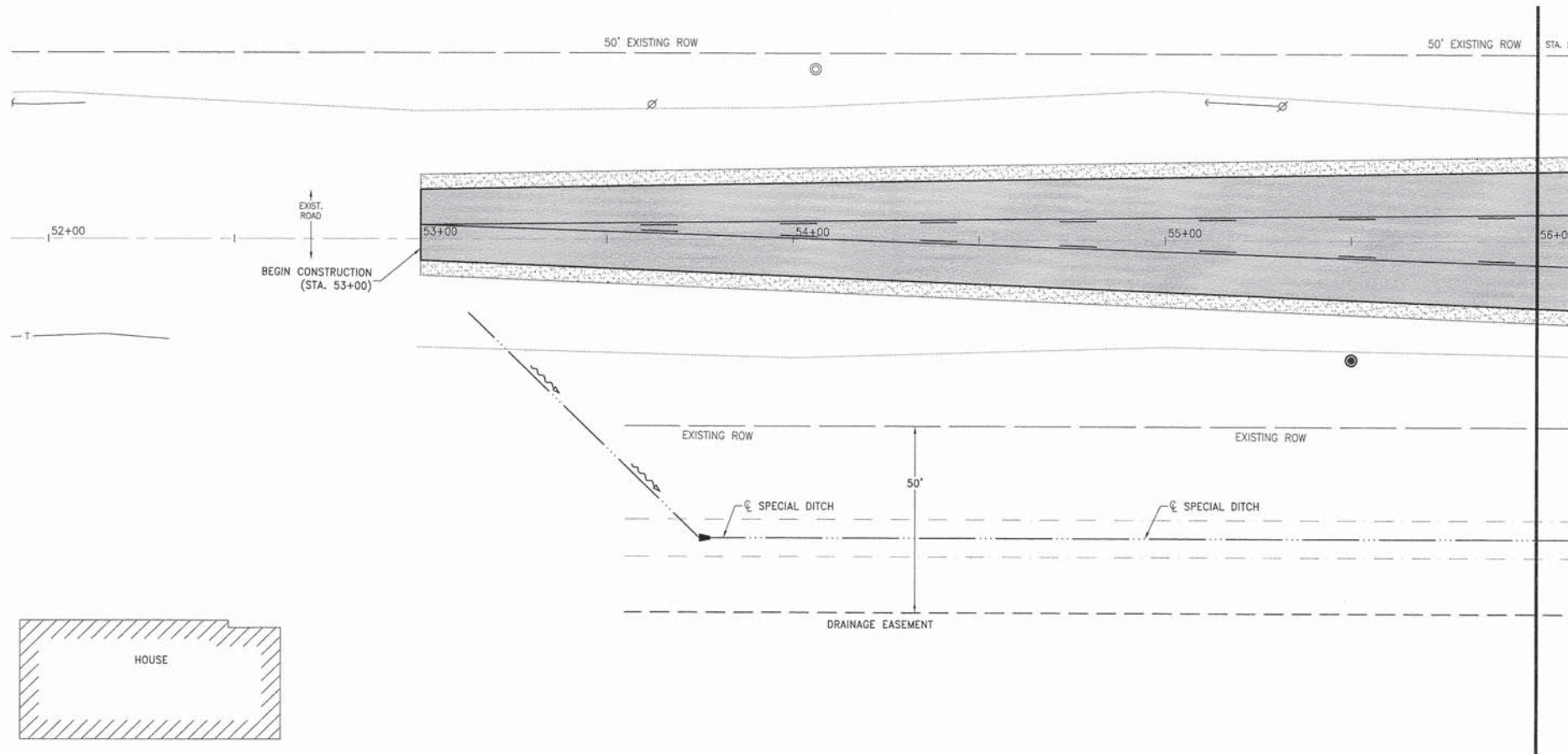

MATCH LINE - STA. 56+00
SEE BELOW

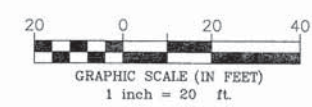

SEE ABOVE
MATCH LINE - STA. 56+00

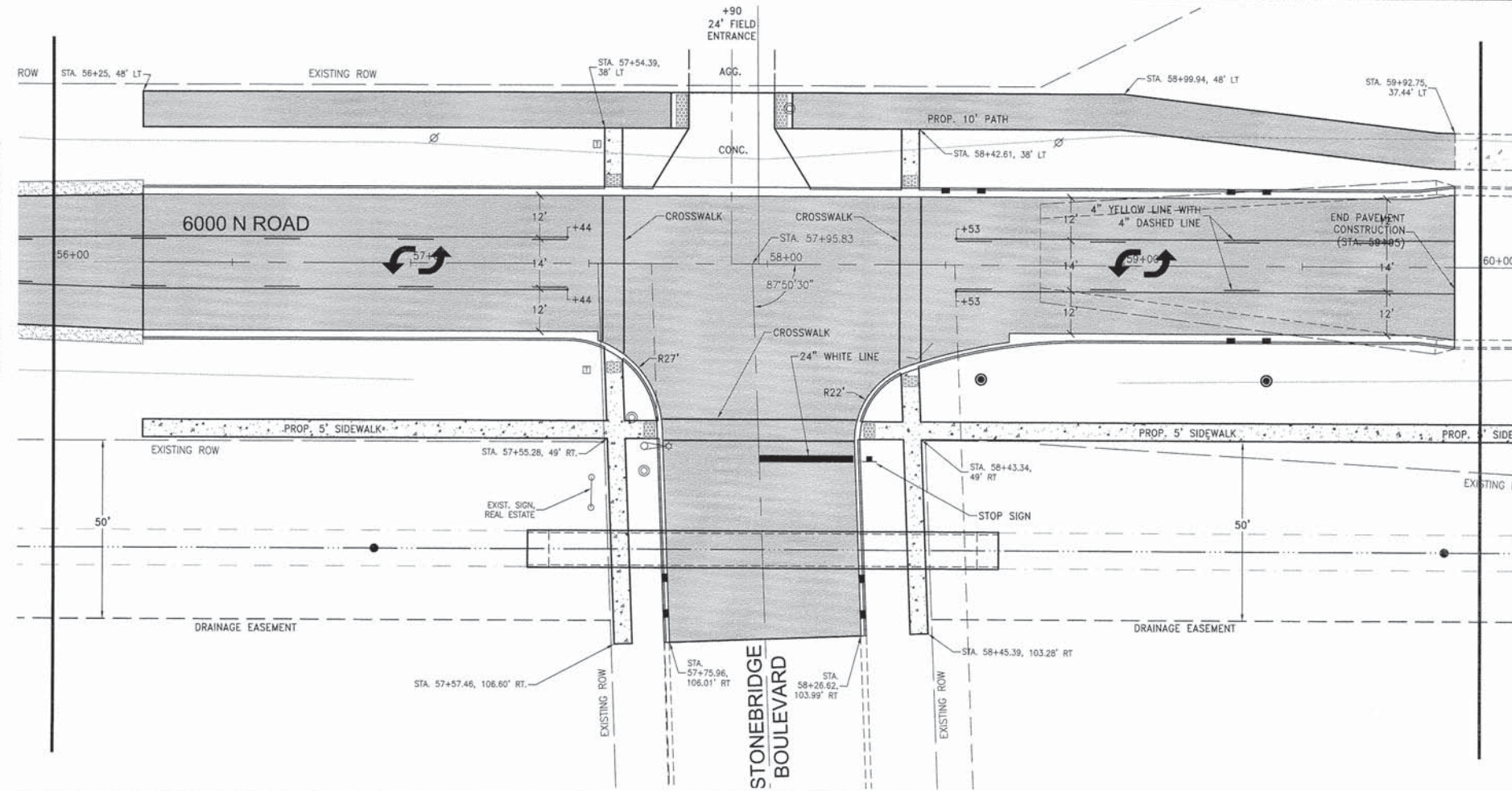

MATCH LINE - STA. 60+00
SEE SHEET 13

FAU. RTE.	SECTION	COUNTY	TOTAL SHEETS	SHEET NO.
*	**	KANKAKEE	21	12

CONTRACT NO. 87398
FED. ROAD DIST. NO. ILLINOIS FED. AID PROJECT

FAU6226
** 04-00066-00-WR

Tyson ENGINEERING
367 South Schuyler Avenue
Kankakee, Illinois 60901
Phone (815) 932-7406

This document and the ideas and designs incorporated herein, as an instrument of professional service, is the property of Tyson Engineering Inc. and is not to be used in whole or in part, for any other project without written authorization of Tyson Engineering Inc.

Do not scale drawings. Use dimensions only.
Contractor shall be responsible for verifying all dimensions.
Information hereon and herein is confidential.

REVISIONS			
NO.	DATE	BY	DESCRIPTION
1	3/25/14	NRD	PER I.D.O.T. REV.

STRIPING AND SIGNAGE PLAN

PROJECT:
**VILLAGE OF BOURBONNAIS
6000 NORTH ROAD
IMPROVEMENTS
PHASE I**
BOURBONNAIS, ILLINOIS

SECTION
04-00066-00-WR

DATE:	2/14/14	JOB NO.	E09108
SCALE:	1"=20'	FILE NO.	
DRAWN BY:	NRD	SHEET	12
CHECKED BY:	SRM		

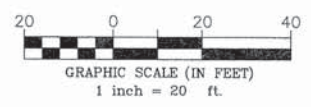
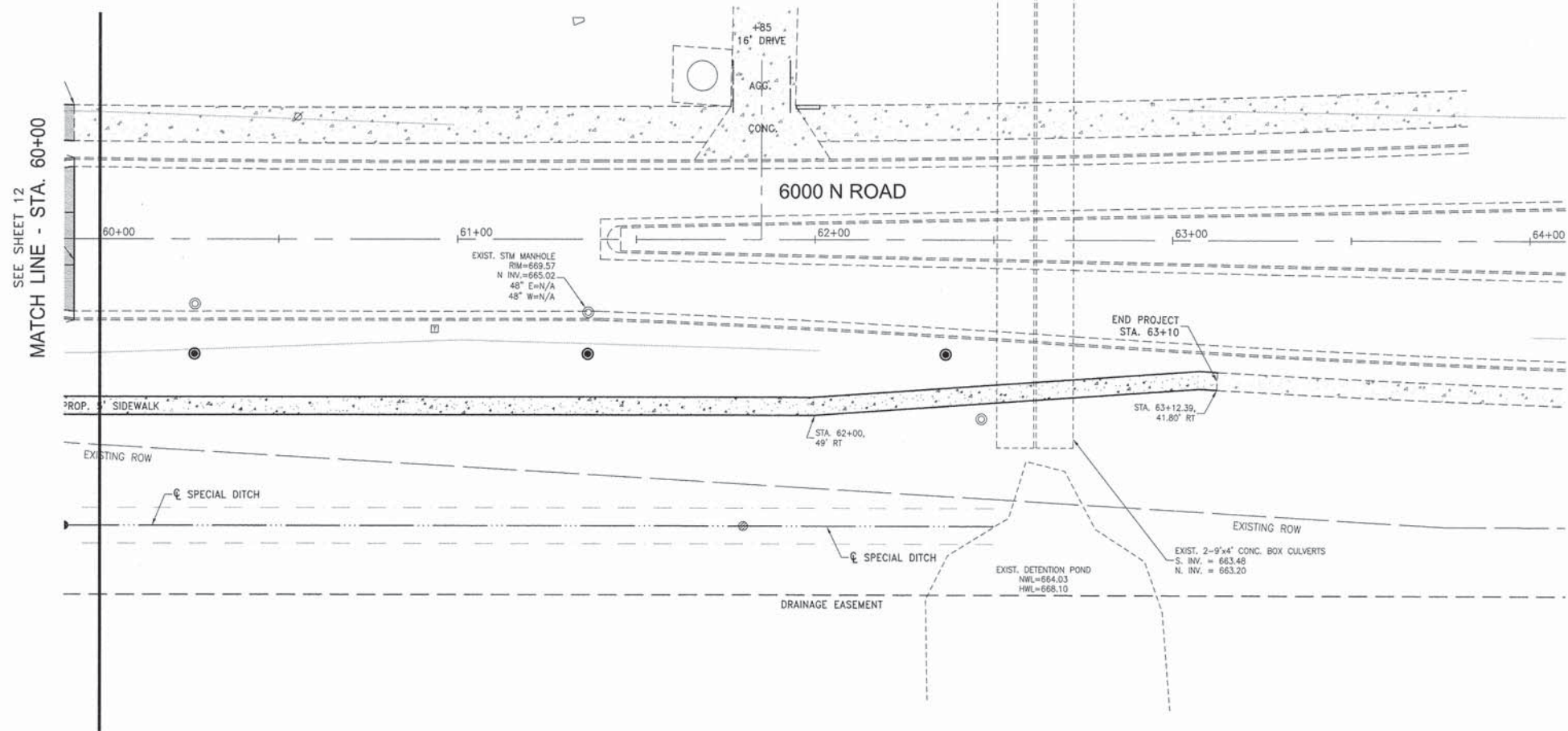

FAU. NO.	SECTION	COUNTY	TOTAL SHEETS	SHEET NO.
*	**	KANKAKEE	21	13

CONTRACT NO. 87398
 FED. ROAD DIST. NO. ILLINOIS FED. AID PROJECT

* FAU6226
 ** 04-0006-00-WR

This document and the ideas and designs incorporated herein, as an instrument of professional service, is the property of Tyson Engineering Inc. and is not to be used in whole or in part, for any other project without written authorization of Tyson Engineering Inc. Contractor shall be responsible for verifying all dimensions, information and herein to conform.

TYSON ENGINEERING
 367 South Schuyler Avenue
 Kankakee, Illinois 60901
 Phone (815) 932-7406

This document and the ideas and designs incorporated herein, as an instrument of professional service, is the property of Tyson Engineering Inc. and is not to be used in whole or in part, for any other project without written authorization of Tyson Engineering Inc. Contractor shall be responsible for verifying all dimensions, information and herein to conform.

REVISIONS

NO.	DATE	BY	DESCRIPTION
1	3/25/14	NRD	PER I.D.O.T. REV.

STRIPING AND SIGNAGE DETAILS

PROJECT:
**VILLAGE OF BOURBONNAIS
 6000 NORTH ROAD
 IMPROVEMENTS
 PHASE I**
 BOURBONNAIS, ILLINOIS

SECTION
 04-00066-00-WR

DATE:	2/14/14	JOB NO.	E09108
SCALE:	1"=20'	FILE NO.	
DRAWN BY:	NRD	SHEET	13
CHECKED BY:	SRM		21

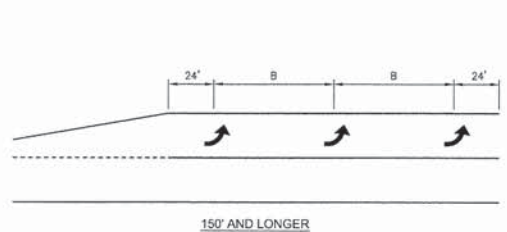
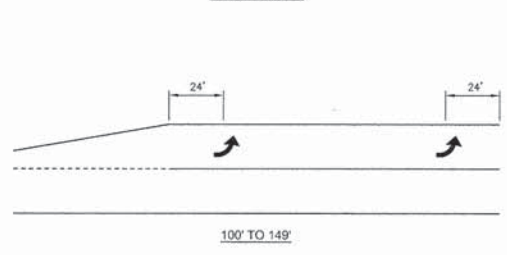
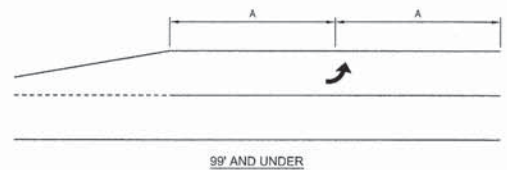

TYPICAL PLACEMENT OF ARROWS
 IN TURN LANES
 780-10

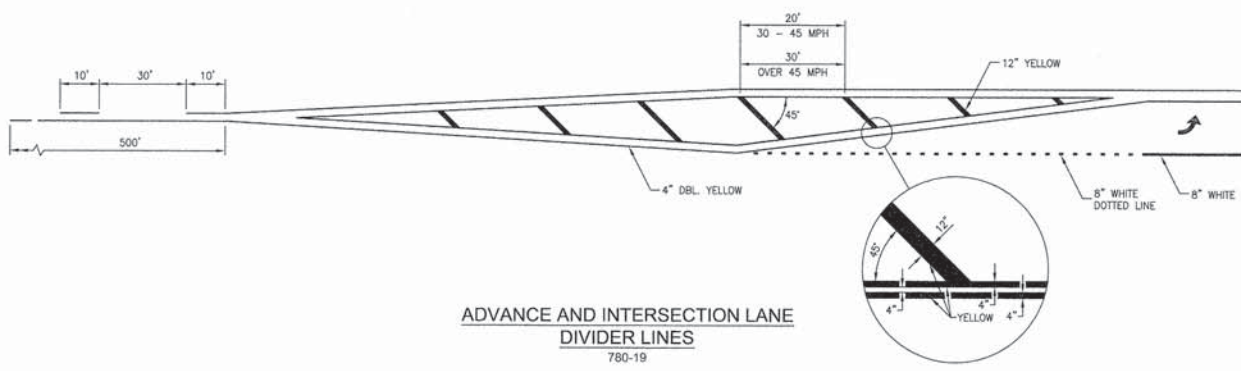

ADVANCE AND INTERSECTION LANE
 DIVIDER LINES
 780-19



TYPICAL APPLICATION
 @ LEFT TURN LANES
 780-1

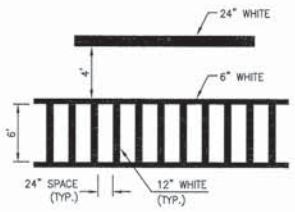

TYPICAL SPACING DETAIL FOR
 CROSSWALKS AND STOP BARS
 780-3
 OPTION 2

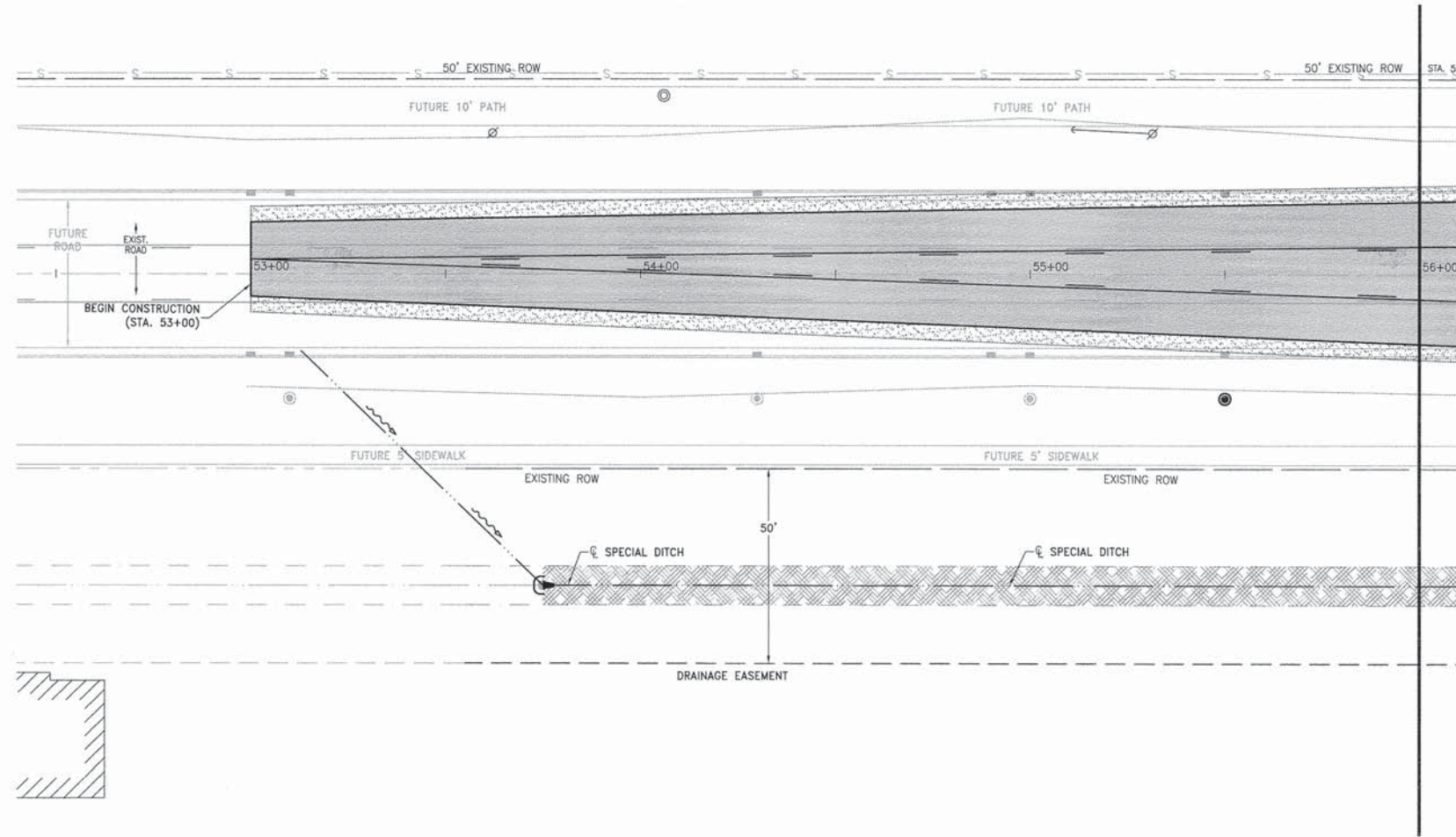

MATCH LINE - STA. 56+00
SEE SHEET 15

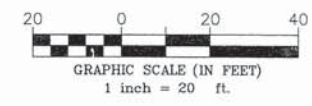

■	NEW CURB INLET	— S —	SILT FENCE WITH WIRE SUPPORT
●	NEW INLET (ROUND GRATE)	□	INLET PROTECTION
⊙	NEW MANHOLE	C	PIPE PROTECTION
▼	NEW FLARED END SECTION	▨	RIP RAP
◇	PLACEMENT OF TEMPORARY ROCK CHECK DAM (COARSE AGGREGATE) IN DRAINAGEWAY	▨	EROSION CONTROL BLANKET; INSTALL DITCH CHECKS IN ACCORDANCE WITH PLACEMENT OF TEMPORARY DITCH CHECK IN DRAINAGEWAY DETAILS

FAU. NO.	SECTION	COUNTY	TOTAL SHEETS	SHEET NO.
*	**	KANKAKEE	21	14

CONTRACT NO. 87398

FED. ROAD DIST. NO. ILLINOIS FED. AID PROJECT

* FAU6226
** 04-00066-00-WR

This document and the ideas and designs incorporated herein, as an instrument of professional service, is the property of Tyson Engineering Inc. and is not to be used in whole or in part, for any other project without written authorization of Tyson Engineering Inc. Contractor shall be responsible for verifying all dimensions, information herein and herein is confidential.

TYSON ENGINEERING
367 South Schuyler Avenue
Kankakee, Illinois 60901
Phone (815) 932-7406

This document and the ideas and designs incorporated herein, as an instrument of professional service, is the property of Tyson Engineering Inc. and is not to be used in whole or in part, for any other project without written authorization of Tyson Engineering Inc. Contractor shall be responsible for verifying all dimensions. Information hereon and herein is confidential.

NO.	DATE	BY	DESCRIPTION
1	3/25/14	NRD	PER I.D.O.T. REV.

STORM WATER POLLUTION PREVENTION PLAN

PROJECT:
VILLAGE OF BOURBONNAIS
6000 NORTH ROAD IMPROVEMENTS PHASE I
BOURBONNAIS, ILLINOIS

SECTION
04-00066-00-WR

DATE:	2/14/14	JOB NO.	E09108
SCALE:	1"=20'	FILE NO.	
DRAWN BY:	NRD	SHEET	14
CHECKED BY:	SRM		21

SEE SHEET 14
MATCH LINE - STA. 56+00

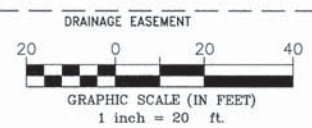
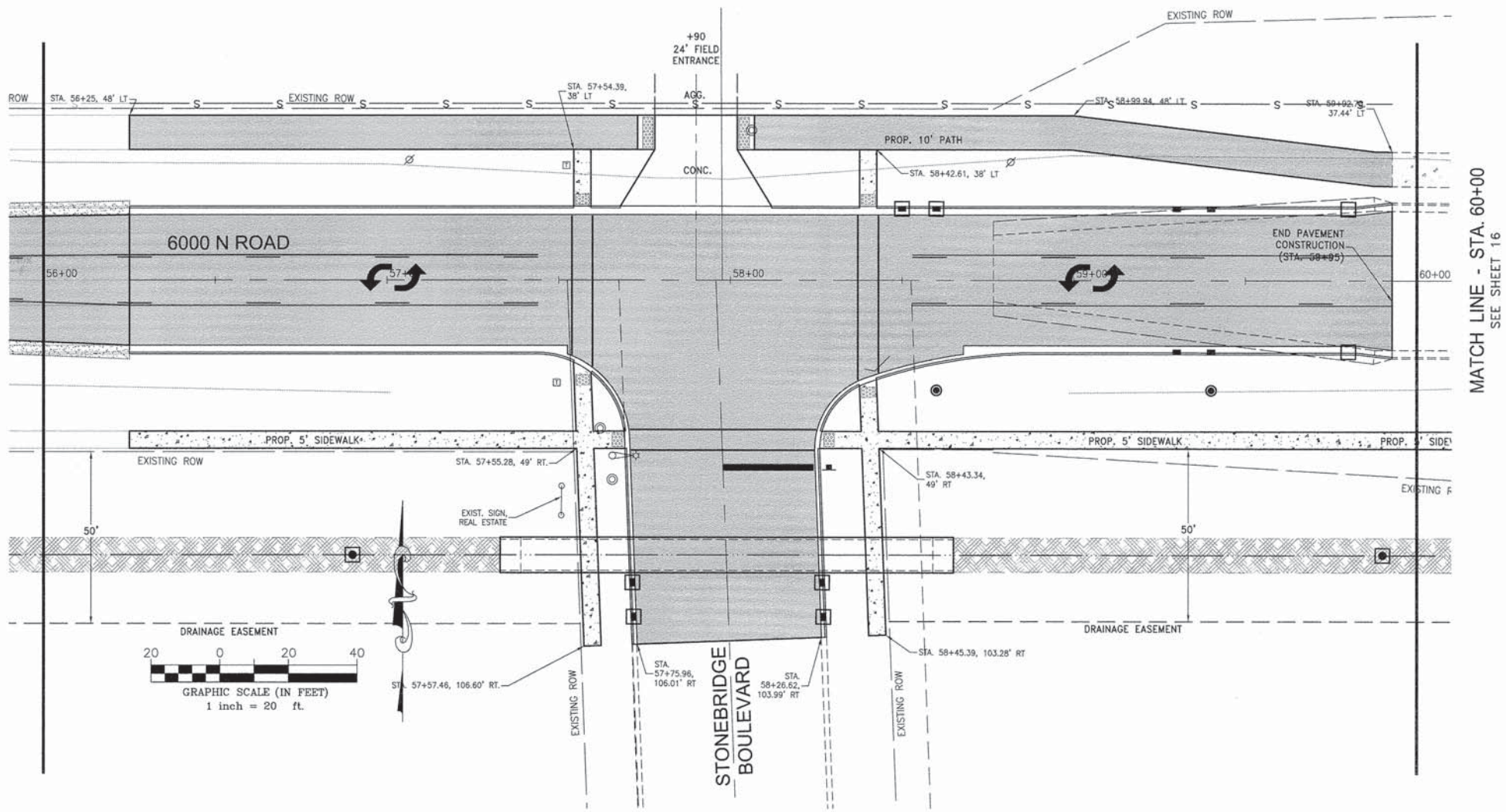

MATCH LINE - STA. 60+00
SEE SHEET 16

■	NEW CURB INLET	— S —	SILT FENCE WITH WIRE SUPPORT
●	NEW INLET (ROUND GRATE)	□	INLET PROTECTION
⊙	NEW MANHOLE	C	PIPE PROTECTION
▴	NEW FLARED END SECTION	▨	RIP RAP
◇	PLACEMENT OF TEMPORARY ROCK CHECK DAM (COARSE AGGREGATE) IN DRAINAGEWAY	▩	EROSION CONTROL BLANKET; INSTALL DITCH CHECKS IN ACCORDANCE WITH PLACEMENT OF TEMPORARY DITCH CHECK IN DRAINAGEWAY DETAILS

FAC. NO.	SECTION	COUNTY	TOTAL SHEETS	SHEET NO.
*	**	KANKAKEE	21	15

CONTRACT NO. 87398
FED. ROAD DIST. NO. ILLINOIS FED. AID PROJECT

* FAU6226
** 04-00066-00-WR

This document and the ideas and designs incorporated herein, as an instrument of professional service, is the property of Tyson Engineering Inc. and is not to be used in whole or in part, for any other project without the written authorization of Tyson Engineering Inc. The Contractor shall be responsible for verifying all dimensions, information herein and herein is confidential.

TYSON ENGINEERING
367 South Schuyler Avenue
Kankakee, Illinois 60901
Phone (815) 932-7406

This document and the ideas and designs incorporated herein, as an instrument of professional service, is the property of Tyson Engineering Inc. and is not to be used in whole or in part, for any other project without the written authorization of Tyson Engineering Inc. Do not scale drawings. Use dimensions only. Contractor shall be responsible for verifying all dimensions. Information herein and herein is confidential.

NO.	DATE	BY	DESCRIPTION
1	3/25/14	NRD	PER I.D.O.T. REV.

STORM WATER POLLUTION PREVENTION PLAN

PROJECT:
**VILLAGE OF BOURBONNAIS
6000 NORTH ROAD
IMPROVEMENTS
PHASE I
BOURBONNAIS, ILLINOIS**

SECTION	04-00066-00-WR	
DATE:	2/14/14	JOB NO. E09108
SCALE:	1"=20'	FILE NO.
DRAWN BY:	NRD	SHEET
CHECKED BY:	SRM	15

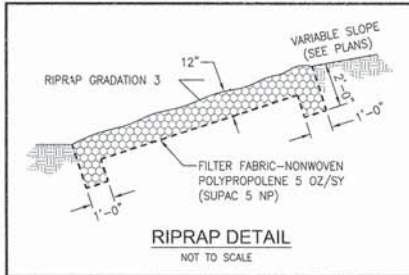
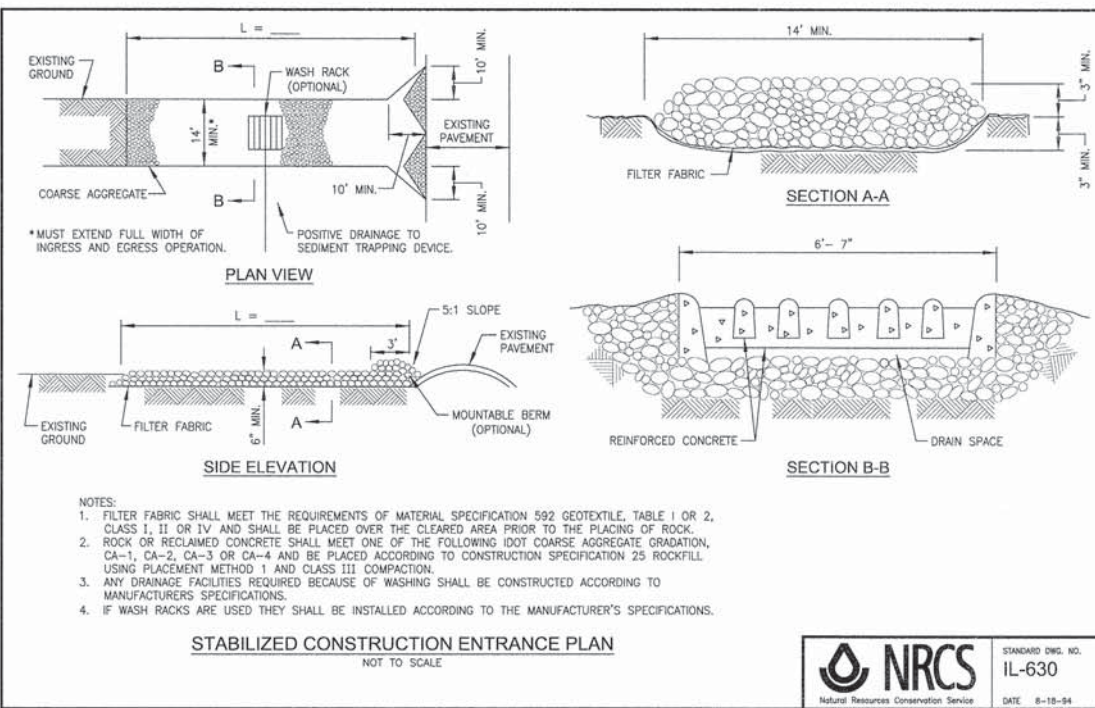
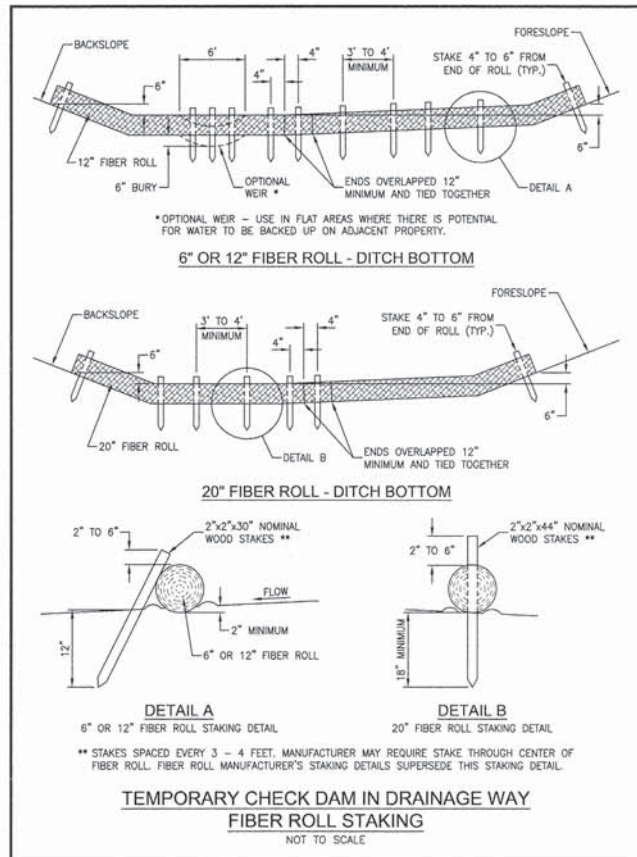
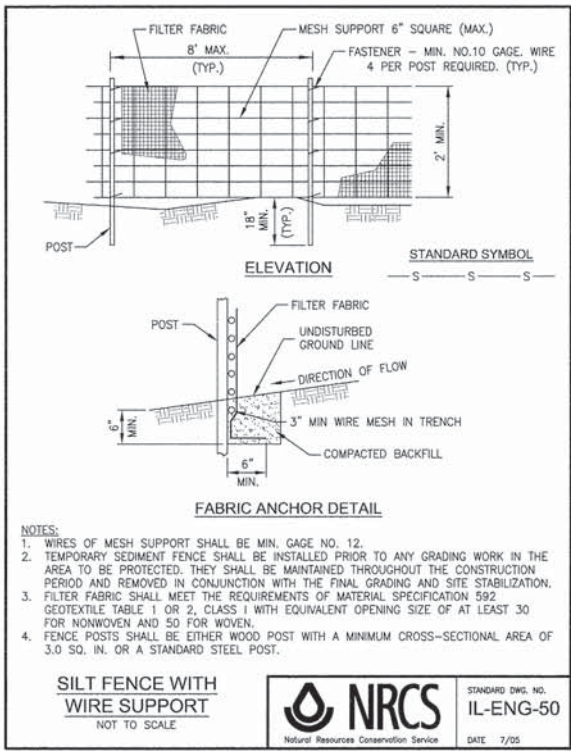
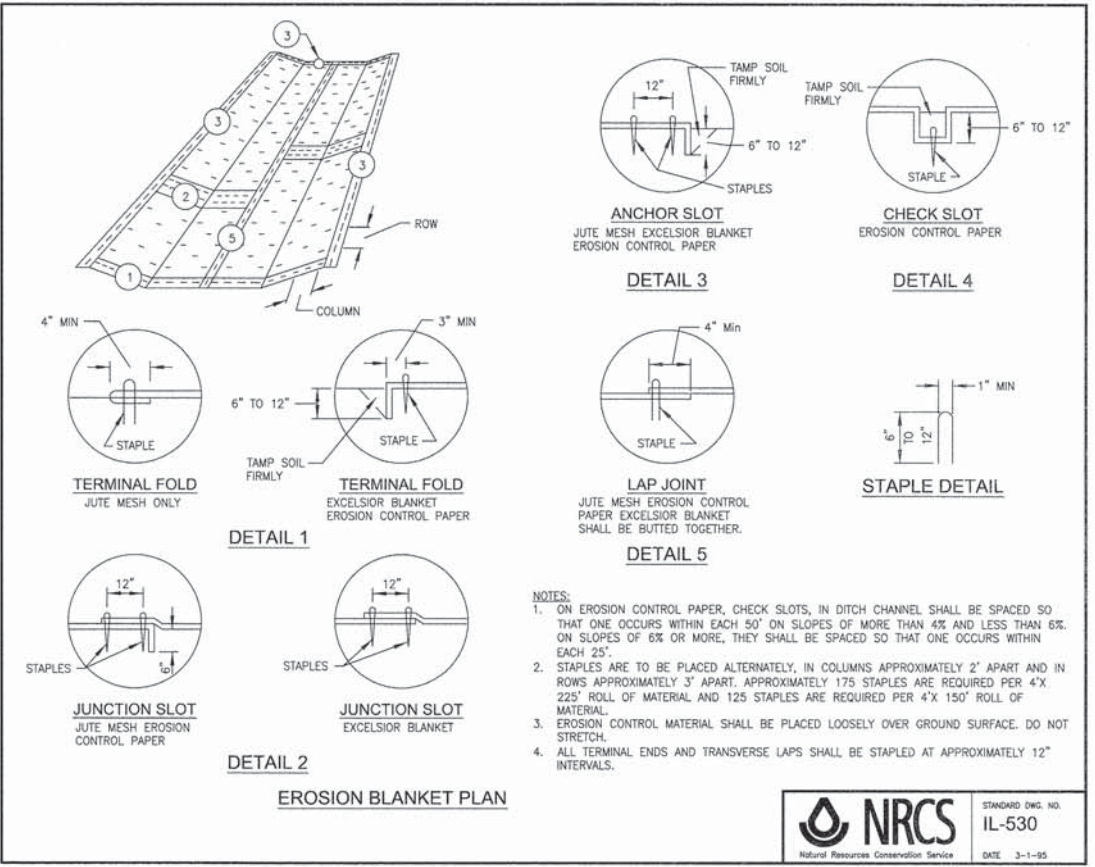
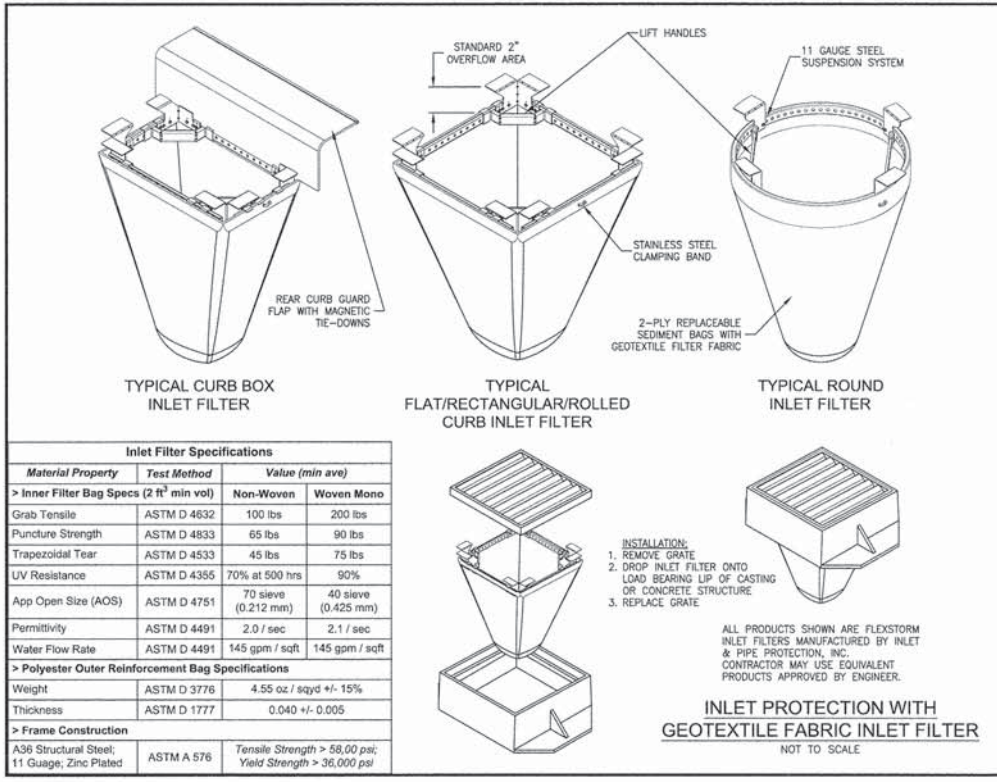

F.A. NO.	SECTION	COUNTY	TOTAL SHEETS	SHEET NO.
*	**	KANKAKEE	21	17

CONTRACT NO. 87398
FED. ROAD DIST. NO. ILLINOIS FED. AD PROJECT

* FAU6226
** 04-00066-00-WR

TYSON ENGINEERING
367 South Schuyler Avenue
Chicago, IL 60607
Phone (815) 932-7406

This document and the ideas and designs incorporated herein, as an instrument of professional service, is the property of Tyson Engineering Inc. and is not to be used in whole or in part, for any other project without written authorization of Tyson Engineering Inc.

Do not scale drawings. Use dimensions only.
Contractor shall be responsible for verifying all dimensions.
Information herein and herein is confidential.

REVISIONS				
NO.	DATE	BY	DESCRIPTION	REV.
1	3/25/14	NRD	PER I.D.O.T. REV.	

STORM WATER POLLUTION PREVENTION DETAILS

**VILLAGE OF BOURBONNAIS
6000 NORTH ROAD
IMPROVEMENTS
PHASE I
BOURBONNAIS, ILLINOIS**

PROJECT:

**SECTION
04-00066-00-WR**

DATE: 2/14/14 JOB NO. E09108
SCALE: N/A FILE NO.
DRAWN BY: NRD SHEET
CHECKED BY: SRM **17**

STANDARD D.W.G. NO. IL-ENG-50 DATE 7/05
STANDARD D.W.G. NO. IL-630 DATE 8-18-84

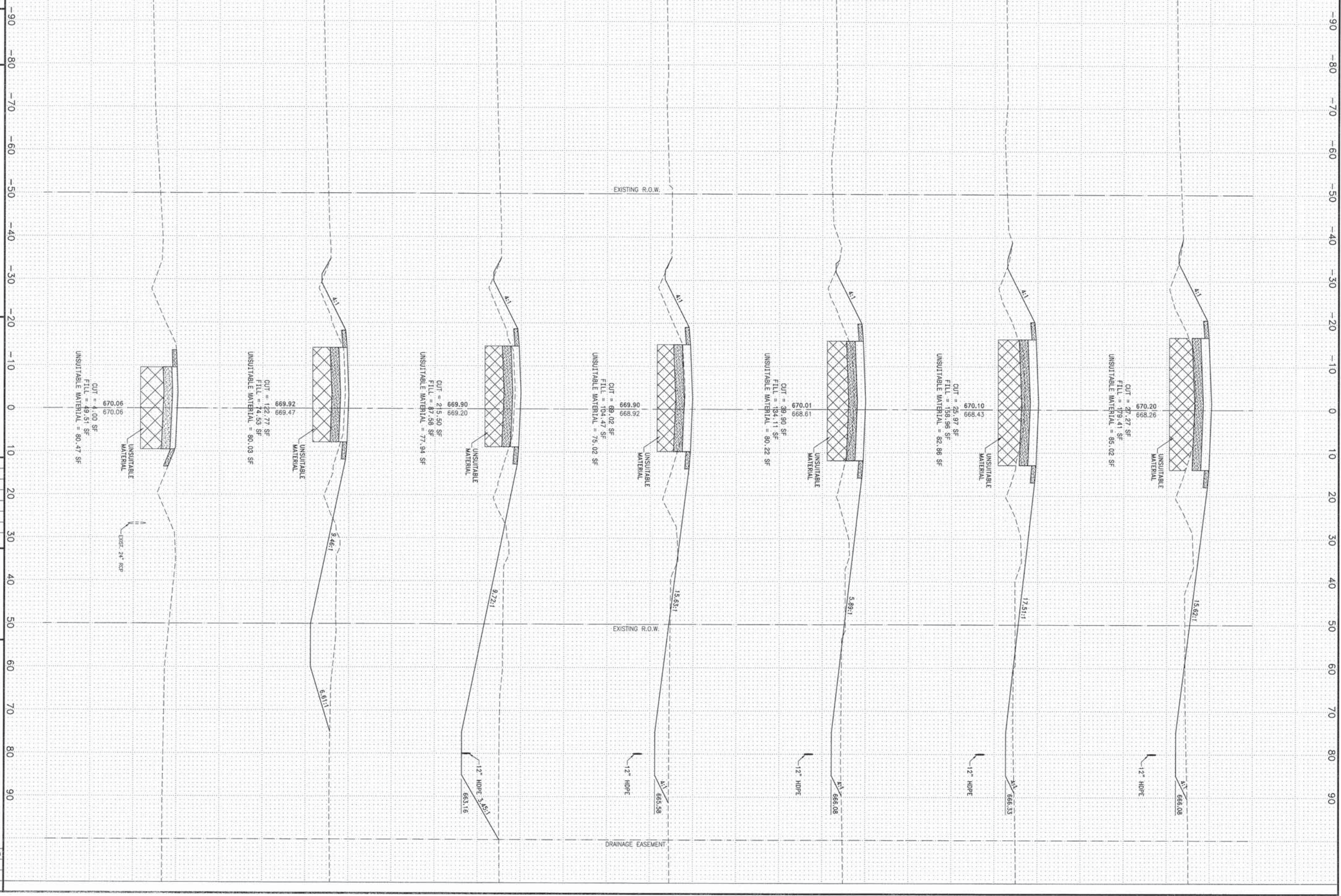

90 -80 -70 -60 -50 -40 -30 -20 -10 0 10 20 30 40 50 60 70 80 90

DATE: 2/14/14
 JOB NO. E09108
 SCALE: HORIZ: 1"=10'
 VERT: 1"=5'
 DRAWN BY: NRD
 CHECKED BY: SRM
 SHEET: 18
 21

SECTION 04-00066-00-WR
 PROJECT: VILLAGE OF BOURBONNAIS
 6000 NORTH ROAD
 IMPROVEMENTS
 PHASE I
 BOURBONNAIS, ILLINOIS

6000N ROAD
 CROSS SECTIONS
 STA. 0+00 TO STA. 0+00

NO.	DATE	BY	DESCRIPTION
1	3/25/14	NRD	PER I.D.O.T. REV.

REVISIONS

This document and the ideas and designs incorporated herein, are the intellectual property of Tyson Engineering Inc. and shall remain the property of Tyson Engineering Inc. and shall not be used in whole or in part, for any other project without written authorization of Tyson Engineering Inc. and is not to be incorporated herein, as an instrument of professional service, is the property of Tyson Engineering Inc. and is not to be used in whole or in part, for any other project without written authorization of Tyson Engineering Inc.

Do not scale drawings. Use dimensions only. Contractor shall be responsible for verifying all dimensions. Information herein and herein is confidential.

TYSON ENGINEERING
 387 South Schuyler Avenue
 Kankakee, Illinois 60901
 Phone (815) 932-7406

CONTRACT NO. 87398
 COUNTY: KANKAKEE
 SHEETS: 21
 FROM SHEET: 18

04-00066-00-WR
 FAU5228

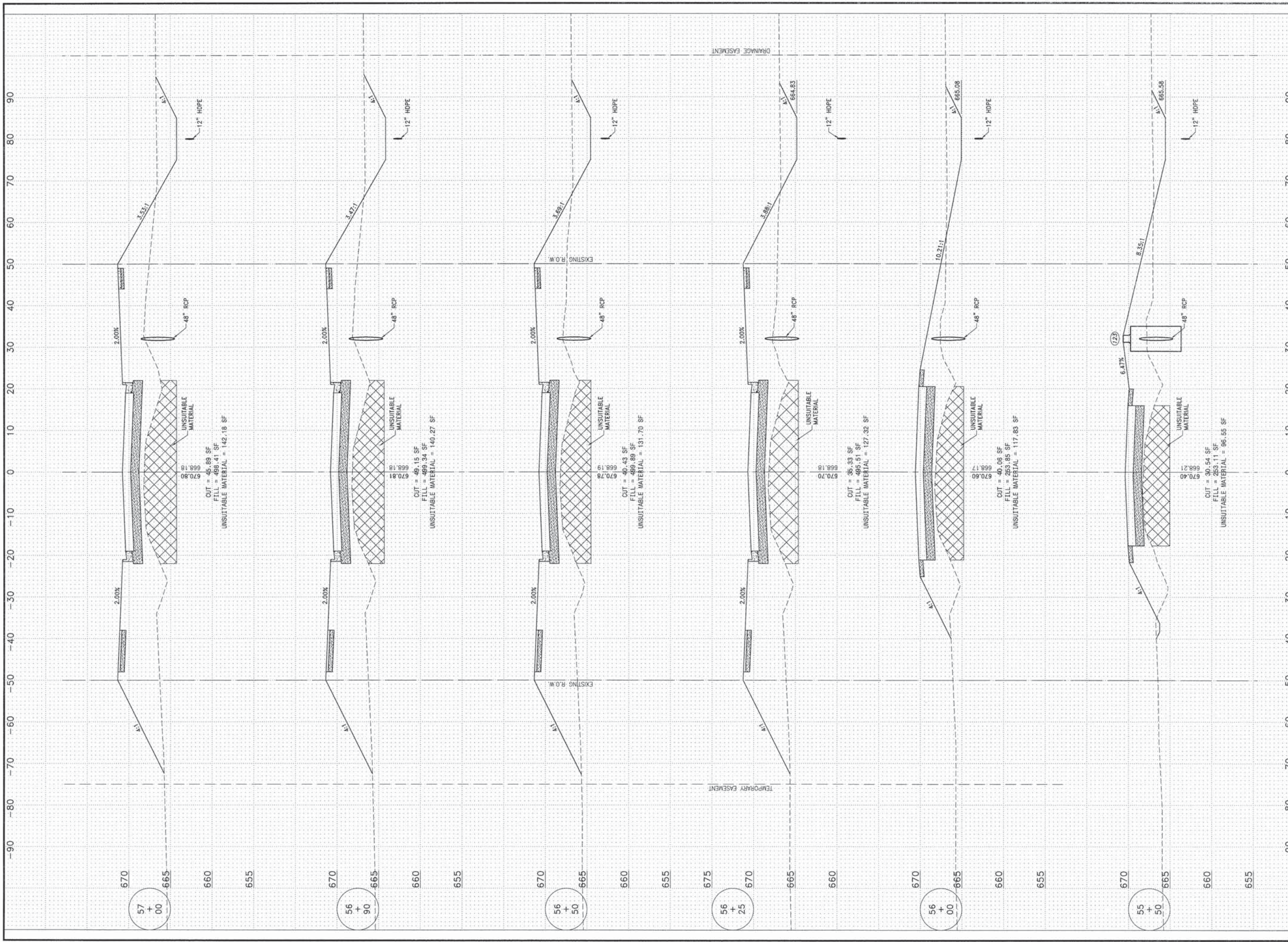

FAU NO.	SECTION	COUNTY	TOTAL SHEETS	SHEET NO.
	**	KANKAKEE	21	19

CONTRACT NO. 87398

FED. ROAD DIST. NO. ILLINOIS FED. AID PROJECT

FAU6226
04-0006-00-WR

This document and the ideas and designs incorporated herein, as an instrument of professional service, is the property of Tyson Engineering Inc. and is not to be used in whole or in part, for any other project without the written authorization of Tyson Engineering Inc. Information herein and herein is confidential.

TYSON ENGINEERING
367 South Schuyler Avenue
Kankakee, Illinois 60901
Phone (815) 932-7406

This document and the ideas and designs incorporated herein, as an instrument of professional service, is the property of Tyson Engineering Inc. and is not to be used in whole or in part, for any other project without the written authorization of Tyson Engineering Inc. Information herein and herein is confidential.

Do not scale drawings. Use dimensions only.
Contractor shall be responsible for verifying all dimensions.
Information herein and herein is confidential.

REVISIONS				
NO.	DATE	BY	DESCRIPTION	
1	3/25/14	NRD	PER	I.D.O.T. REV.

6000N ROAD
CROSS SECTIONS
STA. 0+00 TO STA. 0+00

PROJECT: VILLAGE OF BOURBONNAIS
6000 NORTH ROAD
IMPROVEMENTS
PHASE I
BOURBONNAIS, ILLINOIS

SECTION
04-0006-00-WR

DATE:	2/14/14	JOB NO.	E09108
SCALE:	HORZ.: 1"=10' VERT.: 1"=5'	FILE NO.	
DRAWN BY:	NRD	SHEET	19
CHECKED BY:	SRM		

21

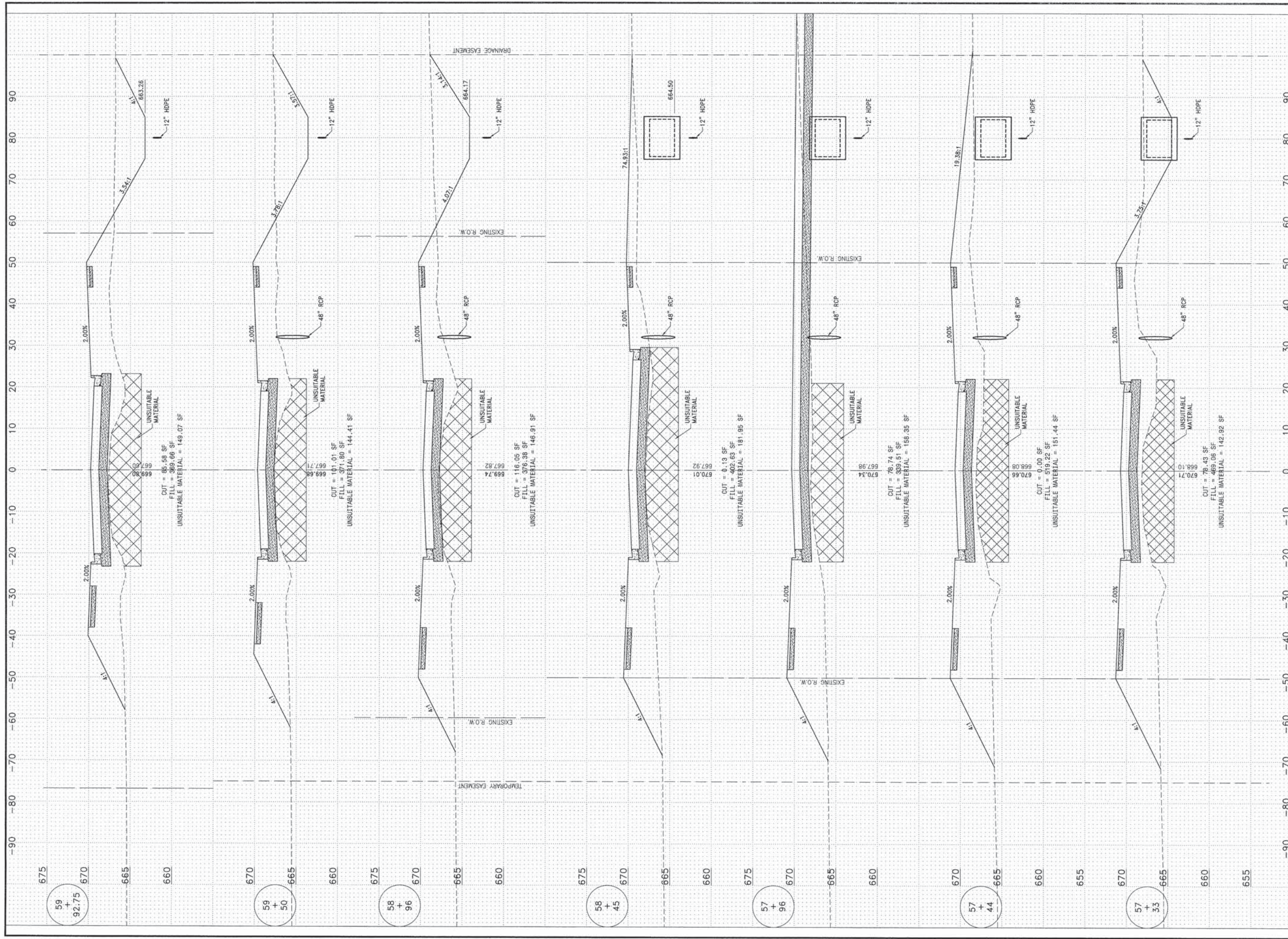

FAU REV.	SECTION	COUNTY	TOTAL SHEETS	SHEET NO.
*	**	KANKAKEE	21	20

CONTRACT NO. B7398
 FED. ROAD DIST. NO. ILLINOIS FED. AID PROJECT

FAU6226
 04-00066-00-WR

This document and the ideas and designs incorporated herein, as an instrument of professional service, is the property of Tyson Engineering Inc. and is not to be used in whole or in part, for any other project without written authorization of Tyson Engineering Inc. Contractor shall be responsible for verifying all dimensions, information herein and thereon is confidential.

TYSON ENGINEERING
 387 South Schuyler Avenue
 Kankakee, Illinois 60901
 Phone (815) 932-7400

This document and the ideas and designs incorporated herein, as an instrument of professional service, is the property of Tyson Engineering Inc. and is not to be used in whole or in part, for any other project without written authorization of Tyson Engineering Inc. Contractor shall be responsible for verifying all dimensions. Information hereon and herein is confidential.

Do not scale drawings. Use dimensions only.
 Contractor shall be responsible for verifying all dimensions.

Information hereon and herein is confidential.

REVISIONS				
NO.	DATE	BY	DESCRIPTION	
1	3/25/14	NRD	PER I.D.O.T. REV.	

6000N ROAD
 CROSS SECTIONS
 STA. 0+00 TO STA. 0+00

PROJECT: VILLAGE OF BOURBONNAIS
6000 NORTH ROAD
IMPROVEMENTS
PHASE I
 BOURBONNAIS, ILLINOIS

SECTION
 04-00066-00-WR

DATE:	2/14/14	JOB NO.	E09108
SCALE:	HORZ.: 1"=10' VERT.: 1"=5'	FILE NO.	
DRAWN BY:	NRD	SHEET	20
CHECKED BY:	SRM		

21

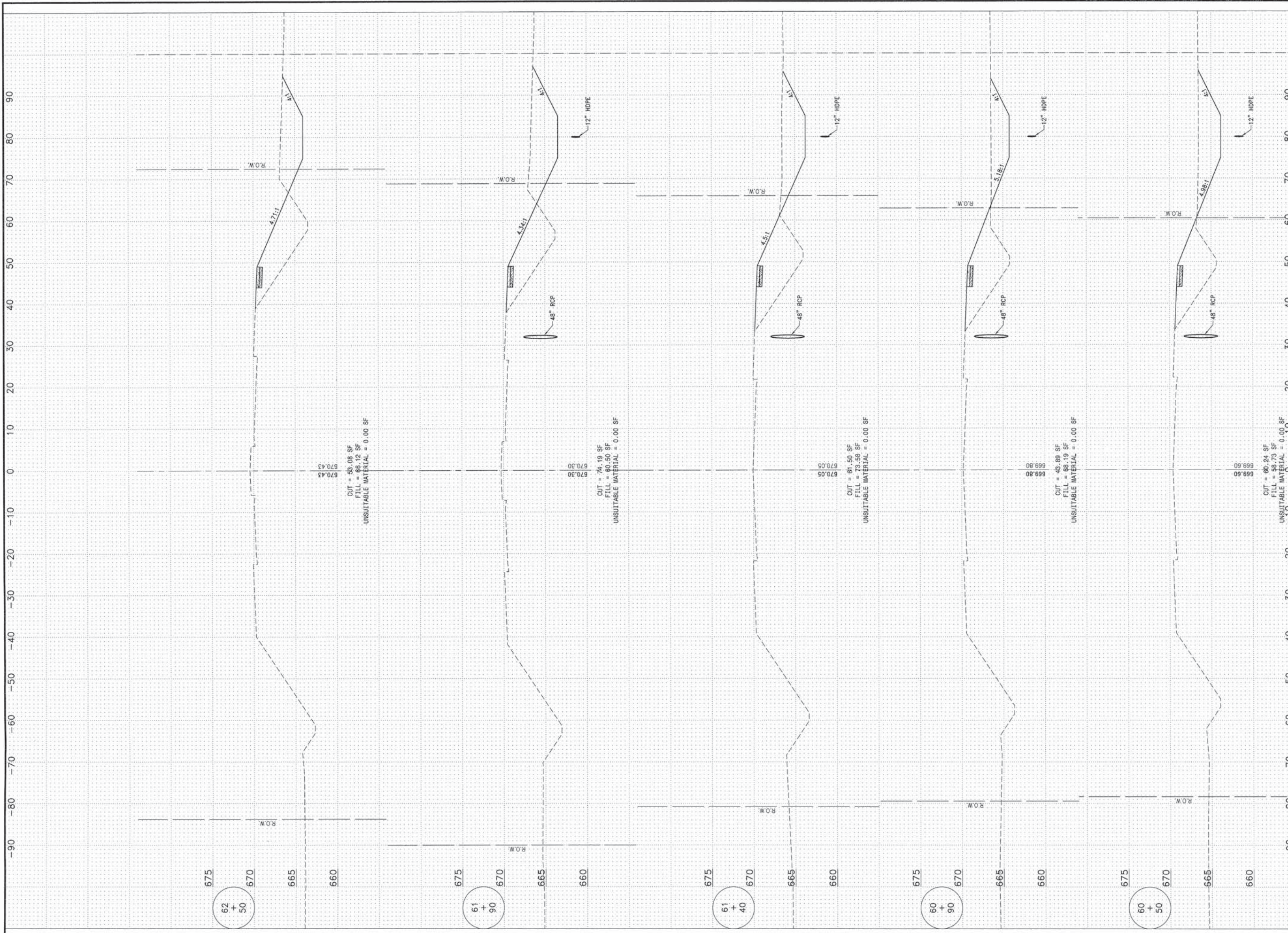

F.S. SHEET NO.	SECTION	COUNTY	TOTAL SHEETS	SHEET NO.
*	**	KANKAKEE	21	21

CONTRACT NO. 87398

FED. ROAD DIST. NO.	ILLINOIS	FED. AID PROJECT

FAU6226
04-00066-00-WR

Tyson ENGINEERING
367 South Schuyler Avenue
Kankakee, Illinois 60801
Phone (815) 932-7466

This document and the ideas and designs incorporated herein, as an instrument of professional service, is the property of Tyson Engineering Inc. and is not to be used in whole or in part, for any other project without written authorization of Tyson Engineering Inc. Contractor shall be responsible for verifying all dimensions. Information hereon and herein is confidential.

Do not scale drawings. Use dimensions only. Contractor shall be responsible for verifying all dimensions. Information hereon and herein is confidential.

REVISIONS			
NO.	DATE	BY	DESCRIPTION
1	3/25/14	NRD	PER I.D.O.T. REV.

6000 ROAD
CROSS SECTIONS
STA. 0+00 TO STA. 0+00

**VILLAGE OF BOURBONNAIS
6000 NORTH ROAD
IMPROVEMENTS
PHASE I
BOURBONNAIS, ILLINOIS**

SECTION
04-00066-00-WR

DATE:	2/14/14	JOB NO.:	E09108
SCALE:	HORZ.: 1"=10' VERT.: 1"=5'	FILE NO.:	
DRAWN BY:	NRD	SHEET	21
CHECKED BY:	SRM		