

DEPARTMENT OF TRANSPORTATION

DIVISION OF HIGHWAYS

PLANS FOR PROPOSED LOCAL AGENCY IMPROVEMENT FEDERAL-AID SECONDARY PROJECT

WESLEY ROAD GUARDRAIL SECTION: 12-00043-00-GR PROJECT: HSIP-5093(168) VILLAGE OF CREVE COEUR TAZEWELL COUNTY C-94-009-13

INDEX OF SHEETS

- 1 COVER SHEET
2 SUMMARY OF QUANTITIES, GENERAL NOTES, HORIZONTAL/VERTICAL CONTROL, LEGEND
3 TYPICAL SECTIONS
4 SCHEDULE OF QUANTITIES
5-6 PLAN SHEETS
7-8 DISTRICT 4 GUARDRAIL EROSION CONTROL TREATMENTS

HIGHWAY STANDARDS

- 635006-03 STEEL PLATE BEAM GUARDRAIL
635006-03 REFLECTOR AND TERMINAL MARKER PLACEMENT
635011-02 REFLECTOR MARKER AND MOUNTING DETAILS
701901-03 TRAFFIC CONTROL DEVICES
BLR 21-8 TYPICAL APPLICATION OF TRAFFIC CONTROL DEVICES FOR CONSTRUCTION ON RURAL HIGHWAYS

BLR 26-3 STEEL PLATE BEAM GUARDRAIL 29" HEIGHT

REVISION 6/16/14

UTILITIES

ATT/DISTRIBUTION 630-573-5450

AMEREN CILCO KENT KOWALSKIE 309-686-2616

VILLAGE OF CREVE COEUR WATER - MARK MENARD 309-613-3155

VILLAGE OF CREVE COEUR SANITARY - JEFF SHEFFLER 309-694-4101

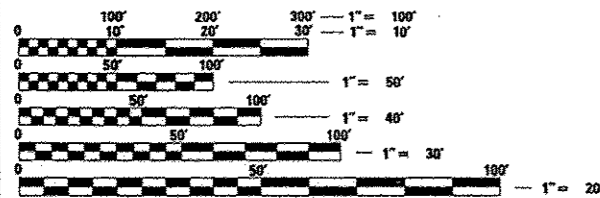

FULL SIZE PLANS HAVE BEEN PREPARED USING STANDARD ENGINEERING SCALES. REDUCED SIZED PLANS WILL NOT CONFORM TO STANDARD SCALES. IN MAKING MEASUREMENTS ON REDUCED PLANS, THE ABOVE SCALES MAY BE USED.

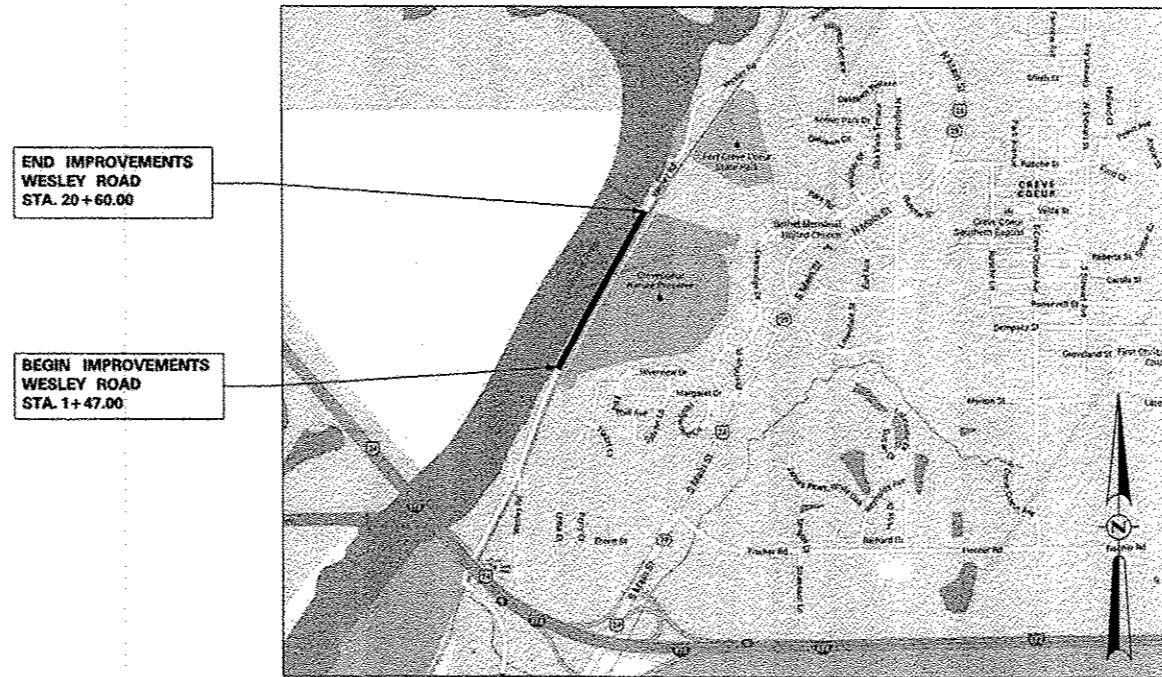

LOCATION MAP

(NOT TO SCALE)

LENGTH OF IMPROVEMENT = 1,913 FEET = 0.36 MILE

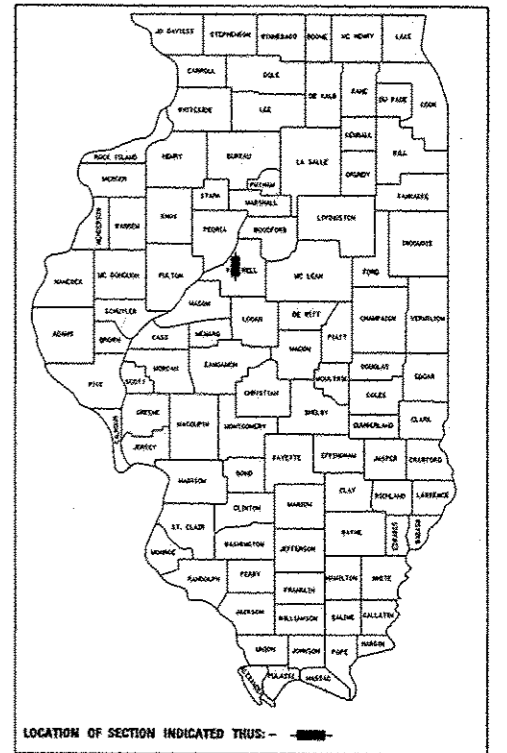

LOCATION OF SECTION INDICATED TRUS: -

APPROVED Oct. 9th 2013 Fred Lang Village of Creve Coeur, Mayor
PASSED 10-28-13 District Four Engineer of Local Roads & Streets
Releasing For Bid Based on Limited Review OCT 20 2013 Deputy Director of Highways, Region Three Engineer, State of Illinois, Department of Transportation

Alicia M. Hermann 002-058326 Licensed Professional Engineer of Illinois 10/9/13 DATE 11/30/13 EXPIRES



HERMANN & ASSOCIATES, LLC CONSULTING ENGINEERS 4603 NORTH GALENA ROAD PEORIA HEIGHTS, ILLINOIS 61616 PHONE: (309) 687-6660 FAX: (309) 687-0671 ILLINOIS PROFESSIONAL DESIGN FIRM NO. 184.004714

PRINTED BY THE AUTHORITY OF THE STATE OF ILLINOIS

CAT #: 034873-00