

STATE OF ILLINOIS
DEPARTMENT OF TRANSPORTATION

| F.A.U. RTE. | SECTION | COUNTY | TOTAL SHEETS | SHEET NO. |
|-------------|-------------|----------|--------------------|-----------|
| 1251 | 2024-1021-R | LAKE | 24 | 1 |
| | | ILLINOIS | CONTRACT NO. 62X61 | |

D-91-053-25

FOR INDEX OF SHEETS, SEE SHEET NO. 2

THE IMPROVEMENT IS LOCATED IN THE CITIES OF HIGHWOOD AND HIGHLAND PARK

TRAFFIC DATA

WALKER AVENUE
ADT: 1,100 (2023)
POSTED SPEED LIMIT: 30 MPH

PROPOSED HIGHWAY PLANS

FAU ROUTE 1251: WALKER AVE.
SHERIDAN RD/WAUKEGAN AVE TO OAK ST.
SECTION: 2024-1021-R

DESIGNED OVERLAY & ADA IMPROVEMENT LAKE COUNTY

C-91-072-25

R12E

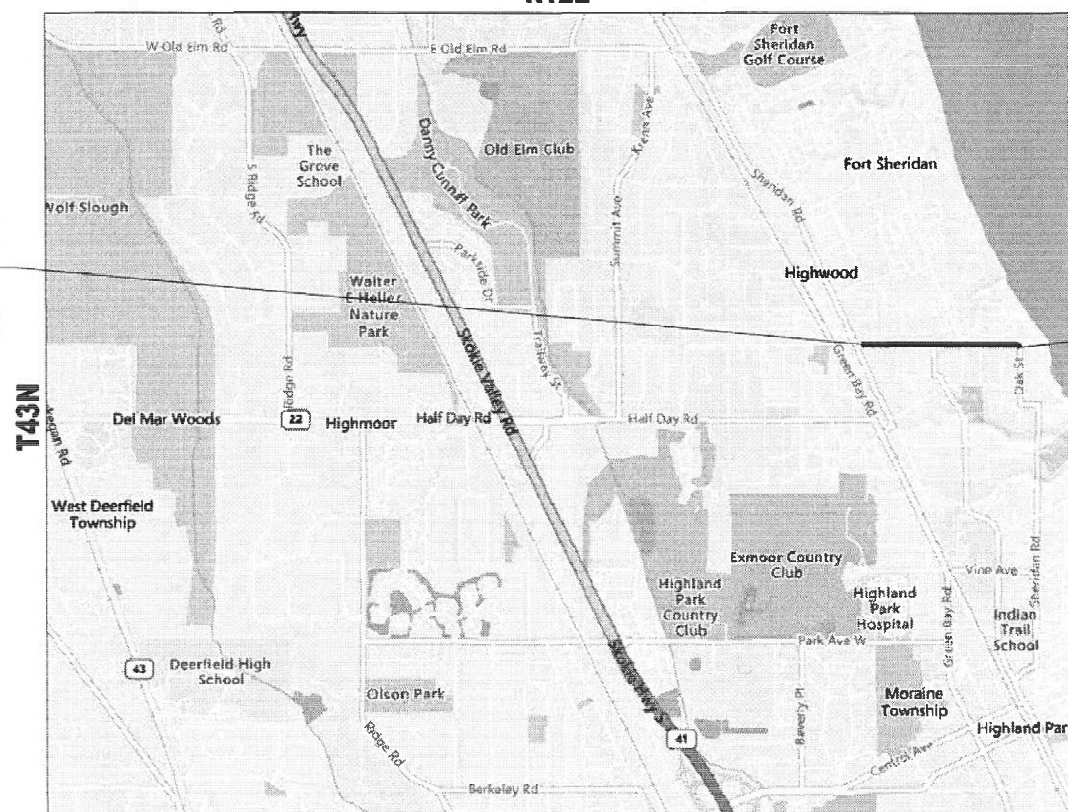

PROJECT BEGINS:
WALKER AVENUE AT
SHERIDAN RD / WAUKEGAN AVE
STATION 10+64

PROJECT ENDS:
WALKER AVENUE AT
OAK STREET
STATION 40+21

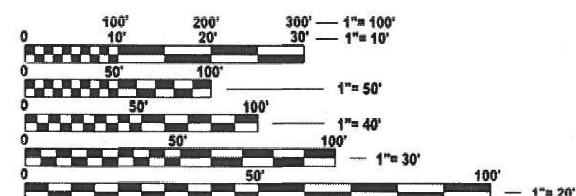

FULL SIZE PLANS HAVE BEEN PREPARED USING STANDARD ENGINEERING SCALES. REDUCED SIZED PLANS WILL NOT CONFORM TO STANDARD SCALES. IN MAKING MEASUREMENTS ON REDUCED PLANS, THE ABOVE SCALES MAY BE USED.

J.U.L.I.E.
JOINT UTILITY LOCATION INFORMATION FOR EXCAVATION
1-800-892-0123
OR 811

PROJECT ENGINEER: RODRIGO LEDEMZA (847) 705-4580
PROJECT MANAGER: J. ALAIN MIDY (847) 221-3056

CONTRACT NO. 62X61

GROSS NET LENGTH = 2,957 FT. = 0.560 MILE

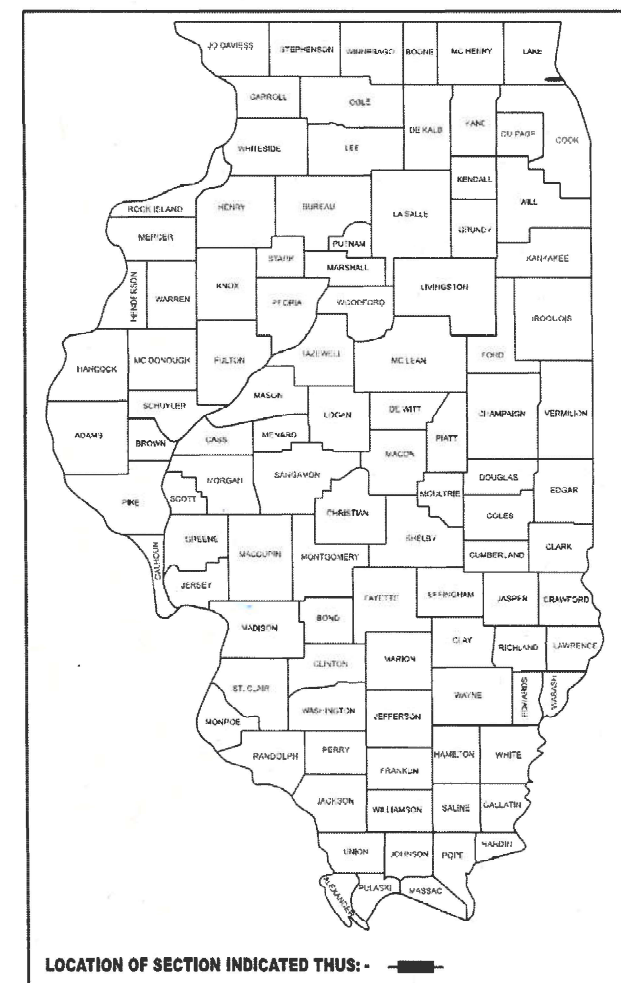

LOCATION OF SECTION INDICATED THUS: -

STATE OF ILLINOIS
DEPARTMENT OF TRANSPORTATION

SUBMITTED March 13th 2025
Jorge Lopez ^{IR}
REGIONAL ENGINEER

May 9 2025
Scott A. Etkin
ENGINEER OF DESIGN AND ENVIRONMENT

May 9 2025
Harry
DIRECTOR OF HIGHWAYS PROJECT IMPLEMENTATION

**PRINTED BY THE AUTHORITY
OF THE STATE OF ILLINOIS**

REV-SEP

INDEX OF SHEETS

SHEET NO. DESCRIPTION

| | |
|--------|---------------------------------------------------------------------------------------|
| 1. | TITLE SHEET |
| 2. | INDEX OF SHEETS, STATE STANDARDS, AND GENERAL NOTES |
| 3-4. | SUMMARY OF QUANTITIES |
| 5. | TYPICAL SECTIONS |
| 6 - 7. | ROADWAY PLAN |
| 8-9. | ADA CURB RAMP IMPROVEMENTS |
| 11-13. | PD STANDARDS |
| 14. | DRIVEWAY DETAILS- DISTANCE BETWEEN ROW AND FACE OF CURB >= 15' (4.5M) (BD-01) |
| 15. | DRIVEWAY DETAILS- DISTANCE BETWEEN ROW AND FACE OF CURB < 15' (4.5M) (BD-02) |
| 16. | FRAME AND LIDS ADJUSTMENT WITH MILLING (BD-08) |
| 17. | PAVEMENT PATCHING FOR HMA SURFACED PAVEMENT (BD-22) |
| 18. | CURB OR CURB AND GUTTER REMOVAL AND REPLACEMENT (BD-24) |
| 19. | BUTT JOINT AND HMA TAPER DETAILS (BD-32) |
| 20. | TRAFFIC CONTROL AND PROTECTION FOR SIDE ROADS, INTERSECTIONS AND DRIVEWAYS (TC-10) |
| 21. | TYPICAL APPLICATIONS RAISED REFLECTIVE PAVEMENT MARKERS (SNOW-PLOW RESISTANT) (TC-11) |
| 22. | DISTRICT ONE TYPICAL PAVEMENT MARKING (TC-13) |
| 23. | SHORT TERM PAVEMENT MARKING LETTERS AND SYMBOLS (TC-16) |
| 24. | ARTERIAL ROAD INFORMATION SIGN (TC-22) |

STATE STANDARDS

STANDARD NO. DESCRIPTION

| | |
|-----------|-------------------------------------------------------------------------|
| 000001-08 | STANDARD SYMBOLS, ABBREVIATIONS, AND PATTERNS |
| 424001-12 | PERPENDICULAR CURB RAMPS FOR SIDEWALKS |
| 424011-05 | CORNER PARALLEL CURB RAMPS FOR SIDEWALKS |
| 424021-07 | DEPRESSED CORNER FOR SIDEWALKS |
| 424026-04 | ENTRANCE / ALLEY PEDESTRIAN CROSSINGS |
| 442201-03 | CLASS C AND D PATCHES |
| 604001-05 | FRAME AND LIDS, TYPE 1 |
| 606001-08 | CONCRETE CURB TYPE B AND COMBINATION CONCRETE CURB AND GUTTER |
| 701006-05 | OFF-RD OPERATIONS, 2L, 2W, 15' (4.5M) TO 24" (600MM) FROM PAVEMENT EDGE |
| 701011-04 | OFF-RD MOVING OPERATIONS, 2L, 2W, DAY ONLY |
| 701301-04 | LANE CLOSURE, 2L, 2W, SHORT TIME OPERATIONS |
| 701311-03 | LANE CLOSURE, 2L, 2W, SLOW MOVING OPERATIONS DAY ONLY |
| 701501-06 | URBAN LANE CLOSURE, 2L, 2W, UNDIVIDED |
| 701701-10 | URBAN LANE CLOSURE, MULTILANE INTERSECTION |
| 701801-06 | SIDEWALK, CORNER OR CROSSWALK CLOSURE |
| 701901-10 | TRAFFIC CONTROL DEVICES |
| 780001-05 | TYPICAL PAVEMENT MARKINGS |
| 781001-04 | TYPICAL APPLICATIONS RAISED REFLECTIVE PAVEMENT MARKERS |

GENERAL NOTES

- THE CONTRACTOR WILL NOT BE ALLOWED TO SET UP A YARD OR FIELD OFFICE ON STATE PROPERTY WITHOUT WRITTEN PERMISSION FROM THE DEPARTMENT.
- ALL MILLED SURFACES SHALL BE A UNIFORM CROSS SLOPE PER LANE AND FREE OF RIDGES BETWEEN PASSES. ANY DEVIATIONS SHALL BE CORRECTED AT NO COST TO THE DEPARTMENT.
- BUTT JOINTS WILL BE INSTALLED AT THE ENDS OF ALL RESURFACING (WHERE RESURFACING MEETS EXISTING PAVEMENT) ACCORDING TO THE "BUTT JOINT AND HOT-MIX ASPHALT TAPER DETAILS" SHEET INCLUDED IN THE PLANS, UNLESS OTHERWISE SPECIFIED.
- ALL PAVEMENT PATCHING LOCATIONS WILL BE DETERMINED IN THE FIELD BY THE ENGINEER.
- LOCATION OF COMBINATION CONCRETE CURB AND GUTTER REMOVAL AND REPLACEMENT, WILL BE DETERMINED IN THE FIELD BY THE ENGINEER.
- TEN (10) FOOT TRANSITIONS SHALL BE USED TO MATCH PROPOSED CURB AND GUTTER AND MEDIAN ITEMS OF WORK TO EXISTING CURBS AND GUTTER AND MEDIANS IN THE FIELD, UNLESS OTHERWISE SHOWN.
- SIDEWALK REMOVAL AND P.C.C. SIDEWALK 5" LOCATIONS SHALL BE DETERMINED BY THE ENGINEER.
- DRAINAGE ADJUSTMENT OR RECONSTRUCTION LOCATIONS WILL BE DETERMINED IN THE FIELD BY THE ENGINEER.
- IT SHALL BE THE CONTRACTOR'S RESPONSIBILITY TO VERIFY ALL DIMENSIONS AND CONDITIONS EXISTING IN THE FIELD PRIOR TO CONSTRUCTION AND ORDERING OF MATERIALS.
- FRAMES AND GRATES ADJUSTMENT OF PRIVATE UTILITIES WITHIN THE LIMITS OF THE IMPROVEMENTS SHALL BE DONE BY THEIR RESPECTIVE OWNERS AND ARE NOT PART OF THIS CONTRACT.
- THE CONTRACTOR SHALL BE REQUIRED TO KEEP A RECORD OF THE LOCATIONS OF THE BURIED STRUCTURES ACCORDING TO THE STATION AND DISTANCE LEFT OR RIGHT OF THE CENTERLINE OF PAVEMENT. UPON COMPLETION OF THE WORK, THE CONTRACTOR SHALL DELIVER THE RECORD TO THE ENGINEER.
- EXISTING BROKEN FRAMES AND LIDS SHALL BE REMOVED AND DISPOSED OF BY THE CONTRACTOR AND SHALL BE REPLACED AS DIRECTED BY THE ENGINEER. REPLACEMENT FRAMES AND LIDS WILL BE PAID FOR ACCORDING TO ARTICLE 109.04 OF THE STANDARD SPECIFICATIONS UNLESS A SEPARATE PAY ITEM HAS BEEN PROVIDED.
- THE CONTRACTOR SHALL CONTACT THE DISTRICT TRAFFIC CONTROL SUPERVISOR AT KALPANA.KANNAN-HOSADURGA@ILLINOIS.GOV A MINIMUM OF 72 HOURS IN ADVANCE OF BEGINNING WORK.
- THE RESIDENT ENGINEER SHALL CONTACT PATRICE HARRIS AREA TRAFFIC FIELD TECHNICIAN, AT PATRICE.HARRIS@ILLINOIS.GOV, A MINIMUM OF TWO (2) WEEKS PRIOR TO THE PLACEMENT OF PERMANENT PAVEMENT MARKINGS.
- PAVEMENT MARKING TAPE, TYPE IV SHALL BE USED FOR SHORT TERM PAVEMENT MARKINGS ON ALL FINAL SURFACES.
- OVERNIGHT LANE CLOSURES SHALL NOT BE ALLOWED FOR REHABILITATION PROJECTS INVOLVING DAYTIME MILLING AND RESURFACING OPERATIONS AND CLASS D PATCHING UNLESS OTHER CONDITIONS WARRANT EXTENDED LANE CLOSURES AS DETERMINED AND APPROVED IN WRITING BY THE ENGINEER OR AS PROVIDED FOR IN THE CONTRACT SPECIFICATIONS.
- BEFORE BEGINNING ANY WORK, THE CONTRACTOR SHALL RETAIN AND RECORD FOR FUTURE REFERENCE, ALL EXISTING PAVEMENT MARKING LINES (AND RAISED REFLECTIVE PAVEMENT MARKERS) IN ORDER THAT THESE LOCATIONS CAN BE RE-ESTABLISHED FOR STRIPING. EXACT LOCATIONS OF ALL PAVEMENT MARKINGS SHALL BE AS DIRECTED BY THE ENGINEER.
- THE CONTRACTOR SHALL BE REQUIRED TO PROVIDE ACCESS TO ABUTTING PROPERTY AT ALL TIMES DURING THE CONSTRUCTION OF THIS PROJECT.

MODEL: GenNotesSh01 [Sheet]
FILE NAME: c:\pw_work\pwwork\pwwork\1042128D105325-shh-gennote.dgn

| | | | | | | | | | | | | | |
|--|---------------------------------|------------|-----------|---------------------------------------------------|---------------------------------------------------------------------------------------------|-------|------|--------|--------------------|-------------|-----------------------------|-----------------|--------------|
| | USER NAME = ivan.diaz | DESIGNED - | REVISED - | STATE OF ILLINOIS DEPARTMENT OF TRANSPORTATION | INDEX OF SHEETS, HIGHWAY STANDARDS & GENERAL NOTES WALKER AVE FROM SHERIDAN RD TO OAK ST | | | | F.A.U RTE. | SECTION | COUNTY | TOTAL SHEETS | SHEET NO. |
| | | DRAWN - | REVISED - | | | | | | 1251 | 2024-1021-R | LAKE | 24 | 2 |
| | PLOT SCALE = 0.16666633 ' / in. | CHECKED - | REVISED - | | | | | | CONTRACT NO. 62X61 | | | | |
| | PLOT DATE = 3/18/2025 | DATE - | REVISED - | | SCALE: | SHEET | OF 1 | SHEETS | STA. | TO STA. | ILLINOIS FED. AID PROJECT | | |

MODEL: SOQ01 [Sheet]
FILE NAME: c:\pwr_work\pwwild\pwwild\1042128\105325-shk-SOQ.dgn

| SUMMARY OF QUANTITIES | | | | | TYPE CODE | | | | | |
|-----------------------|----------|------------------------------------------------------|----------------|----------------|--------------------------------|------------|-------|-------|-------|-------|
| | | | | | URBAN | URBAN | URBAN | URBAN | URBAN | URBAN |
| | | | | | ROADWAY | ROADWAY | | | | |
| | | | | | 100% STATE | 100% STATE | | | | |
| | Code No. | Item | Unit | Total Quantity | 0005 | 0005 | | | | |
| | 20200100 | EARTH EXCAVATION | CU YD | 35 | 35 | 0 | | | | |
| | | | | | | | | | | |
| | 21101615 | TOPSOIL FURNISH AND PLACE, 4" | SQ YD | 187 | 187 | 0 | | | | |
| | | | | | | | | | | |
| | 25200110 | SODDING, SALT TOLERANT | SQ YD | 187 | 187 | 0 | | | | |
| | | | | | | | | | | |
| | 25200200 | SUPPLEMENTAL WATERING | UNIT | 2 | 2 | 0 | | | | |
| | | | | | | | | | | |
| | 35501308 | HOT-MIX ASPHALT BASE COURSE, 6" | SQ YD | 186 | 186 | 0 | | | | |
| | | | | | | | | | | |
| | 35501316 | HOT-MIX ASPHALT BASE COURSE, 8" | SQ YD | 32 | 32 | 0 | | | | |
| | | | | | | | | | | |
| | 40600290 | BITUMINOUS MATERIALS (TACK COAT) | POUND | 6885 | 6885 | 0 | | | | |
| | | | | | | | | | | |
| | 40600370 | LONGITUDINAL JOINT SEALANT | FOOT | 3400 | 3400 | 0 | | | | |
| | | | | | | | | | | |
| | 40600400 | MIXTURE FOR CRACKS, JOINTS, AND FLANGEWAYS | TON | 16 | 16 | 0 | | | | |
| | | | | | | | | | | |
| | 40600982 | HOT-MIX ASPHALT SURFACE REMOVAL - BUTT JOINT | SQ YD | 160 | 160 | 0 | | | | |
| | | | | | | | | | | |
| | 40601005 | HOT-MIX ASPHALT REPLACEMENT OVER PATCHES | TON | 233 | 233 | 0 | | | | |
| | | | | | | | | | | |
| | 40602978 | HOT-MIX ASPHALT BINDER COURSE, IL- 9.5, N50 | TON | 1143 | 1143 | 0 | | | | |
| | | | | | | | | | | |
| | 40604060 | HOT-MIX ASPHALT SURFACE COURSE, IL-9.5, MIX "D", N50 | TON | 1025 | 1025 | 0 | | | | |
| | | | | | | | | | | |
| | 40800050 | INCIDENTAL HOT-MIX ASPHALT SURFACING | TON | 5 | 5 | 0 | | | | |
| | | | | | | | | | | |
| | 42001300 | PROTECTIVE COAT | SQ YD | 1862 | 1862 | 0 | | | | |
| | | | | | | | | | | |
| | 42300200 | PORTLAND CEMENT CONCRETE DRIVEWAY PAVEMENT, 6 INCH | SQ YD | 186 | 186 | 0 | | | | |
| | | | | | | | | | | |
| | 42300400 | PORTLAND CEMENT CONCRETE DRIVEWAY PAVEMENT, 8 INCH | SQ YD | 91 | 91 | 0 | | | | |
| | | | | | | | | | | |
| | 42400200 | PORTLAND CEMENT CONCRETE SIDEWALK 5 INCH | SQ FT | 6454 | 6454 | 0 | | | | |
| | | | | | | | | | | |
| | 42400800 | DETECTABLE WARNINGS | SQ FT | 255 | 255 | 0 | | | | |
| | | | | | | | | | | |
| | 44000164 | HOT-MIX ASPHALT SURFACE REMOVAL, 3 3/4" | SQ YD | 10199 | 10199 | 0 | | | | |
| | | | | | | | | | | |
| | 44000200 | DRIVEWAY PAVEMENT REMOVAL | SQ YD | 495 | 495 | 0 | | | | |
| | | | | | | | | | | |
| | | | | | | | | | | |
| | | | | | | | | | | |
| | | USER NAME = ivan.diaz | DESIGNED - | REVISED - | STATE OF I DEPARTMENT OF TR | | | | | |
| | | | DRAWN - | REVISED - | | | | | | |
| | | PLOT SCALE = 0.16666633 ' / in. | CHECKED - | REVISED - | | | | | | |
| | | PLOT DATE = 3/18/2025 | DATE - | REVISED - | | | | | | |

MODEL: SOQ02 [Sheet]
FILE NAME: c:\pwr_work\pwr\old\pwr\1042\28D\105325-shk-SOQ.dgn

| SUMMARY OF QUANTITIES | | | | | TYPE CODE | | | | | |
|-----------------------|----------|-----------------------------------------------------------------------------------|------------|----------------|--------------------------------|------------|-------|-------|-------|-------|
| | | | | | URBAN | URBAN | URBAN | URBAN | URBAN | URBAN |
| | | | | | ROADWAY | ROADWAY | | | | |
| | | | | | 100% STATE | 100% STATE | | | | |
| | Code No. | Item | Unit | Total Quantity | 0005 | 0005 | | | | |
| | 70300100 | SHORT TERM PAVEMENT MARKING | FOOT | 4694 | 4694 | 0 | | | | |
| | | | | | | | | | | |
| | 70300150 | SHORT TERM PAVEMENT MARKING REMOVAL | SQ FT | 1878 | 1878 | 0 | | | | |
| | | | | | | | | | | |
| | 70300221 | TEMPORARY PAVEMENT MARKING - LINE 4"- PAINT | FOOT | 6618 | 6618 | 0 | | | | |
| | | | | | | | | | | |
| | 70300261 | TEMPORARY PAVEMENT MARKING - LINE 12"- PAINT | FOOT | 2690 | 2690 | 0 | | | | |
| | | | | | | | | | | |
| | 70300281 | TEMPORARY PAVEMENT MARKING - LINE 24"- PAINT | FOOT | 338 | 338 | 0 | | | | |
| | | | | | | | | | | |
| | 70307120 | TEMPORARY PAVEMENT MARKING - LINE 4" - TYPE IV TAPE | FOOT | 939 | 939 | 0 | | | | |
| | | | | | | | | | | |
| * | 72400205 | REMOVE AND RELOCATE SIGN PANEL ASSEMBLY - TYPE A | EACH | 2 | 2 | 0 | | | | |
| | | | | | | | | | | |
| * | 78000200 | THERMOPLASTIC PAVEMENT MARKING - LINE 4" | FOOT | 3309 | 3309 | 0 | | | | |
| | | | | | | | | | | |
| * | 78000600 | THERMOPLASTIC PAVEMENT MARKING - LINE 12" | FOOT | 1345 | 1345 | 0 | | | | |
| | | | | | | | | | | |
| * | 78000650 | THERMOPLASTIC PAVEMENT MARKING - LINE 24" | FOOT | 169 | 169 | 0 | | | | |
| | | | | | | | | | | |
| * | 78100100 | RAISED REFLECTIVE PAVEMENT MARKER | EACH | 55 | 55 | 0 | | | | |
| | | | | | | | | | | |
| | 78300200 | RAISED REFLECTIVE PAVEMENT MARKER REMOVAL | EACH | 55 | 55 | 0 | | | | |
| | | | | | | | | | | |
| | 78300202 | PAVEMENT MARKING REMOVAL - WATER BLASTING | SQ FT | 5572 | 5572 | 0 | | | | |
| | | | | | | | | | | |
| | X0320050 | CONSTRUCTION LAYOUT (SPECIAL) | L SUM | 1 | 1 | 0 | | | | |
| | | | | | | | | | | |
| | X2020110 | GRADING AND SHAPING SHOULDERS | UNIT | 21 | 21 | 0 | | | | |
| | | | | | | | | | | |
| | X4060995 | TEMPORARY RAMP (SPECIAL) | SQ YD | 146 | 146 | 0 | | | | |
| | | | | | | | | | | |
| | X4400501 | COMBINATION CURB AND GUTTER REMOVAL AND REPLACEMENT LESS THAN OR EQUAL TO 10 FEET | FOOT | 66 | 66 | 0 | | | | |
| | | | | | | | | | | |
| | X4400503 | COMBINATION CURB AND GUTTER REMOVAL AND REPLACEMENT GREATER THAN 10 FEET | FOOT | 3147 | 3147 | 0 | | | | |
| | | | | | | | | | | |
| | X5537800 | STORM SEWERS TO BE CLEANED 12" | FOOT | 750 | 0 | 750 | | | | |
| | | | | | | | | | | |
| | X6030310 | FRAMES AND LIDS TO BE ADJUSTED (SPECIAL) | EACH | 7 | 7 | 0 | | | | |
| | | | | | | | | | | |
| | X6700407 | ENGINEER'S FIELD OFFICE, TYPE A (D1) | CAL MO | 12 | 12 | 0 | | | | |
| | | | | | | | | | | |
| | | | | | | | | | | |
| | | | | | | | | | | |
| | | USER NAME = ivan.diaz | DESIGNED - | REVISED - | STATE OF I DEPARTMENT OF TR | | | | | |
| | | | DRAWN - | REVISED - | | | | | | |
| | | PLOT SCALE = 0.16666633 ' / in. | CHECKED - | REVISED - | | | | | | |
| | | PLOT DATE = 3/18/2025 | DATE - | REVISED - | | | | | | |

MODEL: WALKER - RdwayPlan01 (Sheet)
FILE NAME: c:\pwworking\oldiazad\042128\DWG\05325-shh-plan.dgn

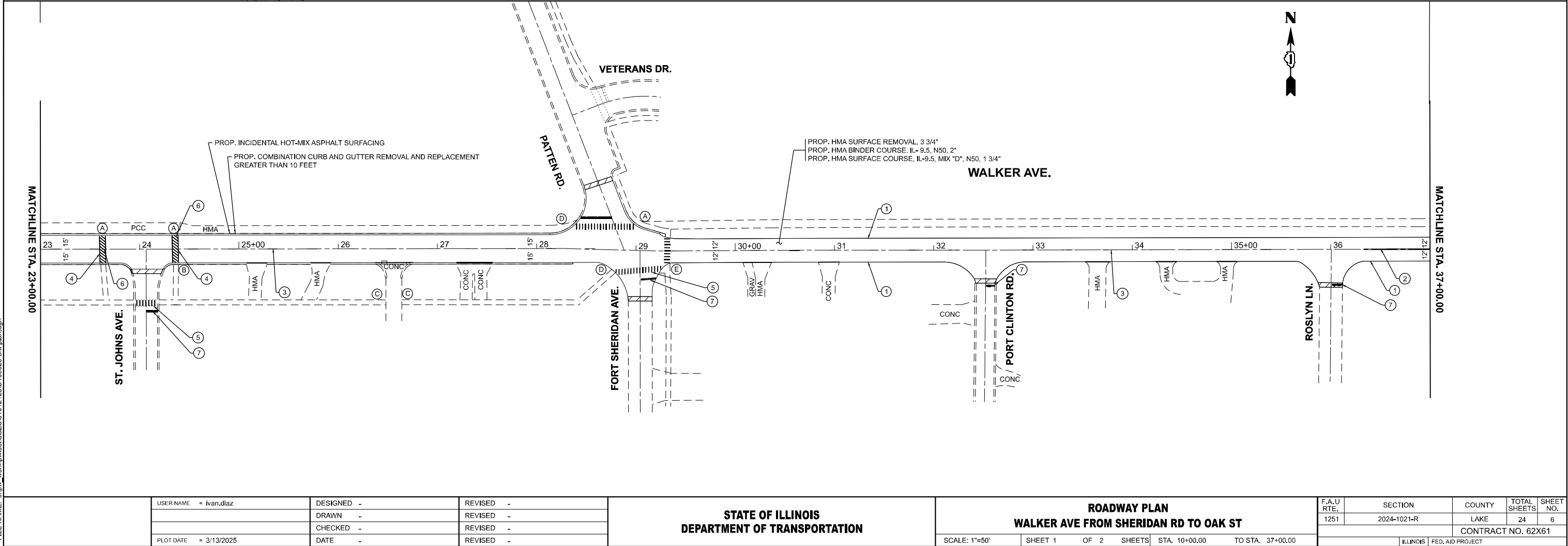
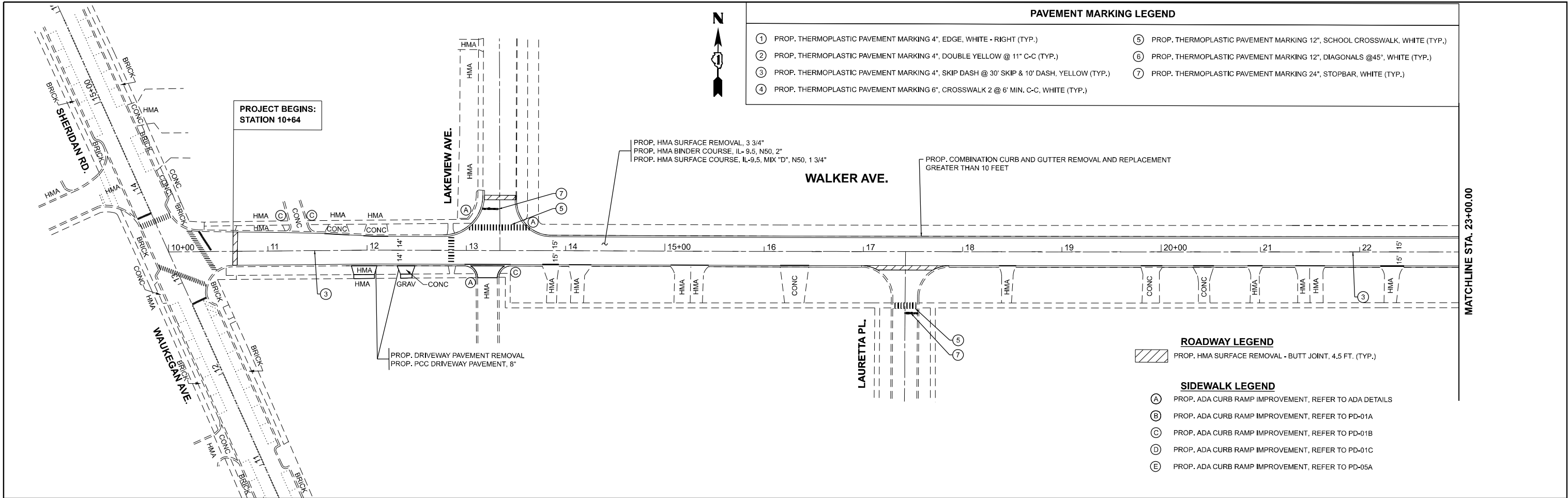

| | | | | | | |
|--|-----------|-------------|----------|---|---------|---|
| | USER NAME | = ivan.diaz | DESIGNED | - | REVISED | - |
| | | | DRAWN | - | REVISED | - |
| | | | CHECKED | - | REVISED | - |
| | PLOT DATE | = 3/13/2025 | DATE | - | REVISED | - |

| | |
|---------------------------------------------------|--|
| STATE OF ILLINOIS DEPARTMENT OF TRANSPORTATION | |
| | |
| | |
| | |

| | |
|---------------------------------------|---------------------|
| ROADWAY PLAN | |
| WALKER AVE FROM SHERIDAN RD TO OAK ST | |
| SCALE: 1"=50' | SHEET 1 OF 2 SHEETS |
| STA. 10+00.00 | TO STA. 37+00.00 |

| | | | | |
|---------------------------|-------------|--------|-----------------|--------------|
| F.A.U RTE. | SECTION | COUNTY | TOTAL SHEETS | SHEET NO. |
| 1251 | 2024-1021-R | LAKE | 24 | 6 |
| CONTRACT NO. 62X61 | | | | |
| ILLINOIS FED. AID PROJECT | | | | |

MODEL: WALKER - RdwayPlan03 (Sheet)
FILE NAME: c:\pwworking\oldiazad\042128\105325-shh-plan.dgn

PAVEMENT MARKING LEGEND

- 1

PROP. THERMOPLASTIC PAVEMENT MARKING 4", EDGE, WHITE - RIGHT (TYP.)
- 2

PROP. THERMOPLASTIC PAVEMENT MARKING 4", DOUBLE YELLOW @ 11" C-C (TYP.)
- 3

PROP. THERMOPLASTIC PAVEMENT MARKING 4", SKIP DASH @ 30' SKIP & 10' DASH, YELLOW (TYP.)
- 4

PROP. THERMOPLASTIC PAVEMENT MARKING 6", CROSSWALK 2 @ 6' MIN. C-C, WHITE (TYP.)
- 5

PROP. THERMOPLASTIC PAVEMENT MARKING 12", SCHOOL CROSSWALK, WHITE (TYP.)
- 6

PROP. THERMOPLASTIC PAVEMENT MARKING 12", DIAGONALS @45°, WHITE (TYP.)
- 7

PROP. THERMOPLASTIC PAVEMENT MARKING 24", STOPBAR, WHITE (TYP.)

ROADWAY LEGEND

- PROP. HMA SURFACE REMOVAL - BUTT JOINT, 4.5 FT. (TYP.)

SIDEWALK LEGEND

- A

PROP. ADA CURB RAMP IMPROVEMENT, REFER TO ADA DETAILS
- B

PROP. ADA CURB RAMP IMPROVEMENT, REFER TO PD-01A
- C

PROP. ADA CURB RAMP IMPROVEMENT, REFER TO PD-01B
- D

PROP. ADA CURB RAMP IMPROVEMENT, REFER TO PD-01C
- E

PROP. ADA CURB RAMP IMPROVEMENT, REFER TO PD-05A

- PROP. HMA SURFACE REMOVAL, 3 3/4"
- PROP. HMA BINDER COURSE, IL-9.5, N50, 2"
- PROP. HMA SURFACE COURSE, IL-9.5, MIX "D", N50, 1 3/4"

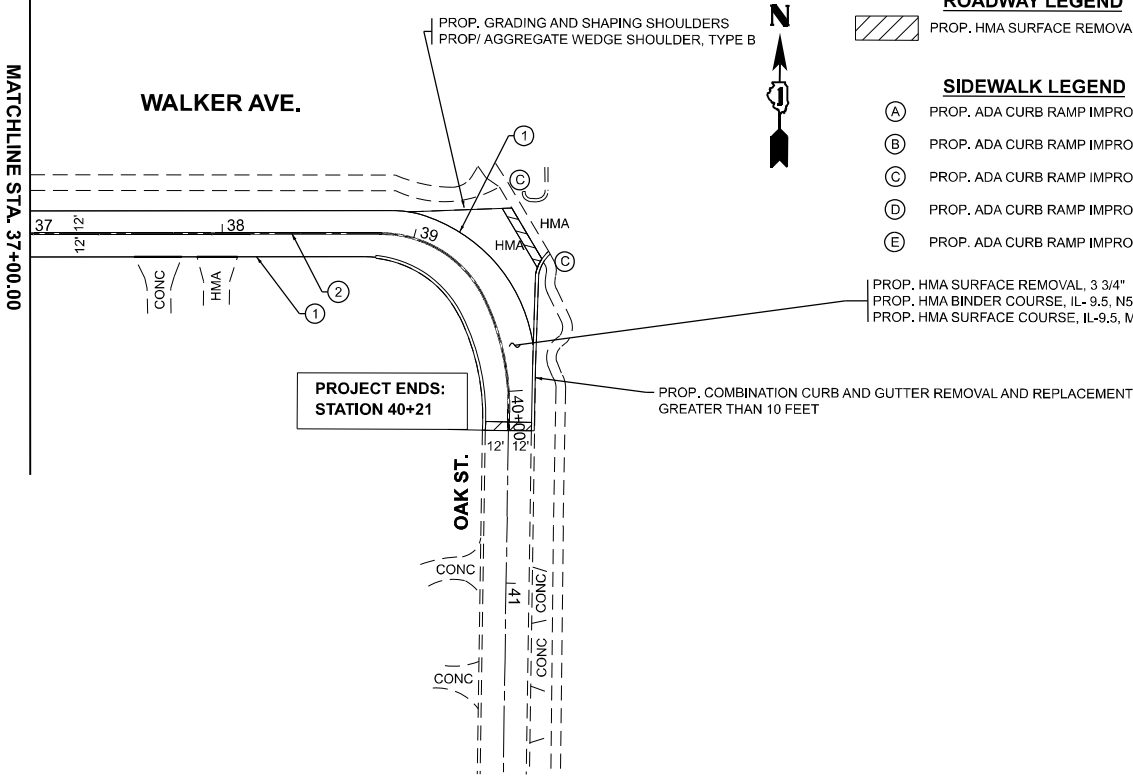

STATE OF ILLINOIS
DEPARTMENT OF TRANSPORTATION

ROADWAY PLAN
WALKER AVE FROM SHERIDAN RD TO OAK ST

| | | | | | |
|-----------|-------------|----------|---|---------|---|
| USER NAME | = ivan.diaz | DESIGNED | - | REVISED | - |
| | | DRAWN | - | REVISED | - |
| | | CHECKED | - | REVISED | - |
| PLOT DATE | = 3/18/2025 | DATE | - | REVISED | - |

SCALE: 1"=50' SHEET 2 OF 2 SHEETS STA. 37+00.00 TO STA. 51+00.00

| F.A.U RTE. | SECTION | COUNTY | TOTAL SHEETS | SHEET NO. |
|---------------------------|-------------|--------|-----------------|--------------|
| 1251 | 2024-1021-R | LAKE | 24 | 7 |
| CONTRACT NO. 62X61 | | | | |
| ILLINOIS FED. AID PROJECT | | | | |

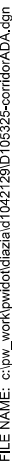
XX.XX¹

EXISTING LENGTH

== PROPOSED SIDE CURB

() EXISTING ELEVATION/SLOPE



PROPOSED SIDEWALK

DETECTABLE WARNINGS

**SIDEWALK REMOVAL
REPLACE W/TOPSOIL & SOD**

REFERENCE BENCHMARK ELEVATION: 670.33

BENCHMARK: "X" ON WEST BOLT OF FIRE HYDRANT

LOCATION: SOUTHWEST CORNER OF WALKER AVENUE AND ST. JOHN AVENUE

| | | |
|-----------------------|------------|-----------|
| USER NAME = Ivan,diaz | DESIGNED - | REVISED - |
| | DRAWN - | REVISED - |
| | CHECKED - | REVISED - |
| PLOT DATE = 3/18/2025 | DATE - | REVISED - |

STATE OF ILLINOIS
DEPARTMENT OF TRANSPORTATION

ADA CURB RAMP IMPROVEMENTS WALKER AVE FROM SHERIDAN RD TO OAK ST

| | | |
|--------|------------------------|------------------------------|
| SCALE: | SHEET A002 OF 3 SHEETS | STA. 0+00.00 TO STA. 0+00.00 |
|--------|------------------------|------------------------------|

| | | | | |
|---------------|-------------|--------------------|-----------------|--------------|
| F.A.U RTE. | SECTION | COUNTY | TOTAL SHEETS | SHEET NO. |
| 1251 | 2024-1021-R | LAKE | 24 | 9 |
| | | CONTRACT NO. 62X61 | | |
| ILLINOIS | | FED. AID PROJECT | | |

ADA DETAIL FOR SINGLE PERPENDICULAR CURB RAMPS W/ EXIST. 5% OR LESS RUN. SLOPE

PD-01A

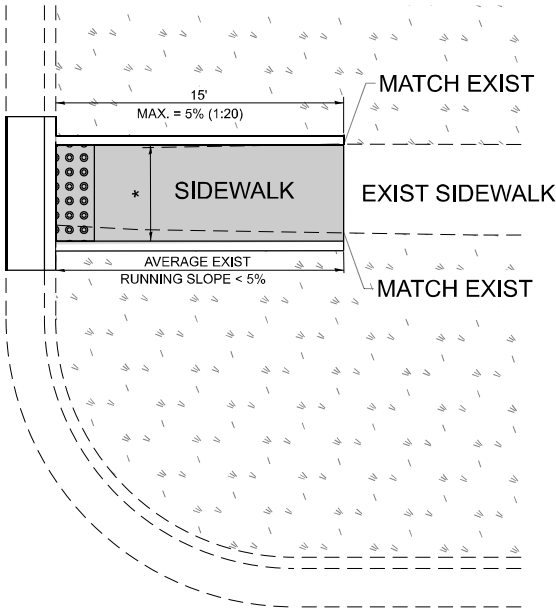

PD-01B

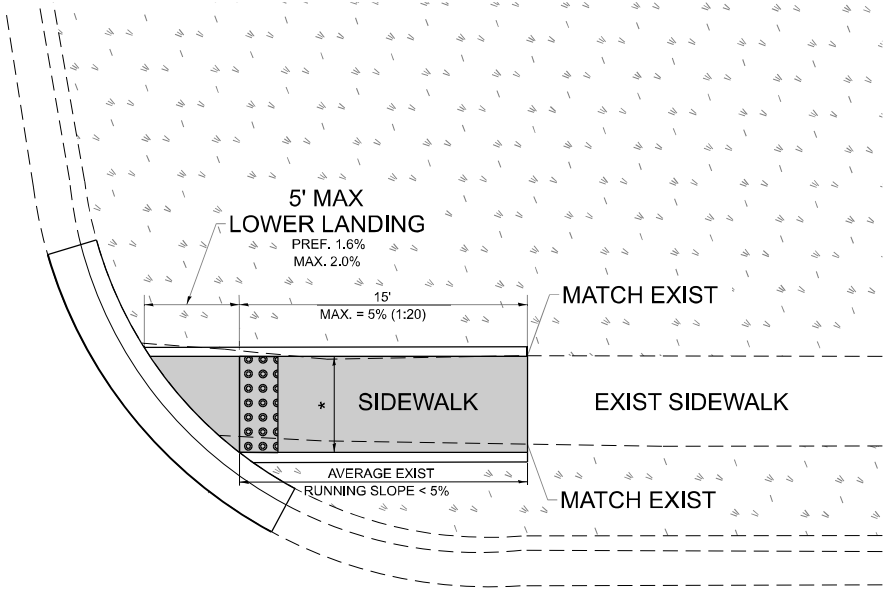

PD-01C

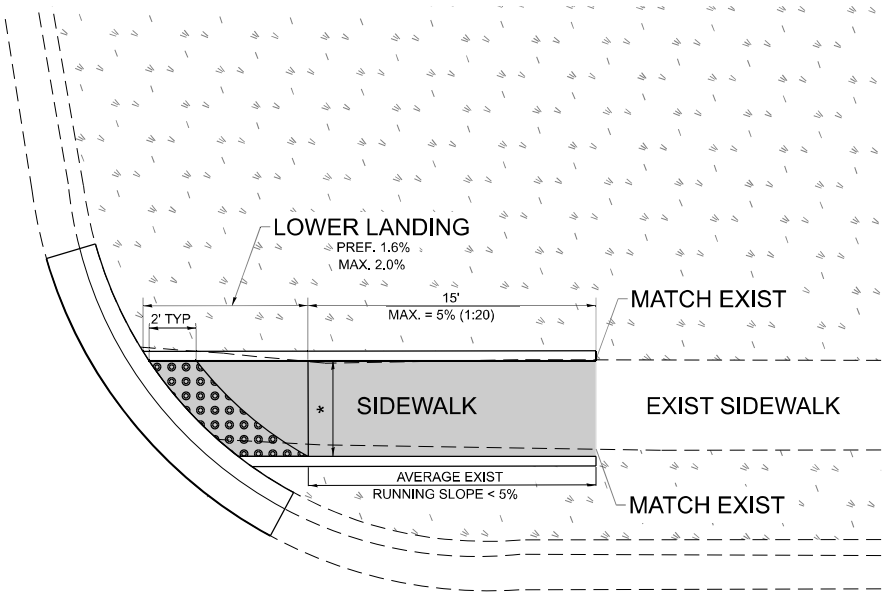

LEGEND

- EXIST. GRASS
- PROPOSED SIDEWALK
- PROPOSED SIDE CURB
- DETECTABLE WARNINGS

CONSTRUCTION NOTES:

- 1) ALL CROSS SLOPES ARE PREFERRED 1.6% (1:64), MAXIMUM 2% (1:50) EXCEPT WHEN TRANSITIONING TO EXISTING SIDEWALK
- * MATCH EXISTING SIDEWALK WIDTH

MODEL: PD01 [Sheet]
FILE NAME: c:\p\work\pd01\pd01.dgn

| | | | | | |
|-----------|-------------|----------|---|---------|---|
| USER NAME | = Ivan.diaz | DESIGNED | - | REVISED | - |
| | | DRAWN | - | REVISED | - |
| | | CHECKED | - | REVISED | - |
| PLOT DATE | = 3/18/2025 | DATE | - | REVISED | - |

STATE OF ILLINOIS
DEPARTMENT OF TRANSPORTATION

PROJECT DETAIL FOR SINGLE PERPENDICULAR CURB RAMPS
(PD-01)

SCALE: NONE SHEET 1 OF 1 SHEETS STA. TO STA.

| | | | | |
|---------------|-------------|--------------------|-----------------|--------------|
| F.A.U RTE. | SECTION | COUNTY | TOTAL SHEETS | SHEET NO. |
| 1251 | 2024-1021-R | LAKE | 24 | 11 |
| PD-01 | | CONTRACT NO. 62X61 | | |
| ILLINOIS | | FED. AID PROJECT | | |

ADA DETAIL FOR SINGLE PERPENDICULAR CURB RAMPS W/ EXIST. 5% OR GREATER RUN. SLOPE

PD-02A

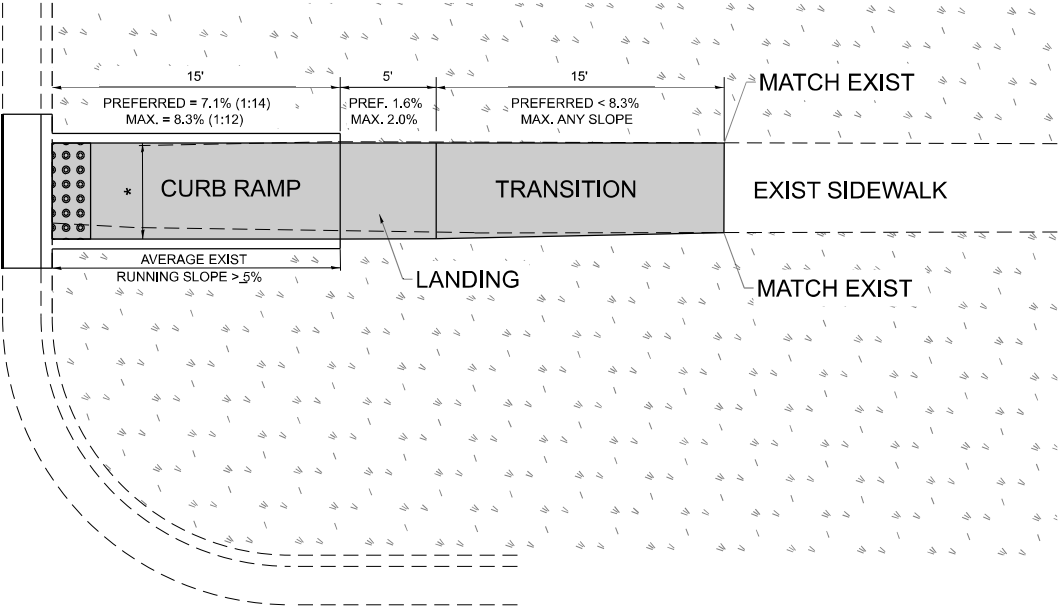

PD-02B

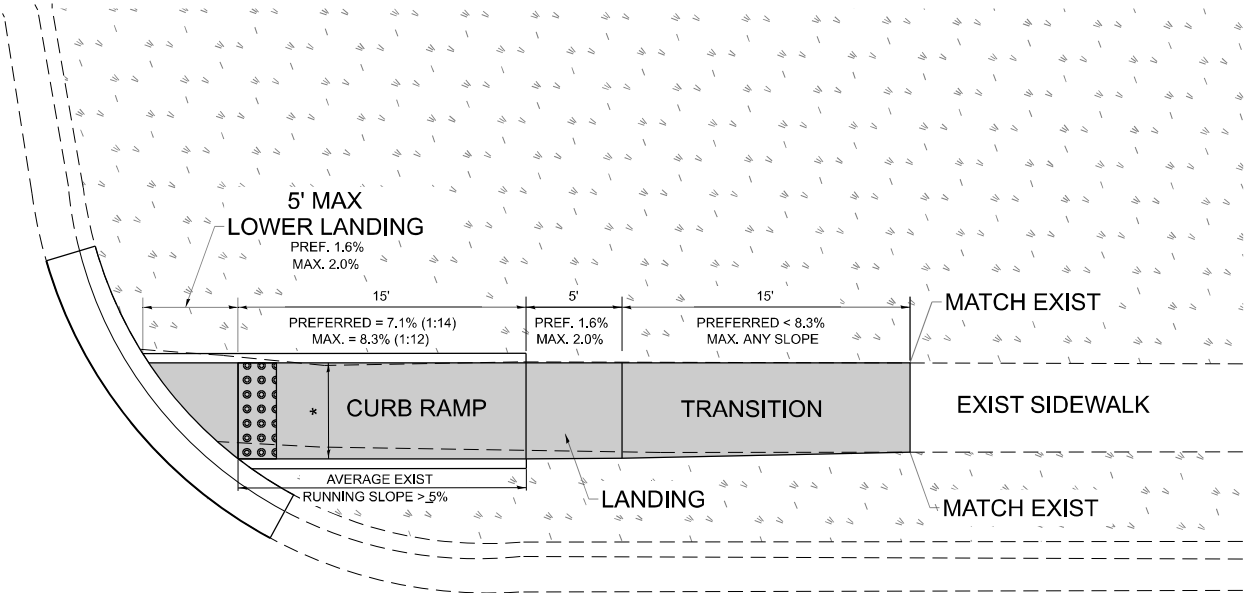

PD-02C

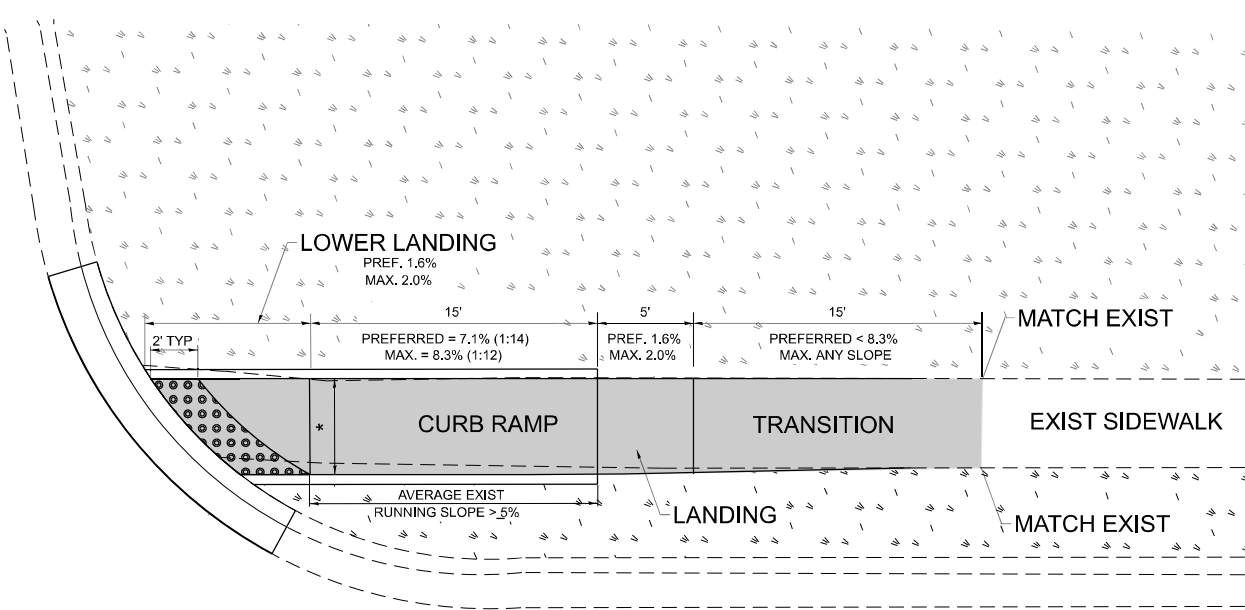

LEGEND

PROPOSED SIDE CURB



EXIST. GRASS



PROPOSED SIDEWALK



DETECTABLE WARNINGS

CONSTRUCTION NOTES:

1) ALL CROSS SLOPES ARE PREFERRED 1.6% (1:64), MAXIMUM 2% (1:50) EXCEPT WHEN TRANSITIONING TO EXISTING SIDEWALK

* MATCH EXISTING SIDEWALK WIDTH

MODEL: PD2 [Sheet]
FILE NAME: c:\pawork\pawork\diazad1042128\PD105325-shh-DiaStd.dgn

| | | | | | | |
|--|-----------|-------------|------------|---------|------------|---------|
| | USER NAME | = ivan.diaz | DESIGNED | - | REVISED | - |
| | DRAWN | - | R. LEDEZMA | REVISED | - | |
| | CHECKED | - | | REVISED | - | |
| | PLOT DATE | = 3/18/2025 | DATE | - | 10/02/2019 | REVISED |

STATE OF ILLINOIS
DEPARTMENT OF TRANSPORTATION

PROJECT DETAIL FOR SINGLE PERPENDICULAR CURB RAMPS
(PD-02)

SCALE: NONE SHEET 1 OF 1 SHEETS STA. TO STA.

| F.A.U RTE. | SECTION | COUNTY | TOTAL SHEETS | SHEET NO. |
|---------------|-------------|--------------------|------------------|--------------|
| 1251 | 2024-1021-R | LAKE | 24 | 12 |
| PD-02 | | CONTRACT NO. 62X61 | | |
| | | ILLINOIS | FED. AID PROJECT | |

ADA DETAIL FOR DEPRESSED CORNER CURB RAMPS

PD-05A

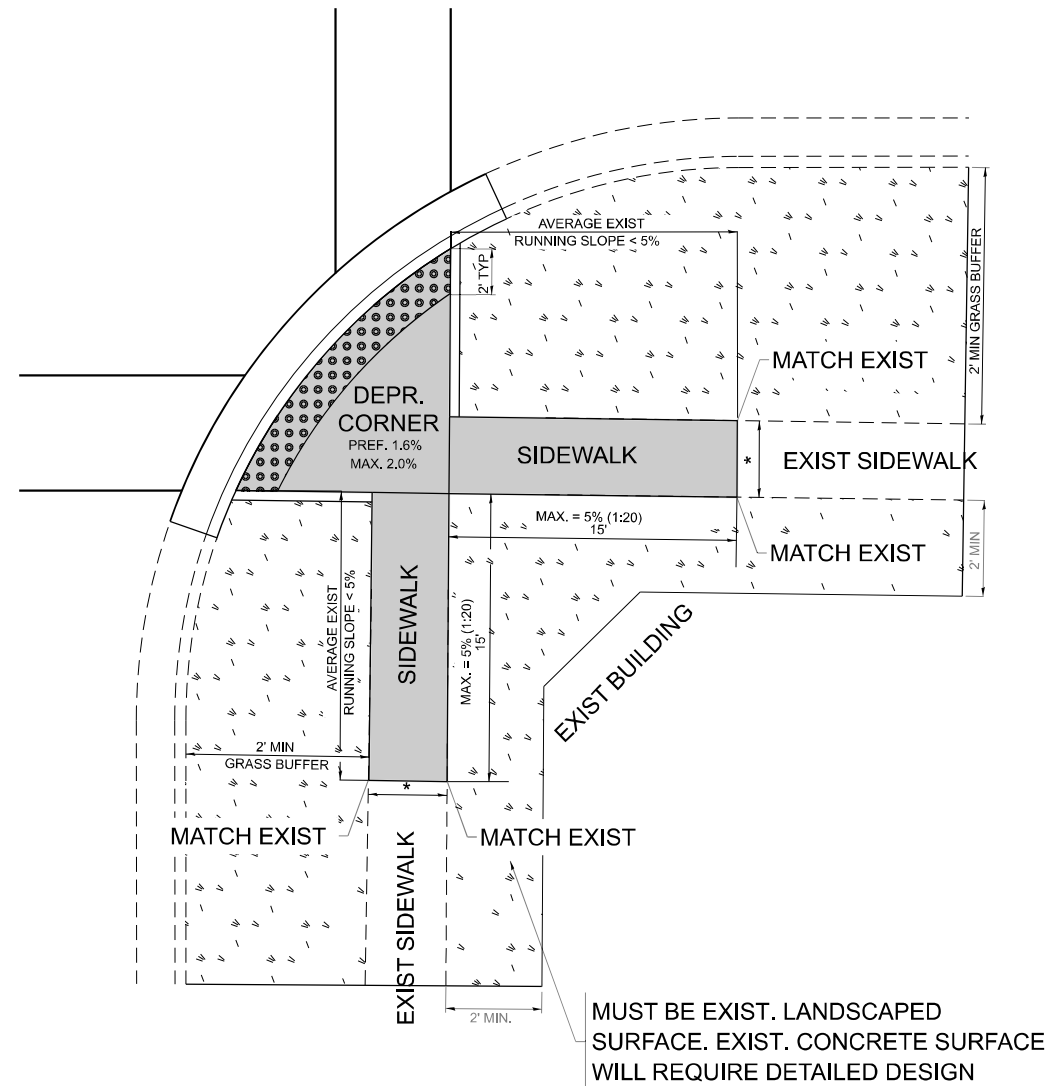

PD-05B

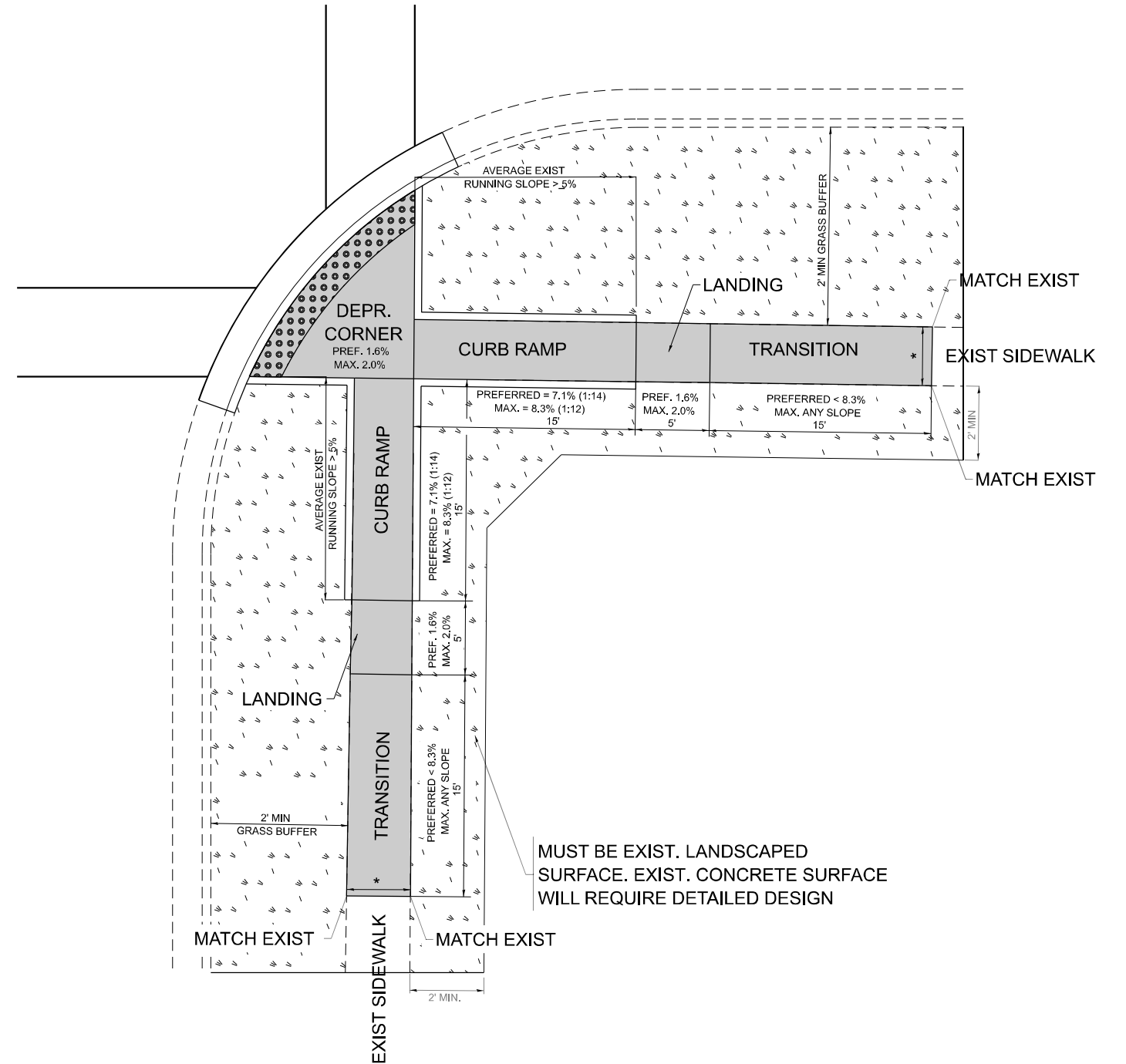

LEGEND



EXIST. GRASS



PROPOSED SIDEWALK



DETECTABLE WARNINGS

== PROPOSED SIDE CURB

CONSTRUCTION NOTES:

1) ALL CROSS SLOPES ARE PREFERRED 1.6% (1:64), MAXIMUM 2% (1:50) EXCEPT WHEN TRANSITIONING TO EXISTING SIDEWALK

* MATCH EXISTING SIDEWALK WIDTH

| | | |
|-----------------------|--------------------|-----------|
| USER NAME = Ivan.diaz | DESIGNED - | REVISED - |
| | DRAWN - R. LEDEZMA | REVISED - |
| | CHECKED - | REVISED - |
| PLOT DATE = 3/18/2025 | DATE - | REVISED - |

STATE OF ILLINOIS
DEPARTMENT OF TRANSPORTATION

PROJECT DETAIL FOR DEPRESSED CORNER CURB RAMPS (PD-05)

| | | | | | |
|-------------|---------|------|--------|------|---------|
| SCALE: NONE | SHEET 1 | OF 1 | SHEETS | STA. | TO STA. |
|-------------|---------|------|--------|------|---------|

| | | | | |
|---------------|-------------|--------------------|-----------------|--------------|
| F.A.U RTE. | SECTION | COUNTY | TOTAL SHEETS | SHEET NO. |
| 1251 | 2024-1021-R | LAKE | 24 | 13 |
| PD-05 | | CONTRACT NO. 62X61 | | |
| ILLINOIS | | FED. AID PROJECT | | |

MODEL: PD5 [Sheet]
FILE NAME: c:\pw_work\pwidot\diaz\ad1042128\ID105325-slt-DistStd.dgn

MODEL: BD2 (Sheet)
FILE NAME: c:\pwwork\pwwork\diaz\1042128\105325-shh-DistStd.dgn

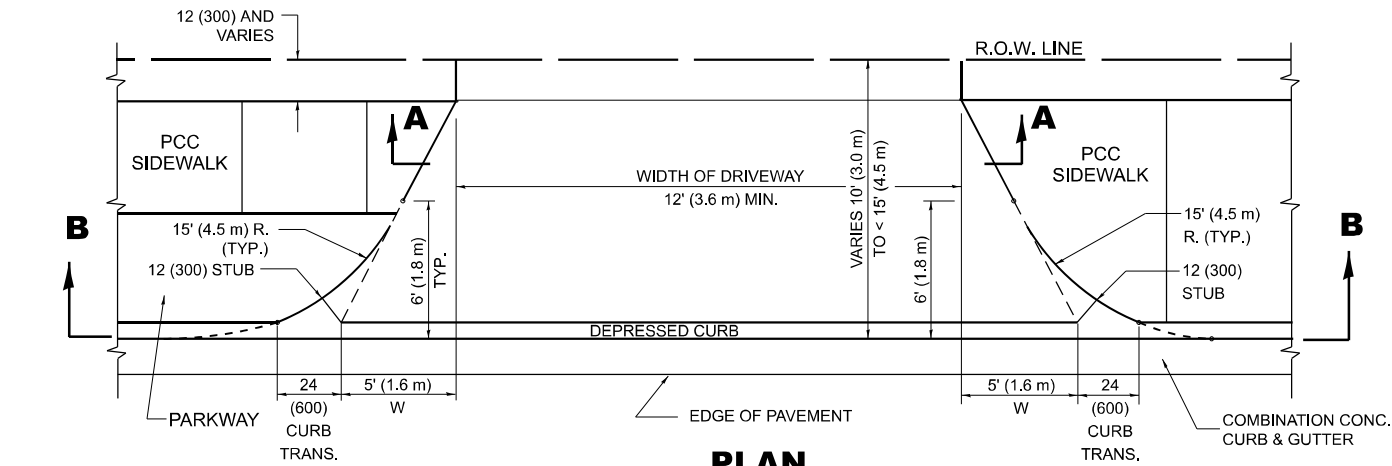

PLAN
10' (3.0 m) TO < 15' (4.5 m)

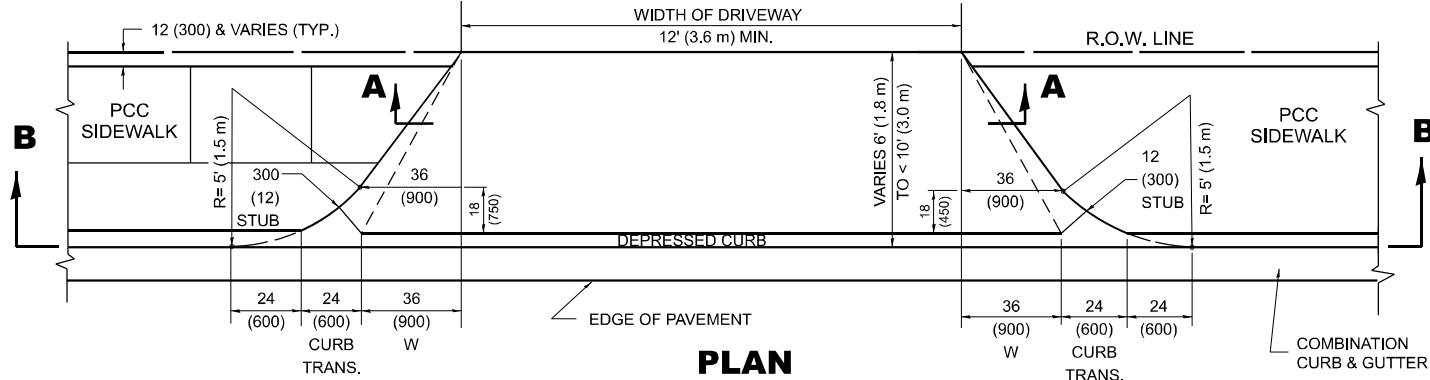

PLAN
6' (1.8 m) TO < 10' (3.0 m)

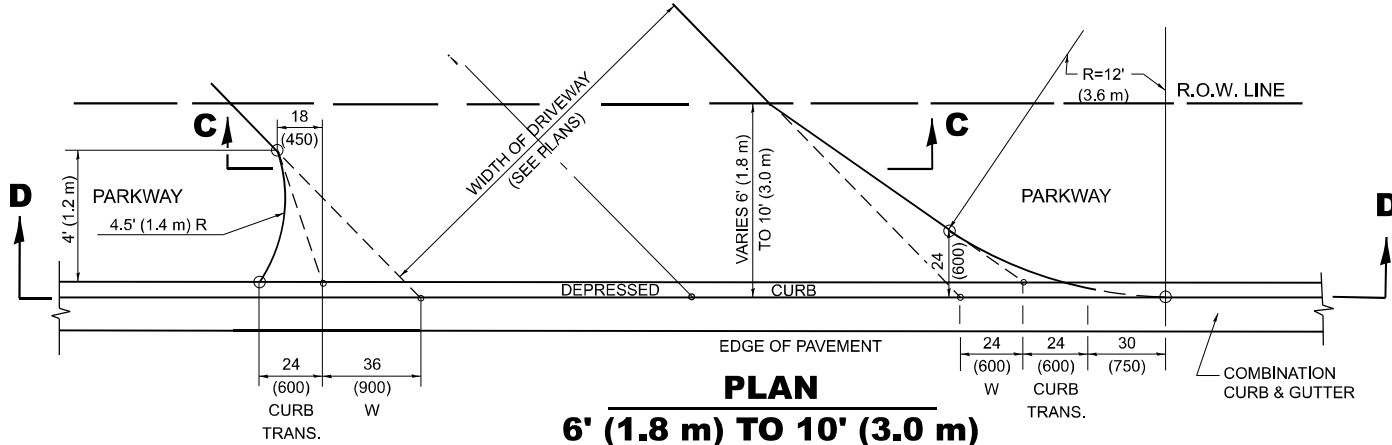

PLAN
6' (1.8 m) TO < 10' (3.0 m)

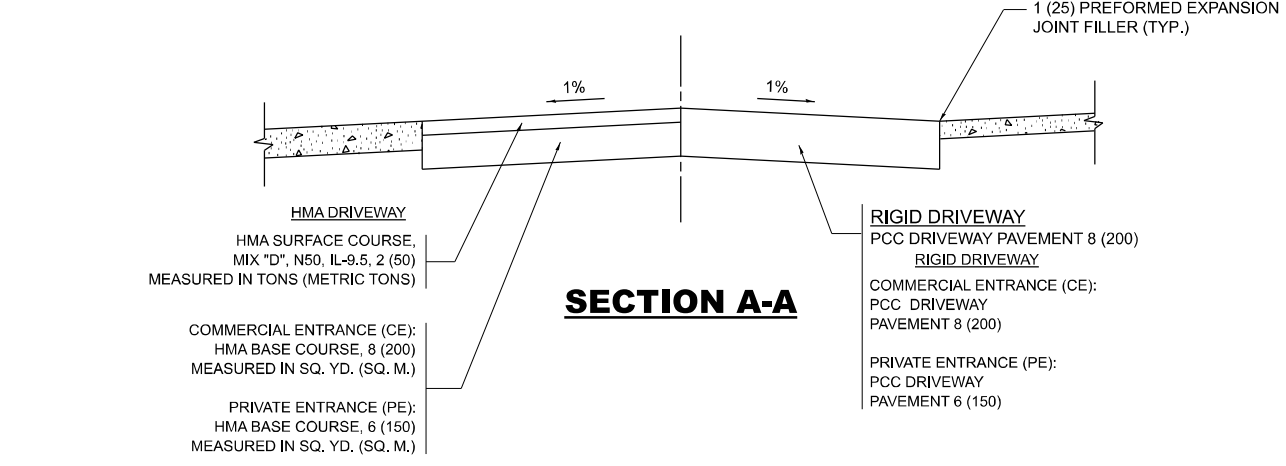

SECTION A-A

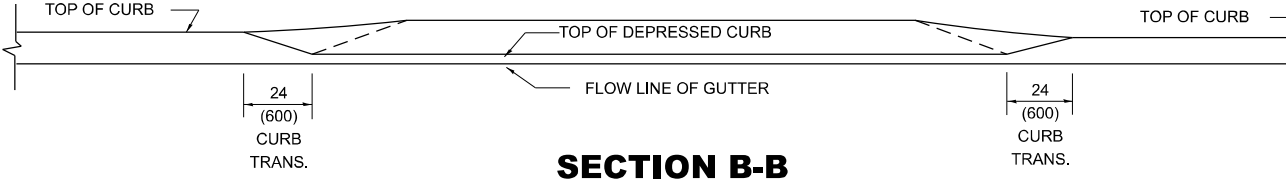

SECTION B-B

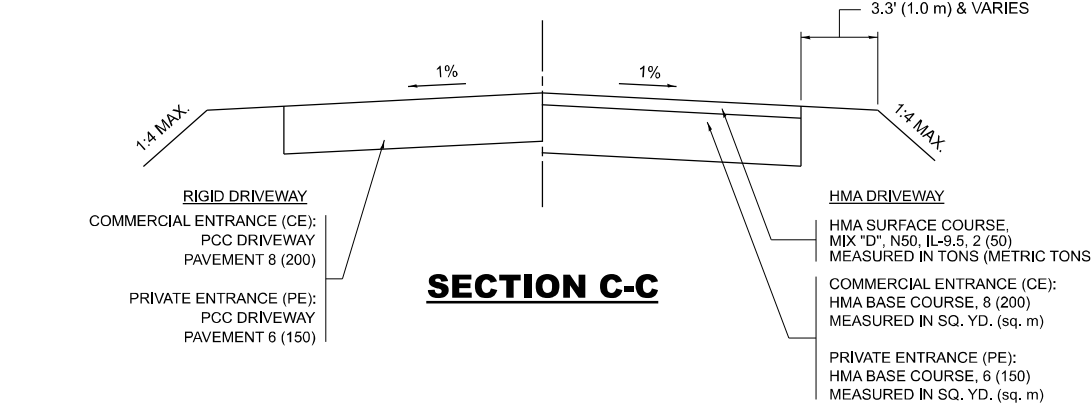

SECTION C-C

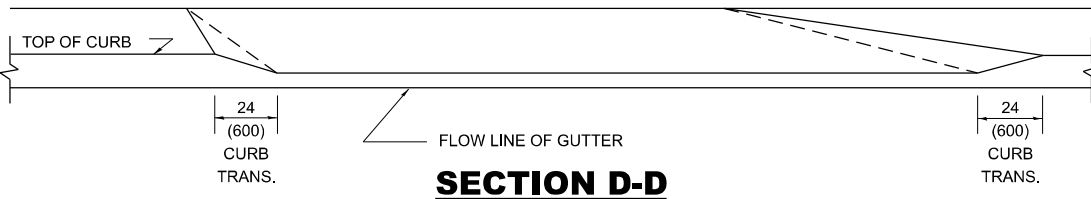

SECTION D-D

GENERAL NOTES

1. DRIVEWAY SLOPES, LOCATIONS, & GEOMETRIC LAYOUT SHALL BE IN ACCORDANCE WITH THE LATEST EDITION OF THE "HANDBOOK FOR POLICY ON PERMITS FOR ACCESS DRIVEWAYS TO STATE HIGHWAYS". FOR FURTHER LAYOUT REQUIREMENTS, REFER TO ILLUSTRATION 10 IN THE PERMIT HANDBOOK. WHERE SIDEWALKS EXIST, DRIVEWAYS SHALL BE REPLACED WITH RIGID PAVEMENT. WHERE NO SIDEWALKS EXIST, DRIVEWAYS SHALL BE REPLACED IN KIND. SIDEWALK CROSS SLOPE THRU DRIVEWAY AREA TO BE A MAXIMUM OF 1:50.
2. WHEN THE DISTANCE BETWEEN R.O.W. AND THE BACK OF CURB IS EQUAL TO OR LESS THAN 8' (2.4 m), THE PCC SIDEWALK SHALL EXTEND TO THE BACK OF CURB.
3. "W" VARIES FROM 36 (900) TO 5' (1.5 m) PROPORTIONAL TO THE LENGTH (L), FROM 6' (1.8 m) TO 10' (3 m).

ALL DIMENSIONS ARE IN INCHES (MILLIMETERS)
UNLESS OTHERWISE NOTED.

| | | |
|-----------------------|--------------------|-----------------------------|
| USER NAME = ivan.diaz | DESIGNED - R. SHAH | REVISED - R. BORO 01-01-07 |
| | DRAWN - | REVISED - R. BORO 09-06-11 |
| | CHECKED - | REVISED - K. SMITH 08-27-19 |
| PLOT DATE = 2/14/2025 | DATE - 11-06-95 | REVISED - K. SMITH 11-18-22 |

STATE OF ILLINOIS
DEPARTMENT OF TRANSPORTATION

| DRIVEWAY DETAILS | | | |
|----------------------------------------------------|---------|------|--------|
| DISTANCE BETWEEN ROW AND FACE OF CURB < 15' (4.5m) | | | |
| SCALE: NONE | SHEET 1 | OF 1 | SHEETS |
| STA. | TO STA. | | |

| F.A.U. RTE. | SECTION | COUNTY | TOTAL SHEETS | SHEET NO. |
|------------------|-------------|--------------------|--------------|-----------|
| 1251 | 2024-1021-R | LAKE | 24 | 15 |
| BD400-01 (BD-02) | | CONTRACT NO. 62X61 | | |
| ILLINOIS | | FED. AID PROJECT | | |



1. EXISTING BROKEN FRAMES AND LIDS SHALL BE REMOVED AND DISPOSED OF BY THE CONTRACTOR AND SHALL BE REPLACED AS DIRECTED BY THE ENGINEER. REPLACEMENT FRAMES AND LIDS WILL BE PAID FOR IN ACCORDANCE WITH ARTICLE 109.04 OF THE STANDARD SPECIFICATIONS UNLESS A SEPARATE PAY ITEM HAS BEEN PROVIDED.
2. IF THE EXISTING LIDS ARE OPEN, THE FRAME WILL BE ADJUSTED TO THE ELEVATION OF THE MILLED PAVEMENT SURFACE PRIOR TO THE MILLING OPERATION. THE FRAME WILL NOT BE REMOVED AND COVERED BY THE METAL PLATE
3. CITY OF CHICAGO CASTINGS ARE THE PROPERTY OF THE CITY AND THE CONTRACTOR SHALL NOTIFY THE CITY FOR REMOVAL AND DISPOSITION OF THE CASTINGS.
4. THE METAL PLATE USED TO COVER THE STRUCTURE SHALL REMAIN THE PROPERTY OF THE CONTRACTOR.
5. THE CONTRACTOR SHALL REMOVE ALL TRAFFIC CONTROL DEVICES BY THE END OF EACH WORK SHIFT.

STAGE 1 (BEFORE PAVEMENT MILLING)

- A) REMOVE A MINIMUM OF 12 (300) OF THE PAVEMENT FROM AROUND THE STRUCTURE.
- B) REMOVE THE EXISTING FRAME AND LID FROM THE STRUCTURE.
- C) COVER THE STRUCTURE OPENING WITH A 36 (900) DIAMETER METAL PLATE.
- D) BACKFILL WITH CRUSHED STONE AND HMA SURFACE MIX APPROVED BY THE ENGINEER. (MIN. 3 (80) HMA TO REMAIN AFTER MILLING).

***UNLESS OTHERWISE SPECIFIED IN THE PLANS.**

THE PROCEDURE EXPLAINED ABOVE SHALL CONFORM TO THE APPLICABLE PORTIONS OF SECTIONS 353, 406, 602, AND 603 OF THE STANDARD SPECIFICATIONS EXCEPT THAT "THE CONTRACTOR SHALL ADJUST THE STRUCTURES TO THE FINISHED PAVEMENT ELEVATION NO MORE THAN 5 CALENDAR DAYS PRIOR TO PLACEMENT OF THE FINAL LIFT OF SURFACE UNLESS APPROVED BY THE ENGINEER."

| | |
|----------------------------------------------|-------------------------------|
| ① SUB-BASE GRANULAR MATERIAL | ⑥ FRAME AND LID (SEE NOTES) |
| ② EXISTING PAVEMENT | ⑦ CLASS PP-2* CONCRETE |
| ③ 36 (900) DIAMETER METAL PLATE | ⑧ PROPOSED HMA SURFACE COURSE |
| ④ PROPOSED CRUSHED STONE AND HMA SURFACE MIX | ⑨ PROPOSED HMA BINDER COURSE |
| ⑤ EXISTING STRUCTURE | |

THE CONTRACTOR WILL BE REQUIRED TO KEEP A RECORD OF THE LOCATIONS OF THE BURIED STRUCTURES ACCORDING TO THE STATION AND DISTANCE LEFT OR RIGHT OF THE CENTERLINE OF PAVEMENT. UPON COMPLETION OF THE WORK, THE CONTRACTOR WILL DELIVER THE RECORD TO THE ENGINEER.

1. REMOVING FRAMES AND LIDS ON DRAINAGE AND UTILITY STRUCTURES IN THE PAVEMENT PRIOR TO MILLING, AND ADJUSTING TO FINAL GRADE PRIOR TO PLACING THE SURFACE COURSE, WILL BE PAID FOR AT THE CONTRACT UNIT PRICE EACH FOR "FRAMES AND LIDS TO BE ADJUSTED (SPECIAL)."
2. THIS WORK WILL NOT BE PAID FOR WHEN DRAINAGE AND UTILITY STRUCTURES ARE SPECIFIED FOR PAYMENT AS STRUCTURE RECONSTRUCTION.
3. NEW FRAMES AND LIDS, WHEN SPECIFIED, WILL BE PAID FOR SEPARATELY.
4. WHEN STRUCTURES ARE TO BE ADJUSTED OR RECONSTRUCTED, THE LOWERING AND RAISING OF THE FRAMES AND LIDS WILL NOT BE PAID FOR SEPARATELY BUT WILL BE INCLUDED IN THE COST OF THE CORRESPONDING PAY ITEM.

| | | | | | |
|-------------|---------|------|--------|------|---------|
| SCALE: NONE | SHEET 1 | OF 1 | SHEETS | STA. | TO STA. |
|-------------|---------|------|--------|------|---------|

| | | | | |
|-------------------------|-------------|--------------------|-----------------|--------------|
| F.A.U RTE. | SECTION | COUNTY | TOTAL SHEETS | SHEET NO. |
| 1251 | 2024-1021-R | LAKE | 24 | 16 |
| BD600-03 (BD-08) | | CONTRACT NO. 62X61 | | |
| ILLINOIS | | FED. AID PROJECT | | |

METHOD OF MEASUREMENT

REFER TO SECTION 442 OF THE STANDARD SPECIFICATIONS FOR ROAD AND BRIDGE CONSTRUCTION AND THE RECURRING SPECIAL PROVISION "PATCHING WITH HOT-MIX ASPHALT OVERLAY REMOVAL."

BASIS OF PAYMENT

- 1. REFER TO SECTION 442 OF THE STANDARD SPECIFICATIONS FOR ROAD AND BRIDGE CONSTRUCTION AND THE RECURRING SPECIAL PROVISION "PATCHING WITH HOT-MIX ASPHALT OVERLAY REMOVAL."
- 2. SAW CUT/SCORING OF EXISTING HMA OVERLAY IS INCLUDED IN THE COST OF PAVEMENT PATCHING.
- 3. SAW CUT/SCORING OF EXISTING PAVEMENT IS INCLUDED IN THE COST OF PAVEMENT PATCHING.

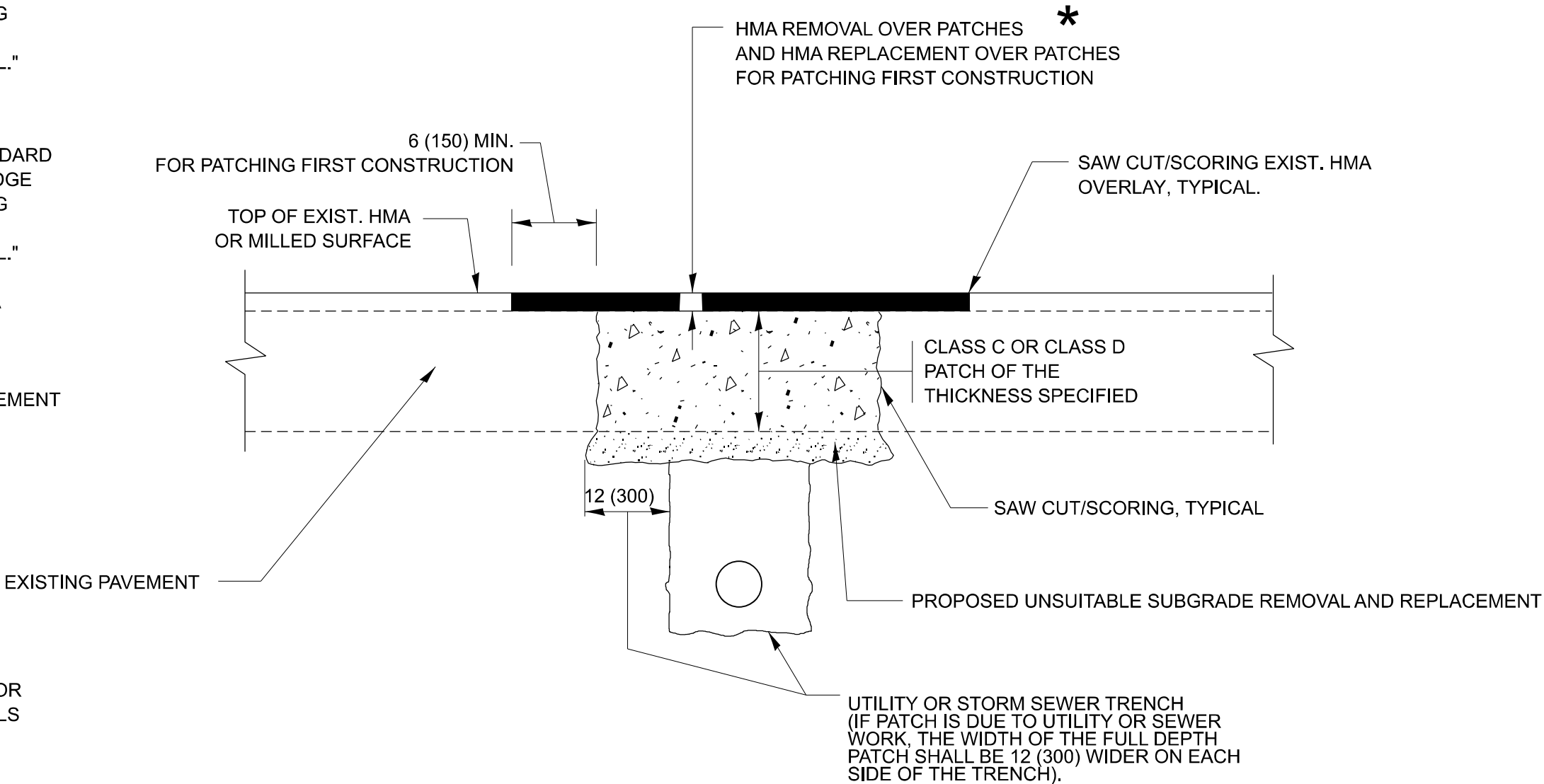

SEQUENCE OF CONSTRUCTION (PATCHING FIRST)

- 1. REMOVE THE EXISTING HMA MATERIAL OVER THE AREA TO BE PATCHED.
- 2. REMOVE AND REPLACE WITH CLASS C OR D PATCH.
- 3. REPLACE HMA MATERIAL OVER THE AREA TO BE PATCHED.

SEQUENCE OF CONSTRUCTION (MILLING FIRST)

- 1. MILL HMA FIRST IF THERE IS AT LEAST 4 1/2 INCHES OR MORE OF HMA MATERIAL ON TOP OF THE EXISTING PAVEMENT OR IF THE PAVEMENT IS FULL DEPTH HMA. A MINIMUM OF 2 INCHES OF HMA MATERIAL SHALL BE IN PLACE AFTER MILLING.
- 2. REMOVE AND REPLACE WITH FULL DEPTH CLASS D PATCHES TO TOP OF MILLED SURFACE.

ALL DIMENSIONS ARE IN INCHES (MILLIMETERS) UNLESS OTHERWISE SHOWN.

MODEL: BD22 (Sheet)
FILE NAME: c:\p\work\pav\tdi\dia\1042128\105325-shh-DiaStd.dgn

| | | | | | | | | | | | | | |
|--|---------------------------|------------------------|---------------------------------|---------------------------------------------------|------------------------------------------------|-----------|--------|--------|------------------|-------------|--------------------|-----------------|--------------|
| | USER NAME = ivan.diaz | DESIGNED - R. SHAH | REVISED - R. BORO 01-01-07 | STATE OF ILLINOIS DEPARTMENT OF TRANSPORTATION | PAVEMENT PATCHING FOR HMA SURFACED PAVEMENT | | | | F.A.U RTE. | SECTION | COUNTY | TOTAL SHEETS | SHEET NO. |
| | | DRAWN - | REVISED - R. BORO 09-04-07 | | | | | | 1251 | 2024-1021-R | LAKE | 24 | 17 |
| | | CHECKED - | REVISED - K. ENG 10-27-08 | | | | | | BD400-04 (BD-22) | | CONTRACT NO. 62X61 | | |
| | PLOT DATE = 3/18/2025 | DATE - 10-25-94 | REVISED - K. SMITH 11-18-22 | | ILLINOIS FED. AID PROJECT | | | | | | | | |
| | | | | | SCALE: NONE | SHEET 1 | OF 1 | SHEETS | STA. | TO STA. | | | |

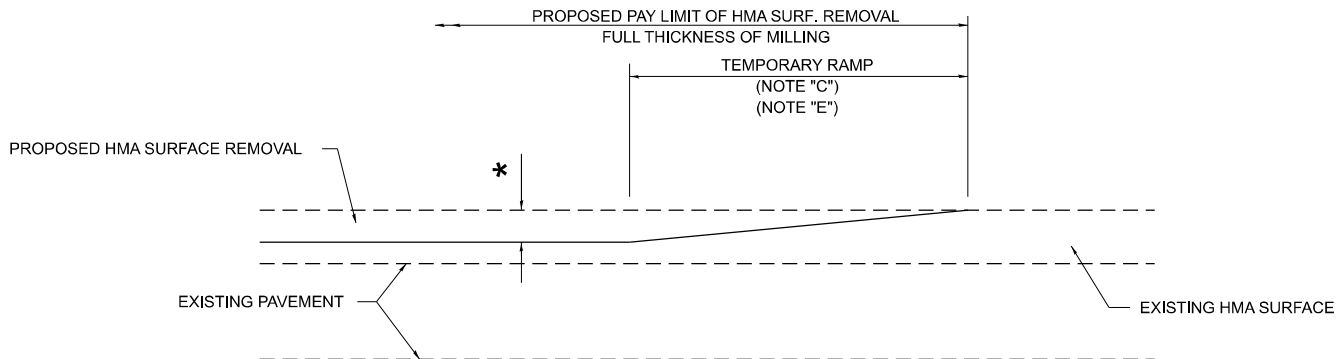

MILLED TEMPORARY RAMP
(FOR BUTT JOINT AND HMA TAPER SEE DETAIL BELOW)

OPTION 1

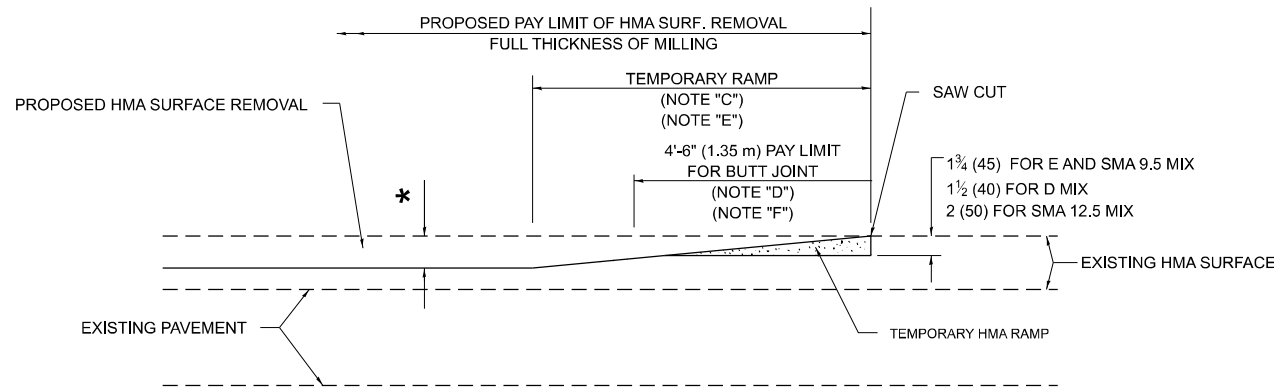

HMA CONSTRUCTED TEMPORARY RAMP
(FOR BUTT JOINT AND HMA TAPER SEE DETAIL BELOW)

OPTION 2

TYPICAL TEMPORARY RAMP

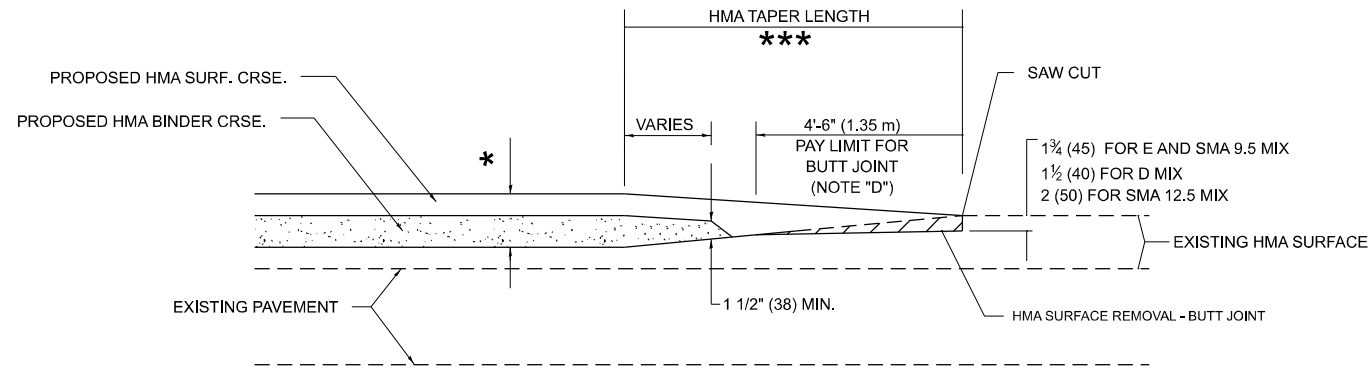

**BUTT JOINT AND
HMA TAPER**

**TYPICAL BUTT JOINT AND HMA TAPER
FOR MILLING AND RESURFACING**

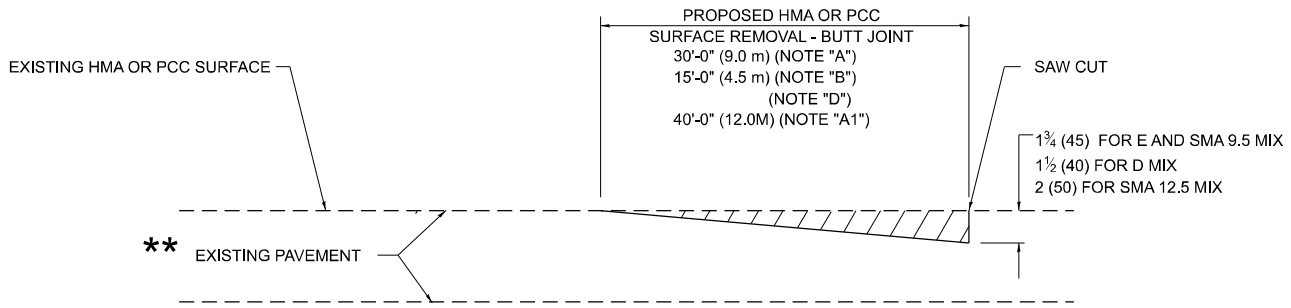

BUTT JOINT DETAIL

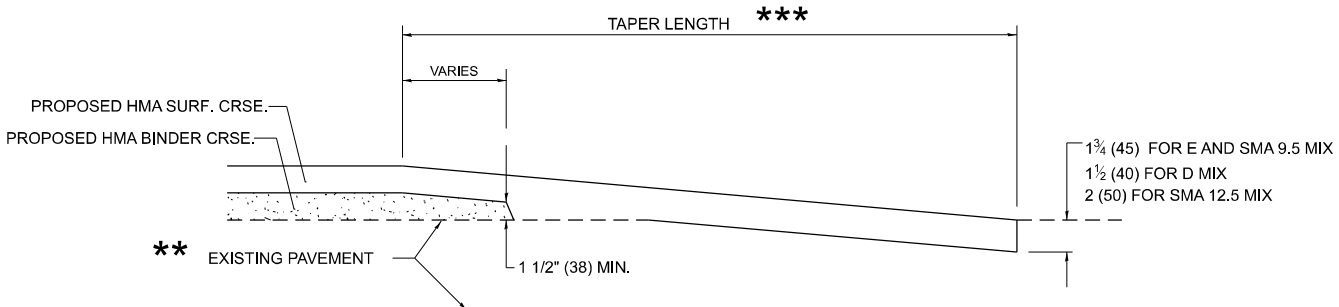

HMA TAPER DETAIL

**TYPICAL BUTT JOINT AND HMA TAPER
FOR RESURFACING ONLY**

** PC CONCRETE, HMA OR HMA RESURFACED PAVEMENT.

GENERAL NOTES

- A. MAINLINE ARTERIAL ROADWAYS AND MAJOR SIDE ROADS.
- A1. INTERSTATES
- B. MINOR SIDE ROADS.
- C. THE TEMP. RAMP SHALL BE CONSTRUCTED IMMEDIATELY UPON REMOVAL OF THE EXISTING HMA SURFACE.
- D. THE BUTT JOINT SHALL BE CONSTRUCTED IMMEDIATELY PRIOR TO PLACING THE PROPOSED HMA COURSES.
- E. TAPER THE TEMP. RAMP AT A RATE OF 3' - 4" (1.02m) PER 1 INCH (25 mm) OF MILLING THICKNESS.
* SEE TYPICAL SECTIONS FOR MILLING THICKNESS.
- F. SEE ARTICLE 406.08 AND 406.14 OF THE STANDARD SPECIFICATIONS FOR "HMA AND/OR PCC SURFACE REMOVAL, BUTT JOINT".

20'-0" (6.1 m) PER 1 (25) RESURFACING (NOTE "A")
10'-0" (3.0 m) PER 1 (25) RESURFACING (NOTE "B")

BASIS OF PAYMENT

- 1. THE BUTT JOINT WILL BE PAID FOR AT THE CONTRACT UNIT PRICE PER SQUARE YARD (SQUARE METER) FOR "HOT-MIX ASPHALT SURFACE REMOVAL - BUTT JOINT" OR FOR "PORTLAND CEMENT CONCRETE SURFACE REMOVAL- BUTT JOINT".
- 2. THE TEMPORARY RAMP AND SAW CUT SHALL BE INCLUDED IN THE UNIT COST FOR HMA OR PCC SURFACE REMOVAL-BUTT JOINT.

ALL DIMENSIONS ARE IN INCHES (MILLIMETERS) UNLESS OTHERWISE SHOWN.

MODEL: BD32 (Sheet)
FILE NAME: c:\p\work\p\work\1042128\105325-shh-DistStd.dgn

| | | |
|-----------------------|-----------------------|-----------------------------|
| USER NAME = ivan.diaz | DESIGNED - M. DE YONG | REVISED - A. ABBAS 03-21-97 |
| | DRAWN - | REVISED - M. GOMEZ 04-06-01 |
| | CHECKED - | REVISED - R. BORO 01-01-07 |
| PLOT DATE = 3/18/2025 | DATE - 06-13-90 | REVISED - K. SMITH 11-18-22 |

STATE OF ILLINOIS
DEPARTMENT OF TRANSPORTATION

| BUTT JOINT AND HMA TAPER DETAILS | | | |
|-------------------------------------|---------|-------------|--------------|
| SCALE: NONE | SHEET 1 | OF 1 SHEETS | STA. TO STA. |

| F.A.U RTE. | SECTION | COUNTY | TOTAL SHEETS | SHEET NO. |
|----------------|-------------|--------------------|-----------------|--------------|
| 1251 | 2024-1021-R | LAKE | 24 | 19 |
| BD400-05 BD-32 | | CONTRACT NO. 62X61 | | |
| ILLINOIS | | FED. AID PROJECT | | |

MODEL: TC10 (Sheet)
FILE NAME: c:\p\work\pwtold\pwtold1042128D105325-shh-DiaSids.dgn

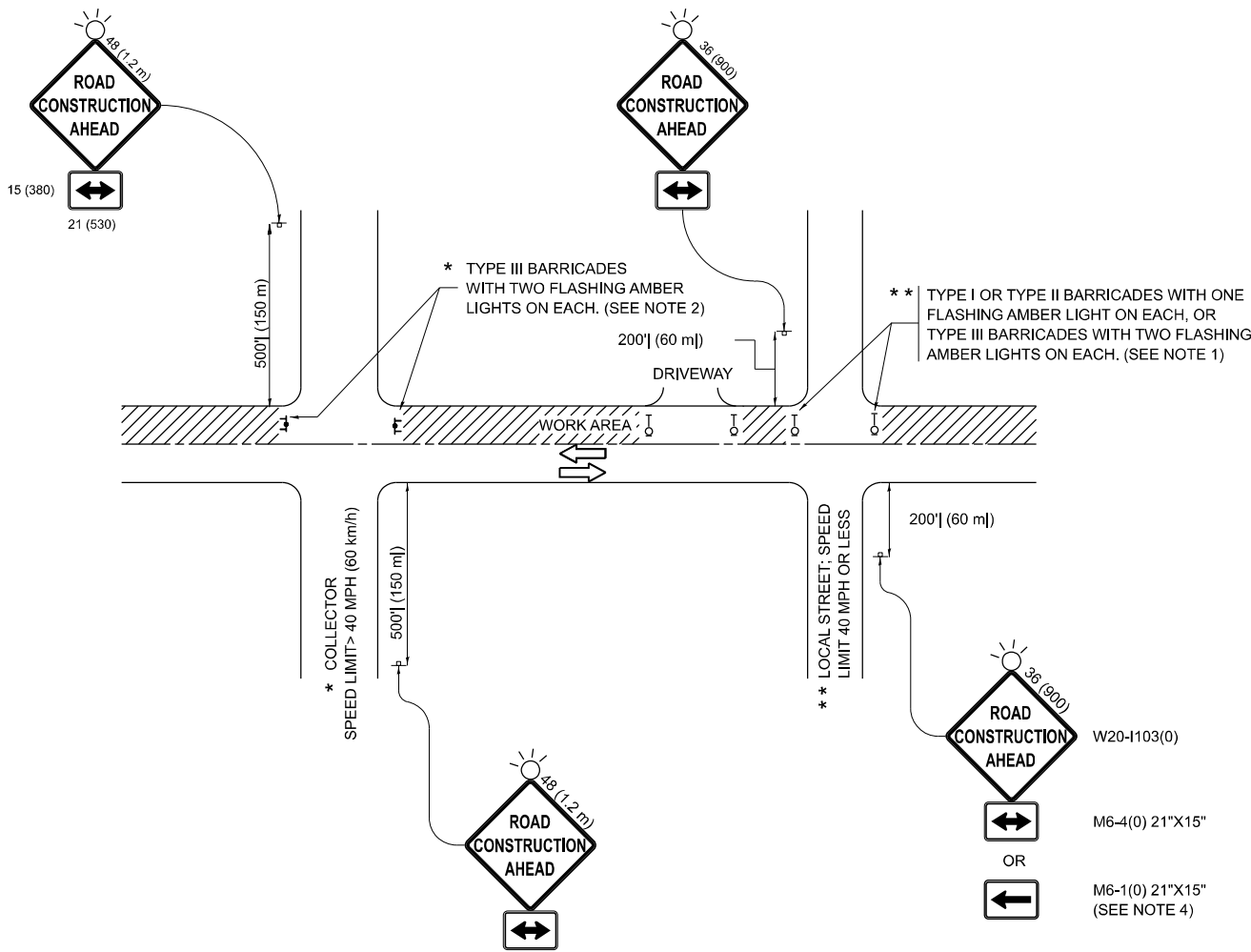

NOTES:

- SIDE ROAD WITH A SPEED LIMIT OF 40 MPH (60 km/h) OR LESS AS SHOWN ON THE DRAWING AND AS DIRECTED BY THE ENGINEER:
 - ONE "ROAD CONSTRUCTION AHEAD" SIGN 36 x 36 (900x900) WITH A FLASHER MOUNTED ON IT APPROXIMATELY 200' (60 m) IN ADVANCE OF THE MAIN ROUTE.
 - THE CLOSED PORTION OF THE MAIN ROUTE SHALL BE PROTECTED BY BLOCKING WITH TYPE I, TYPE II OR TYPE III BARRICADES, 1/3 OF THE CROSS SECTION OF THE CLOSED PORTION.
- SIDE ROAD WITH A SPEED LIMIT GREATER THAN 40 MPH (60 km/h) AS SHOWN ON THE DRAWING AND AS DIRECTED BY THE ENGINEER:
 - ONE "ROAD CONSTRUCTION AHEAD" SIGN 48 x 48 (1.2 m x 1.2 m) WITH A FLASHER MOUNTED ON IT APPROXIMATELY 500' (150 m) IN ADVANCE OF THE MAIN ROUTE.
 - THE CLOSED PORTION OF THE MAIN ROUTE SHALL BE PROTECTED BY BLOCKING WITH TYPE III BARRICADES, 1/2 OF THE CROSS SECTION OF THE CLOSED PORTION.
- CONES MAY BE SUBSTITUTED FOR BARRICADES OR DRUMS AT HALF THE SPACING DURING DAY OPERATIONS. CONES SHALL BE A MINIMUM OF 28 (710) IN HEIGHT.
- WHEN THE SIDE ROAD LIES BETWEEN THE BEGINNING OF THE MAINLINE SIGNING AND THE WORK ZONE, A SINGLE HEADED ARROW (M6-1) SHALL BE USED IN LIEU OF THE DOUBLE HEADED ARROW (M6-4).
- WHEN WORK IS BEING PERFORMED ON A SIDE ROAD OR DRIVEWAY, FOLLOW THE APPLICABLE STANDARD(S). THE DIRECTIONAL ARROW (M6-1 OR M6-4) SHALL BE COVERED OR REMOVED WHEN NO LONGER CONSISTENT WITH THE TRAFFIC CONTROL SET-UP.
- ADVANCE WARNING SIGNS ARE TO BE OMITTED ON DRIVEWAYS UNLESS OTHERWISE SPECIFIED IN THE PLANS OR BY THE ENGINEER.
- THE TRAFFIC CONTROL AND PROTECTION FOR SIDE ROADS, INTERSECTIONS, AND DRIVEWAYS SHALL BE INCLUDED IN THE COST OF SPECIFIED TRAFFIC CONTROL STANDARDS OR ITEMS.

All dimensions are in inches (millimeters)
unless otherwise shown.

| | | | | | | | | | | | | | | | | |
|--------|-----------------------|-------------------|---------------------------------|---------------------------------------------------|--------------------------------------------------------------------------------|---------|--|--|---------------------------|-------------|--------|-----------------|--------------|--------------------|--|--|
| | USER NAME = ivan.diaz | DESIGNED - L.H.A. | REVISED - T. RAMMACHER 01-06-00 | STATE OF ILLINOIS DEPARTMENT OF TRANSPORTATION | TRAFFIC CONTROL AND PROTECTION FOR SIDE ROADS, INTERSECTIONS, AND DRIVEWAYS | | | | F.A.U RTE. | SECTION | COUNTY | TOTAL SHEETS | SHEET NO. | | | |
| | | DRAWN - | REVISED - A. SCHUETZE 07-01-13 | | | | | | 1251 | 2024-1021-R | LAKE | 24 | 20 | | | |
| | | CHECKED - | REVISED - A. SCHUETZE 09-15-06 | | | | | | TC-10 | | | | | CONTRACT NO. 62X61 | | |
| | PLOT DATE = 3/18/2025 | DATE - 06-89 | REVISED - D. SENDERAK 05-03-24 | | | | | | ILLINOIS FED. AID PROJECT | | | | | | | |
| SCALE: | | SHEET OF SHEETS | | STA. | | TO STA. | | | | | | | | | | |

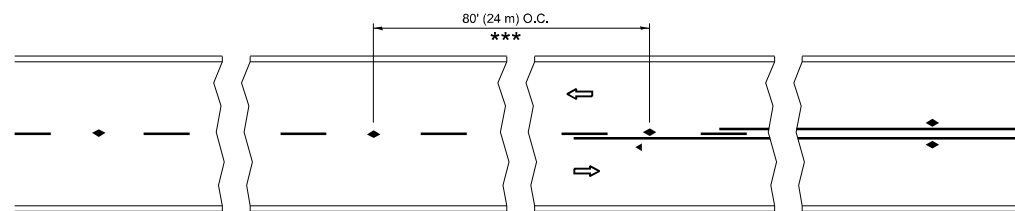

*** REDUCE TO 40' (12 m) O.C. ON CURVES WITH POSTED OR ADVISORY SPEED 45 M.P.H. (70 km/h) OR LESS.

TWO-LANE/TWO-WAY

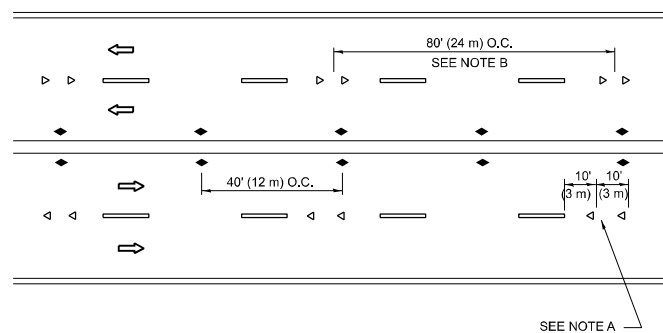

MULTI-LANE/UNDIVIDED

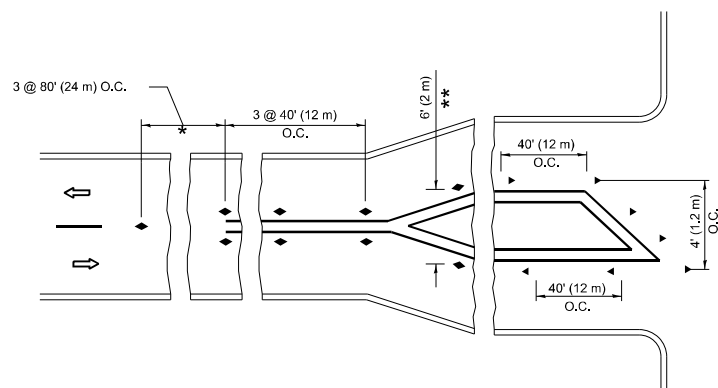

TURN LANES

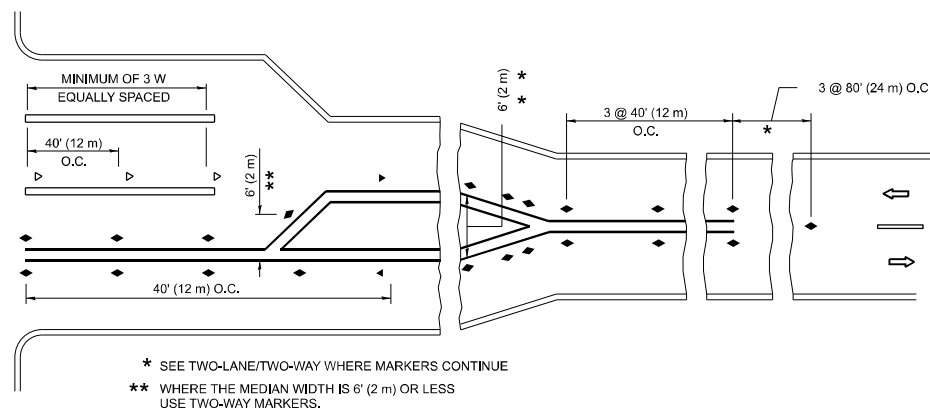

LANE REDUCTION TRANSITION

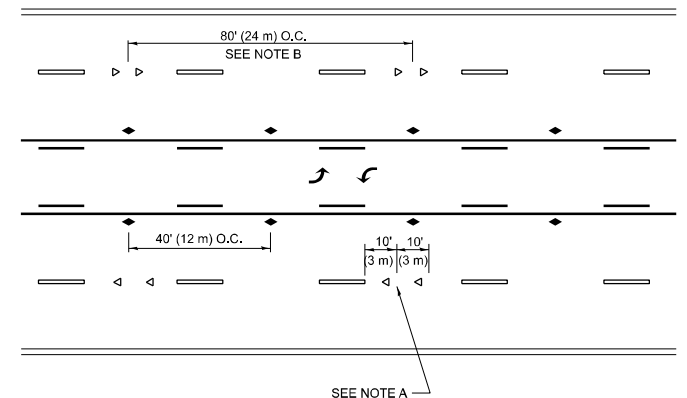
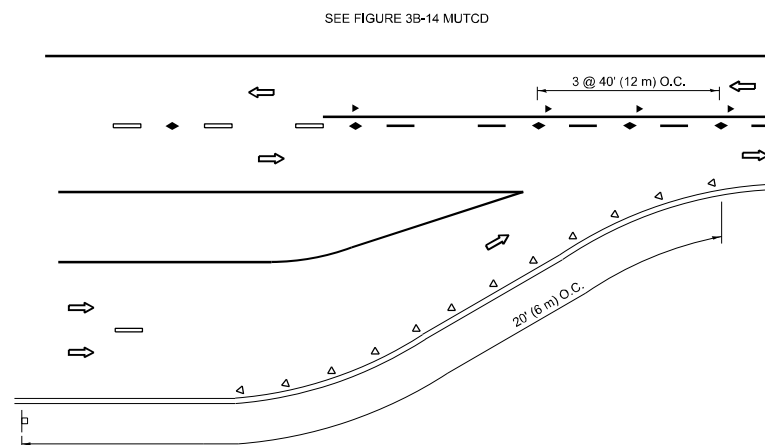





TWO-WAY LEFT TURN

GENERAL NOTES

1. MARKERS USED WITH DASHED LINES SHALL BE CENTERED IN THE GAP BETWEEN SEGMENTS.
2. MARKERS USED ADJACENT TO SOLID LINES SHALL BE OFFSET 2 TO 3 (50 TO 75) TOWARD TRAFFIC AS SHOWN.
3. MARKERS THROUGH TANGENTS LESS THAN 500' (150 m) IN LENGTH BETWEEN CURVES SHALL BE INSTALLED AT THE LESSER OF THE TWO CURVE SPACINGS.
4. MARKERS ARE TO BE USED ADJACENT TO BOTH SOLID WHITE LINES IN DUAL LEFT TURN LANES

SYMBOLS

-  YELLOW STRIPE
-  WHITE STRIPE
-  ONE-WAY AMBER MARKER
-  ONE-WAY CRYSTAL MARKER (W/O)
-  TWO-WAY AMBER MARKER

LANE MARKER NOTES

- A. USE DOUBLE LANE LINE MARKERS SPACED AS SHOWN.
- B. REDUCE TO 40' (12 m) O.C. ON CURVES WHERE ADVISORY SPEEDS ARE 10 M.P.H (20 km/h) LOWER THAN POSTED SPEEDS.

DESIGN NOTES

1. DOUBLE LANE LINE MARKERS SHALL BE USED UNLESS SPECIFIED OTHERWISE.
2. EXCEPT AS SHOWN ON THE LANE REDUCTION TRANSITION AND FREEWAY EXIT RAMP DETAIL, MARKERS ARE NOT TO BE SPECIFIED ON RIGHT EDGE LINES.
3. THE EXACT MARKER LIMITS, SPACING, AND COLOR SHALL BE INCLUDED IN THE PLANS WHEN STANDARD SPECIFICATIONS ARE NOT BEING USED.
4. MARKERS SHOULD NOT BE USED ALONGSIDE CURBS EXCEPT FOR EXTREMELY SHORT SECTIONS OF CURBS WHERE NOT MORE THAN TWO MARKERS WOULD BE INVOLVED.

All dimensions are in inches (millimeters)
unless otherwise shown.

| | | | | | | | | | | | | | | | | | |
|------------|-----------------------|-----------------------|------------------------------|---------------------------------|---------------------------------------------------|----------------------------------------------------------------------------------|-------------|--------|------|---------|----|---------------------------|---------------|--------------------|--------|-----------------|--------------|
| FILE NAME: | | USER NAME = Ivan.diaz | DESIGNED - | REVISED - T. RAMMACHER 03-12-99 | STATE OF ILLINOIS DEPARTMENT OF TRANSPORTATION | TYPICAL APPLICATIONS RAISED REFLECTIVE PAVEMENT MARKERS (SNOW-PLOW RESISTANT) | | | | | | | F.A.U RTE. | SECTION | COUNTY | TOTAL SHEETS | SHEET NO. |
| | | | DRAWN - | REVISED - T. RAMMACHER 01-06-00 | | 1251 | 2024-1021-R | | LAKE | 24 | 21 | | | | | | |
| | | | CHECKED - | REVISED - C. JUCIUS 09-09-09 | | TC-11 | | | | | | | | CONTRACT NO. 62X61 | | | |
| | PLOT DATE = 3/18/2025 | DATE - | REVISED - C. JUCIUS 07-01-13 | SCALE: NONE | | SHEET 1 | OF 1 | SHEETS | STA. | TO STA. | | | | | | | |
| | | | | | | | | | | | | ILLINOIS FED. AID PROJECT | | | | | |
| | | | | | | | | | | | | | | | | | |

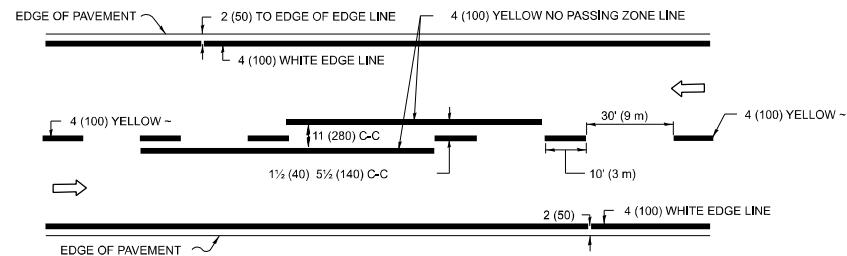

2-LANE ROADWAY

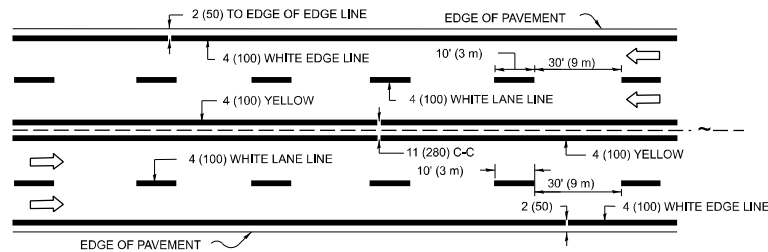

MULTI-LANE UNDIVIDED

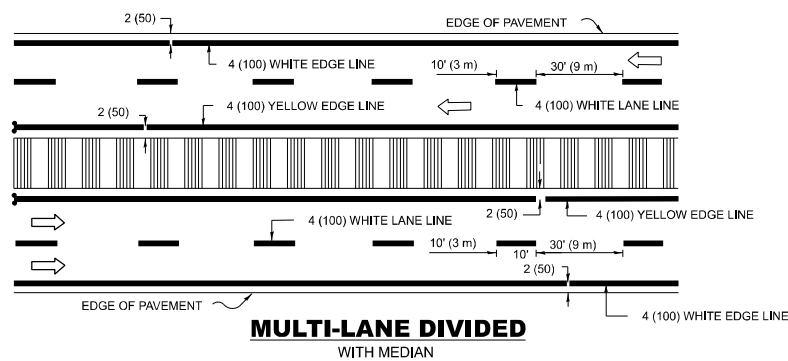

TYPICAL LANE AND EDGE LINE MARKING

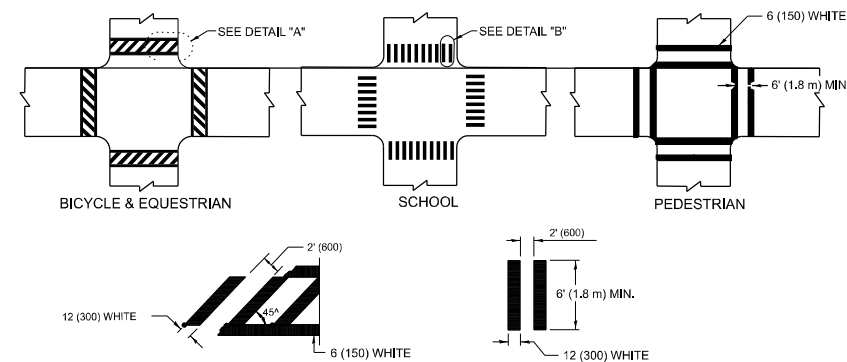

DETAIL "A" **DETAIL "B"**

TYPICAL CROSSWALK MARKING

* MARKINGS SHALL BE INSTALLED PARALLEL TO THE CENTERLINE OF THE ROAD WHICH IT CROSSES

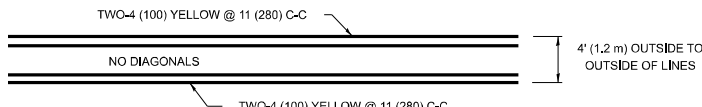

4' (1.2 m) WIDE MEDIANS ONLY

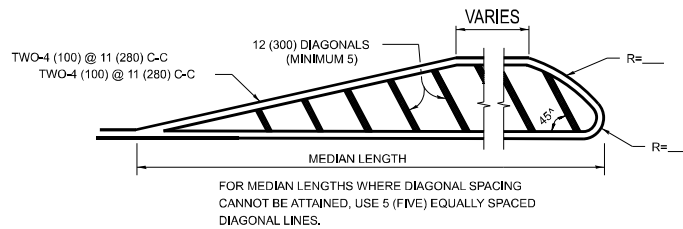

DIAGONAL LINE SPACING: 50' (15 m) C-C (LESS THAN 30MPH (50 km/h))
75' (25 m) C-C 30MPH (50 km/h) TO 45MPH (70 km/h))
150' (45 m) C-C (MORE THAN 45MPH (70 km/h))

MEDIANS OVER 4' (1.2 m) WIDE

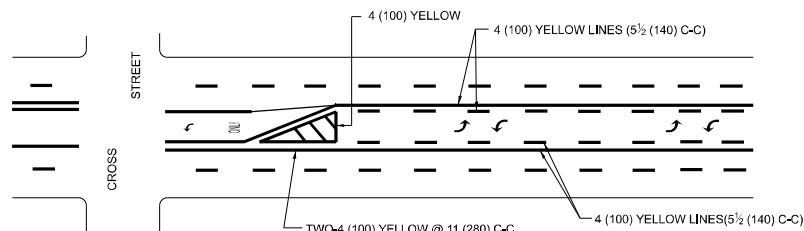

A MINIMUM OF TWO PAIRS OF TURN ARROWS SHALL BE USED, WHITE IN COLOR. ADDITIONAL PAIRS SHALL BE PLACED AT 200' (60 m) TO 300' (90 m) INTERVALS.

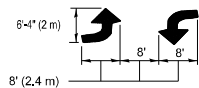

MEDIAN WITH TWO-WAY LEFT TURN LANE
TYPICAL PAINTED MEDIAN MARKING

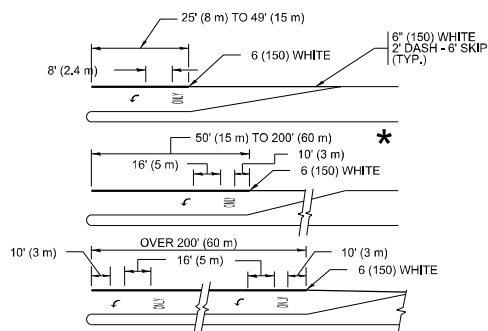

FULL SIZE LETTERS 8' (2.4 m) AND ARROWS SHALL BE USED.

* TURN LANES IN EXCESS OF 400' (120 m) IN LENGTH MAY HAVE AN ADDITIONAL SET OF ARROW - "ONLY" INSTALLED MIDWAY BETWEEN THE OTHER TWO SETS OF ARROW - "ONLY".

TYPICAL LEFT (OR RIGHT) TURN LANE

TYPICAL TURN LANE MARKING

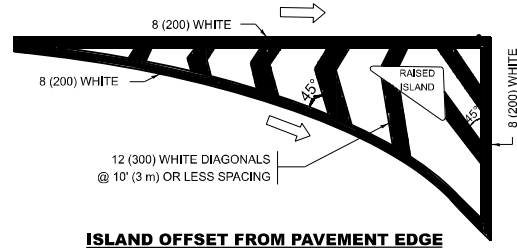

ISLAND OFFSET FROM PAVEMENT EDGE

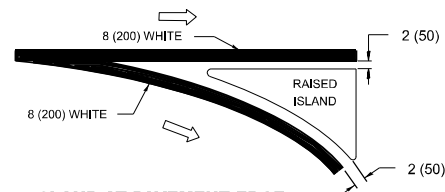

ISLAND AT PAVEMENT EDGE

TYPICAL ISLAND MARKING

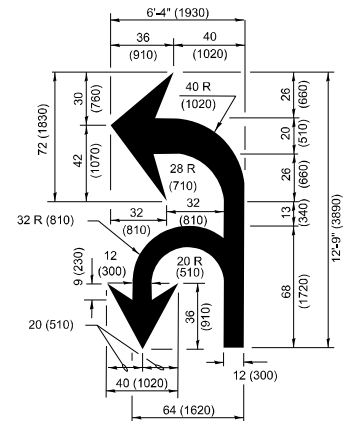

COMBINATION LEFT AND U-TURN

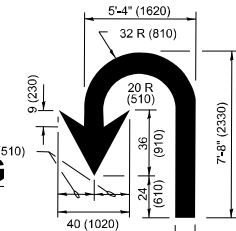

U-TURN

* LANE REDUCTION ARROWS REQUIRED AT SPEEDS OF 45 MPH OR GREATER OR WHEN SPECIFIED IN PLANS.

| D(FT) | SPEED LIMIT |
|-------|-------------|
| 345 | 30 |
| 425 | 35 |
| 500 | 40 |
| 580 | 45 |
| 665 | 50 |
| 750 | 55 |



| TYPE OF MARKING | WIDTH OF LINE | PATTERN | COLOR | SPACING / REMARKS |
|---------------------------------------------------------------------------------------------------|-----------------------------------------------------------------------------------------------------|------------------------------------|---------------------------------------------------------|--------------------------------------------------------------------------------------------------------------------------------------------------------------------------------|
| CENTERLINE ON 2 LANE PAVEMENT | 4 (100) | SKIP-DASH | YELLOW | 10' (3 m) LINE WITH 30' (9 m) SPACE |
| CENTERLINE ON MULTI-LANE UNDIVIDED PAVEMENT | 2 @ 4 (100) | SOLID | YELLOW | 11 (280) C-C |
| NO PASSING ZONE LINES: FOR ONE DIRECTION FOR BOTH DIRECTIONS | 4 (100) 2 @ 4 (100) | SOLID SOLID | YELLOW YELLOW | 5½ (140) C-C FROM SKIP-DASH CENTERLINE 11 (280) C-C OMIT SKIP-DASH CENTERLINE BETWEEN |
| LANE LINES | 4 (100) 5 (125) ON FREEWAYS | SKIP-DASH SKIP-DASH | WHITE WHITE | 10' (3 m) LINE WITH 30' (9 m) SPACE |
| DOTTED LINES (EXTENSIONS OF CENTER, LANE OR TURN LANE MARKINGS) | SAME AS LINE BEING EXTENDED | SKIP-DASH | SAME AS LINE BEING EXTENDED | 2' (600) LINE WITH 6' (1.8 m) SPACE |
| EDGE LINES | 4 (100) | SOLID | YELLOW-LEFT WHITE-RIGHT | OUTLINE MEDIANS IN YELLOW |
| TURN LANE MARKINGS | 6 (150) LINE: FULL SIZE LETTERS & SYMBOLS (8' (2.4m)) | SOLID | WHITE | SEE TYPICAL TURN LANE MARKING DETAIL |
| TWO WAY LEFT TURN MARKING | 2 @ 4 (100) EACH DIRECTION 8' (2.4m) LEFT ARROW | SKIP-DASH AND SOLID IN PAIRS | YELLOW WHITE | 10' (3 m) LINE WITH 30' (9 m) SPACE FOR SKIP-DASH: 5½ (140) C-C BETWEEN SOLID LINE AND SKIP-DASH LINE SEE TYPICAL TWO-WAY LEFT TURN MARKING DETAIL |
| CROSSWALK LINES (PEDESTRIAN) A. DIAGONALS (BIKE & EQUESTRIAN) B. LONGITUDINAL BARS (SCHOOL) | 2 @ 6 (150) 12 (300) @ 45° 12 (300) @ 90° | SOLID SOLID SOLID | WHITE WHITE WHITE | NOT LESS THAN 6' (1.8 m) APART 2' (600) APART 2' (600) APART SEE TYPICAL CROSSWALK MARKING DETAILS. |
| STOP LINES | 24 (600) | SOLID | WHITE | PLACE 4' (1.2 m) IN ADVANCE OF AND PARALLEL TO CROSSWALK, IF PRESENT. OTHERWISE, PLACE AT DESIRED STOPPING POINT, PARALLEL TO CROSSROAD CENTERLINE, WHERE POSSIBLE |
| PAINTED MEDIANS | 2 @ 4 (100) WITH 12 (300) DIAGONALS @ 45° NO DIAGONALS USED FOR 4' (1.2 m) WIDE MEDIANS | SOLID | YELLOW: TWO WAY TRAFFIC WHITE: ONE WAY TRAFFIC | 11 (280) C-C FOR THE DOUBLE LINE SEE TYPICAL PAINTED MEDIAN MARKING. |
| GORE MARKING AND CHANNELIZING LINES | 8 (200) WITH 12 (300) DIAGONALS @ 45° | SOLID | WHITE | DIAGONALS: 15' (4.5 m) C-C (LESS THAN 30MPH (50 km/h)) 20' (6 m) C-C 30MPH (50 km/h) TO 45MPH (70 km/h)) 30' (9 m) C-C (OVER 45MPH (70 km/h)) |
| RAILROAD CROSSING | 24 (600) TRANSVERSE LINES: "RR" IS 6' (1.8 m) LETTERS: 16 (400) LINE FOR "X" | SOLID | WHITE | SEE STATE STANDARD 780001 AREA OF: "R"=3.6 SQ. FT. (0.33 m ²) EACH "X"=54.0 SQ. FT. (5.0 m ²) |
| SHOULDER DIAGONALS (REQUIRED FOR SHOULDERS ≥ 8') | 12 (300) @ 45° | SOLID | WHITE - RIGHT YELLOW - LEFT | 50' (15 m) C-C (LESS THAN 30MPH (50 km/h)) 75' (25 m) C-C (30 MPH (50 km/h) TO 45MPH (70 km/h)) 150' (45 m) C-C (OVER 45MPH (70 km/h)) |
| U TURN ARROW | SEE DETAIL | SOLID | WHITE | 16.3 SF |
| 2 ARROW COMBINATION LEFT AND U TURN | SEE DETAIL | SOLID | WHITE | 30.4 SF |

FOR FURTHER DETAILS ON PAVEMENT MARKING REFER TO
STANDARD SPECIFICATIONS FOR ROAD AND BRIDGE
CONSTRUCTION AND STATE STANDARD 780001.

All dimensions are in inches (millimeters)
unless otherwise shown.

| | | |
|-----------------------|------------------|------------------------------|
| USER NAME = ivan.diaz | DESIGNED - EVERS | REVISED - C. JUCIUS 09-09-09 |
| | DRAWN - | REVISED - C. JUCIUS 07-01-13 |
| | CHECKED - | REVISED - C. JUCIUS 12-21-15 |
| PLOT DATE = 3/18/2025 | DATE - 03-19-90 | REVISED - C. JUCIUS 04-12-16 |

**STATE OF ILLINOIS
DEPARTMENT OF TRANSPORTATION**

| DISTRICT ONE TYPICAL PAVEMENT MARKINGS | | | | |
|-------------------------------------------|---------|------|--------|--------------|
| SCALE: NONE | SHEET 1 | OF 1 | SHEETS | STA. TO STA. |

| | | | | |
|---------------|-------------|--------------------|------------------|--------------|
| F.A.U RTE. | SECTION | COUNTY | TOTAL SHEETS | SHEET NO. |
| 1251 | 2024-1021-R | LAKE | 24 | 22 |
| TC-13 | | CONTRACT NO. 62X61 | | |
| | | ILLINOIS | FED. AID PROJECT | |

MODEL: TC13 [Sheet]
FILE NAME: c:\pw_ work\pwidot\diaz\id1042128\D105325-sht-DistStd.dgn

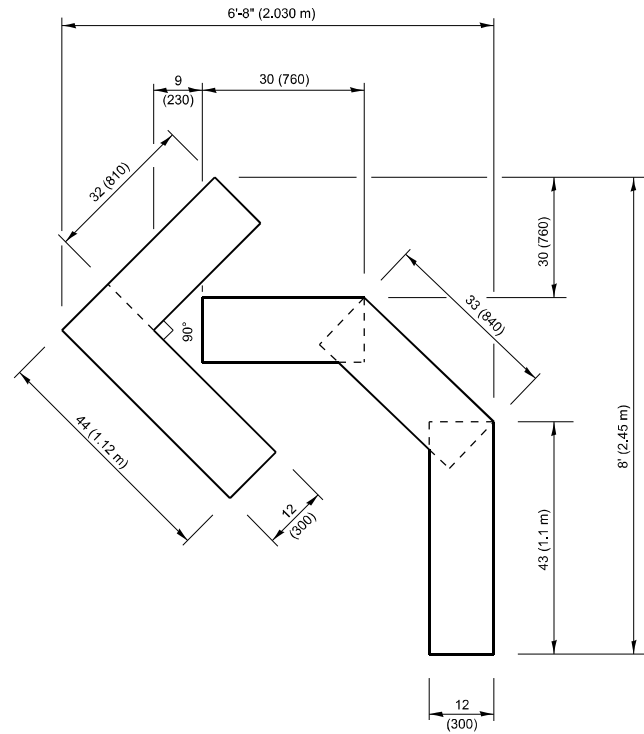

QUANTITY

4 (100) LINE = 45.5 ft. (13.9 m)
15.2 sq. ft. (1.41 sq. m)

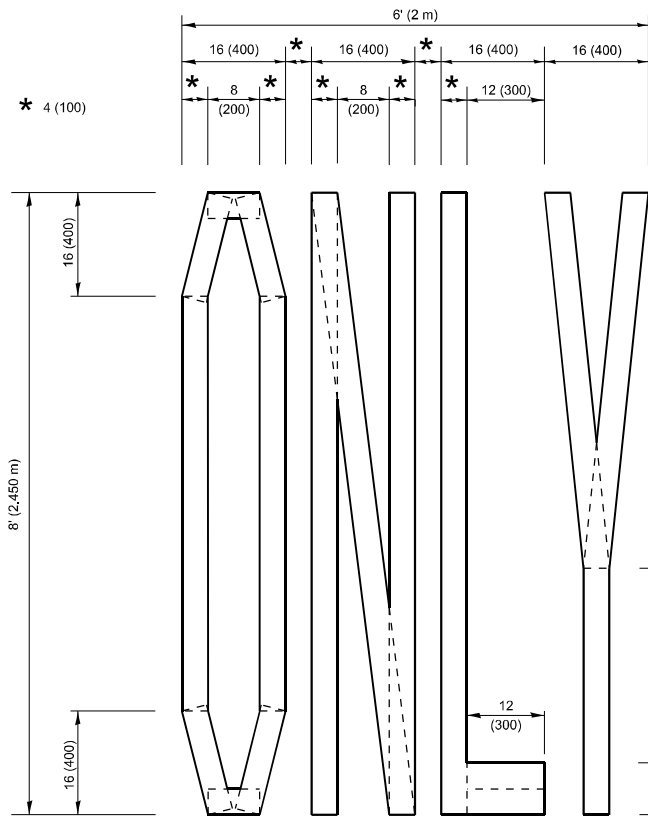

QUANTITY

4 (100) LINE = 64.1 ft. (19.5 m)
21.4 sq. ft. (1.99 sq. m)

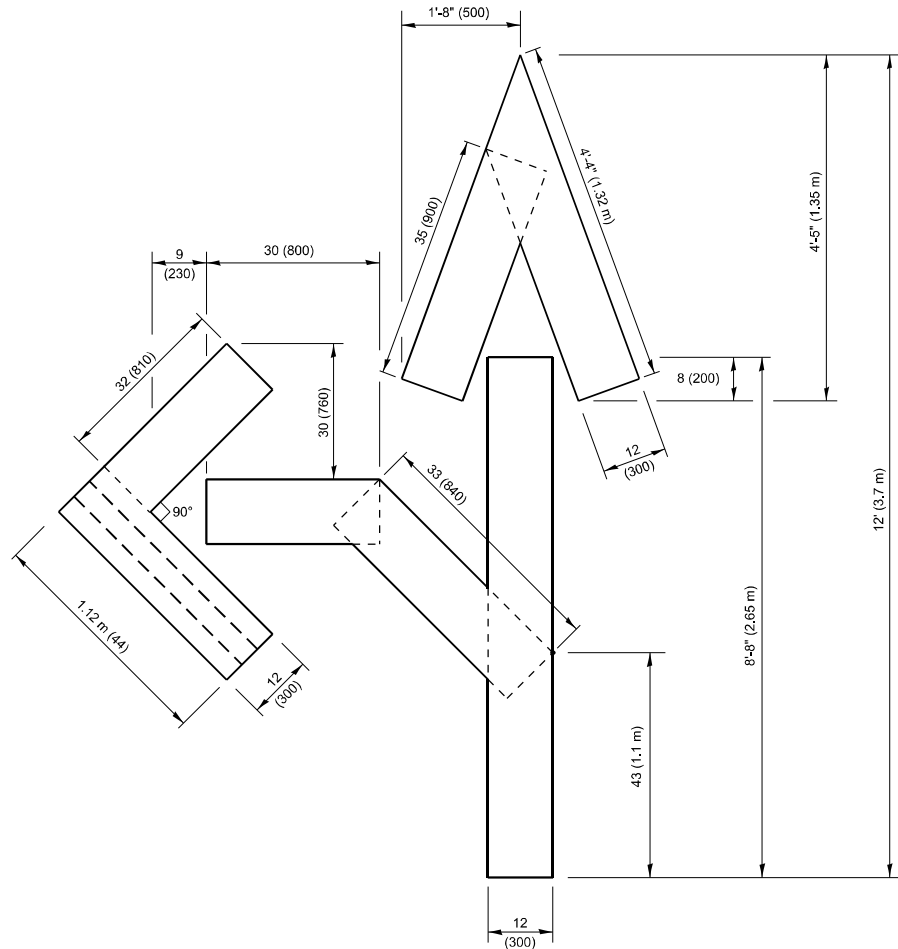

QUANTITY

4 (100) LINE = 82.5 ft. (25.1 m)
27.5 sq. ft. (2.53 sq. m)

NOTE:

ALL QUANTITIES OF PLACEMENT ARE REPRESENTED
IN LINEAR FEET OF 4" LINES TO MATCH THE
4" TEMPORARY TAPE PAY ITEM AND REPRESENTS
THE TOTAL QUANTITY OF 4" TAPE REQUIRED.

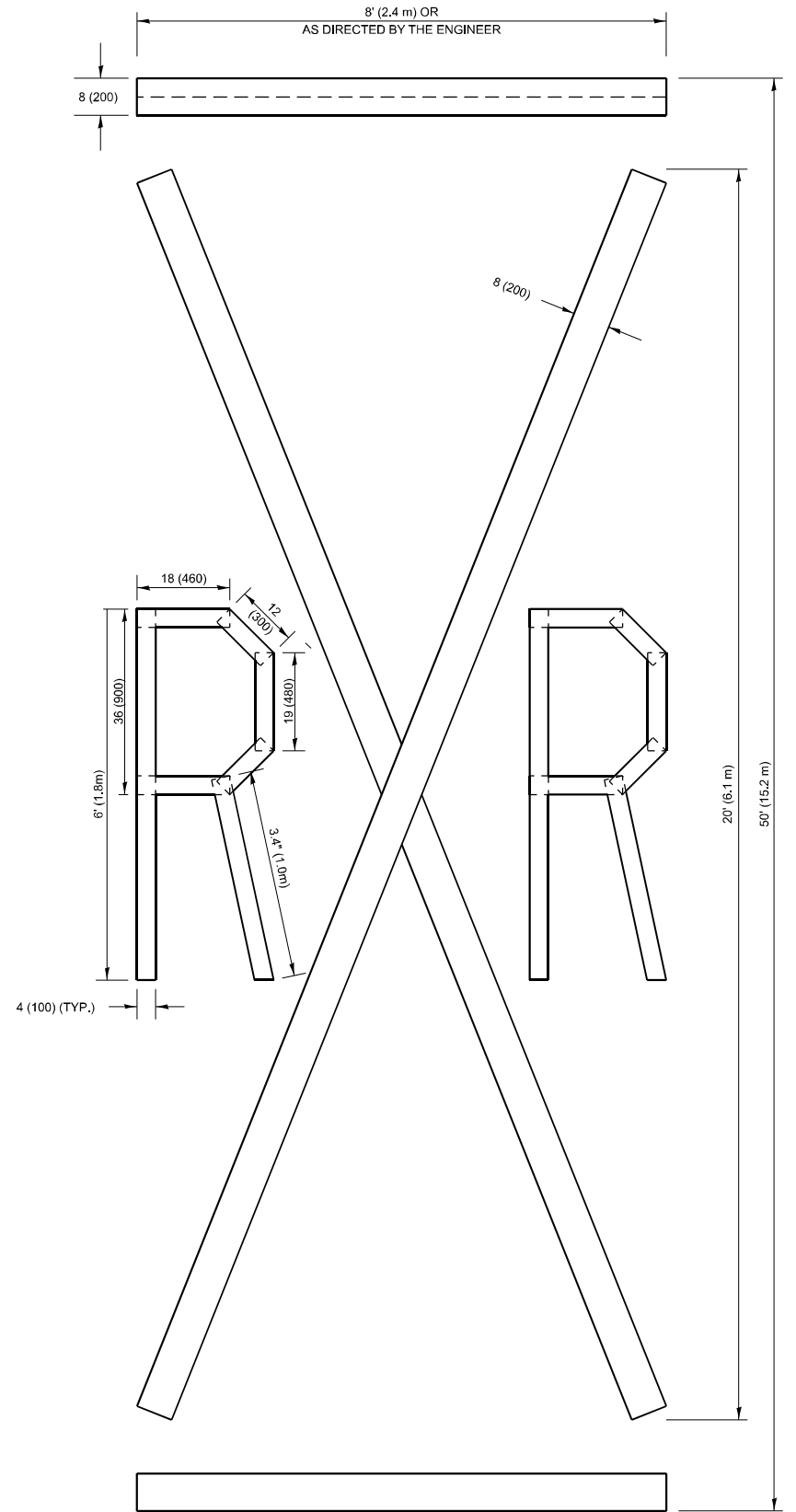

QUANTITY

4 (100) LINE = 225.9 ft. (68.9 m)
75.3 sq. ft. (6.99 sq. m)

All dimensions are in inches (millimeters)
unless otherwise shown.

MODEL: TC16 (Sheet)
FILE NAME: c:\p\work\pav\old\pav\1042128\105325-shh-DiaStd.dgn

| | | | | | | |
|--|-----------|-------------|----------|------------|---------|-------------------------|
| | USER NAME | = ivan.diaz | DESIGNED | - | REVISED | - T. RAMMACHER 03-02-98 |
| | DRAWN | - | | | REVISED | - E. GOMEZ 08-28-00 |
| | CHECKED | - | | | REVISED | - E. GOMEZ 08-28-00 |
| | PLOT DATE | = 3/18/2025 | DATE | - 09-18-94 | REVISED | - A. SCHUETZE 09-15-16 |

STATE OF ILLINOIS
DEPARTMENT OF TRANSPORTATION

SHORT TERM PAVEMENT MARKING LETTERS AND SYMBOLS

SCALE: NONE SHEET 1 OF 1 SHEETS STA. TO STA.

| F.A.U RTE. | SECTION | COUNTY | TOTAL SHEETS | SHEET NO. |
|---------------|-------------|--------------------|------------------|--------------|
| 1251 | 2024-1021-R | LAKE | 24 | 23 |
| TC-16 | | CONTRACT NO. 62X61 | | |
| | | ILLINOIS | FED. AID PROJECT | |

MODEL: TC22 (Sheet)
FILE NAME: c:\p\work\pwork\diaz\ad1042\28D105325-shh-DiazStd.dgn

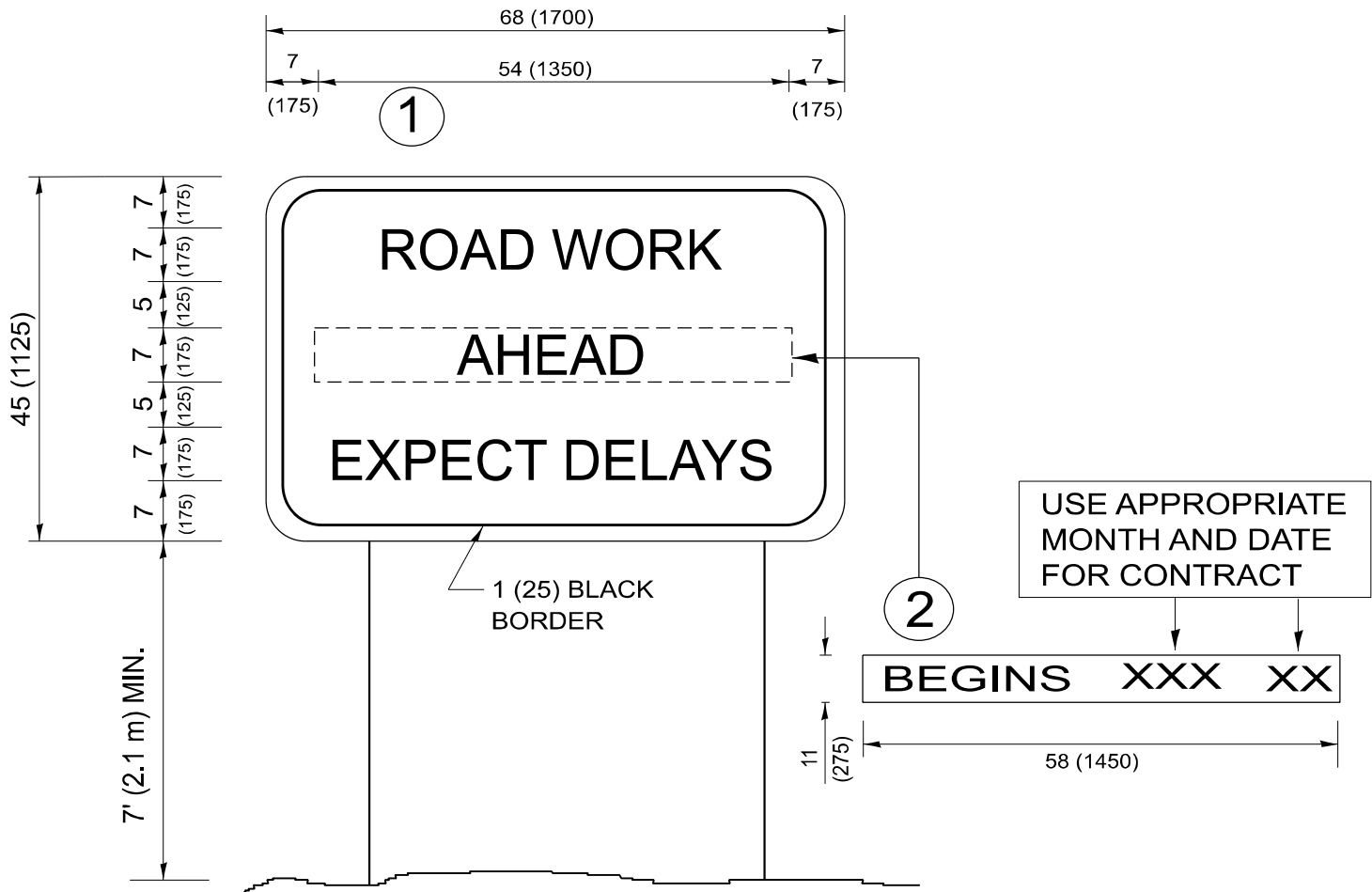

NOTES:

1. USE BLACK LETTERING ON ORANGE BACKGROUND.
2. ERECT SIGNS IN ADVANCE OF THE LOCATION FOR THE "ROAD CONSTRUCTION AHEAD" SIGN AT LOCATIONS AS DIRECTED BY THE ENGINEER.
3. ERECT SIGN ① WITH INSTALLED PANEL ② ONE WEEK PRIOR TO THE START OF CONSTRUCTION.
4. REMOVE PANEL ② SOON AFTER THE START OF CONSTRUCTION.
5. SEE SPECIAL PROVISION FOR "TEMPORARY INFORMATION SIGNING" FOR ADDITIONAL INFORMATION.
6. ONE SIGN ASSEMBLY EQUALS 25.70 SQ. FT. (2.3 SQ. M.)
7. SHALL BE PAID FOR AS TEMPORARY INFORMATION SIGNING.

ALL DIMENSIONS ARE IN INCHES (MILLIMETERS)
UNLESS OTHERWISE SHOWN.

| | | | | | | | | | | | | | | | |
|--|-------------------------|--------------|-----------------------------------|---------------------------------------------------|-----------------------------------|--|----------|--|---------------|-------------|--------|------------------|--------------|--------------------|--|
| | USER NAME = ivan.diaz | DESIGNED - | REVISED - R. MIRS 09-15-97 | STATE OF ILLINOIS DEPARTMENT OF TRANSPORTATION | ARTERIAL ROAD INFORMATION SIGN | | | | F.A.U RTE. | SECTION | COUNTY | TOTAL SHEETS | SHEET NO. | | |
| | | DRAWN - | REVISED - R. MIRS 12-11-97 | | | | | | 1251 | 2024-1021-R | LAKE | 24 | 24 | | |
| | | CHECKED - | REVISED - T. RAMMACHER 02-02-99 | | | | | | TC-22 | | | | | CONTRACT NO. 62X61 | |
| | PLOT DATE = 3/18/2025 | DATE - | REVISED - C. JUCIUS 01-31-07 | | SCALE: NONE | | | | | SHEET 1 | OF 1 | SHEETS | STA. | TO STA. | |
| | | | | | | | ILLINOIS | | | | | FED. AID PROJECT | | | |