

BILL OF MATERIALS - RIVER BIRCH WEST

ITEM	UNIT	TOTAL
HOT-MIX ASPHALT SURFACE COURSE, MIX "C", N50	TON	109.0
AGGREGATE WEDGE SHOULDER, TYPE B	TON	4.1
SIGN PANEL - TYPE 1	SO FT	13
WOOD SIGN SUPPORT	FOOT	29
PAINT PAVEMENT MARKING - LINE 4"	FOOT	324
REMOVE EXISTING PARKING BLOCKS	EACH	19
PRECAST CONCRETE PARKING BLOCK	EACH	19
BITUMINOUS MATERIALS (PRIME COAT)	POUND	438

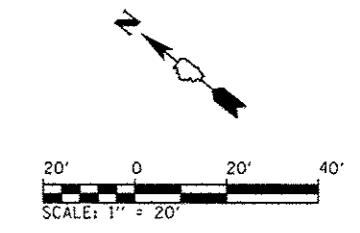
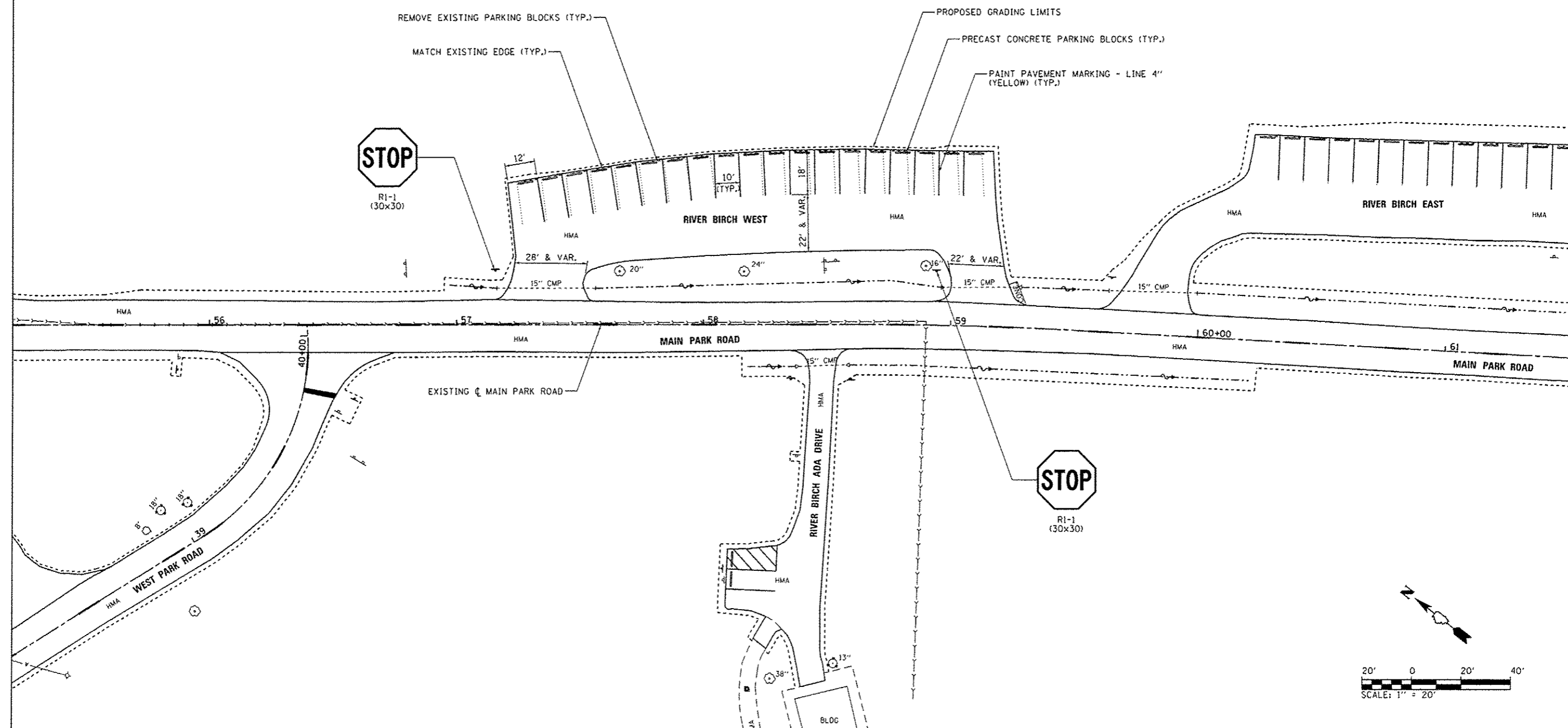

FILE NAME : L:\11001\1106610\VDL15\Draw\CADD_Sheets\046251-sht-MainPark-0885SitePlan-RBW.dgn	USER NAME : Brad Downen	DESIGNED - MJO	REVISED -	STATE OF ILLINOIS DEPARTMENT OF TRANSPORTATION	SITE PLAN - RIVER BIRCH WEST KANKAKEE RIVER STATE PARK	F.A. RTE.	SECTION	COUNTY	TOTAL SHEETS	SHEET NO.
Default	PLOT SCALE : 40.0000' / in.	DRAWN - RAH	REVISED -			PARK ROADS	*	ILLINOIS	140	64
	PLOT DATE : 4/6/2013	CHECKED - BJD	REVISED -			* WILL & KANKAKEE		CONTRACT NO. 46251		
		DATE - 3/29/2013	REVISED -			ILLINOIS FED. AID PROJECT				