

**BILL OF MATERIALS - RIVER BIRCH ADA DRIVE**

ITEM	UNIT	TOTAL
LEVELING BINDER (MACHINE METHOD), N50	TON	3.7
HOT-MIX ASPHALT SURFACE REMOVAL - BUTT JOINT	50 YD	20
HOT-MIX ASPHALT SURFACE COURSE, MIX "C", N50	TON	28.9
AGGREGATE WEDGE SHOULDER, TYPE B	TON	3.6
SIGN PANEL - TYPE 1	50 FT	11
WOOD SIGN SUPPORT	FOOT	44
PAINT PAVEMENT MARKING - LINE 4"	FOOT	95
PRECAST CONCRETE PARKING BLOCK	EACH	2
FOLD DOWN BOLLARDS	EACH	1
BOLLARD REMOVAL	EACH	1
REMOVE SIGN COMPLETE	EACH	2
BITUMINOUS MATERIALS (PRIME COAT)	POUND	175

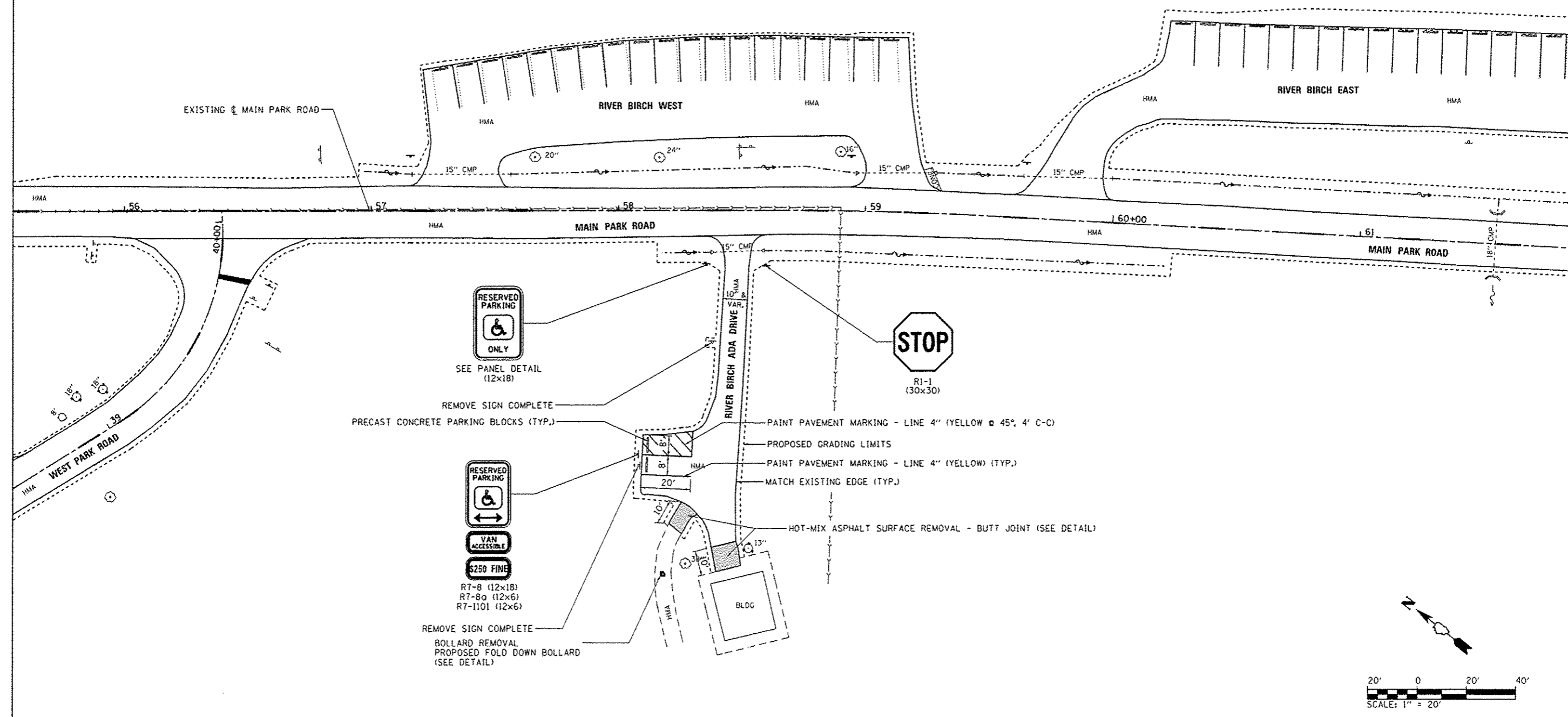

FILE NAME : L:\V\DOT\1180618\W0.15\Draw\CAADD_Sheets\46251-sht-MainPark-09\SitePlan-ROADA.dgn	USER NAME : Brad Downen	DESIGNED - MJJ	REVISED -	<b>STATE OF ILLINOIS DEPARTMENT OF TRANSPORTATION</b>	<b>SITE PLAN - RIVER BIRCH ADA DRIVE KANKAKEE RIVER STATE PARK</b>		F.A. RTE.	SECTION	COUNTY	TOTAL SHEETS	SHEET NO.	
Default	PLOT SCALE = 48.0000' / in.	DRAWN - RAH	REVISED -		SCALE: 1" = 20'	SHEET 1 OF 1 SHEETS	STA.	TO STA.	* WILL & KANKAKEE	CONTRACT NO. 46251	140	65
	PLOT DATE = 4/6/2013	CHECKED - BJD	REVISED -						ILLINOIS FED. AID PROJECT			
		DATE - 3/29/2013	REVISED -									