

POINT NUMBER	STATION	OFFSET	ELEVATION
1	18+05.00	12.00' LT	651.60
2	18+23.64	12.00' LT	651.23
3	18+35.16	14.30' LT	650.91
4	18+53.64	42.00' LT	652.06
5	18+55.15	42.00' LT	652.09
6	18+55.16	¢	651.52
7	18+35.16	¢	651.12
8	18+05.00	¢	651.78
9	18+05.00	12.00' RT	651.60
10	18+23.64	12.00' RT	651.23
11	18+35.16	14.30' RT	650.91
12	18+53.64	42.00' RT	650.91
13	18+55.18	42.00' RT	650.94

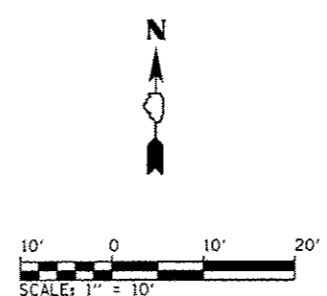

GRADING & STAKING PLAN

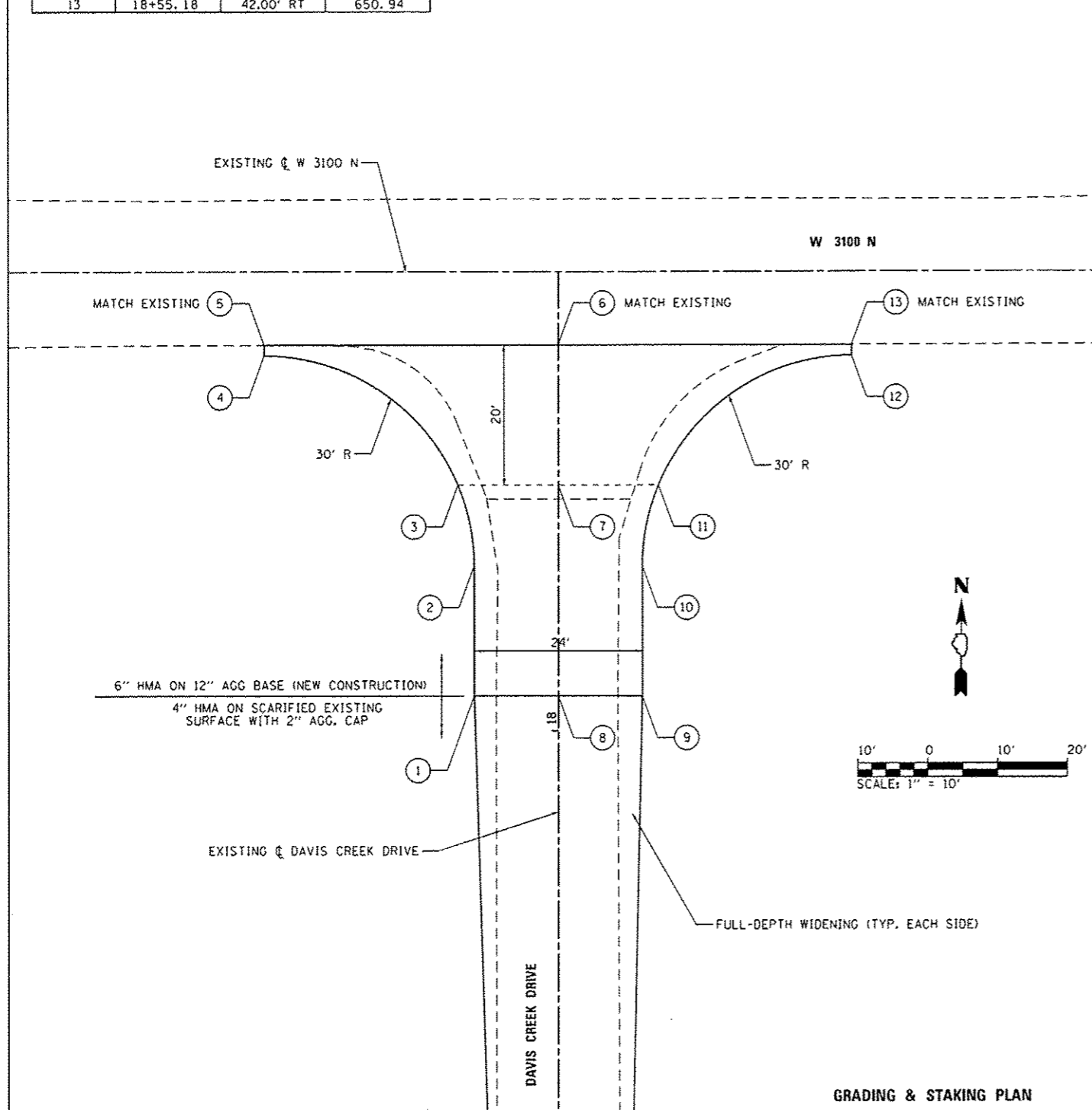
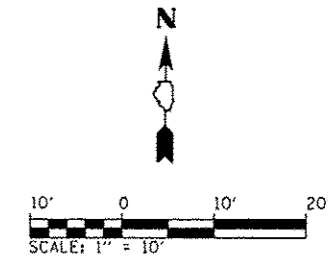
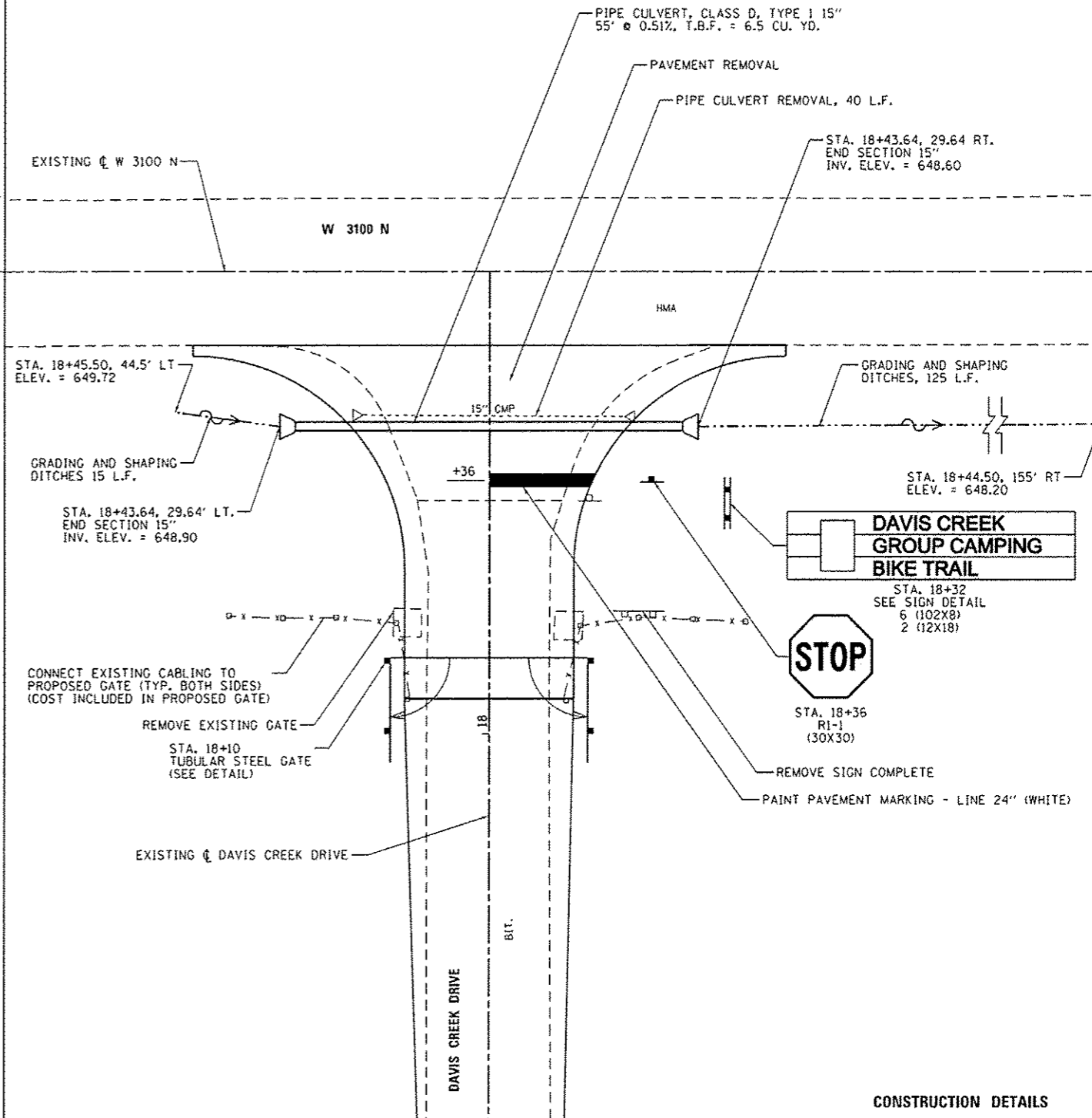

CONSTRUCTION DETAILS

FILE NAME :	USER NAME :	DESIGNED :	REVISED :
L:\1007\1186618\WD_15\0-aw\CA00_Sheets\046251-ent-DavisCreek-087EntranceDetail.dgn	Brod Gowen	MJO	-
Default		DRAWN :	REVISED :
		RAH	-
		CHECKED :	REVISED :
		BJD	-
		DATE :	REVISED :
		3/29/2013	-

STATE OF ILLINOIS
DEPARTMENT OF TRANSPORTATION

ENTRANCE DETAIL - DAVIS CREEK CAMPGROUND
KANKAKEE RIVER STATE PARK

SCALE: 1" = 10' SHEET 7 OF 7 SHEETS STA. TO STA.

F.A. RTE.	SECTION	COUNTY	TOTAL SHEETS	SHEET NO.
	PARK ROADS		140	91
• WILL & KANKAKEE		CONTRACT NO. 46251		
ILLINOIS FED. AID PROJECT				