

STATION 15+00  
MATCHLINE SEE ABOVE

STATION 15+00  
MATCHLINE SEE BELOW

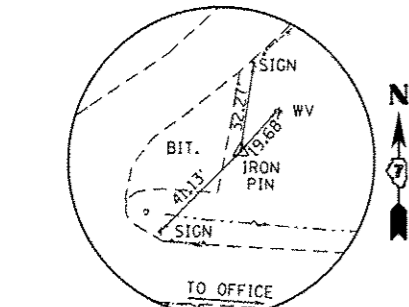

**CONTROL POINT #1**  
 N: 821420.609  
 E: 991903.959  
 ELEV. = 535.191

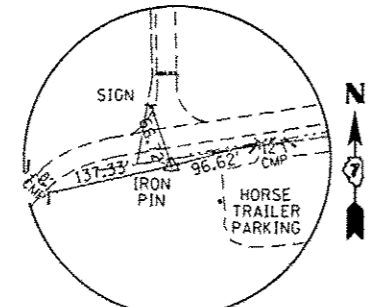

**CONTROL POINT #2**  
 N: 821771.571  
 E: 992202.564  
 ELEV. = 535.090

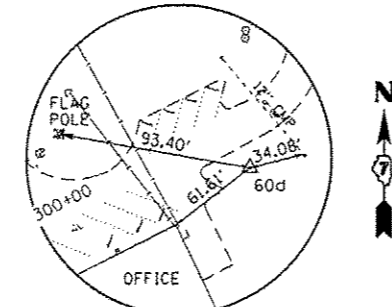

**CONTROL POINT #3**  
 N: 821233.575  
 E: 992273.064  
 ELEV. = 531.57

FILE NAME: L:\1001\1106610\W013\Draw\1400_Sheets\46255_SitePlan - North.dgn	USER NAME: Brian Bond	DESIGNED: BMB	REVISED:
PLOT SCALE: 200.0000 / in.	DRAWN: RAH	CHECKED: JMM	REVISED:
PLOT DATE: 3/29/2013	DATE: 3/29/2013		REVISED:

**STATE OF ILLINOIS  
DEPARTMENT OF TRANSPORTATION**

<b>SITE PLAN - NORTH DAY USE AREA</b>			
<b>NEWTON LAKE STATE FISH AND WILDLIFE AREA</b>			
SCALE: AS NOTED	SHEET	OF SHEETS	STA. TO STA.

F.A. RTE.	SECTION	COUNTY	TOTAL SHEETS	SHEET NO.
N/A	PARKS ROADS	JASPER	66	11
CONTRACT NO. 46255				
ILLINOIS FED. AID PROJECT				