

PLAN	SURVEYED	BY	DATE
	PLOTTED		
	GRADES CHECKED		
	STRUCTURE NOTATIONS CHECKED		
	NOTE BOOK NO.		
	CADD FILE NAME		

PROFILE	SURVEYED	BY	DATE
	PLOTTED		
	GRADES CHECKED		
	STRUCTURE NOTATIONS CHECKED		
	NOTE BOOK NO.		
	CADD FILE NAME		

FILE NAME = \\collinsengr.com\1\update\1\Posanden\DDCS\7000 - I94 at Ohio Street\CADD\SHEETS\DI6063-PRE3.dgn

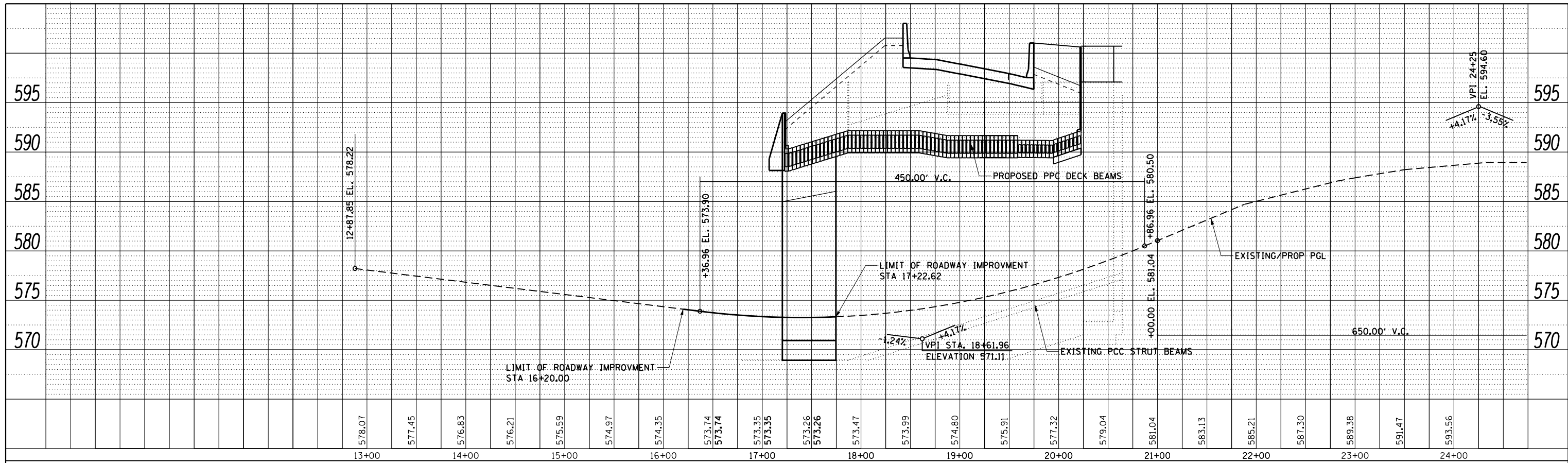

578.07	577.45	576.83	576.21	575.59	574.97	574.35	573.74	573.35	573.26	573.47	573.99	574.80	575.91	577.32	579.04	581.04	583.13	585.21	587.30	589.38	591.47	593.56	
13+00	14+00	15+00	16+00	17+00	18+00	19+00	20+00	21+00	22+00	23+00	24+00												



USER NAME = rge11  
 PLOT SCALE = 100.000' / in.  
 PLOT DATE = 3/25/2013

DESIGNED -	REVISED -
DRAWN -	REVISED -
CHECKED -	REVISED -
DATE -	REVISED -

STATE OF ILLINOIS  
 DEPARTMENT OF TRANSPORTATION

PROPOSED ROADWAY PROFILE  
 RAMP A

SCALE: SHEET NO. OF SHEETS STA. TO STA.

F.A.I. RTE.	SECTION	COUNTY	TOTAL SHEETS	SHEET NO.
90/94	0303-474HB-R	COOK	368	48
CONTRACT NO. 60F63				
ILLINOIS FED. AID PROJECT				