

FILE NAME = \\collinsengr.com\1\pds\1\Posanden\1\Posanden\DDCS\Y2000 - 134.ctb\Drawn\Street\CA00D\SHEETS\0160F63-DRNS RAMP B.dgn

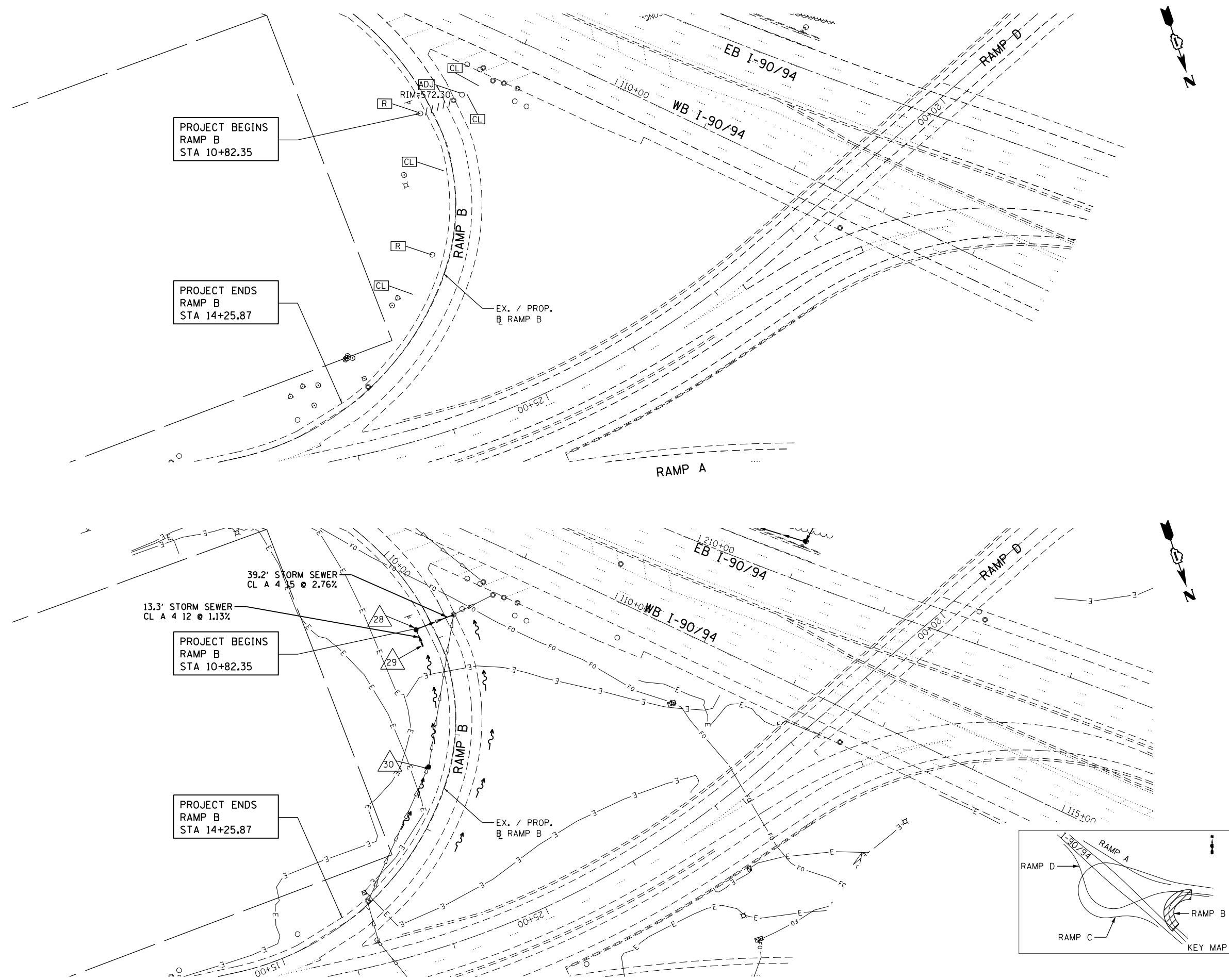

- △ 28 STA 10+82.17, 17.0' RT (RAMP B)
 CB TA 4 DIA T8C
 RIM 570.65
 N. INV 567.59
 W. INV 566.87
- △ 29 STA 11+00.17, 17.0' RT (RAMP B)
 INLET TA T8C
 RIM 571.18
 S. INV 567.74
- △ 30 STA 12+39.6, 20.0' RT (RAMP B)
 CB TA 4 DIA T8C
 RIM 575.26
 S. INV 559.61 (EX)
 N. INV 559.61 (EX)

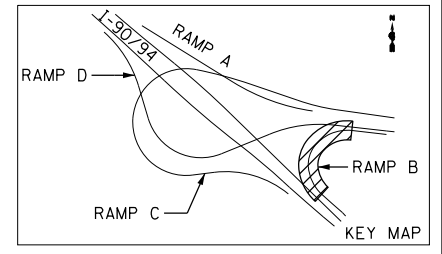

COLLINS ENGINEERS

USER NAME = r9e11	DESIGNED -	REVISED -
PLOT SCALE = 100.000000' / in.	DRAWN -	REVISED -
PLOT DATE = 3/25/2013	CHECKED -	REVISED -
	DATE -	REVISED -

**STATE OF ILLINOIS
 DEPARTMENT OF TRANSPORTATION**

**RAMP B
 EXISTING AND PROPOSED DRAINAGE PLAN**

SCALE: SHEET NO. 5 OF 5 SHEETS STA. TO STA.

F.A.I. RTE. 90/94	SECTION 0303-474HB-R	COUNTY COOK	TOTAL SHEETS 368	SHEET NO. 129
CONTRACT NO. 60F63				
FED. ROAD DIST. NO. 1 ILLINOIS FED. AID PROJECT				