

Measured On Curve Along
Inside Face of North Parapet

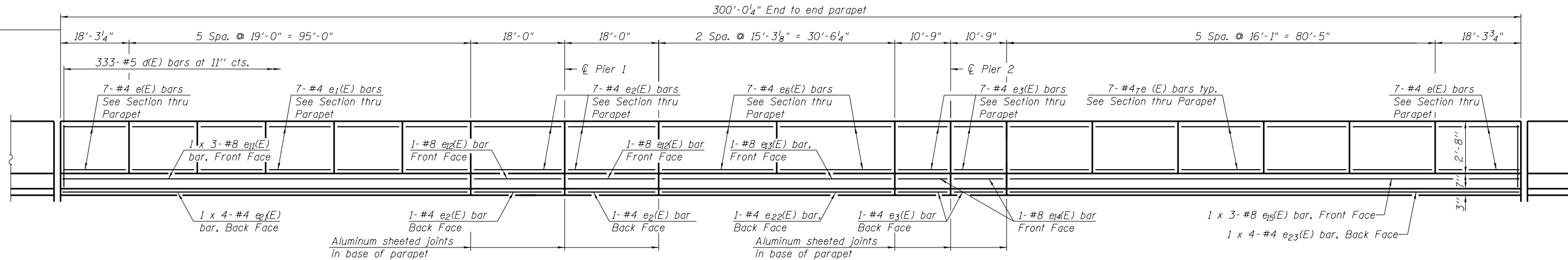

INSIDE ELEVATION OF NORTH PARAPET

(Looking South)

Dimensions given along inside face of parapet

Measured On Curve Along
Inside Face of South Parapet

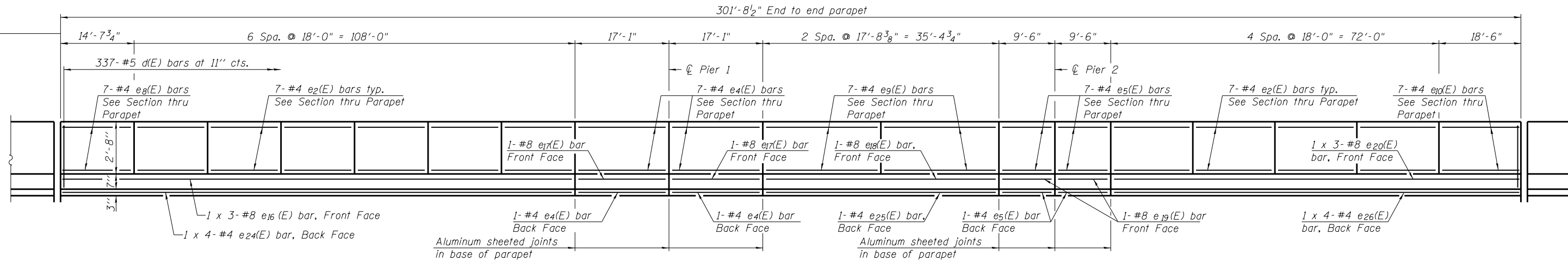

INSIDE ELEVATION OF SOUTH PARAPET

(Looking South)

Dimensions given along inside face of parapet

Notes:

See Sheet S16 of S49 for Section Thru Parapet.
Bars indicated thus 1 x 3-#4 etc. indicates 1 line of bars with 3 lengths per line.
Bend longitudinal reinforcement to fit in field.

MINIMUM BAR LAP

(Parapet)

#4 bar = 2'-0"

#8 bar = 5'-2"

USER NAME =	DESIGNED - MAH	REVISED
	CHECKED - LDB	REVISED
PLOT SCALE =	DRAWN - DR	REVISED
PLOT DATE =	CHECKED - JMH	REVISED

F.A.P. RTE.	SECTION	COUNTY	TOTAL SHEETS	SHEET NO.
0383	0303-474HB-R	COOK	368	207
CONTRACT NO. 60F63				
ILLINOIS FED. AID PROJECT				