

Bench Mark: BM-12 N. 1,904,392.510 E. 1,168,864.965 El. 581.496 Cut "Square" at SW corner, end of conc. barrier wall at SW corner of conc. support pier for Ontario feeder to I-90/94 EB overpass at left shoulder for EB I-90/94 exit 50B. At SW corner, top of barrier wall, 8.20 Ft. Westerly of SE corner of pier and 3.20 Ft. Southerly of NW corner of pier.

Existing Structure: S.N. 016-1003 was originally built in 1959 as F.A.I. Route 94, Section 0303-477-HB and rehabilitated in 1994. The existing structure consists of 8-span cast-in-place concrete curved box girders supported on stub abutments on pile supported footings and single-column rectangular piers (monolithic with the box girder structure). The back to back of abutments measures 637'-0 3/4" and the out-to-out of deck is 34'-8". The structure is to be removed and replaced with a three span bridge (S.N. 016-1322). A single span bridge (S.N. 016-1323) and three MSE walls. Traffic is to be maintained utilizing stage construction. Temporary detour of Ramp D will be utilized during the setting of beams.

No Salvage.

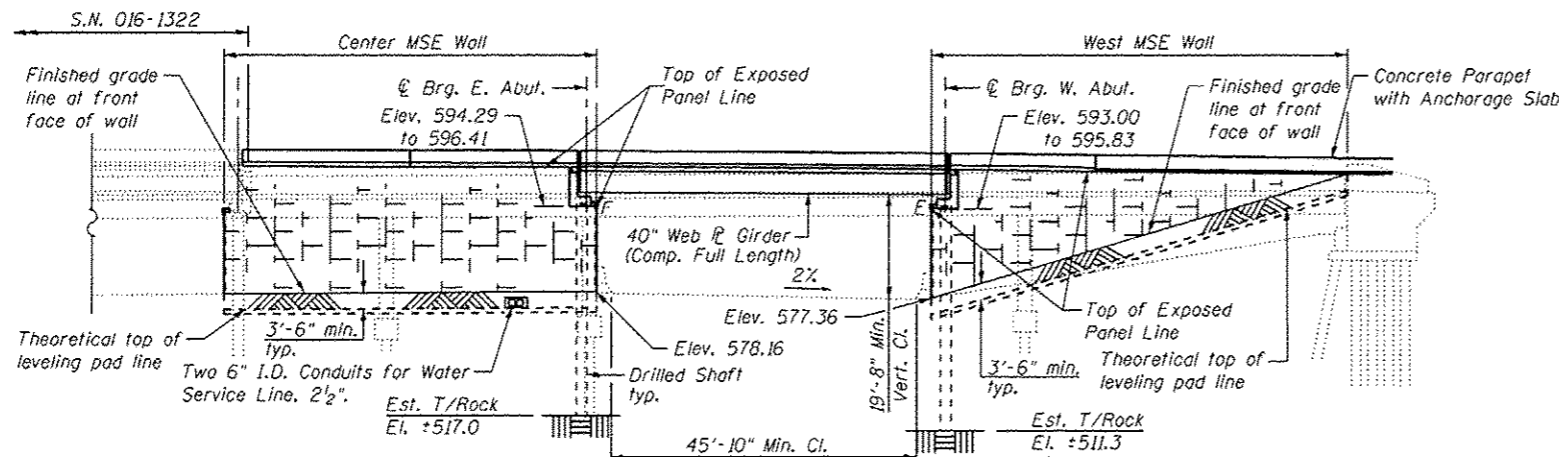
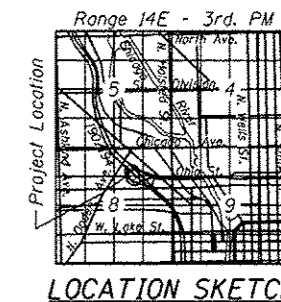
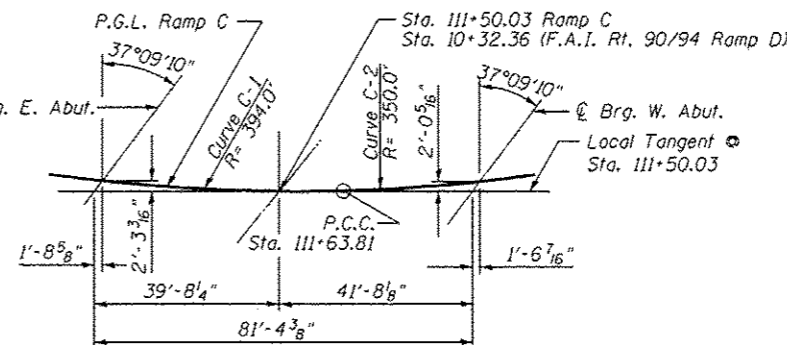
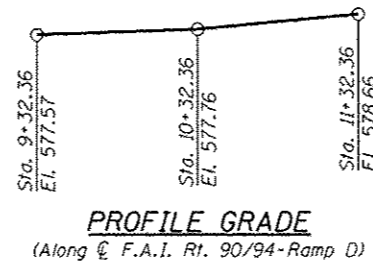

STATION 111+50.03
BUILT BY
STATE OF ILLINOIS
F.A.P. RT. 0383 SEC. 0303-474HB-R
LOADING HL-93
STR. NO. 016-1323

NAME PLATE
(See Std. 515001)

DESIGN SPECIFICATIONS
2012 AASHTO LRFD Bridge Design
Specifications, 6th Edition

LOADING HL-93
Allow 50#/sq. ft. for future wearing surface.

DESIGN STRESSES
FIELD UNITS

f'c = 3,500 psi
fy = 60,000 psi (Reinforcement)
fy = 50,000 psi (M270 Grade 50)

SEISMIC DATA

Seismic Performance Zone (SPZ) = 1
Design Spectral Acceleration at 1.0 sec. (S_{D1}) = 0.085g
Design Spectral Acceleration at 0.2 sec. (S_{D5}) = 0.143g
Soil Site Class = D

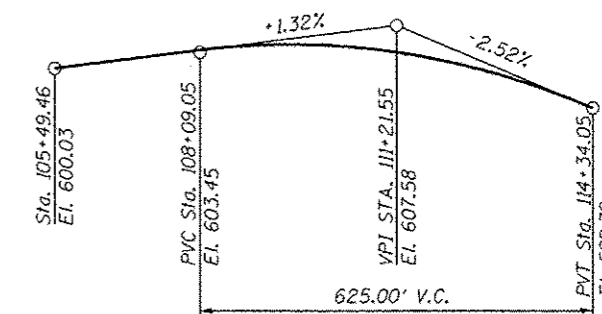

PROFILE GRADE
(Along P.G.L. Ramp C)

APPROVED
For Structural Adequacy Only
De Carl Ruppberg
Engineer of Bridges & Structures



GOLLINS ENGINEERS, INC.
JAMES M. HAMELKA
NO. 81-6116
EXPIRES 11-30-2014

GENERAL PLAN AND ELEVATION
ONTARIO STREET OVER F.A.I. RT. 90/94 RAMP D
F.A.P. RT. 0383 - SEC. 0303-474HB-R
COOK COUNTY
STATION 111+50.03
STRUCTURE NO. 016-1323

CURVE C-1 DATA
P.I. = Sta. 109+48.55
Δ = 76° 21' 27" (LT)
D = 14° 32' 31"
R = 394.00'
T = 309.81'
L = 525.08'
E = 107.22'
S.E. = 0.06''
P.C. Sta. = 106+38.74
P.C.C. Sta. = 111+63.81

CURVE C-2 DATA
P.I. = Sta. 118+82.33
Δ = 128° 03' 26" (LT)
D = 16° 22' 13"
R = 350.00'
T = 718.52'
L = 782.26'
E = 449.23'
S.E. = 0.06''
P.C.C. Sta. = 111+63.81
P.T. Sta. = 119+46.07

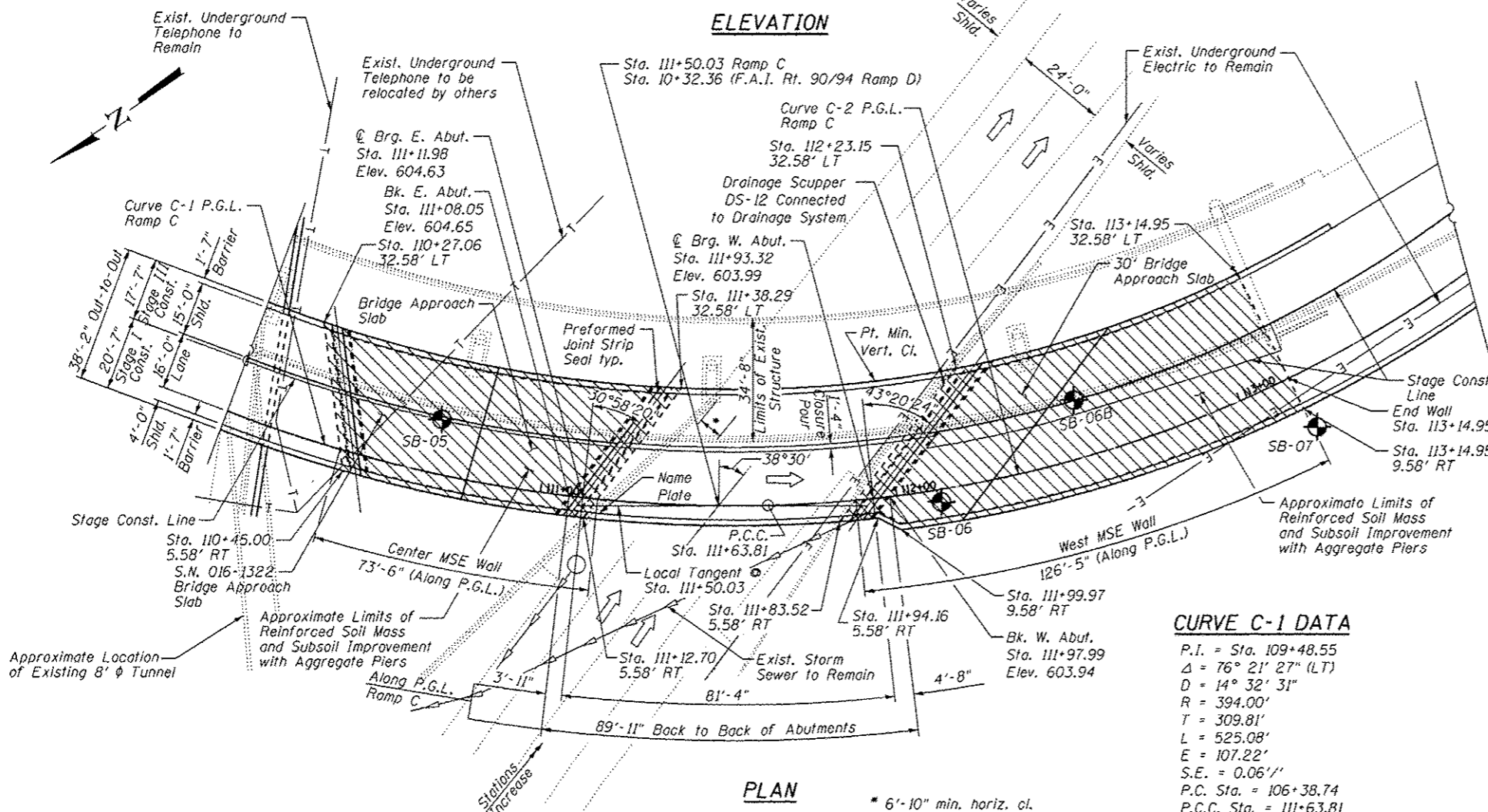

COLLINS ENGINEERS
1223 N. Western Dr.
Chicago, IL 60642
Tel: 312.942.1100
Fax: 312.942.1101
www.collinseng.com

| | | |
|------------|----------------|---------|
| USER NAME | DESIGNED - AMS | REVISED |
| PLOT SCALE | CHECKED - LDB | REVISED |
| PLOT DATE | DRAWN - DR | REVISED |
| | CHECKED - JMH | REVISED |

STATE OF ILLINOIS
DEPARTMENT OF TRANSPORTATION

GENERAL PLAN AND ELEVATION
STRUCTURE NO. 016-1323
SHEET NO. SRI OF SR41 SHEETS

| F.A.P. RTE. | SECTION | COUNTY | TOTAL SHEETS | SHEET NO. |
|--------------------|--------------|--------|---------------------------|-----------|
| 0383 | 0303-474HB-R | COOK | 368 | 242 |
| CONTRACT NO. 60F63 | | | ILLINOIS FED. AID PROJECT | |