

INSIDE ELEVATION OF SOUTH PARAPET
(Looking South)

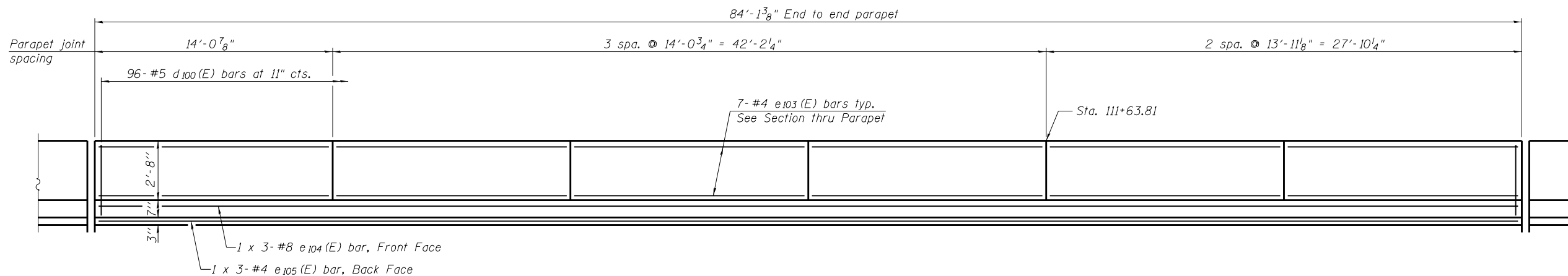

INSIDE ELEVATION OF NORTH PARAPET
(Looking South)

Notes:

See sheet SR1 and SR11 of SR41 for curve change details at Sta. 111+63.81.
See sheet SR13 of SR41 for Section Thru Parapet.
Bars indicated thus 1 x 3-#4 etc. indicates 1 line of bars with 3 lengths per line.
Bend longitudinal reinforcement to fit in field.

MINIMUM BAR LAP
(Parapet)
#4 bar = 2'-0"
#8 bar = 5'-2"

USER NAME =	DESIGNED - AMS	REVISED
	CHECKED - LDB	REVISED
PLOT SCALE =	DRAWN - DR	REVISED
PLOT DATE =	CHECKED - JMH	REVISED

F.A.P. RTE.	SECTION	COUNTY	TOTAL SHEETS	SHEET NO.
0383	0303-474HB-R	COOK	368	253
CONTRACT NO. 60F63				