

STATE OF ILLINOIS  
DEPARTMENT OF TRANSPORTATION  
DIVISION OF HIGHWAYS

# PROPOSED HIGHWAY PLANS

ROUTE IL. ROUTE 173  
SECTION @ TIFFANY ROAD  
PROJECT R-91-024-10  
LAKE COUNTY  
DEED D-91-449-06

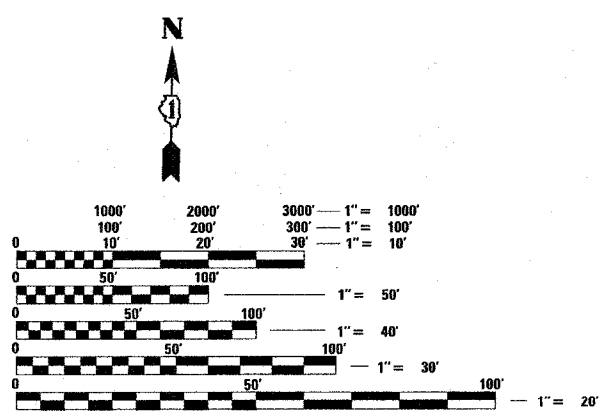
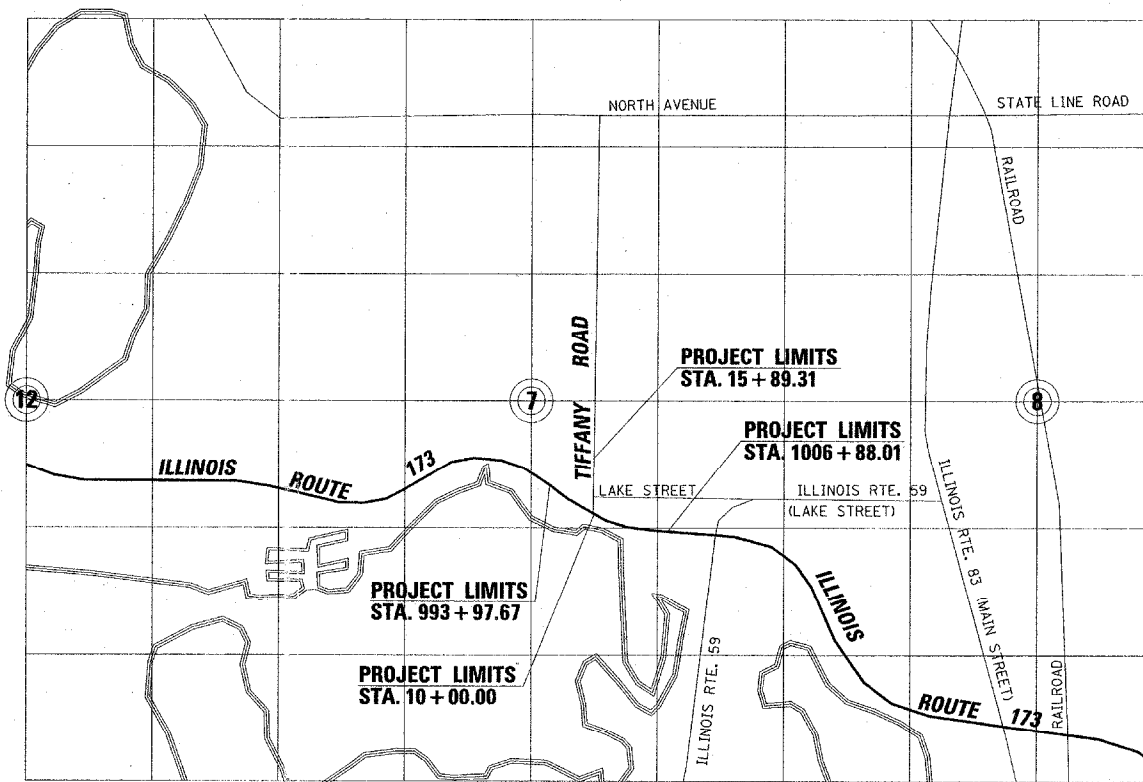
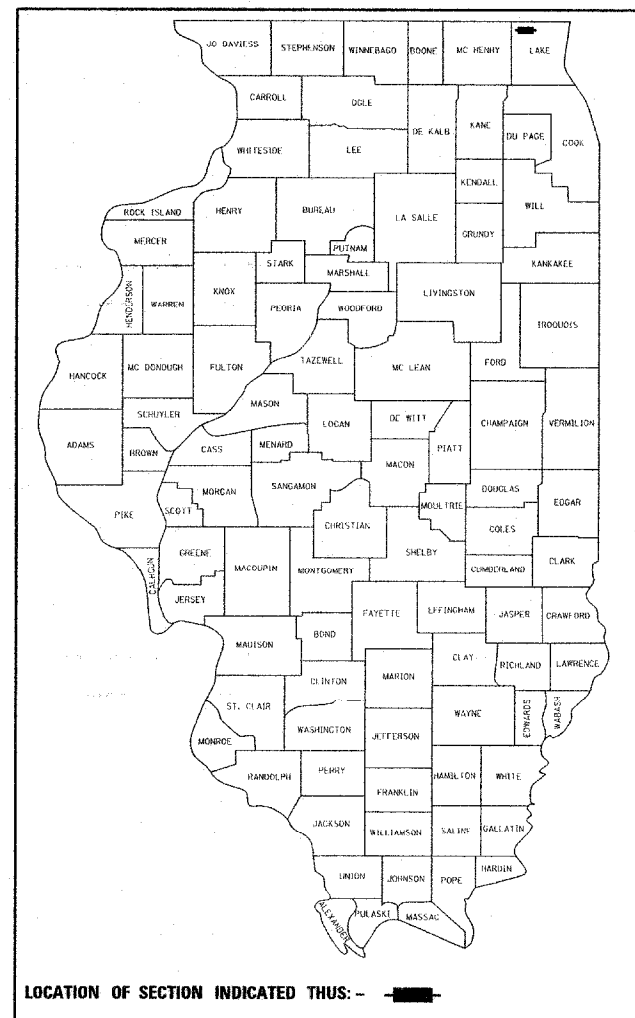

FULL SIZE PLANS HAVE BEEN PREPARED USING STANDARD ENGINEERING SCALES. REDUCED SIZED PLANS WILL NOT CONFORM TO STANDARD SCALES. IN MAKING MEASUREMENTS ON REDUCED PLANS, THE ABOVE SCALES MAY BE USED.

J.U.L.I.E.  
JOINT UTILITY LOCATION INFORMATION FOR EXCAVATION  
1-800-892-0123  
OR 811

|              |                |               |            |
|--------------|----------------|---------------|------------|
| GROSS LENGTH | IL 173 =       | 1290.34 FT. = | 0.244 MILE |
|              | TIFFANY ROAD = | 589.31 FT. =  | 0.112 MILE |
| NET LENGTH   | IL 173 =       | 770 FT. =     | 0.146 MILE |
|              | TIFFANY ROAD = | 589.31 FT. =  | 0.112 MILE |

CONTRACT NO.

STATE OF ILLINOIS  
DEPARTMENT OF TRANSPORTATION  
DIVISION OF HIGHWAYS

SUBMITTED \_\_\_\_\_ 20 \_\_\_\_\_

DEPUTY DIRECTOR OF HIGHWAYS, REGION ENGINEER

\_\_\_\_\_ 20 \_\_\_\_\_

ENGINEER OF DESIGN AND ENVIRONMENT

\_\_\_\_\_ 20 \_\_\_\_\_

DIRECTOR OF HIGHWAYS, CHIEF ENGINEER

RECEIVED  
OCT 11 2012  
PLATS & LEGALS

PRINTED BY THE AUTHORITY  
OF THE STATE OF ILLINOIS