

TRAFFIC SIGNAL SCHEDULE OF QUANTITIES

PAY ITEM	UNIT	QUANTITY
89502300 REMOVE ELECTRICAL CABLE FROM CONDUIT	FOOT	4130
89502380 REMOVE EXISTING HANDHOLE	EACH	3

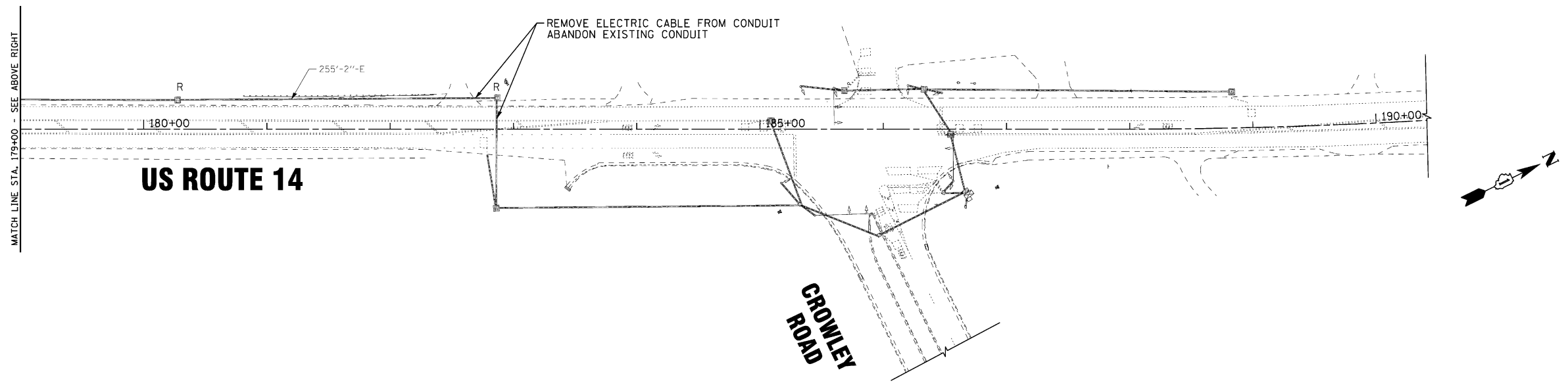

COPYRIGHT © 2012 BY BAXTER & WOODMAN, INC. ALL RIGHTS RESERVED. THIS DOCUMENT IS THE PROPERTY OF BAXTER & WOODMAN, INC. AND IS NOT TO BE REPRODUCED OR TRANSMITTED IN ANY FORM OR BY ANY MEANS, ELECTRONIC OR MECHANICAL, INCLUDING PHOTOCOPYING, RECORDING, OR BY ANY INFORMATION STORAGE AND RETRIEVAL SYSTEM. WITHOUT PERMISSION IN WRITING FROM BAXTER & WOODMAN, INC.



DESIGNED - DSH	REVISED - 5-29-12 UPDATE
DRAWN - KAR	REVISED - 2-4-13 PER TRAFFIC
CHECKED - LDH	REVISED -
DATE - 12-13-10	FILE: 100153-W040-TS-INTRCNCT.dgn

**STATE OF ILLINOIS
DEPARTMENT OF TRANSPORTATION**

**US ROUTE 14 FROM MOTOROLA ENTRANCE TO
CROWLEY ROAD INTERCONNECT REMOVAL PLAN**

SCALE: 1"=50' STA. TO STA.

F.A.P. RTE.	SECTION	COUNTY	TOTAL SHEETS	SHEET NO.
66	21-RS-3	McHENRY	32	22
C-91-297-11			CONTRACT NO. 60N27	
FED. ROAD DIST. NO. 1 ILLINOIS FED AID PROJECT				