

06-14-13 LETTING ITEM 021

F.A.P. RTE. 324	SECTION 24-RS-4	COUNTY McHENRY	TOTAL SHEETS * 16	SHEET NO. 1
FED. ROAD DIST. NO.		ILLINOIS		
D-91-304-11		CONTRACT NO. 60N34		
		*16 of 1 = 17		

STATE OF ILLINOIS
DEPARTMENT OF TRANSPORTATION
DIVISION OF HIGHWAYS

PROPOSED HIGHWAY PLANS

FAP 324 (ILLINOIS ROUTE 23)
SECTION: 24-RS-4
POPLAR ROAD TO INTERSTATE 90 (JANE ADAMS MEMORIAL TOLLWAY)
RESURFACING

MCHENRY COUNTY
C-91-304-11

FOR INDEX OF SHEETS, SEE SHEET NO. 2

IMPROVEMENT LOCATED WITHIN
UNINCORPORATED RILEY TOWNSHIP

DESIGN DESIGNATION
OTHER PRINCIPAL ARTERIAL

TRAFFIC DATA
IL ROUTE 23
2010 ADT = 2250
SPEED LIMIT = 55 MPH

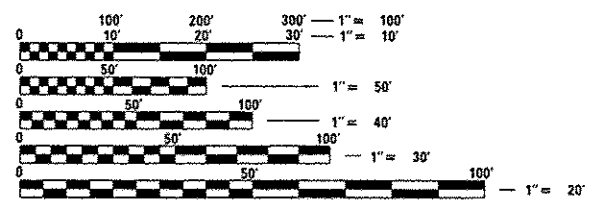

FULL SIZE PLANS HAVE BEEN PREPARED USING STANDARD ENGINEERING SCALES. REDUCED SIZED PLANS WILL NOT CONFORM TO STANDARD SCALES. IN MAKING MEASUREMENTS ON REDUCED PLANS, THE ABOVE SCALES MAY BE USED.

PROJECT BEGINS
STA 106 + 80

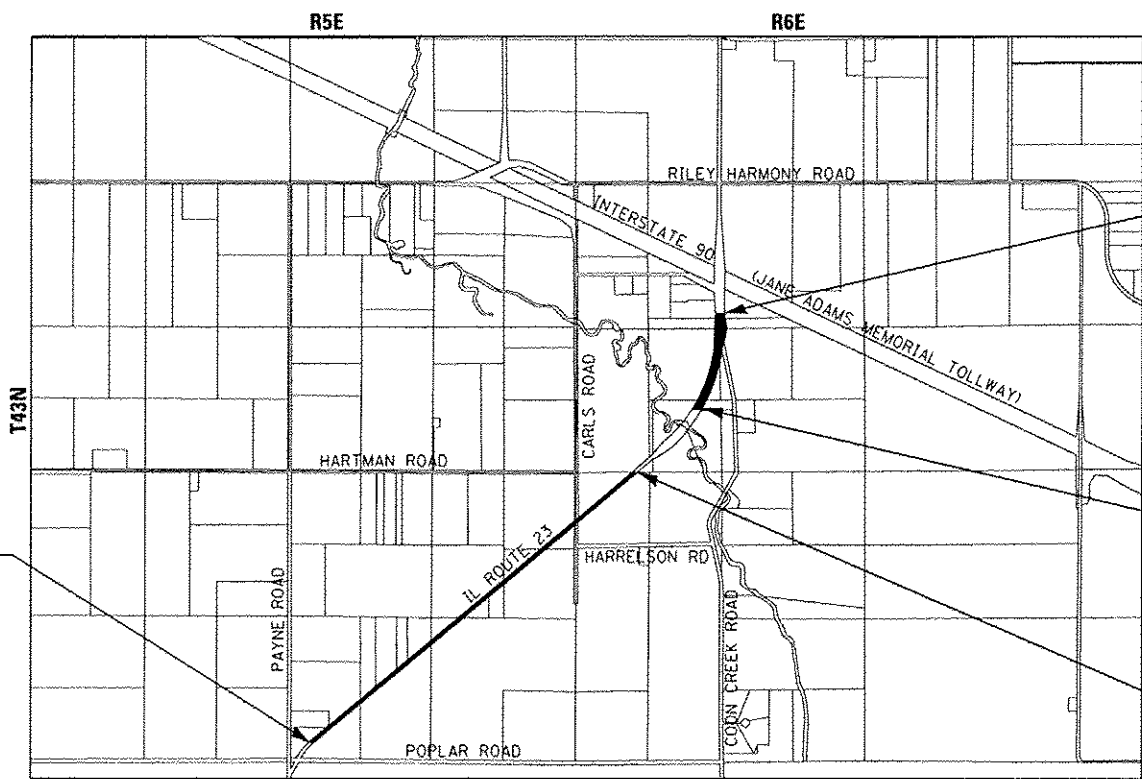

PROJECT ENDS
STA 221 + 75

OMISSION ENDS
STA 203 + 55

OMISSION BEGINS
STA 188 + 00

SCALE: NTS

RILEY TOWNSHIP
GROSS LENGTH OF IMPROVEMENT = 11,495 LF OR 2.177 MILES
NET LENGTH OF IMPROVEMENT = 9,940 LF OR 1.883 MILES



LOCATION OF SECTION INDICATED THUS: [Symbol]

STATE OF ILLINOIS
DEPARTMENT OF TRANSPORTATION
DIVISION OF HIGHWAYS

SUBMITTED *October 15 2013*
John Furtman
DEPUTY DIRECTOR OF HIGHWAYS, REGION ENGINEER

May 10 2013
John D. Baranelli P.E.
ENGINEER OF DESIGN AND ENVIRONMENT

May 10 2013
Omer Osman P.E.
DIRECTOR OF HIGHWAYS, CHIEF ENGINEER

PRINTED BY THE AUTHORITY
OF THE STATE OF ILLINOIS



CONTACT JULIE AT 811 OR 800-892-0123
WITH THE FOLLOWING:
COUNTY = MCHENRY
CITY-TOWNSHIP = RILEY
SEC. & 1/4 SEC. NO. = 26
48 HOURS (2 working days) BEFORE YOU DIG

DISTRICT ONE -
PROJECT MANAGER: KEN ENG (847) 705-4247 (IDOT)
PROJECT ENGINEER: ROBERT LENZINI (815) 459-1260 (BAXTER & WOODMAN)
CONTRACT NO. 60N34

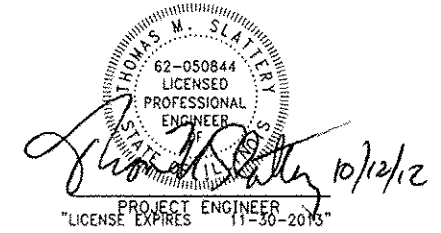

CONSULTING ENGINEER
 STATE OF ILLINOIS
 LICENSE NO. 384-00271 - EXPIRES 4/30/2015
 5/20/2012 10:33:53 AM

INDEX OF SHEETS

SHEET NO.	DESCRIPTION
1	TITLE SHEET
2	INDEX OF SHEETS, HIGHWAY STANDARDS & GENERAL NOTES
3-3A	SUMMARY OF QUANTITIES
4 - 5	EXISTING AND PROPOSED TYPICAL SECTIONS
6 - 10	ROADWAY AND PAVEMENT MARKING PLANS
11	(BD-22) PAVEMENT PATCHING FOR HMA SURFACED PAVEMENT
12	(BD-32) BUTT JOINT AND HMA TAPER DETAILS
13	(TC-10) TRAFFIC CONTROL AND PROTECTION FOR SIDE ROADS, INTERSECTIONS, AND DRIVEWAYS
14	(TC-11) TYPICAL APPLICATIONS RAISED REFLECTIVE PAVEMENT MARKERS (SNOW-PLOW RESISTANT)
15	(TC-13) TYPICAL PAVEMENT MARKINGS
16	(TC-22) ARTERIAL ROAD INFORMATION SIGNING

HIGHWAY STANDARDS

STANDARD NO.	DESCRIPTION
000001 - 00	STANDARD SYMBOLS, ABBREVIATIONS, AND PATTERNS
442201 - 03	CLASS C AND D PATCHES
635006 - 03	REFLECTOR AND TERMINAL MARKER PLACEMENT
701006 - 04	OFF-ROAD OPERATIONS, 2L, 2W, 15' (4.5M) TO 24" (600mm) FROM PAVEMENT EDGE
701011 - 03	OFF-ROAD MOVING OPERATIONS, 2L, 2W, DAY ONLY
701301 - 04	LANE CLOSURE, 2L, 2W, SHORT TIME OPERATIONS
701306 - 03	LANE CLOSURE, 2L, 2W, SLOW MOVING OPERATIONS DAY ONLY, FOR SPEEDS > 45 MPH
701311 - 03	LANE CLOSURE, 2L, 2W MOVING OPERATIONS - DAY ONLY
701336 - 06	LANE CLOSURE, 2L, 2W, WORK AREAS IN SERIES, FOR SPEEDS > 45 MPH
701901 - 02	TRAFFIC CONTROL DEVICES

GENERAL NOTES

- ALL CONSTRUCTION SHALL BE DONE IN ACCORDANCE WITH THE DETAILS IN THE PLANS, THE SPECIAL PROVISIONS INCLUDED IN THE CONTRACT DOCUMENTS, AND THE LATEST EDITION OF THE FOLLOWING STATE OF ILLINOIS SPECIFICATIONS: "THE STANDARD SPECIFICATIONS FOR ROAD AND BRIDGE CONSTRUCTION" (REFERRED TO AS THE "STANDARD SPECIFICATIONS"), THE "SUPPLEMENTAL SPECIFICATIONS AND RECURRING SPECIAL PROVISIONS", THE "MANUAL ON UNIFORM TRAFFIC CONTROL DEVICES FOR STREETS AND HIGHWAYS" AND THE "MANUAL OF TEST PROCEDURES FOR MATERIALS".
- BEFORE STARTING ANY EXCAVATION, THE CONTRACTOR SHALL CALL "J.U.L.I.E." AT (800) 892-0123 FOR FIELD LOCATIONS OF BURIED ELECTRIC, TELEPHONE, AND GAS FACILITIES. 48 HOUR NOTIFICATION REQUIRED.
- THE CONTRACTOR WILL NOT BE ALLOWED TO SET UP A YARD OR FIELD OFFICE ON STATE PROPERTY WITHOUT THE WRITTEN PERMISSION OF THE DEPARTMENT.
- THE CONTRACTOR SHALL COORDINATE ALL CONSTRUCTION ACTIVITIES WITH UTILITY COMPANIES.
- BUTT JOINTS WILL BE INSTALLED AT THE ENDS OF ALL RESURFACING (WHERE RESURFACING MEETS EXISTING PAVEMENT), IN ACCORDANCE WITH THE "BUTT JOINT AND HMA TAPER DETAILS" SHEET INCLUDED IN THE PLANS UNLESS OTHERWISE SPECIFIED.
- WHEN MILLED PAVEMENT IS OPEN TO TRAFFIC, THE MAXIMUM GRADE DIFFERENTIAL BETWEEN PASSES OF THE MILLING MACHINE SHALL NOT EXCEED 1 1/2 INCHES WHERE THE SPEED LIMIT IS 45 MPH OR LESS AND 1 INCH WHERE THE SPEED LIMIT IS GREATER THAN 45 MPH. WITH WRITTEN APPROVAL FROM THE ENGINEER, A MAXIMUM GRADE DIFFERENTIAL OF 3 INCHES MAY BE ALLOWED IF THE EDGE OF MILLING IS SLOPED AT A MINIMUM OF 1:3 (V:H).
- THE ENGINEER SHALL CONTACT DEBBIE HANLON, THE AREA TRAFFIC FIELD ENGINEER, AT (847) 438-2300 A MINIMUM OF TWO (2) WEEKS PRIOR TO INSTALLATION OF PERMANENT PAVEMENT MARKINGS. THE RESIDENT ENGINEER IS RESPONSIBLE FOR RECORDING EXISTING PAVEMENT MARKINGS PRIOR TO HMA SURFACE REMOVAL.
- THE CONTRACTOR SHALL CONTACT THE IDOT TRAFFIC CONTROL SUPERVISOR AT (847) 705-4470 A MINIMUM OF 72 HOURS IN ADVANCE OF BEGINNING WORK.
- ALL PAVEMENT PATCHING LOCATIONS WILL BE DETERMINED IN THE FIELD BY THE ENGINEER.
- DOUBLE LANE MARKERS ARE TO BE USED AS SHOWN ON THE DISTRICT ONE DETAIL "TYPICAL APPLICATIONS - RAISED REFLECTIVE MARKERS (SNOW-PLOW RESISTANT)" SHOWN IN THE PLANS.
- BEFORE BEGINNING WORK, THE CONTRACTOR SHALL RETAIN AND RECORD FOR FUTURE REFERENCE, ALL EXISTING PAVEMENT MARKING LINES AND RAISED REFLECTIVE PAVEMENT MARKERS IN ORDER THAT THESE LOCATIONS CAN BE RE-ESTABLISHED FOR STRIPING. EXACT LOCATIONS OF ALL PAVEMENT MARKINGS SHALL BE AS DIRECTED BY THE ENGINEER.
- THE CONTRACTOR SHALL BE RESPONSIBLE FOR VERIFYING ALL DIMENSIONS AND CONDITIONS EXISTING IN THE FIELD PRIOR TO CONSTRUCTION AND ORDERING MATERIALS.
- THE CONTRACTOR SHALL BE REQUIRED TO PROVIDE ACCESS TO ABUTTING PROPERTY AT ALL TIMES DURING THE CONSTRUCTION OF THIS PROJECT.
- WHEN CONSTRUCTION OPERATIONS ON TWO-LANE ROADS OPEN TO TRAFFIC RESULT IN THE REMOVAL OR COVERING OF ANY PAVEMENT MARKING INDICATING PASSING RESTRICTIONS, "NO PASSING ZONES STRIPED NEXT ---- MILES" SIGNS SHALL BE USED. THE CONTRACTOR SHALL PLACE THE SIGNS AT THE BEGINNING OF THE UNSTRIPED AREA, JUST BEYOND EACH MAJOR INTERSECTION WITHIN THE UNSTRIPED AREA, AND AT SUCH LOCATIONS AS THE ENGINEER MAY DIRECT TO ENSURE A MINIMUM SPACING OF FIVE MILES.

COMMITMENTS

THE ENGINEER SHALL CONTACT MR. DAVID DIAMOND, RILEY TOWNSHIP HIGHWAY COMMISSIONER, AT 815-568-6221 TWO WEEKS PRIOR TO THE START OF CONSTRUCTION.

CONTRACT NO. 60N34 - 2
 DATE: 12/12/10
 PROJECT: ILLINOIS ROUTE 23
 DRAWN BY: BCD
 CHECKED BY: RWL
 DATE: 12-12-10
 FILE: 100153-W015-GEN-NOTE.sht



DESIGNED - TMS	REVISED -
DRAWN - BCD	REVISED -
CHECKED - RWL	REVISED -
DATE - 12-12-10	FILE - 100153-W015-GEN-NOTE.sht

STATE OF ILLINOIS
DEPARTMENT OF TRANSPORTATION

ILLINOIS ROUTE 23
POPLAR ROAD TO INTERSTATE 90
INDEX OF SHEETS, HIGHWAY STANDARDS AND GENERAL NOTES
SCALE: NONE STA. TO STA.

F.A.P. RTE. 324	SECTION 24-RS-4	COUNTY McHENRY	TOTAL SHEETS 16	SHEET NO. 2
FED. ROAD DIST. NO. 1 ILLINOIS FED. AID PROJECT			CONTRACT NO. 60N34	

100% STATE

SUMMARY OF QUANTITIES			URBAN		CONSTRUCTION TYPE CODE	
CODE NO.	ITEM DESCRIPTION	UNIT	TOTAL QUANTITY	0005 QUANTITY		
40600200	BITUMINOUS MATERIALS (PRIME COAT)	TON	23	23		
40600300	AGGREGATE (PRIME COAT)	TON	177	177		
40600400	MIXTURE FOR CRACKS, JOINTS, AND FLANGWAYS	TON	3	3		
40600827	POLYMERIZED LEVELING BINDER (MACHINE METHOD), IL-4.75, N50	TON	1,249	1,249		
40600895	CONSTRUCTING TEST STRIP	EACH	2	2		
40600982	HOT-MIX ASPHALT SURFACE REMOVAL - BUTT JOINT	SQ YD	90	90		
40601005	HOT-MIX ASPHALT REPLACEMENT OVER PATCHES	TON	245	245		
40603340	HOT-MIX ASPHALT SURFACE COURSE, MIX "D", N70	TON	2,542	2,542		
44000158	HOT-MIX ASPHALT SURFACE REMOVAL, 2 1/4"	SQ YD	29,465	29,465		
44002212	HOT-MIX ASPHALT REMOVAL OVER PATCHES, 3"	SQ YD	1,415	1,415		
44201761	CLASS D PATCHES, TYPE I, 10 INCH	SQ YD	100	100		
44201765	CLASS D PATCHES, TYPE II, 10 INCH	SQ YD	650	650		
44201769	CLASS D PATCHES, TYPE III, 10 INCH	SQ YD	100	100		
44201771	CLASS D PATCHES, TYPE IV, 10 INCH	SQ YD	350	350		
48102100	AGGREGATE WEDGE SHOULDER, TYPE B	TON	1,485	1,485		

* INDICATES SPECIALTY ITEM

100% STATE

SUMMARY OF QUANTITIES			URBAN		CONSTRUCTION TYPE CODE	
CODE NO.	ITEM DESCRIPTION	UNIT	TOTAL QUANTITY	0005 QUANTITY		
63100167	TRAFFIC BARRIER TERMINAL, TYPE 1 (SPECIAL) TANGENT	EACH	7	7		
67000400	ENGINEER'S FIELD OFFICE, TYPE A	CAL MO	3	3		
67100100	MOBILIZATION	LSUM	1	1		
70100460	TRAFFIC CONTROL AND PROTECTION, STANDARD 701306	LSUM	1	1		
70100600	TRAFFIC CONTROL AND PROTECTION, STANDARD 701336	LSUM	1	1		
70300100	SHORT-TERM PAVEMENT MARKING	FOOT	5,403	5,403		
70300220	TEMPORARY PAVEMENT MARKING - LINE 4"	FOOT	61,406	61,406		
70300280	TEMPORARY PAVEMENT MARKING - LINE 24"	FOOT	96	96		
70301000	WORK ZONE PAVEMENT MARKING REMOVAL	SQ FT	601	601		
78000200	THERMOPLASTIC PAVEMENT MARKING - LINE 4"	FOOT	30,703	30,703		
78000650	THERMOPLASTIC PAVEMENT MARKING - LINE 24"	FOOT	48	48		
78100100	RAISED REFLECTIVE PAVEMENT MARKER	EACH	248	248		
78201000	TERMINAL MARKER - DIRECT APPLIED	EACH	7	7		
78300200	RAISED REFLECTIVE PAVEMENT MARKER REMOVAL	EACH	248	248		
Z0018500	DRAINAGE STRUCTURES TO BE CLEANED	EACH	1	1		

* INDICATES SPECIALTY ITEM

COPYRIGHT © 2005 BY BAXTER & WOODMAN, INC.
 ALL RIGHTS RESERVED. ILLINOIS ROUTE 23, POPLAR ROAD TO INTERSTATE 90, SUMMARY OF QUANTITIES, SHEET NO. 3 OF 3.
 PROJECT NO. 24-RS-4, COUNTY OF MCHENRY, ILLINOIS.
 DRAWN BY: BCC, CHECKED BY: RWL, DATE: 12-12-10.
 FILE: 100153-W015-500.sht



DESIGNED - TMS	REVISED -
DRAWN - BCC	REVISED -
CHECKED - RWL	REVISED -
DATE - 12-12-10	FILE - 100153-W015-500.sht

STATE OF ILLINOIS
DEPARTMENT OF TRANSPORTATION

ILLINOIS ROUTE 23
POPLAR ROAD TO INTERSTATE 90
SUMMARY OF QUANTITIES

F.A.P. RTE. 324	SECTION 24-RS-4	COUNTY MCHENRY	TOTAL SHEETS 16	SHEET NO. 3
SCALE: NONE			CONTRACT NO. 60N34	
FED. ROAD DIST. NO. 1 ILLINOIS FED. AID PROJECT				

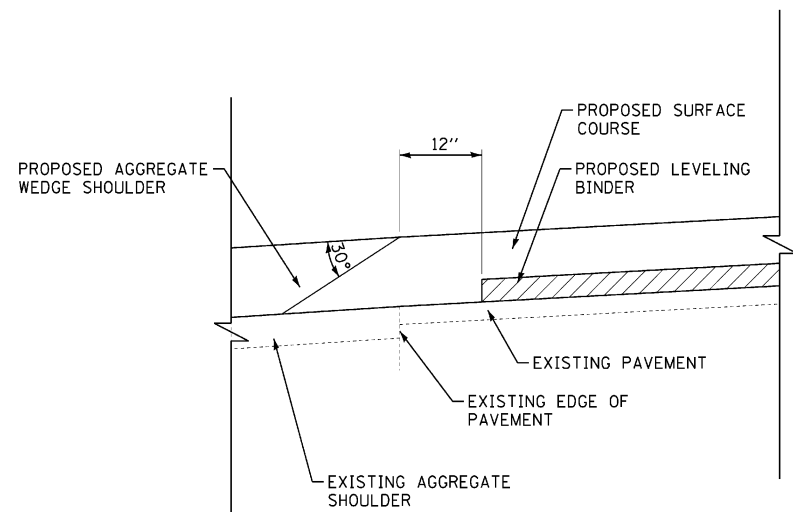

SAFETY EDGE DETAIL

(APPLIES TO LOCATIONS WITH LESS THAN 3' OF PAVED SHOULDER)

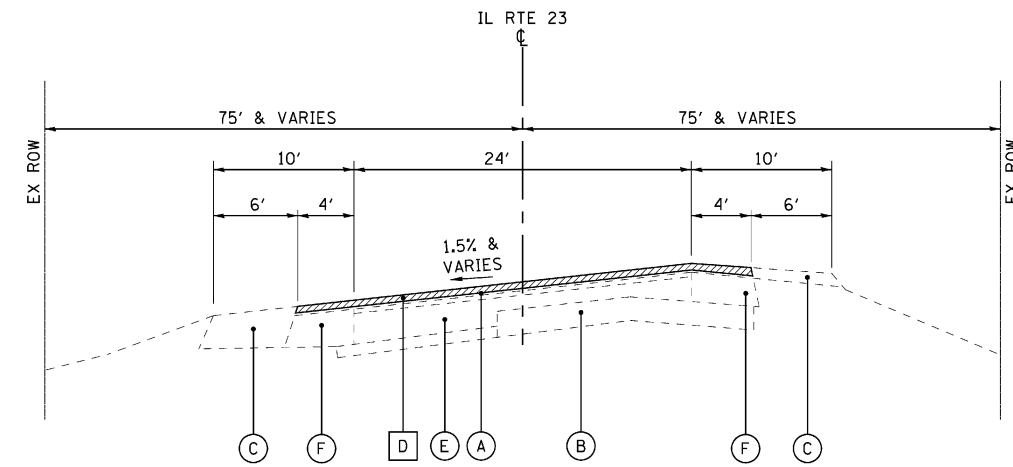

**EXISTING TYPICAL SECTION
IL ROUTE 23
STA 203+55 TO STA 221+75**

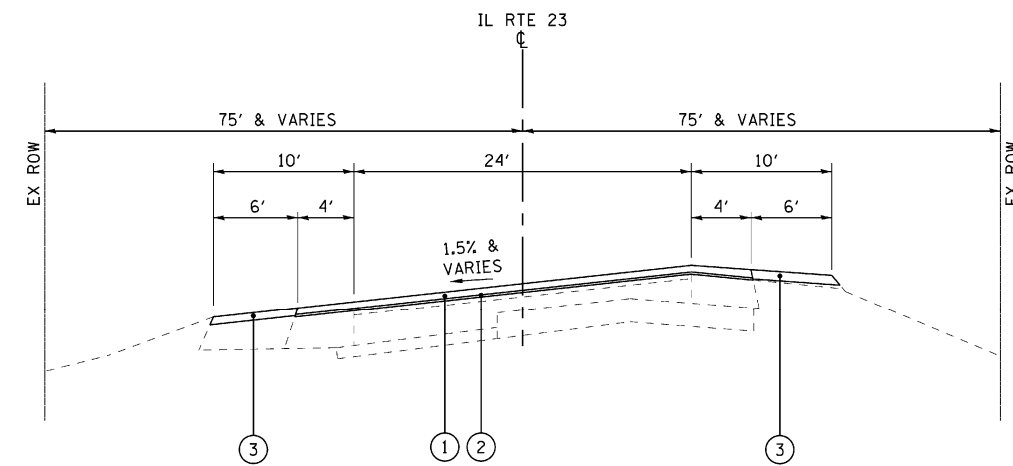

**PROPOSED TYPICAL SECTION
IL ROUTE 23
STA 203+55 TO STA 221+75**

LEGEND

- (A) EXISTING HMA SURFACE, 3"±
- (B) EXISTING PCC BASE, 10"±
- (C) EXISTING AGGREGATE SHOULDER, 6"±
- (D) HOT-MIX ASPHALT SURFACE REMOVAL, 3"
- (E) EXISTING HOT-MIX ASPHALT BASE COURSE, 10" ±
- (F) EXISTING PAVED SHOULDERS
- (G) EXISTING COMBINATION CONCRETE CURB AND GUTTER, TYPE B-6.24
- [Hatched Box] ITEM TO BE REMOVED
- (1) HOT-MIX ASPHALT SURFACE COURSE, MIX "D", N70 (IL-9.5mm) - 2"
- (2) POLYMERIZED LEVELING BINDER (MACHINE METHOD), IL-4.75, N50 - 1"
- (3) GRADING AND SHAPING SHOULDERS AND AGGREGATE WEDGE SHOULDER, TYPE B
- (SE) SAFETY EDGE (SEE DETAIL) - REQUIRED ON ALL LOCATIONS WITH LESS THAN 3' OF PAVED SHOULDER

COPYRIGHT © 2010 BY BAXTER & WOODMAN, INC. ...
 LICENSE NO. 185-002123-EXPRES 4/20/2011
 5/6/09r



DESIGNED - TMS	REVISED -
DRAWN - BCD	REVISED -
CHECKED - RWL	REVISED -
DATE - 12-12-10	FILE - 100153-w015-TypSec.sht

**STATE OF ILLINOIS
DEPARTMENT OF TRANSPORTATION**

**ILLINOIS ROUTE 23
POPLAR ROAD TO INTERSTATE 90
TYPICAL SECTIONS**

SCALE: NONE STA. TO STA.

F.A.P. RTE.	SECTION	COUNTY	TOTAL SHEETS	SHEET NO.
324	24-RS-4	McHENRY	16	5
FED. ROAD DIST. NO. 1 ILLINOIS FED. AID PROJECT				

CONTRACT NO. 60N34

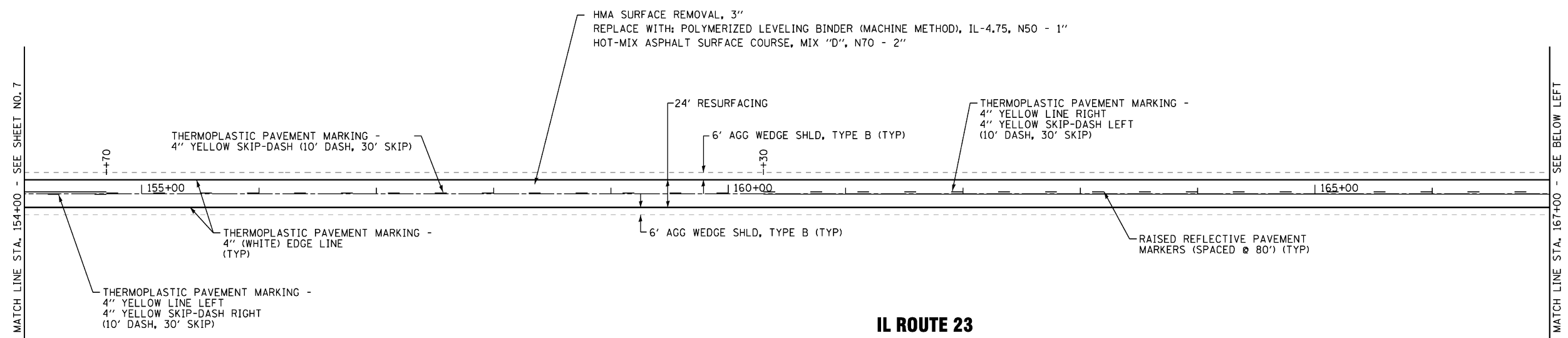
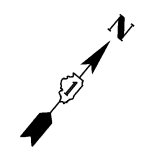

IL ROUTE 23

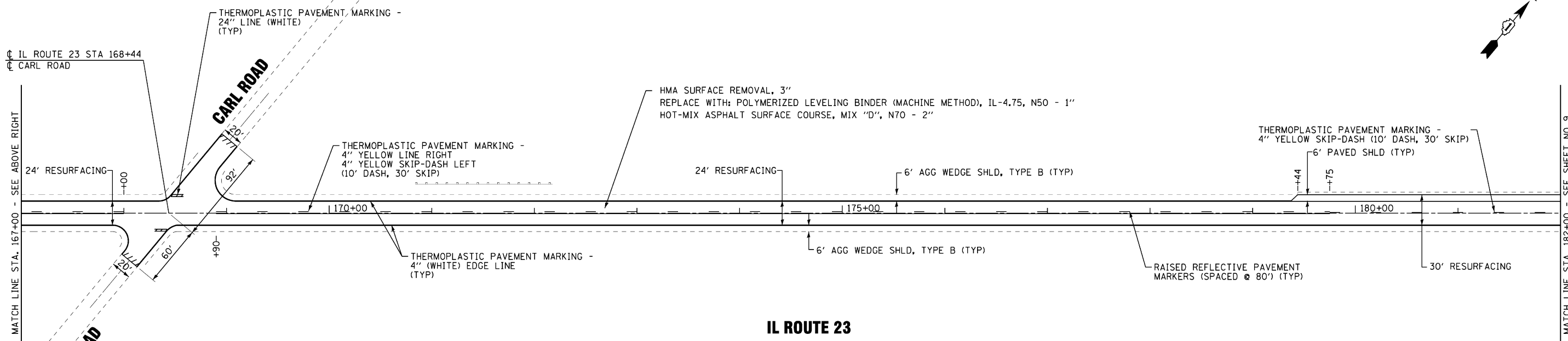

IL ROUTE 23

- NOTE:
1. ALL PAVEMENT PATCHING LOCATIONS WILL BE DETERMINED BY THE RESIDENT ENGINEER.
 2. REFER TO DISTRICT 1 TYPICAL PAVEMENT MARKINGS (TC-13) FOR ADDITIONAL INFORMATION.
 3. REFER TO DISTRICT 1 RAISED REFLECTIVE PAVEMENT MARKERS (TC-11) FOR ADDITIONAL INFORMATION.

COPYRIGHT © 2010 BY BAXTER & WOODMAN, INC. ...
 LICENSE NO. 185-00121 EXP. 12/31/2011
 560600



DESIGNED - TMS	REVISED -
DRAWN - BCD	REVISED -
CHECKED - RWL	REVISED -
DATE - 12-12-10	FILE - 100153-wa15-Plan03.sht

**STATE OF ILLINOIS
DEPARTMENT OF TRANSPORTATION**

**ILLINOIS ROUTE 23
POPLAR ROAD TO INTERSTATE 90
ROADWAY AND PAVEMENT MARKING PLAN**

F.A.P. RTE.	SECTION	COUNTY	TOTAL SHEETS	SHEET NO.
324	24-RS-4	McHENRY	16	8
FED. ROAD DIST. NO. 1 ILLINOIS FED. AID PROJECT			CONTRACT NO. 60N34	

SCALE: 1" = 50' STA. 154+00 TO STA. 182+00

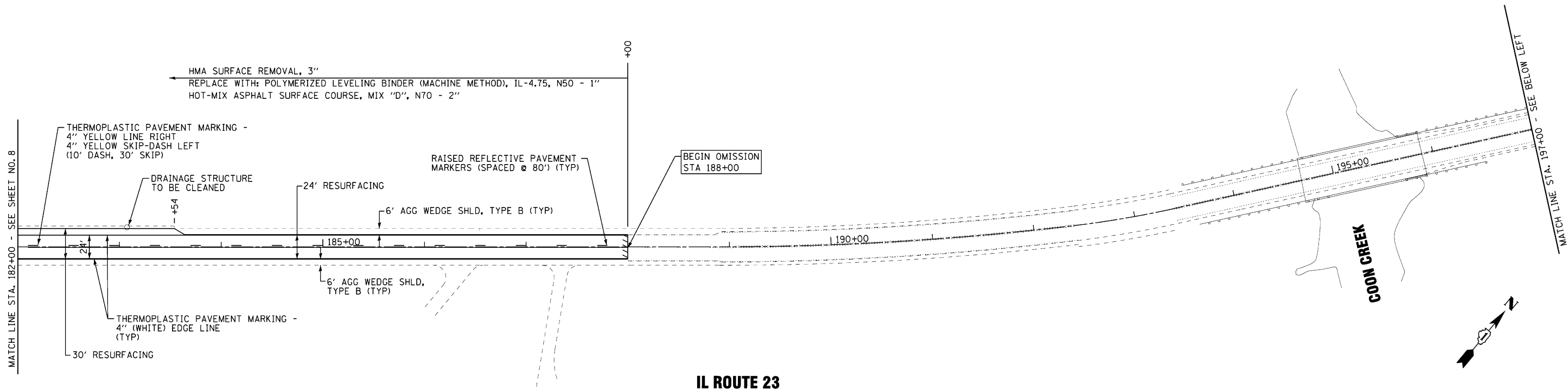

IL ROUTE 23

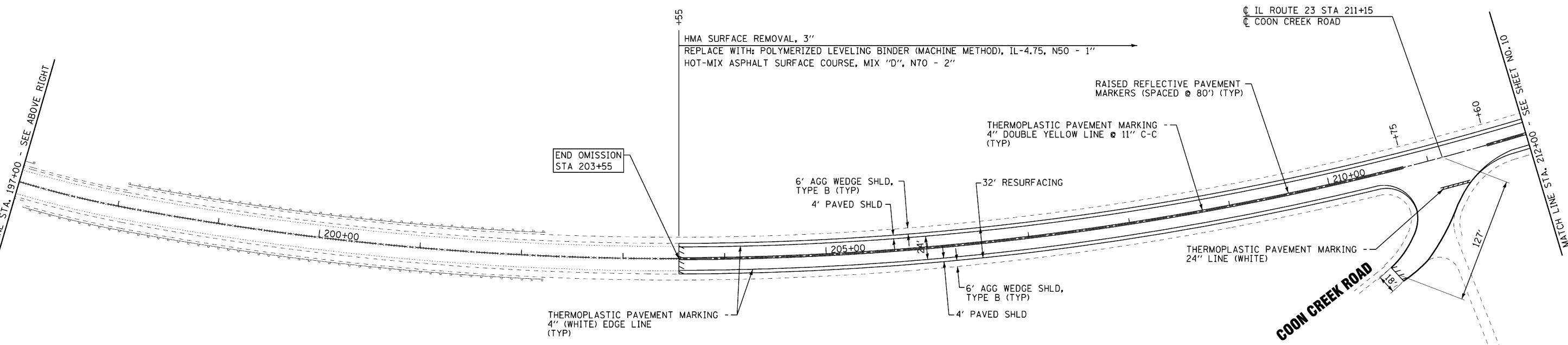

IL ROUTE 23

- NOTE:
1. ALL PAVEMENT PATCHING LOCATIONS WILL BE DETERMINED BY THE RESIDENT ENGINEER.
 2. REFER TO DISTRICT 1 TYPICAL PAVEMENT MARKINGS (TC-13) FOR ADDITIONAL INFORMATION.
 3. REFER TO DISTRICT 1 RAISED REFLECTIVE PAVEMENT MARKERS (TC-11) FOR ADDITIONAL INFORMATION.

COPYRIGHT © 2010 BY BAXTER & WOODMAN, INC.
 ALL RIGHTS RESERVED. NO PART OF THIS DRAWING IS TO BE REPRODUCED OR TRANSMITTED IN ANY FORM OR BY ANY MEANS, ELECTRONIC OR MECHANICAL, INCLUDING PHOTOCOPYING, RECORDING, OR BY ANY INFORMATION STORAGE AND RETRIEVAL SYSTEM.
 LICENSE NO. 185-001237-EXPRES 4/23/2011
 5606040



DESIGNED - TMS	REVISED -
DRAWN - BCD	REVISED -
CHECKED - RWL	REVISED -
DATE - 12-12-10	FILE - 100153-wa15-Plan04.sht

**STATE OF ILLINOIS
DEPARTMENT OF TRANSPORTATION**

**ILLINOIS ROUTE 23
POPLAR ROAD TO INTERSTATE 90
ROADWAY AND PAVEMENT MARKING PLAN**

SCALE: 1" = 50' STA. 182+00 TO STA. 212+00

F.A.P. RTE.	SECTION	COUNTY	TOTAL SHEETS	SHEET NO.
324	24-RS-4	McHENRY	16	9
FED. ROAD DIST. NO. 1 ILLINOIS FED. AID PROJECT			CONTRACT NO. 60N34	

MATCH LINE STA. 212+00 - SEE SHEET NO. 9

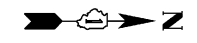
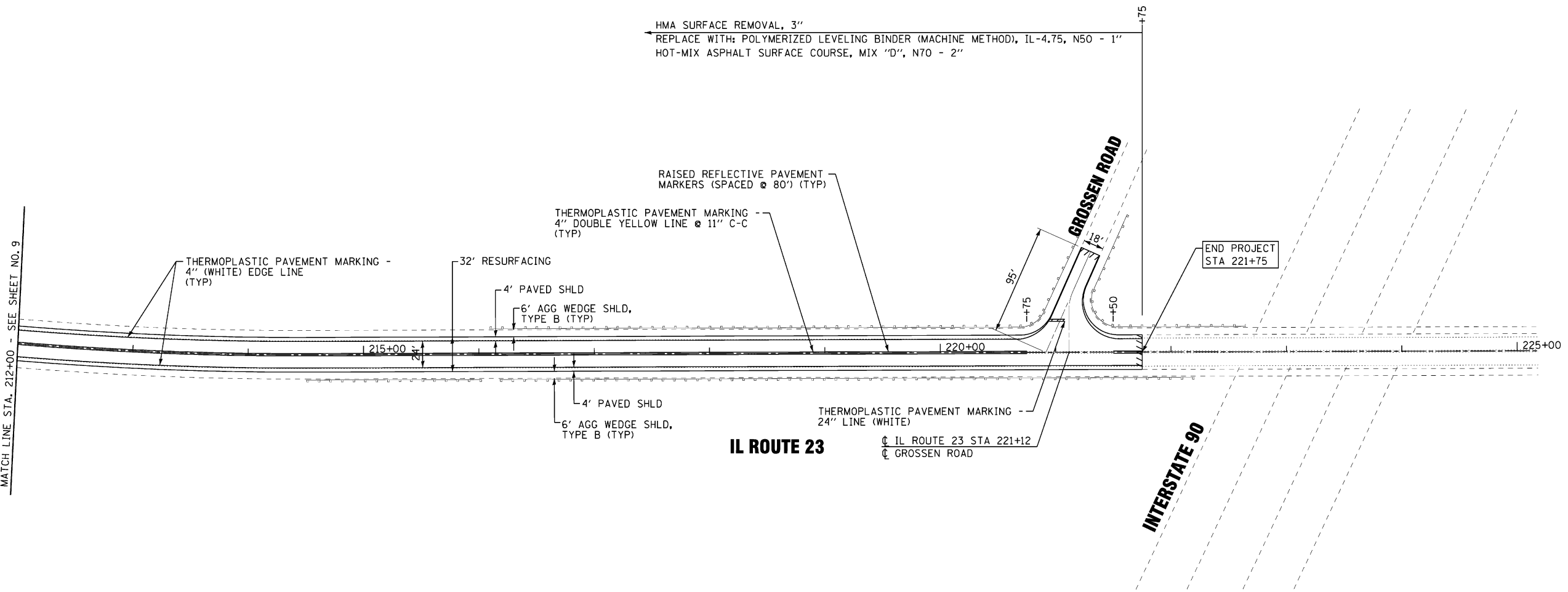

IL ROUTE 23

INTERSTATE 90

GROSSEN ROAD

END PROJECT
STA 221+75

HMA SURFACE REMOVAL, 3"
REPLACE WITH: POLYMERIZED LEVELING BINDER (MACHINE METHOD), IL-4.75, N50 - 1"
HOT-MIX ASPHALT SURFACE COURSE, MIX "D", N70 - 2"

RAISED REFLECTIVE PAVEMENT MARKERS (SPACED @ 80') (TYP)

THERMOPLASTIC PAVEMENT MARKING - 4" DOUBLE YELLOW LINE @ 11" C-C (TYP)

THERMOPLASTIC PAVEMENT MARKING - 4" (WHITE) EDGE LINE (TYP)

32' RESURFACING

4' PAVED SHLD

6' AGG WEDGE SHLD, TYPE B (TYP)

4' PAVED SHLD
6' AGG WEDGE SHLD, TYPE B (TYP)

THERMOPLASTIC PAVEMENT MARKING - 24" LINE (WHITE)
CL IL ROUTE 23 STA 221+12
CL GROSSEN ROAD

- NOTE:
1. ALL PAVEMENT PATCHING LOCATIONS WILL BE DETERMINED BY THE RESIDENT ENGINEER.
 2. REFER TO DISTRICT 1 TYPICAL PAVEMENT MARKINGS (TC-13) FOR ADDITIONAL INFORMATION.
 3. REFER TO DISTRICT 1 RAISED REFLECTIVE PAVEMENT MARKERS (TC-11) FOR ADDITIONAL INFORMATION.

COPYRIGHT © 2010 BY BAXTER & WOODMAN, INC.
 ALL RIGHTS RESERVED. NO PART OF THIS DOCUMENT IS TO BE REPRODUCED OR TRANSMITTED IN ANY FORM OR BY ANY MEANS, ELECTRONIC OR MECHANICAL, INCLUDING PHOTOCOPYING, RECORDING, OR BY ANY INFORMATION STORAGE AND RETRIEVAL SYSTEM.
 LICENSE NO. 185-00123 EXP. 12/31/2011
 560600
 10/18/2010



DESIGNED - TMS	REVISED -
DRAWN - BCD	REVISED -
CHECKED - RWL	REVISED -
DATE - 12-12-10	FILE - 100153-wa15-Plan05.sht

**STATE OF ILLINOIS
DEPARTMENT OF TRANSPORTATION**

**ILLINOIS ROUTE 23
POPLAR ROAD TO INTERSTATE 90
ROADWAY AND PAVEMENT MARKING PLAN**

SCALE: 1" = 50' STA. 212+00 TO STA. 225+00

F.A.P. RTE.	SECTION	COUNTY	TOTAL SHEETS	SHEET NO.
324	24-RS-4	McHENRY	16	10
FED. ROAD DIST. NO. 1 ILLINOIS FED. AID PROJECT			CONTRACT NO. 60N34	

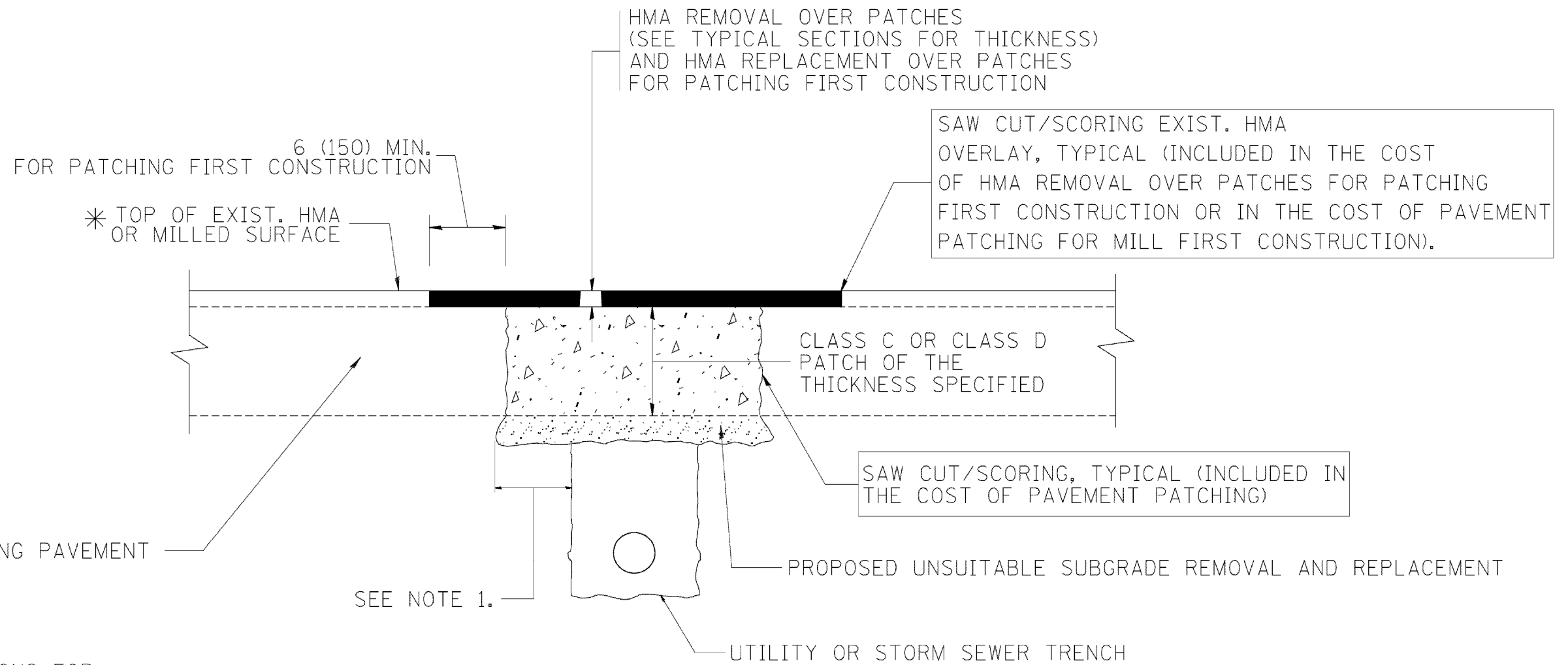

* SEE TYPICAL SECTIONS FOR
THICKNESS AND MATERIALS

NOTES:

1. THE WIDTH OF THE FULL DEPTH PATCH OVER A TRENCH SHALL BE 12 (300) WIDER ON EACH SIDE OF THE TRENCH.
2. FOR METHOD OF MEASUREMENT AND BASIS OF PAYMENT, SEE RECURRING SPECIAL PROVISION "PATCHING WITH HOT-MIX ASPHALT OVERLAY REMOVAL".

SEQUENCE OF CONSTRUCTION (PATCHING FIRST)

1. REMOVE THE EXISTING HMA MATERIAL OVER THE AREA TO BE PATCHED.
2. REMOVE AND REPLACE WITH CLASS C OR D PATCH.
3. REPLACE HMA MATERIAL OVER THE AREA TO BE PATCHED.

SEQUENCE OF CONSTRUCTION (MILLING FIRST)

1. MILL HMA FIRST IF THERE IS AT LEAST 4 1/2 INCHES OR MORE OF HMA MATERIAL ON TOP OF THE EXISTING PAVEMENT OR IF THE PAVEMENT IS FULL DEPTH HMA. A MINIMUM OF 2 INCHES OF HMA MATERIAL SHALL BE IN PLACE AFTER MILLING.
2. REMOVE AND REPLACE WITH FULL DEPTH CLASS D PATCHES TO TOP OF MILLED SURFACE.

ALL DIMENSIONS ARE IN INCHES (MILLIMETERS) UNLESS OTHERWISE SHOWN.

COPYRIGHT © 2011 BY BAXTER & WOODMAN, INC. ALL RIGHTS RESERVED. ILLINOIS LICENSE NO. 187-000227-EXP-RES. 4/20/2013
 FILE NAME = c:\projects\diststd22x34\ba22.dgn
 USER NAME = bauerdl
 PLOT SCALE = 50.0000' / IN.
 PLOT DATE = 10/27/2008
 DESIGNED - R. SHAH
 DRAWN -
 CHECKED -
 DATE - 10-25-94
 REVISED - A. ABBAS 04-27-98
 REVISED - R. BORO 01-01-07
 REVISED - R. BORO 09-04-07
 REVISED - K. ENG 10-27-08

STATE OF ILLINOIS DEPARTMENT OF TRANSPORTATION		PAVEMENT PATCHING FOR HMA SURFACED PAVEMENT		F.A. RTE.	SECTION	COUNTY	TOTAL SHEETS	SHEET NO.
		SCALE: NONE		324	24-RS-4	McHENRY	16	11
		SHEET NO. 1 OF 1 SHEETS		BD400-04 (BD-22)		CONTRACT NO. 60N34		
		STA. TO STA.		FED. ROAD DIST. NO. 1 ILLINOIS FED. AID PROJECT				

COPYRIGHT © 2011 BY BAXTER & WOODMAN, INC. ALL RIGHTS RESERVED. ILLINOIS PROFESSIONAL ENGINEERING LICENSE NO. 189-000223 EXP. DATE 12/31/2013 566666r
 W:\diststa\22434\tol@dgn
 ...\\pilot\00033-006_PBA.dwg
 ...\\cpr\pba\wood\com\proj\cra\CR-ystrat\cra\ke\l\001\00053-140-006.dwg\WO-15-11RT-23\CADD-SURVEY\DRAWINGS\JOINS\00053-W05-D1-T.C.dgn

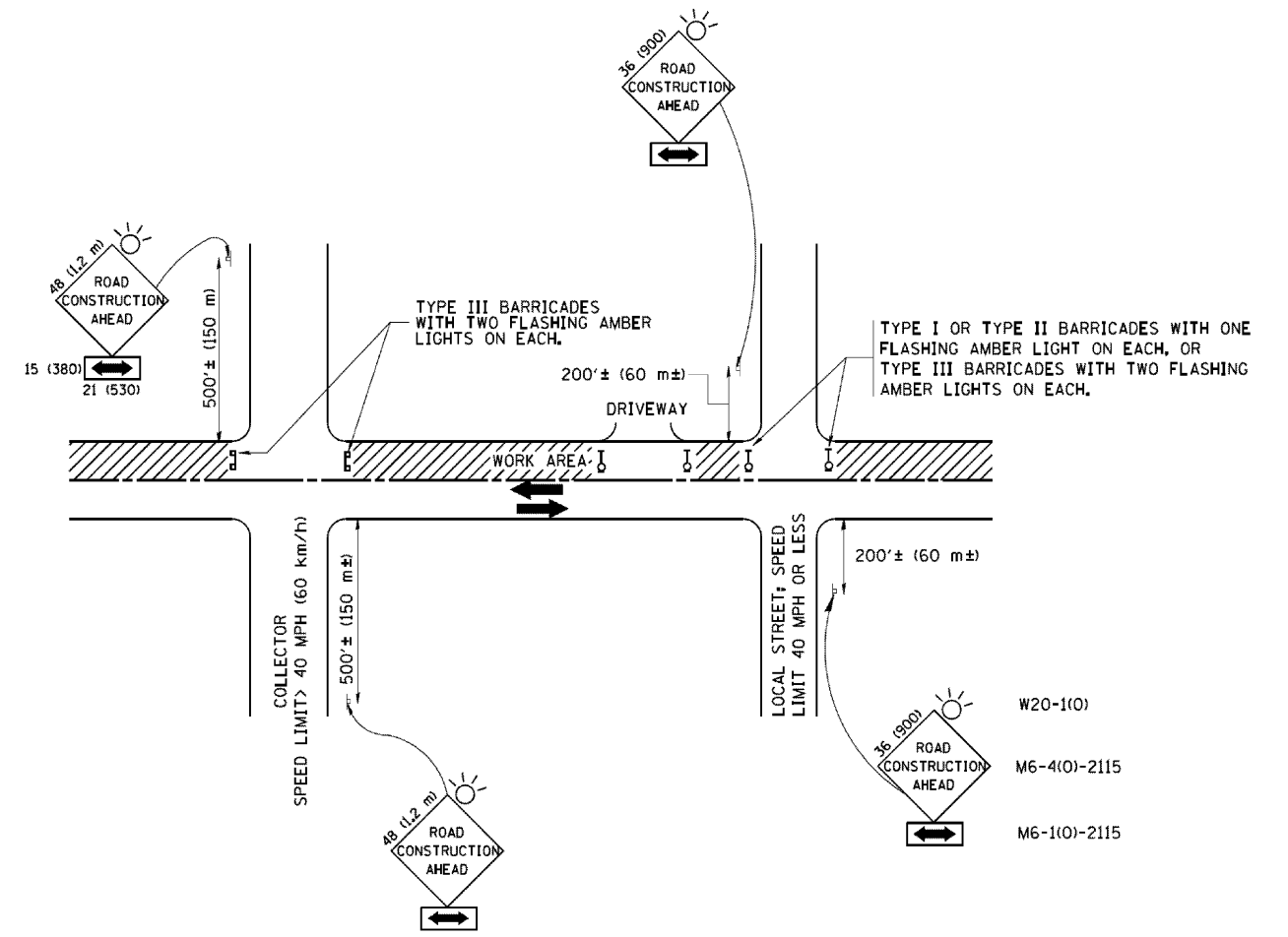

TRAFFIC CONTROL AND PROTECTION FOR SIDE ROADS, INTERSECTIONS, AND DRIVEWAYS

NOTES:

- A. FOR NO LANE RESTRICTION ON THE SIDE ROAD OR DRIVEWAYS
 1. SIDE ROAD WITH A SPEED LIMIT OF 40 MPH (60 km/h) OR LESS AS SHOWN ON THE DRAWING AND AS DIRECTED BY THE ENGINEER:
 - a) ONE ROAD CONSTRUCTION AHEAD SIGN 36 x 36 (900x900) WITH A FLASHER AND FLAG MOUNTED ON IT APPROXIMATELY 200' (60 m) IN ADVANCE OF THE MAIN ROUTE.
 - b) THE CLOSED PORTION OF THE MAIN ROUTE SHALL BE PROTECTED BY BLOCKING WITH TYPE I, TYPE II OR TYPE III BARRICADES, 1/3 OF THE CROSS SECTION OF THE CLOSED PORTION.
 2. SIDE ROAD WITH A SPEED LIMIT GREATER THAN 40 MPH (60 km/h) AS SHOWN ON THE DRAWING AND AS DIRECTED BY THE ENGINEER:
 - a) ONE ROAD CONSTRUCTION AHEAD SIGN 48 x 48 (1,2 m x 1,2 m) WITH A FLASHER MOUNTED ON IT APPROXIMATELY 500' (150 m) IN ADVANCE OF THE MAIN ROUTE.
 - b) THE CLOSED PORTION OF THE MAIN ROUTE SHALL BE PROTECTED BY BLOCKING WITH TYPE III BARRICADES, 1/2 OF THE CROSS SECTION OF THE CLOSED PORTION.
 3. WHEN THE SIDE ROAD LIES BETWEEN THE BEGINNING OF THE MAINLINE SIGNING AND THE WORK ZONE, A SINGLE HEADED ARROW (M6-1) SHALL BE USED IN LIEU OF THE DOUBLE HEADED ARROW (M6-4).
- B. FOR A LANE CLOSURE ON A SIDE ROAD OR DRIVEWAY:

USE APPLICABLE PORTIONS OF THE TYPICAL APPLICATION OF TRAFFIC CONTROL DEVICES (STD. 701501, STD. 701606 OR THE APPROPRIATE STANDARD). THE SPACING OF SIGNS AND BARRICADES SHALL BE ADJUSTED FOR FIELD CONDITIONS AS DIRECTED BY THE ENGINEER. THE DIRECTIONAL ARROW SHALL BE COVERED OR REMOVED WHEN NO LONGER CONSISTENT WITH THE SIDE ROAD LANE CLOSURE.
- C. ADVANCE WARNING SIGNS ARE TO BE OMITTED ON DRIVEWAY UNLESS OTHERWISE NOTED.
- D. THE TRAFFIC CONTROL AND PROTECTION FOR SIDE ROADS, INTERSECTIONS, AND DRIVEWAYS SHALL BE INCIDENTAL TO THE COST OF SPECIFIED TRAFFIC CONTROL STANDARDS OR ITEMS.

All dimensions are in millimeters (inches) unless otherwise shown.

FILE NAME = W:\diststa\22434\tol@dgn	USER NAME = geglienobt	DESIGNED - LHA	REVISED - J. OBERLE 10-18-95
	PLOT SCALE = 50.000 ' / IN.	DRAWN -	REVISED - A. HOUSEH 03-06-96
	PLOT DATE = 1/4/2008	CHECKED -	REVISED - A. HOUSEH 10-15-96
		DATE - 06-89	REVISED - T. RAMMACHER 01-06-00

**STATE OF ILLINOIS
DEPARTMENT OF TRANSPORTATION**

TRAFFIC CONTROL AND PROTECTION FOR SIDE ROADS, INTERSECTIONS, AND DRIVEWAYS			
SCALE: NONE	SHEET NO. 1 OF 1 SHEETS	STA.	TO STA.

F.A. RTE.	SECTION	COUNTY	TOTAL SHEETS	SHEET NO.
324	24-RS-4	McHENRY	16	13
TC-10			CONTRACT NO. 60N34	
FED. ROAD DIST. NO. 1 ILLINOIS FED. AID PROJECT				

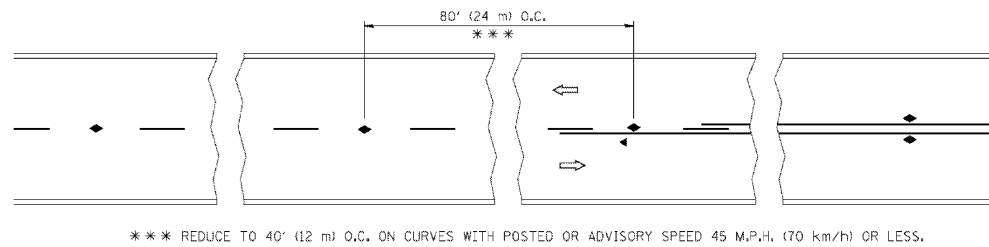

TWO-LANE/TWO-WAY

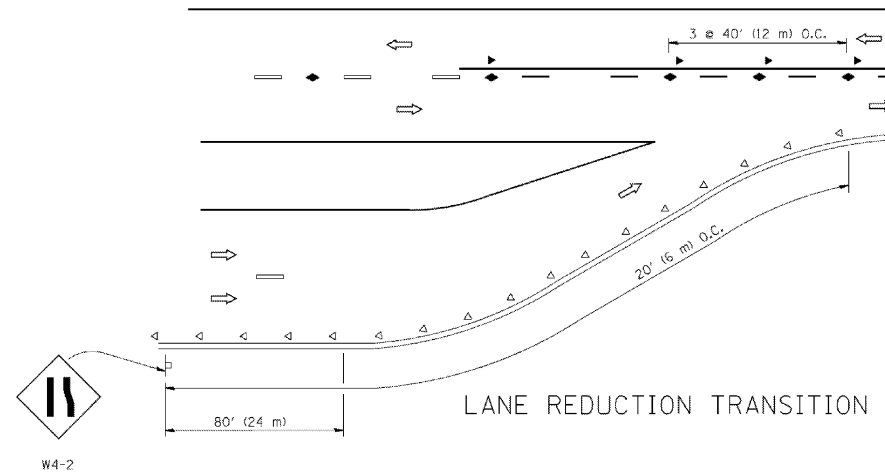

LANE REDUCTION TRANSITION

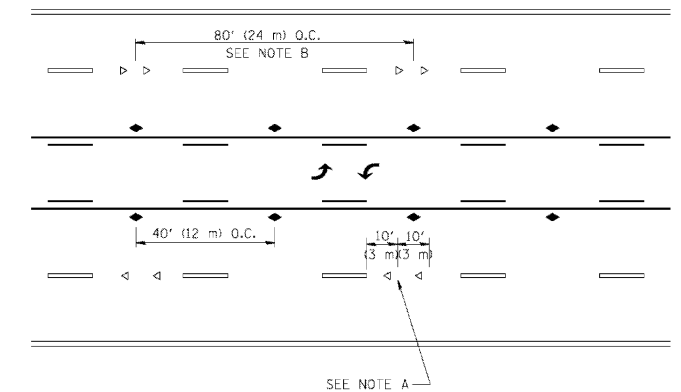

TWO-WAY LEFT TURN

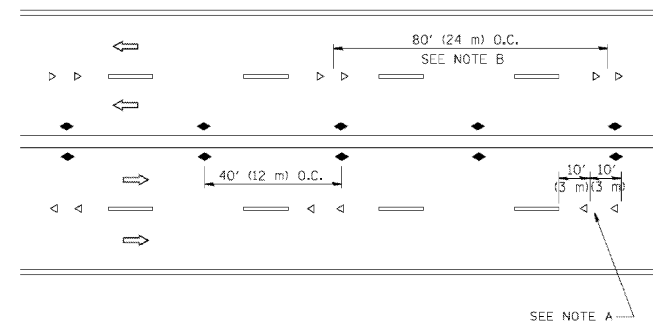

MULTI-LANE/UNDIVIDED

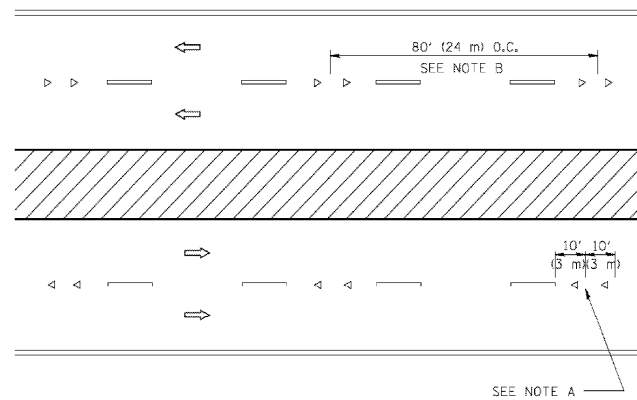

MULTI-LANE/DIVIDED

GENERAL NOTES

1. MARKERS USED WITH DASHED LINES SHALL BE CENTERED IN THE GAP BETWEEN SEGMENTS.
2. MARKERS USED ADJACENT TO SOLID LINES SHALL BE OFFSET 2 TO 3 (50 TO 75) TOWARD TRAFFIC AS SHOWN.
3. MARKERS THROUGH TANGENTS LESS THAN 500' (150 m) IN LENGTH BETWEEN CURVES SHALL BE INSTALLED AT THE LESSER OF THE TWO CURVE SPACINGS.

SYMBOLS

- YELLOW STRIPE
- WHITE STRIPE
- ◀ ONE-WAY AMBER MARKER
- ◁ ONE-WAY CRYSTAL MARKER (W/O)
- ◆ TWO-WAY AMBER MARKER

LANE MARKER NOTES

- A. USE DOUBLE LANE LINE MARKERS SPACED AS SHOWN.
- B. REDUCE TO 40' (12 m) O.C. ON CURVES WHERE ADVISORY SPEEDS ARE 10 M.P.H (20 km/h) LOWER THAN POSTED SPEEDS.

DESIGN NOTES

1. DOUBLE LANE LINE MARKERS SHALL BE USED UNLESS SPECIFIED OTHERWISE.
2. EXCEPT AS SHOWN ON THE LANE REDUCTION TRANSITION AND FREEWAY EXIT RAMP DETAIL, MARKERS ARE NOT TO BE SPECIFIED ON RIGHT EDGE LINES.
3. THE EXACT MARKER LIMITS, SPACING, AND COLOR SHOULD BE INCLUDED IN THE PLANS.
4. MARKERS SHOULD NOT BE USED ALONGSIDE CURBS EXCEPT FOR EXTREMELY SHORT SECTIONS OF CURBS WHERE NOT MORE THAN TWO MARKERS WOULD BE INVOLVED.

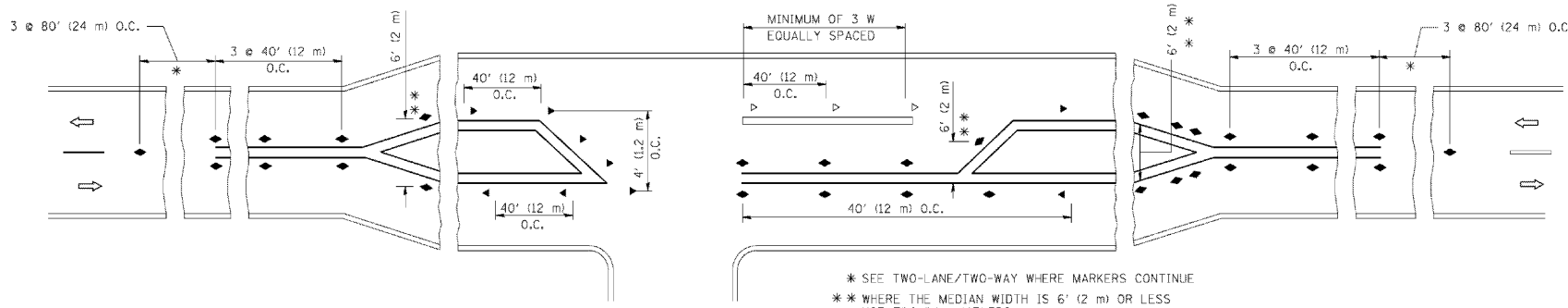

LEFT TURN

All dimensions are in inches (millimeters) unless otherwise shown.

COPYRIGHT © 2011 BY BAXTER & WOODMAN, INC. ALL RIGHTS RESERVED. THIS DRAWING IS THE PROPERTY OF BAXTER & WOODMAN, INC. AND IS NOT TO BE REPRODUCED OR TRANSMITTED IN ANY FORM OR BY ANY MEANS, ELECTRONIC OR MECHANICAL, INCLUDING PHOTOCOPYING, RECORDING, OR BY ANY INFORMATION STORAGE AND RETRIEVAL SYSTEM. WITHOUT PERMISSION IN WRITING FROM BAXTER & WOODMAN, INC.

FILE NAME =	USER NAME = drvakosgn	DESIGNED -	REVISED - T. RAMMACHER 09-19-94
...	...	DRAWN -	REVISED - T. RAMMACHER 03-12-99
...	...	CHECKED -	REVISED - T. RAMMACHER 01-06-00
...	...	DATE -	REVISED - C. JUCIUS 09-09-09

STATE OF ILLINOIS
DEPARTMENT OF TRANSPORTATION

TYPICAL APPLICATIONS				
RAISED REFLECTIVE PAVEMENT MARKERS (SNOW-PLOW RESISTANT)				
F.A. RTE.	SECTION	COUNTY	TOTAL SHEETS	SHEET NO.
324	24-RS-4	McHENRY	16	14
TC-11			CONTRACT NO. 60N34	
SCALE: NONE SHEET NO. 1 OF 1 SHEETS STA. TO STA. FED. ROAD DIST. NO. 1 ILLINOIS FED. AID PROJECT				

COPYRIGHT © 2011 BY BAXTER & WOODMAN, INC. 11/11/11 10:58 AM
 W:\diststa\22x34\to22.dgn
 USER: geglennobt
 PLOT SCALE = 50.000' / IN.
 PLOT DATE = 1/4/2008
 FILE NAME = W:\diststa\22x34\to22.dgn
 USER NAME = geglennobt
 DESIGNED -
 DRAWN -
 CHECKED -
 DATE -
 REVISED - R. MIRS 09-15-97
 REVISED - R. MIRS 12-11-97
 REVISED - T. RAMMACHER 02-02-99
 REVISED - C. JUCLUS 01-31-07
 STATE OF ILLINOIS
 DEPARTMENT OF TRANSPORTATION
 ARTERIAL ROAD
 INFORMATION SIGN
 SCALE: NONE SHEET NO. 1 OF 1 SHEETS STA. TO STA.
 F.A. RTE. 324 SECTION 24-RS-4 COUNTY McHENRY TOTAL SHEETS 16 SHEET NO. 16
 TC-22 CONTRACT NO. 60N34
 FED. ROAD DIST. NO. 1 ILLINOIS FED. AID PROJECT

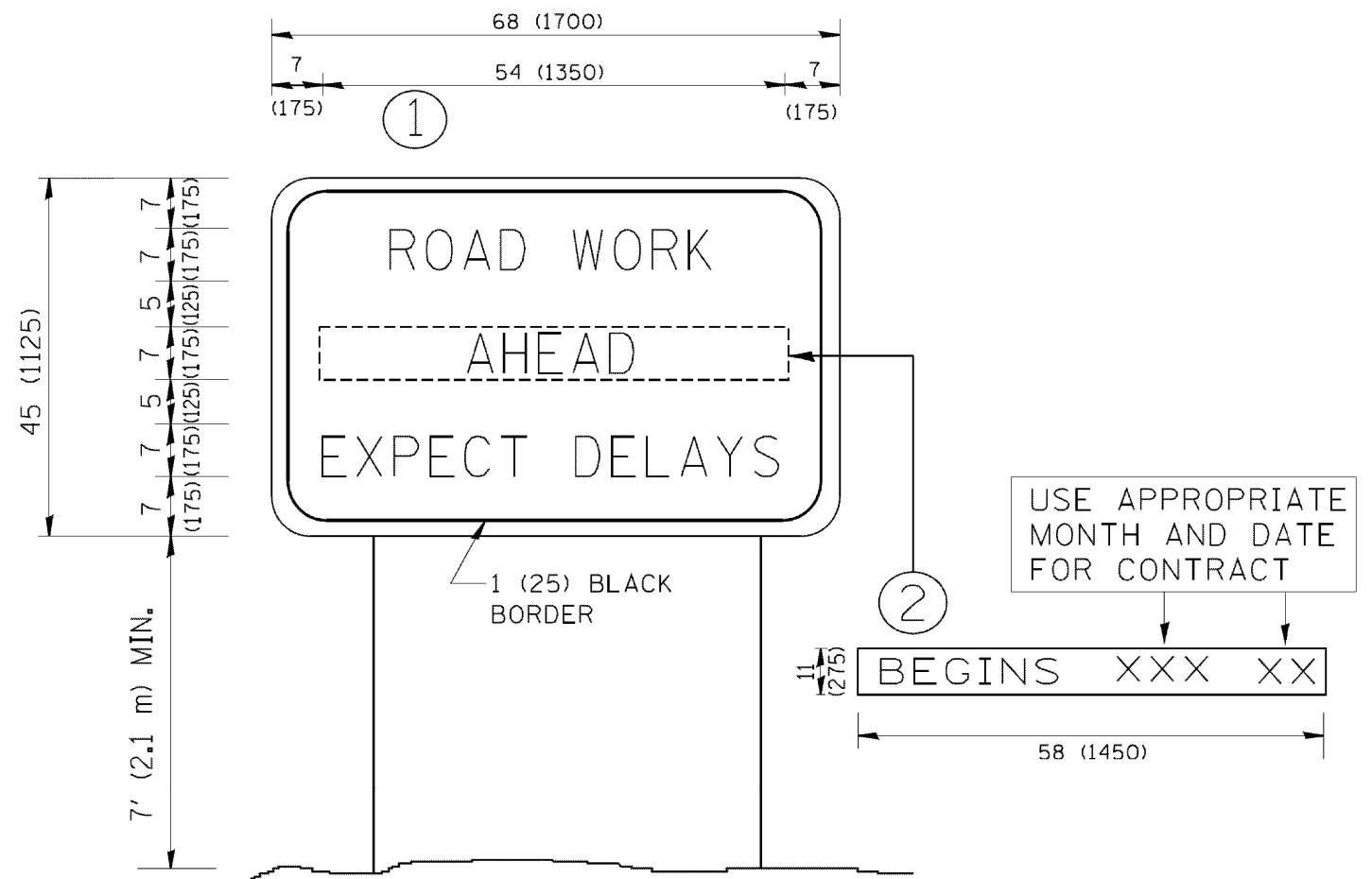

NOTES:

1. USE BLACK LETTERING ON ORANGE BACKGROUND.
2. ERECT SIGNS IN ADVANCE OF THE LOCATION FOR THE "ROAD CONSTRUCTION AHEAD" SIGN AT LOCATIONS AS DIRECTED BY THE ENGINEER.
3. ERECT SIGN ① WITH INSTALLED PANEL ② ONE WEEK PRIOR TO THE START OF CONSTRUCTION.
4. REMOVE PANEL ② SOON AFTER THE START OF CONSTRUCTION.
5. SEE SPECIAL PROVISION FOR "TEMPORARY INFORMATION SIGNING" FOR ADDITIONAL INFORMATION.
6. ONE SIGN ASSEMBLY EQUALS 25.70 SQ. FT. (2.3 SQ. M.)
7. SHALL BE PAID FOR AS TEMPORARY INFORMATION SIGNING.

ALL DIMENSIONS ARE IN INCHES (MILLIMETERS) UNLESS OTHERWISE SHOWN.

FILE NAME = W:\diststa\22x34\to22.dgn	USER NAME = geglennobt	DESIGNED -	REVISED - R. MIRS 09-15-97	STATE OF ILLINOIS DEPARTMENT OF TRANSPORTATION	ARTERIAL ROAD INFORMATION SIGN			F.A. RTE. 324	SECTION 24-RS-4	COUNTY McHENRY	TOTAL SHEETS 16	SHEET NO. 16
	PLOT SCALE = 50.000' / IN.	DRAWN -	REVISED - R. MIRS 12-11-97		SCALE: NONE	SHEET NO. 1 OF 1 SHEETS	STA. TO STA.	TC-22		CONTRACT NO. 60N34		
	PLOT DATE = 1/4/2008	CHECKED -	REVISED - T. RAMMACHER 02-02-99		FED. ROAD DIST. NO. 1 ILLINOIS FED. AID PROJECT							
		DATE -	REVISED - C. JUCLUS 01-31-07									