

**THERMOPLASTIC PAVEMENT MARKING LEGEND**

<p>(A) THERMOPLASTIC PAVEMENT MARKING 4" SOLID WHITE, EDGE LINE (TYPICAL)</p> <p>(B) THERMOPLASTIC PAVEMENT MARKING 6" WHITE SKIP-DASH (2' DASH, 6' SKIP) (TYPICAL)</p> <p>(C) THERMOPLASTIC PAVEMENT MARKING 4" YELLOW, 2 @ 11" C-C (TYPICAL)</p> <p>(D) THERMOPLASTIC PAVEMENT MARKING 6" SOLID WHITE, TURN LANE LINE (TYPICAL)</p>	<p>(E) THERMOPLASTIC PAVEMENT MARKING LETTERS &amp; SYMBOLS, WHITE (TYPICAL)</p> <p>(F) THERMOPLASTIC PAVEMENT MARKING 24" SOLID WHITE, STOP BAR (TYPICAL)</p> <p>(G) THERMOPLASTIC PAVEMENT MARKING 12" SOLID YELLOW DIAGONALS</p> <p>(H) THERMOPLASTIC PAVEMENT MARKING 4" YELLOW SKIP-DASH (10' DASH, 30' SKIP) (TYPICAL)</p> <p>(I) THERMOPLASTIC PAVEMENT MARKING 4" SOLID YELLOW NO PASSING ZONE LINE FOR ONE DIRECTION, 5-1/2" C-C FROM SKIP-DASH CENTERLINE (TYPICAL)</p>
---	---

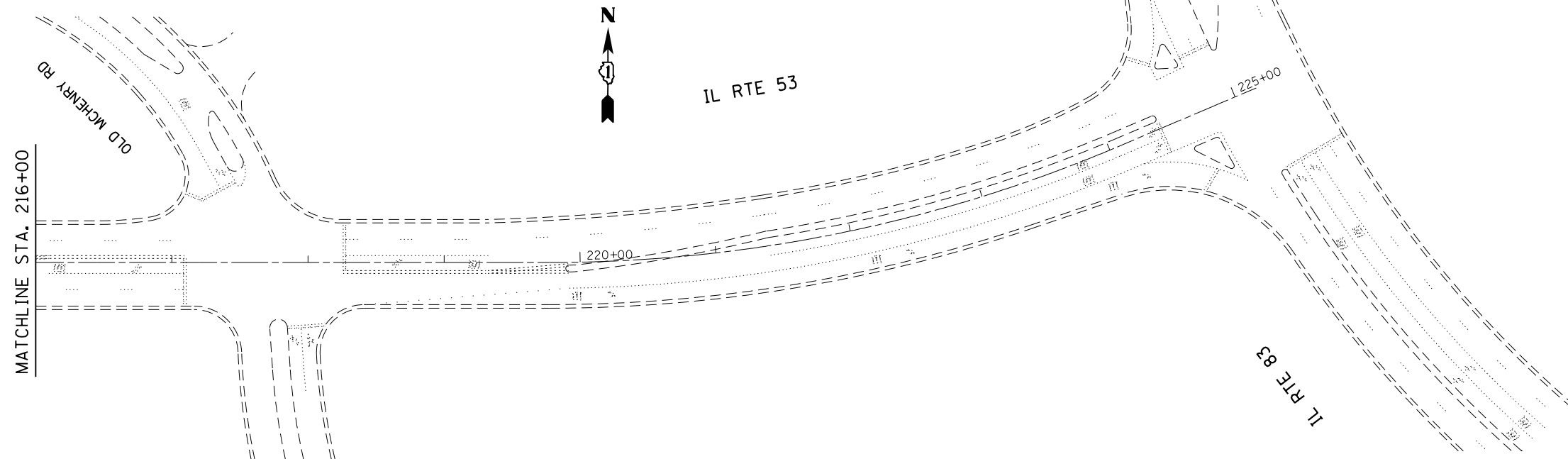

**GENERAL NOTES:**

1) ALL RAISED REFLECTIVE PAVEMENT MARKERS SHALL BE PLACED IN ACCORDANCE WITH DISTRICT ONE "TYPICAL APPLICATIONS RAISED REFLECTIVE PAVEMENT MARKERS (SNOW-PLOW RESISTANT) (TC-11)" STANDARD DETAIL.

2) ALL FINAL PAVEMENT MARKINGS SHALL BE THERMOPLASTIC (OF THE EXTRUDED TYPE) AND SHOULD BE PLACED IN ACCORDANCE WITH "DISTRICT ONE TYPICAL PAVEMENT MARKINGS (TC-13)" STANDARD DETAIL.

FILE NAME = D:\31111-sht-plan.dgn	USER NAME = tar1qfm	DESIGNED -	REVISED -	<b>STATE OF ILLINOIS DEPARTMENT OF TRANSPORTATION</b>	<b>IL 53 (WO LAKE COOK RD. TO OLD MCHENRY RD.) ROADWAY AND PAVEMENT MARKING PLANS</b>	F.A.U. RTE. = 1261	SECTION = 530-RS-5	COUNTY = LAKE	TOTAL SHEETS = 25	SHEET NO. = 13	
PLOT SCALE = 100.0000' / 1" =		CHECKED -	REVISED -			SCALE: 1" = 50'		SHEET NO. OF SHEETS		STA. 202+00.00 TO STA. 225+16.83	
PLOT DATE = 3/27/2013		DATE -	REVISED -			CONTRACT NO. 60N41					
ILLINOIS FED. AID PROJECT											