

**STAGE II CONSTRUCTION:**

1. APPLY PERMANENT PAVEMENT MARKINGS FOR GORE AREAS AND AUXILLARY LANE EDGE LINES UNDER HIGHWAY STANDARD 701426-05. (FROM STA. 29+07 RT. TO STA. 35+35 RT.)
2. CLOSE SOUTHBOUND LANES AND CROSS-OVER IN ACCORDANCE WITH HIGHWAY STANDARDS 701411-08, 701431-08, AND AS SHOWN IN THE PLANS.
3. PERFORM BRIDGE, BRIDGE APPROACH PAVEMENT, DRAINAGE, AND GUARDRAIL RECONSTRUCTION ON SOUTHBOUND LANES (WEST HALF OF BRIDGE) AS SHOWN IN THE PLANS.
4. REMOVE TEMPORARY MEDIAN PAVEMENT AND RECONSTRUCT REMOVED PORTIONS OF RAISED MEDIAN IN ACCORDANCE WITH HIGHWAY STANDARD 701422-05. MEDIAN TO BE RECONSTRUCTED AT DEPTH AND DIMENSIONS AS NOTED DURING PRE-STAGE. MEDIAN RECONSTRUCTION SHALL BE PAID FOR AS "CONCRETE MEDIAN (SPECIAL)".
5. APPLY PERMANENT PAVEMENT MARKINGS AND RAISED REFLECTIVE PAVEMENT MARKERS FOR ALL OTHER LOCATIONS UNDER HIGHWAY STANDARD 701426-04.

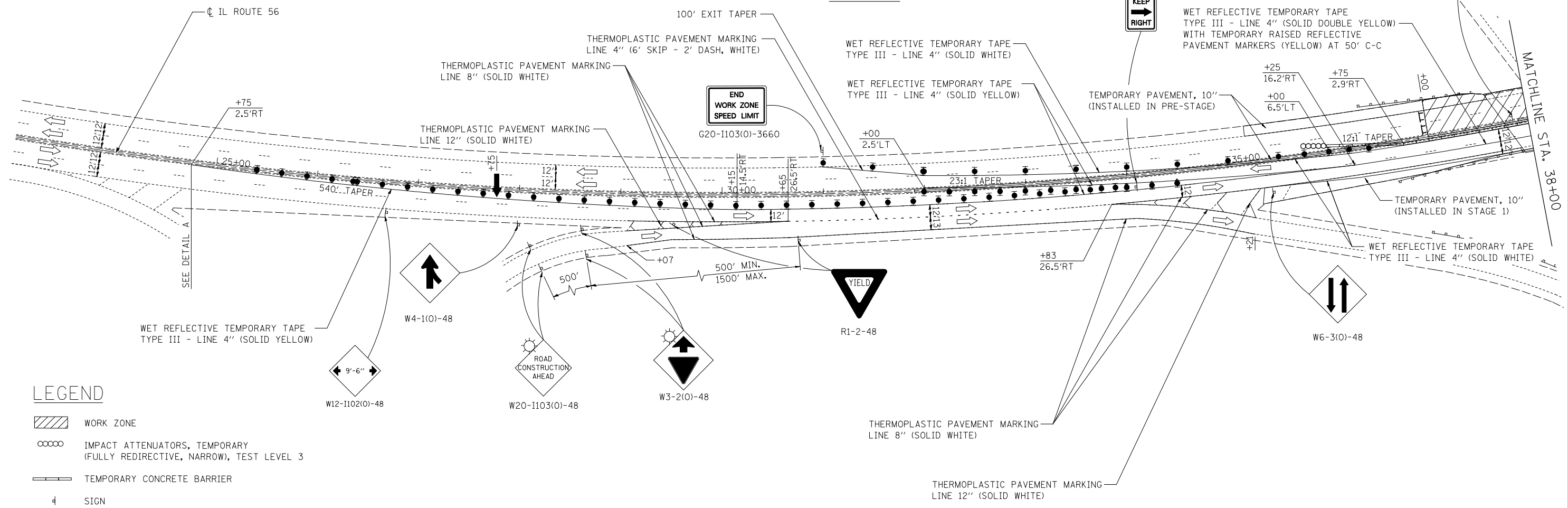
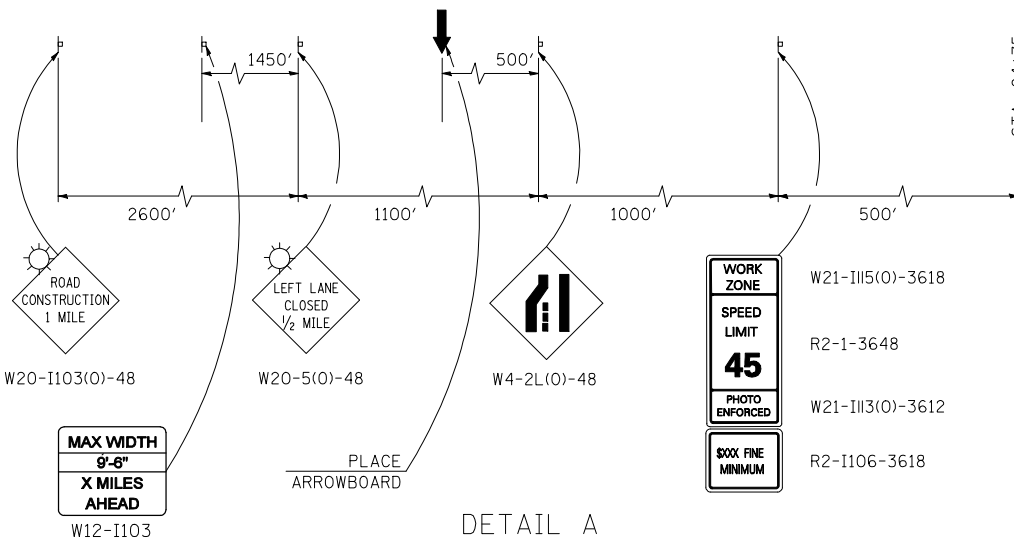

**LEGEND**

- WORK ZONE
- IMPACT ATTENUATORS, TEMPORARY (FULLY REDIRECTIVE, NARROW), TEST LEVEL 3
- TEMPORARY CONCRETE BARRIER
- SIGN
- DIRECTION INDICATOR BARRICADE WITH STEADY BURN MONODIRECTIONAL LIGHT
- TYPE II BARRICADE OR DRUM WITH STEADY BURN MONODIRECTIONAL LIGHT
- ARROWBOARD
- TYPE III BARRICADE W/2 FLASHING BEACONS (NO. OF BARRICADES AS DIRECTED BY ENGINEER)

**NOTES:**

1. ANY CLOSURE TO IL ROUTE 38 (ROOSEVELT RD.) SHALL BE IN ACCORDANCE WITH HIGHWAY STANDARD 701422-05.

