

* CONCRETE MEDIAN AND CURB & GUTTER REMOVAL AND THE CONSTRUCTION OF TEMP. PAVEMENT SHALL BE DONE AS A PRESTAGE USING STANDARD 701606 BEFORE STAGE I CONSTRUCTION. COST INCLUDED IN "TRAFFIC CONTROL AND PROTECTION (SPECIAL)".

COST OF TEMPORARY REMOVAL OR RELOCATION OF EXISTING SIGNS IS INCLUDED IN COST OF "TRAFFIC CONTROL AND PROTECTION (SPECIAL)".

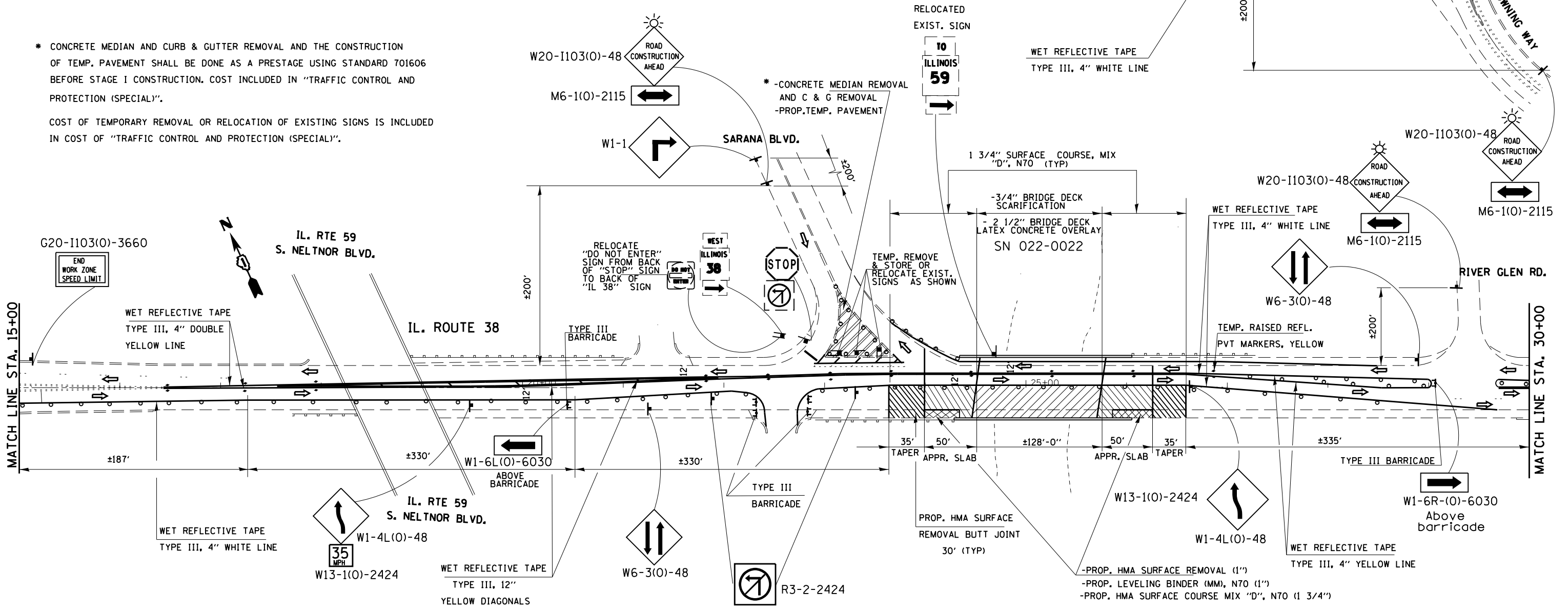

FILE NAME =	USER NAME = gorengautab	DESIGNED -	REVISED -	STATE OF ILLINOIS DEPARTMENT OF TRANSPORTATION	IL 38 (ROOSEVELT RD) AT WEST BRANCH DUPAGE RIVER TRAFFIC CONTROL PLAN. STAGE I (SN 022-0022)	F.A.P. RTE.	SECTION	COUNTY	TOTAL SHEETS	SHEET NO.	
c:\pwork\pwork\gorengautab\d0273151	162311-sht-plan.dgn	DRAWN -	REVISED -			347	2011-067-1	DUPAGE	29	15	
PLOT SCALE = 97.7273' / 1"		CHECKED -	REVISED -			CONTRACT NO. 60P86					
PLOT DATE = 5/8/2013		DATE -	REVISED -			ILLINOIS FED. AID PROJECT					