

**GENERAL NOTES:**

- 1). LIMIT OF RESURFACING ON THE SIDE-STREETS THROUGHOUT THE PROJECT SHALL BE TO THE RADIUS OF RETURN, UNLESS OTHERWISE SHOWN ON THE PLANS, OR AS DIRECTED BY THE RESIDENT ENGINEER.
- 2). ALL FINAL PAVEMENT MARKINGS SHALL BE THERMOPLASTIC (OF THE EXTRUDED TYPE) AND SHOULD BE PLACED IN ACCORDANCE WITH "CITY OF CHICAGO TYPICAL PAVEMENT MARKINGS (TC-24)" STANDARD DETAIL
- 3). CURB AND GUTTER REMOVAL AND REPLACEMENT MAY BE REQUIRED ADJACENT TO VAULTED SIDEWALKS. EXTRA CARE SHOULD BE TAKEN TO AVOID DAMAGE TO THE EXISTING VAULTED SIDEWALKS

**NOTE:**

PARKING LANE RESURFACING (18+88 TO 30+00)  
 PROP. HMA SURFACE REMOVAL, 2"  
 PROP. HMA SURFACE COURSE, MIX "D", N70, 2"

PROP. 24" WHITE THERMOPLASTIC PEDESTRIAN CROSSWALK (TYP.)

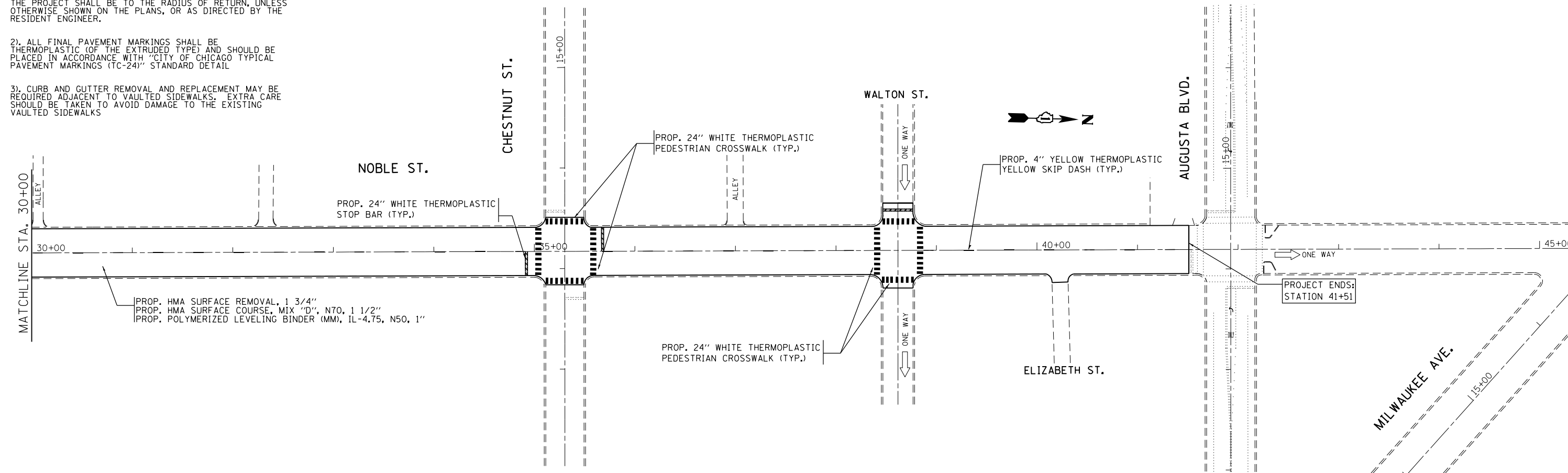

FILE NAME =	USER NAME = Bilgramisa	DESIGNED -	REVISED -	<b>STATE OF ILLINOIS DEPARTMENT OF TRANSPORTATION</b>	<b>ROADWAY &amp; PAVEMENT MARKING PLAN NOBLE ST. (ERIE ST. - AUGUSTA BLVD.)</b>	OR	SECTION	COUNTY	TOTAL	SHEET	
et:\pw\work\pwidot\bilgramisa\d0278421\103912-sh-t-plan.dgn		DRAWN -	REVISED -			22	2011-086-R5	COOK	18	7	
PLOT SCALE = 100.0000' / in.		CHECKED -	REVISED -			CONTRACT NO. 60R13					
PLOT DATE = 3/25/2013		DATE -	REVISED -			ILLINOIS FED. AID PROJECT					
					SCALE:	SHEET NO. 7 OF 7 SHEETS	STA. 18+88 TO STA. 41+51				