

FILE NAME = G:\Projects\ILLINOIS Department of Transportation\PTB 162 - Item 7 - Various Various\Work Order No. 9- US 12 at Old McHenry Rd\CADD Sheets\160T88-sht-mot-typical.dgn

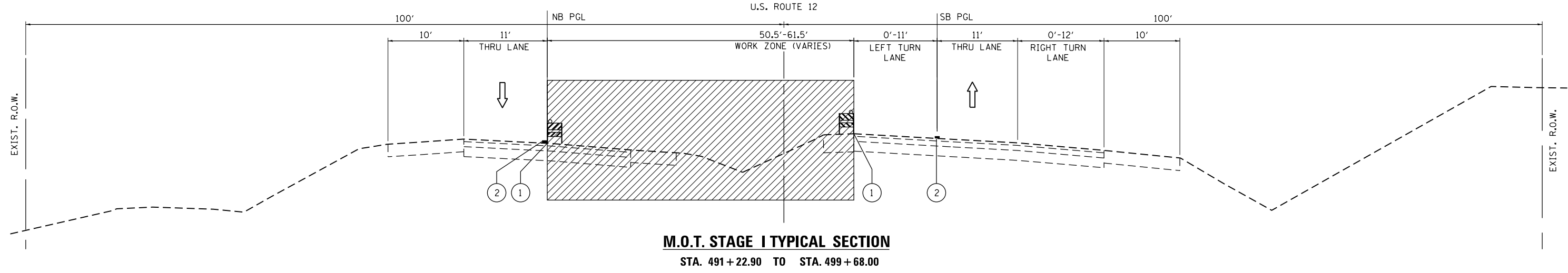

**M.O.T. STAGE I TYPICAL SECTION**  
 STA. 491+22.90 TO STA. 499+68.00

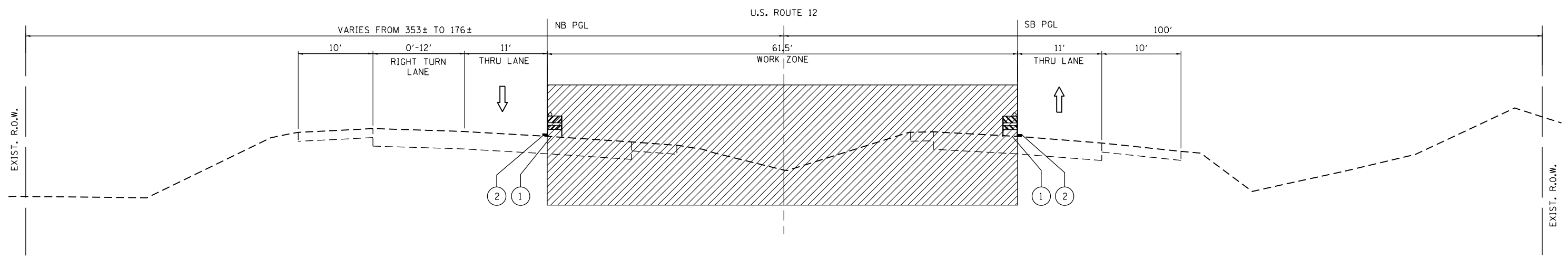

**M.O.T. STAGE I TYPICAL SECTION**  
 STA. 500+43.69 TO STA. 505+70.56 (NORTHBOUND)  
 STA. 500+43.69 TO STA. 505+88.67 (SOUTHBOUND)

**LEGEND**

- ① TYPE II BARRICADE OR VERTICAL PANEL WITH STEADY BURN MONO-DIRECTIONAL LIGHT
- ② TEMPORARY PAVEMENT MARKING - LINE 4" (YELLOW)
- ← DIRECTION OF TRAFFIC
- ▨ WORK ZONE

**NOTES**

1. PRIOR TO INSTALLING POST MOUNTED SIGNS, THE CONTRACTOR SHALL CONTACT J.U.L.I.E.
2. SEE STAGING PLAN AND STANDARD 701422 FOR ADDITIONAL INFORMATION.
3. ALL DRAINAGE ITEMS SHALL BE CONSTRUCTED DURING M.O.T. STAGE I.

USER NAME = mmiller	DESIGNED - MTM	REVISED -
	DRAWN - MTM	REVISED -
PLOT SCALE = 20.0000' / in.	CHECKED - BA	REVISED -
PLOT DATE = 3/27/2013	DATE - 3/27/13	REVISED -

**STATE OF ILLINOIS  
 DEPARTMENT OF TRANSPORTATION**

**SUGGESTED MAINTENANCE OF TRAFFIC  
 STAGE I - TYPICAL SECTIONS**

SCALE: N.T.S. SHEET 1 OF 2 SHEETS STA. TO STA.

F.A.P. RTE.	SECTION	COUNTY	TOTAL SHEETS	SHEET NO.
334	TR-TS	LAKE	58	20
CONTRACT NO. 60T88				
ILLINOIS FED. AID PROJECT				