

G:\Projects\ILLINOIS Department of Transportation\PTB 162 - Item 7 - Various Various\Work Order No. 9- US 12 at Old McHenry Rd\CAD Sheets\160T88-ent-erosion.dgn

MATCH LINE STA. 499+75, SEE SHEET 24

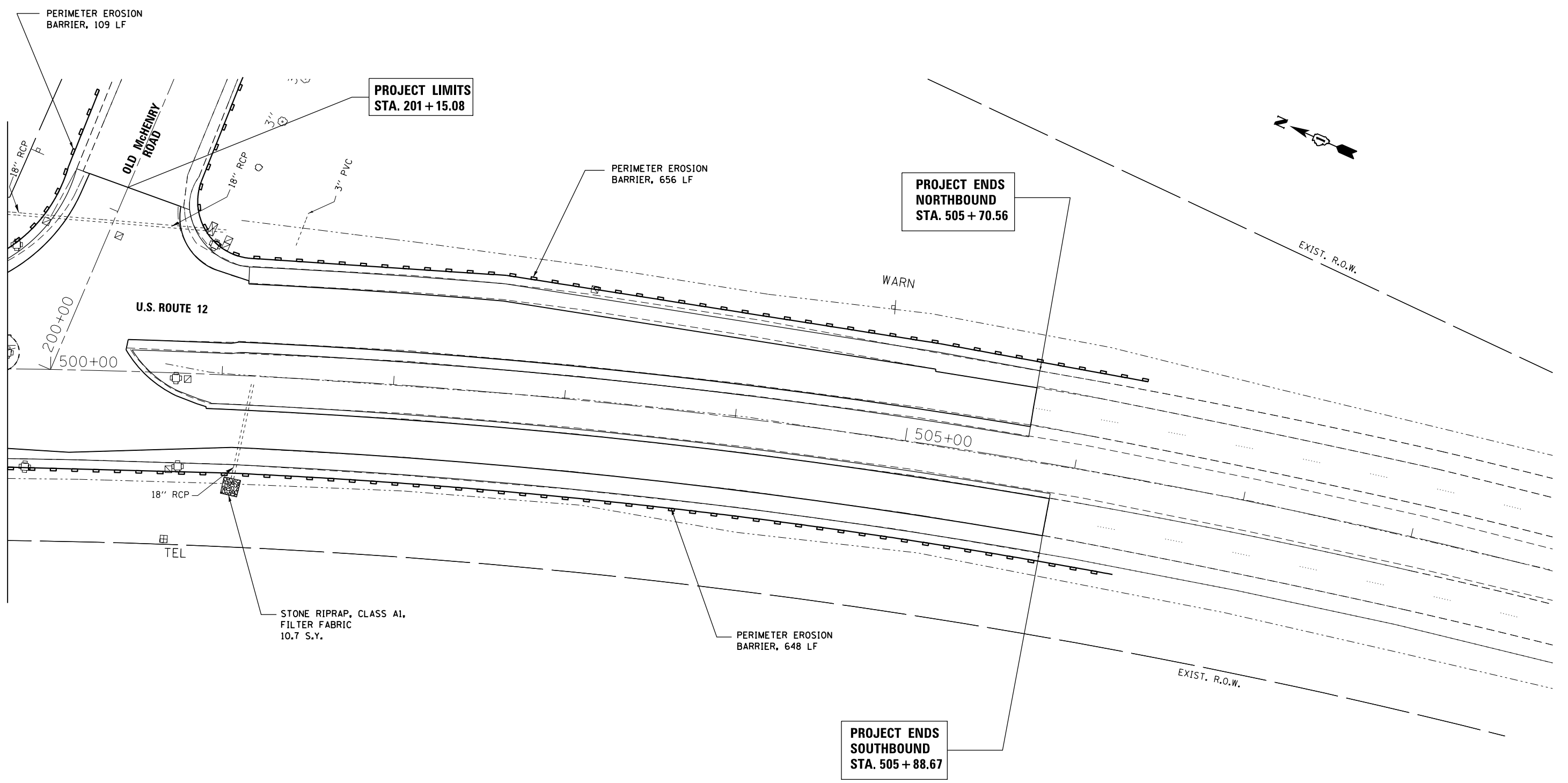

FILE NAME =	USER NAME = mmiller	DESIGNED - BA	REVISED -
Default		DRAWN - BA	REVISED -
	PLOT SCALE = 60.0000' / in.	CHECKED - AW	REVISED -
	PLOT DATE = 3/27/2013	DATE - 3/27/13	REVISED -

**STATE OF ILLINOIS
DEPARTMENT OF TRANSPORTATION**

TEMPORARY EROSION SEDIMENT CONTROL

SCALE: 1"=30' SHEET 2 OF 2 SHEETS STA. 499+75.00 TO STA. 505+88.67

F.A.P. RTE.	SECTION	COUNTY	TOTAL SHEETS	SHEET NO.
334	TR-TS	LAKE	58	25
CONTRACT NO. 60T88				
ILLINOIS FED. AID PROJECT				