

PLAN	SURVEYED	DATE
	PLOTTED	BY
	GRADES CHECKED	
	ALIGNMENT CHECKED	
	STRUCTURE NOTED	
	FILE NAME	
	NO.	

PROFILE	SURVEYED	DATE
	PLOTTED	BY
	GRADES CHECKED	
	STRUCTURE NOTED	
	FILE NAME	
	NO.	

G:\Projects\ILLINOIS Department of Transportation\162 - Item 7 - Various Various Work Order No. 9 - US 12 at Old Highway Rd\CAD Sheets\060888-shd-draw.dgn

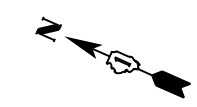

- 50 STA. 499+55.00 12.5' LT CATCH BASIN TYPE C, 4' DIA TYPE 24 FRAME & GRATE RIM EL 869.74 INV EL 865.74 (W) 12"
- 51 STA. 499+55.00 5.1' LT CATCH BASIN TYPE C, 4' DIA TYPE 24 FRAME & GRATE RIM EL 870.11 INV EL 865.61 (E) 12"
- 52 STA. 499+51.30 8.8' LT MANHOLE TYPE A, 4' DIA TYPE 1 FRAME & GRATE, CLOSED RIM EL 870.00 INV EL 865.34 (N) 12" INV EL 865.50 (E) 12" INV EL 865.50 (W) 12"
- 53 STA. 498+00.00 12.8' LT CATCH BASIN TYPE C, 4' DIA TYPE 24 FRAME & GRATE RIM EL 868.09 INV EL 864.09 (W) 12"
- 54 STA. 498+00.00 5.4' LT CATCH BASIN TYPE C, 4' DIA TYPE 24 FRAME & GRATE RIM EL 868.57 INV EL 864.07 (E) 12"
- 55 STA. 497+96.30 9.1' LT MANHOLE TYPE A, 5' DIA TYPE 1 FRAME, CLOSED LID RIM EL 868.45 INV EL 863.01 (N) 12" INV EL 863.01 (S) 12" INV EL 863.96 (E) 12" INV EL 863.96 (W) 12"
- 56 STA. 496+50.00 13.1' LT CATCH BASIN TYPE C, 4' DIA TYPE 24 FRAME & GRATE RIM EL 866.56 INV EL 862.56 (W) 12"
- 57 STA. 496+50.00 5.6' LT CATCH BASIN TYPE C, 4' DIA TYPE 24 FRAME & GRATE RIM EL 867.00 INV EL 862.50 (E) 12"
- 58 STA. 496+46.30 9.4' LT MANHOLE TYPE A, 5' DIA TYPE 1 FRAME, CLOSED LID RIM EL 866.75 INV EL 860.75 (N) 12" INV EL 860.50 (S) 15" INV EL 862.45 (E) 12" INV EL 862.45 (W) 12"
- 59 STA. 495+00.00 13.4' LT CATCH BASIN TYPE C, 4' DIA TYPE 24 FRAME & GRATE RIM EL 865.32 INV EL 861.32 (W) 12"
- 60 STA. 495+00.00 4.3' LT CATCH BASIN TYPE C, 4' DIA TYPE 24 FRAME & GRATE RIM EL 865.86 INV EL 861.36 (E) 12"
- 61 STA. 494+96.30 9.7' LT MANHOLE TYPE A, 5' DIA TYPE 1 FRAME, OPEN LID RIM EL 865.55 INV EL 858.75 (N) 15" INV EL 859.00 (S) 18" INV EL 861.20 (E) 12" INV EL 861.20 (W) 12"
- 62 STA. 493+50.00 13.8' LT CATCH BASIN TYPE C, 4' DIA TYPE 24 FRAME & GRATE RIM EL 864.05 INV EL 860.05 (W) 12"
- 63 STA. 493+50.00 7.2' RT CATCH BASIN TYPE C, 4' DIA TYPE 24 FRAME & GRATE RIM EL 864.80 INV EL 860.30 (E) 12"
- 64 STA. 493+50.00 3.3' LT MANHOLE TYPE A, 5' DIA TYPE 1 FRAME, OPEN LID RIM EL 863.50 INV EL 858.24 (N) 18" INV EL 858.24 (S) 18" INV EL 859.80 (E) 12" INV EL 859.80 (W) 12"
- 65 STA. 492+00.00 14.1' LT CATCH BASIN TYPE C, 4' DIA TYPE 24 FRAME & GRATE RIM EL 862.64 INV EL 858.64 (W) 12"
- 66 STA. 492+00.00 12.3' RT CATCH BASIN TYPE C, 4' DIA TYPE 24 FRAME & GRATE RIM EL 863.74 INV EL 858.74 (E) 12"
- 67 STA. 492+00.00 0.9' LT MANHOLE TYPE A, 5' DIA TYPE 1 FRAME, OPEN LID RIM EL 861.80 INV EL 857.71 (N) 18" INV EL 857.71 (S) 18" INV EL 858.00 (E) 12" INV EL 858.00 (W) 12"
- 68 STA. 491+30.00 14.3' LT CATCH BASIN TYPE C, 4' DIA TYPE 24 FRAME & GRATE RIM EL 862.12 INV EL 858.12 (W) 12"
- 69 STA. 491+30.00 10.8' RT CATCH BASIN TYPE C, 4' DIA TYPE 24 FRAME & GRATE RIM EL 863.18 INV EL 858.68 (E) 12"
- EX STA. 491+39.37 1.0' RT EXISTING MANHOLE EX RIM EL 861.86 ADJUST RIM EL 861.20 INV EL 857.49 (S) 18" INV EL 857.80 (E) 12" INV EL 857.80 (W) 12"

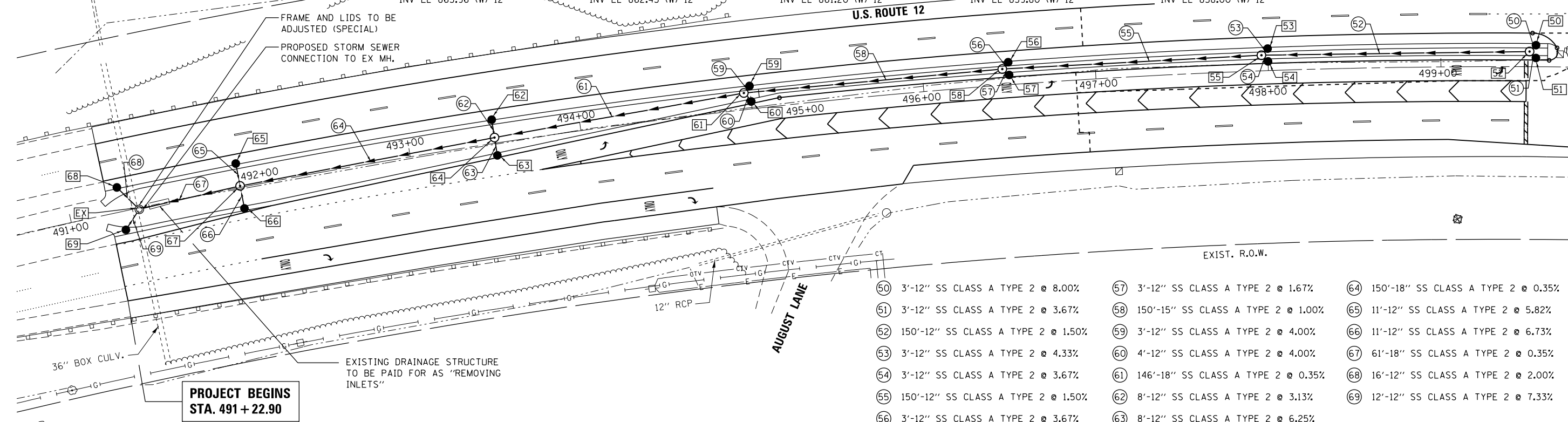

**PROJECT BEGINS  
STA. 491 + 22.90**

- 50 3'-12" SS CLASS A TYPE 2 @ 8.00%
- 51 3'-12" SS CLASS A TYPE 2 @ 3.67%
- 52 150'-12" SS CLASS A TYPE 2 @ 1.50%
- 53 3'-12" SS CLASS A TYPE 2 @ 4.33%
- 54 3'-12" SS CLASS A TYPE 2 @ 3.67%
- 55 150'-12" SS CLASS A TYPE 2 @ 1.50%
- 56 3'-12" SS CLASS A TYPE 2 @ 3.67%
- 57 3'-12" SS CLASS A TYPE 2 @ 1.67%
- 58 150'-15" SS CLASS A TYPE 2 @ 1.00%
- 59 3'-12" SS CLASS A TYPE 2 @ 4.00%
- 60 4'-12" SS CLASS A TYPE 2 @ 4.00%
- 61 146'-18" SS CLASS A TYPE 2 @ 0.35%
- 62 8'-12" SS CLASS A TYPE 2 @ 3.13%
- 63 8'-12" SS CLASS A TYPE 2 @ 6.25%
- 64 150'-18" SS CLASS A TYPE 2 @ 0.35%
- 65 11'-12" SS CLASS A TYPE 2 @ 5.82%
- 66 11'-12" SS CLASS A TYPE 2 @ 6.73%
- 67 61'-18" SS CLASS A TYPE 2 @ 0.35%
- 68 16'-12" SS CLASS A TYPE 2 @ 2.00%
- 69 12'-12" SS CLASS A TYPE 2 @ 7.33%

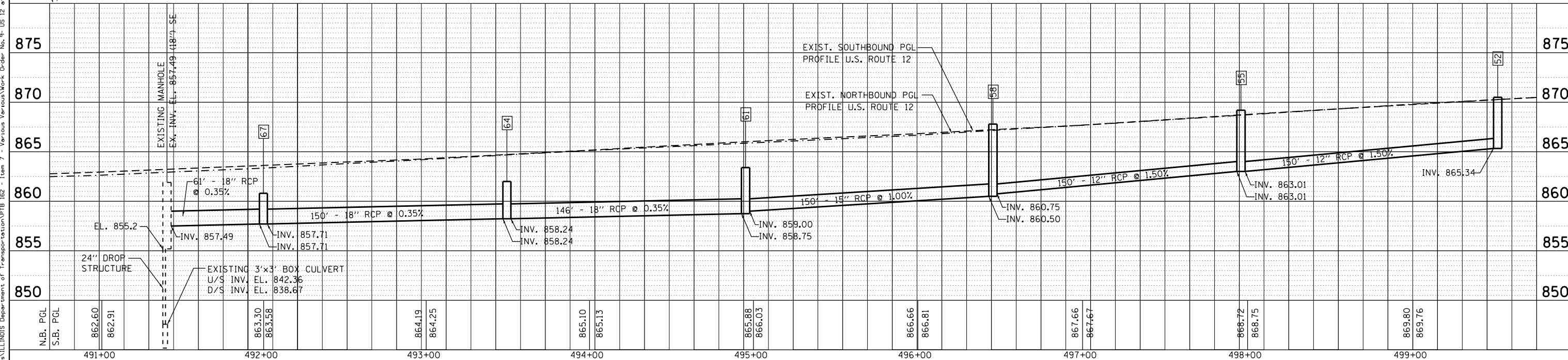

FILE NAME =	USER NAME = mmiller	DESIGNED - MTM	REVISED -	<b>STATE OF ILLINOIS DEPARTMENT OF TRANSPORTATION</b>	<b>PROPOSED DRAINAGE AND UTILITIES</b>	F.A.P. R.T.E. 334	SECTION TR-TS	COUNTY LAKE	TOTAL SHEETS 58	SHEET NO. 27	
Default	PLOT SCALE = 60.0000' / in.	CHECKED - BA	REVISED -			CONTRACT NO. 60T88					
	PLOT DATE = 3/27/2013	DATE - 3/27/13	REVISED -			ILLINOIS FED. AID PROJECT					
						SCALE: 1"=30'    SHEET 2 OF 3 SHEETS    STA. TO STA.					

MATCH LINE STA. 499+75  
SEE SHEET 28