

**BENCHMARK**

N.E. BOLT ON FIRE HYDRANT @ S.E. CORNER OF ELM ROAD AND HARWOOD AVE.

HARWOOD AVE. (SOUTH)	PT# A5	N 1783056.5261	E 1166253.2684	STA. 200+00
	PT# A6	N 1783262.5089	E 1166250.6059	STA. 202+06
	PT# A7	N 1784596.0866	E 1166774.1489	STA. 216+38.66
HARWOOD AVE. (NORTH)	PT# A20	N 1784594.9227	E 1166777.1161	STA. 80+00
	PT# A21	N 1784743.0032	E 1166906.6863	STA. 81+96.76
ELM ST.	PT# A22	N 1784878.3427	E 1167025.1082	STA. 83+76.60
	PT# A90	N 1784387.5294	E 1166692.2725	STA. 30+00
DIXIE HWY	PT# A91	N 1784330.9831	E 1166841.4892	STA. 31+59.57
	PT# A92	N 1784258.2460	E 1167033.4312	STA. 33+64.83
	PT# A40	N 1784702.1054	E 1166503.8833	STA. 40+00
	PT# A41	N 1784644.6207	E 1166650.4247	STA. 41+57.41
	PT# A42	N 1784495.6262	E 1167030.2451	STA. 45+65.41

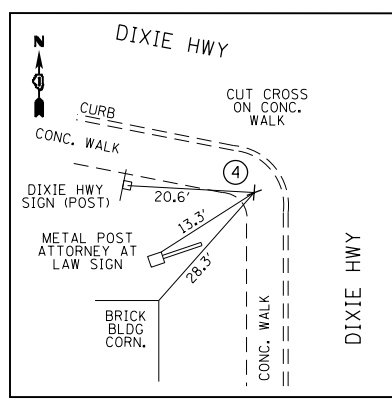

#4 ROVER @ CP CROSS

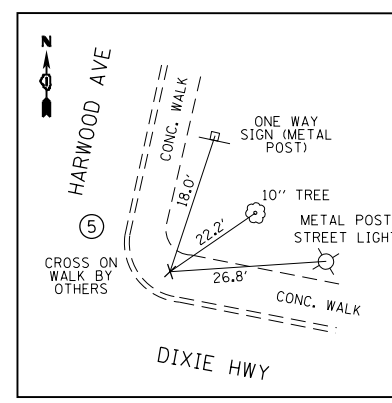

#5 ROVER @ CP CROSS

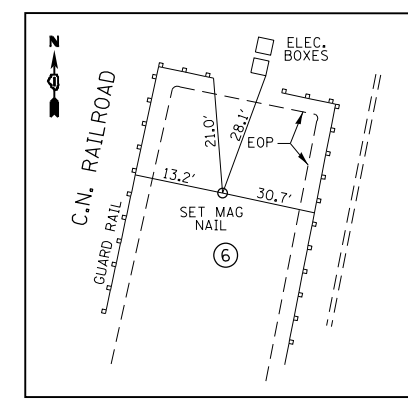

#6 ROVER @ CP MAG NAIL

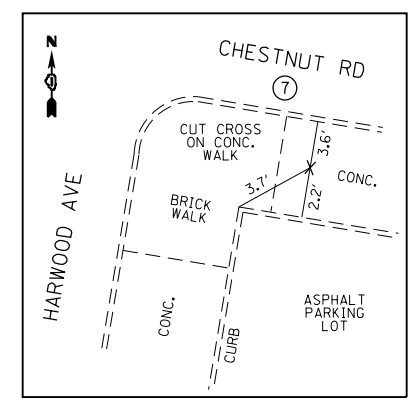

#7 ROVER @ CP CROSS

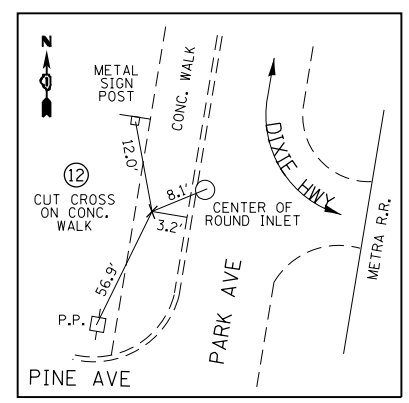

#12 ROVER @ CP CROSS

FILE NAME =	USER NAME = midyja	DESIGNED -	REVISED -
c:\pwork\pwork\midyja\0267296\PI18111	sh-t-ATB.dgn	DRAWN -	REVISED -
	PLOT SCALE = 200.0000' / in.	CHECKED -	REVISED -
#MODELNAME#	PLOT DATE = 3/27/2013	DATE -	REVISED -

**STATE OF ILLINOIS  
DEPARTMENT OF TRANSPORTATION**

ALIGNMENT, TIES, AND BENCHMARK			
HARWOOD AVE (ELM RD - DIXIE HWY)			
SCALE: 1"=100'	SHEET	OF SHEETS	STA. TO STA.

F.A.U. RTE.	SECTION	COUNTY	TOTAL SHEETS	SHEET NO.
2845	3160A-RS&N	COOK	27	8
				CONTRACT NO. 60T99
ILLINOIS FED. AID PROJECT				