

STATE OF ILLINOIS  
DEPARTMENT OF TRANSPORTATION  
DIVISION OF HIGHWAYS

**PROPOSED  
HIGHWAY PLANS**

VARIOUS LOCATIONS IN WILL COUNTY  
LIGHT EMITTING DIODE (LED) INSTALLATION  
SECTION 2013-004-1  
WILL COUNTY  
D-91-217-13

F.A. RTE.	SECTION	COUNTY	TOTAL SHEETS	SHEET NO.
VAR.	2013-004-1	WILL	58	1
		ILLINOIS	CONTRACT NO. 60W22	

\*58-1 = 57

D-91-217-13

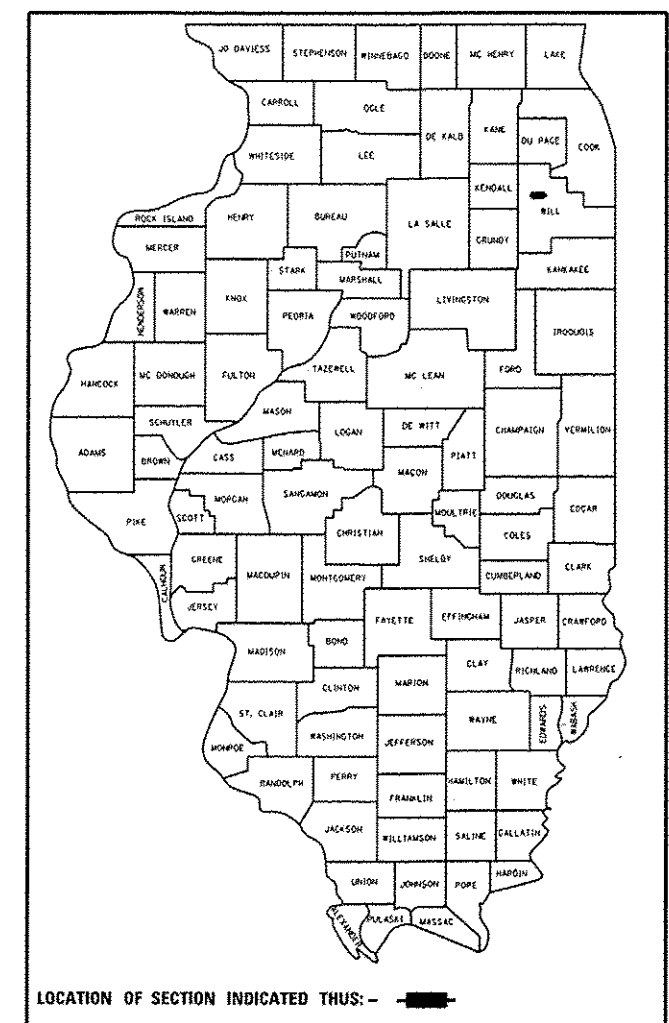

FOR INDEX OF SHEETS, SEE SHEET NO. 2

**HIGHWAY STANDARDS**

- 701006-03 OFF-ROAD OPERATIONS 2L, 2W, 15' (4.5 m) TO 24" (600 mm) FROM PAVEMENT EDGE
- 701101-02 OFF-ROAD OPERATIONS MULTILANE, 15' (4.5 m) TO 24" (600 mm) FROM PAVEMENT EDGE
- 701701-08 URBAN LANE CLOSURE MULTILANE INTERSECTION
- 701901-02 TRAFFIC CONTROL DEVICES
- 720001-01 SIGN PANEL MOUNTING DETAIL
- 720006-03 SIGN PANEL ERECTION DETAILS
- 857001-01 STANDARD PHASE DESIGNATION DIAGRAMS AND PHASE SEQUENCES
- 862001-01 UNINTERRUPTABLE POWER SUPPLY (UPS)
- 880006-01 TRAFFIC SIGNAL MOUNTING DETAILS

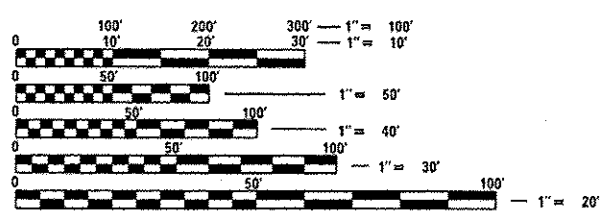
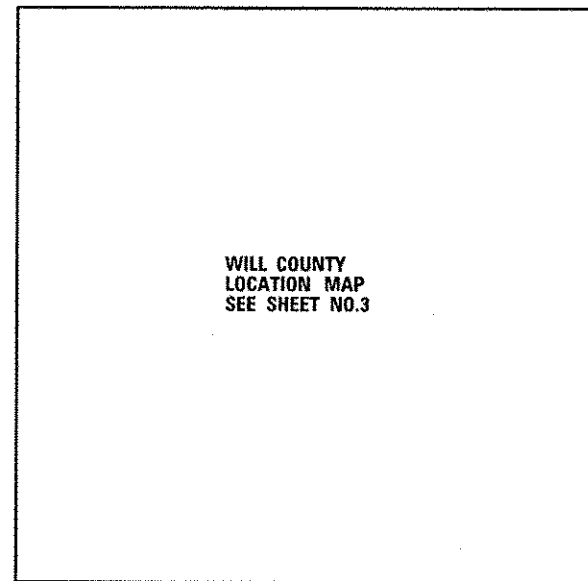

FULL SIZE PLANS HAVE BEEN PREPARED USING STANDARD ENGINEERING SCALES. REDUCED SIZED PLANS WILL NOT CONFORM TO STANDARD SCALES. IN MAKING MEASUREMENTS ON REDUCED PLANS, THE ABOVE SCALES MAY BE USED.

J.U.L.I.E.  
JOINT UTILITY LOCATION INFORMATION FOR EXCAVATION  
1-800-892-0123  
OR 811

PROJECT ENGINEER: ISIS ROSADO  
PROJECT MANAGER: SUDUD MAHMOUD (847) 708-4420

CONTRACT NO. 60W22

STATE OF ILLINOIS  
DEPARTMENT OF TRANSPORTATION  
DIVISION OF HIGHWAYS

SUBMITTED March 29 20 13  
*John P. Baranzelli*  
DEPUTY DIRECTOR OF HIGHWAYS, REGION ENGINEER

May 10 20 13  
*John D. Baranzelli* P.E.  
acting ENGINEER OF DESIGN AND ENVIRONMENT

May 10 20 13  
*Omer Osman* P.E.  
DIRECTOR OF HIGHWAYS, CHIEF ENGINEER

PRINTED BY THE AUTHORITY  
OF THE STATE OF ILLINOIS

Rev. 6-4-13

**INDEX OF SHEETS**

- 1 COVER SHEET
- 2 INDEX OF SHEETS
- 3-4 LOCATION MAP
- 5-8 SUMMARY OF QUANTITIES
- 9-14 DISTRICT 1 STANDARD TRAFFIC SIGNAL DESIGN DETAILS

**TRAFFIC SIGNAL PLANS**

PAGE*	TS*	INTERSECTION NAME
15	7505	IL ROUTE 1 (DIXIE HIGHWAY) AND INDIANA AVENUE
16	7503	IL ROUTE 1 (DIXIE HIGHWAY) AND CHURCH ROAD
17	4290	US ROUTE 30 (PLAINFIELD RD.) AT LARKIN AVE.
18	7420	IL ROUTE 7 (THEODORE ST.) AT US ROUTE 30 (PLAINFIELD RD.)
19	4295	IL ROUTE 7 (THEODORE ST.) AT IL ROUTE 7 (LARKIN AVE.)
20	4730	IL ROUTE 7 (LARKIN AVE.) AT HILLCREST S.C.
21	7535	IL ROUTE 7 (THEODORE ST.) AT ARBOR LANE
22	20561	IL ROUTE 53 AT CATON FARM ROAD
23	7430	US ROUTE 30 (PLAINFIELD RD.) AT CATON FARM ROAD
24	924	IL ROUTE 1 (DIXIE HIGHWAY) AT CRETE-MONEE RD.
25	7412	US ROUTE 45 AT LARAWAY ROAD
26	7609	IL ROUTE 171 (ARCHER AVENUE) AT I-355 NORTHBOUND RAMP
27	7608	IL ROUTE 171 (ARCHER AVENUE) AT I-355 SOUTHBOUND RAMP
28	7526	IL ROUTE 7 (159TH STREET) AT FARREL ROAD
29	7529	IL ROUTE 7 (159TH STREET) AT ADELMAN DRIVE
30	7521	IL ROUTE 7 (9TH STREET) AT 7TH STREET
31	7523	IL ROUTE 7 (9TH STREET) AT HAMILTON STREET
32	7522	IL ROUTE 7 (9TH STREET) AT MADISON STREET
33	7545	IL ROUTE 53 AT DIVISION STREET
34	7524	IL ROUTE 7 (9TH STREET) AT LOCH LANE
35	21895	IL ROUTE 59 AT 95TH STREET
36	21893	IL ROUTE 59 AT CANTORE ROAD
37	21465	IL ROUTE 59 AT 103RD STREET
38	21860	IL ROUTE 59 AT 111TH STREET
39	7432	US ROUTE 6 AT 1355 EAST RAMP (B & D)
40	7437	US ROUTE 30 AT PRAIRIE ROAD
41	7433	US ROUTE 6 AT CEDAR ROAD
42	7608	US ROUTE 30 / IL ROUTE 59 AT IL ROUTE 171
43	7588	US ROUTE 30 / IL ROUTE 59 AT US ROUTE 30 / 143RD STREET
44	7586	US ROUTE 30 / IL ROUTE 59 AT PLAINFIELD-NAPERVILLE ROAD
45	21864	IL ROUTE 59 AT 135TH STREET
46	7587	IL ROUTE 59 AT MEIJER ACCESS
47	20972	US ROUTE 30 AT 135TH STREET
48	21863	IL ROUTE 59 AT 119TH STREET
49	21862	IL ROUTE 59 AT 127TH STREET
50	7532	IL ROUTE 7 (LARKIN AVE.) AT MEADOW AVE. / FRONTAGE ROAD
51	7530	IL ROUTE 7 (LARKIN AVE.) AT MOEN AVENUE
52	20600	US ROUTE 6 AT BRANDON ROAD
53	7405	IL ROUTE 7 (LARKIN AVE.) AT US ROUTE 6
54	9130	IL ROUTE 53 (INDEPENDENCE BLVD) AT TAYLOR ROAD
55	7567	JOLIET ROAD AT BLUFF ROAD
56	7550	IL 50 (CICERO AVE.) AT GOVERNOR HIGHWAY
57	21861	IL ROUTE 59 AT ROYAL WORLINGTON DRIVE
58	21393	US ROUTE 30 AT 111TH STREET

**GENERAL NOTES:**

1. CONTRACTOR SHALL REPLACE BROKEN MOUNTING BRACKETS AT ALL RETROFIT SIGNAL HEAD INTERSECTIONS OR AS DIRECTED BY THE ENGINEER. THE COST OF THIS WORK SHALL BE INCLUDED IN THE CORRESPONDING SIGNAL HEAD, LED, RETROFIT PAY ITEM OF THE TYPE AND NUMBER OF SIGNAL HEADS, FACES, AND SECTIONS AS SPECIFIED IN THE PLANS.
2. CONTRACTOR SHALL RELOCATE EXISTING SIGN PANELS FROM PAINTED POSTS THAT ARE INDICATED FOR REPLACEMENT TO A NEW POSTS AS SHOWN ON THE PLANS OR AS DIRECTED BY THE ENGINEER. THE COST OF REMOVAL, RELOCATION AND ANY NEW MOUNTING HARDWARE NECESSARY TO COMPLETE THIS WORK SHALL BE INCLUDED IN THE TRAFFIC SIGNAL POST, GALVANIZED STEEL PAY ITEM OF THE LENGTH AS SPECIFIED IN THE PLANS.
3. DUE TO THE PRESENCE OF A RED LIGHT RUNNING (RLR) CAMERA FOR THE BELOW LISTED LOCATIONS, CONTRACTOR SHALL NOTIFY THE VILLAGE AND RLR CAMERA COMPANY PRIOR TO THE START OF CONSTRUCTION. THE VILLAGE OR THE RLR CAMERA COMPANY SHALL MAKE THE CAMERA INOPERATIVE FOR THE TIME OF CONSTRUCTION. ANY RLR CAMERA EQUIPMENT THAT IS IN CONFLICT WITH THE PROPOSED CONSTRUCTION SHALL BE REMOVED BY ITS RESPECTIVE OWNERS PRIOR TO THE START OF CONSTRUCTION.

RLR CAMERA LOCATION: 21864 - IL ROUTE 59 AT 135TH STREET AT PLAINFIELD.	
VILLAGE OF PLAINFIELD 24401 WEST LOCKPORT STREET PLAINFIELD, IL 60544 815-436-7093	LASERCRAFT 1450 OAKBROOK DRIVE, SUITE 900 NORCROSS, GA 30093 770-409-1391
RLR CAMERA LOCATION: 7524 - IL ROUTE 7 (159TH STREET) AT READ ST/LOCH LANE.	
VILLAGE OF LOCKPORT 222 EAST NINTH STREET LOCKPORT, IL 60441 815-838-0990	REDSPEED ILLINOIS 400 EISENHOWER LANE NORTH LOMBARD, IL 60148 630-317-5700
RLR CAMERA LOCATION: 7530 - IL ROUTE 7 (LARKIN AVE.) AT MOEN AVENUE.	
VILLAGE OF ROCKDALE 79 MOEN AVENUE ROCKDALE, IL 60436 815-725-8937	REDSPEED ILLINOIS 400 EISENHOWER LANE NORTH LOMBARD, IL 60148 630-317-5700

10. AT THE LOCATIONS ON THE PLANS WHERE UNINTERRUPTIBLE POWER SUPPLY, GROUND MOUNTED ARE SPECIFIED, THE UPS SHALL BE INSTALLED ON A SEPARATE FOUNDATION NEXT TO THE EXISTING CONTROLLER CABINET (TYPE III) OR AS DIRECTED BY THE ENGINEER. THIS WORK SHALL BE INCLUDED IN THE PAY ITEM "UNINTERRUPTIBLE POWER SUPPLY, GROUND MOUNTED" AND NO OTHER COMPENSATION WILL BE PROVIDED.
11. THE CONTRACTOR SHALL CONTACT THE TRAFFIC CONTROL SUPERVISOR AT (847) 705-4470 72 HOURS IN ADVANCE OF THE BEGINNING WORK.
12. RESTORATION OF THE TRAFFIC SIGNAL WORK AREA SHALL BE INCLUDED IN THE RELATED PAY ITEM SUCH AS FOUNDATION, CONDUIT, HANDHOLE, ETC., AND NO EXTRA COMPENSATION SHALL BE ALLOWED. ALL ROADWAY SURFACES SUCH AS SHOULDERS, MEDIAN, SIDEWALKS, PAVEMENT, ETC. SHALL BE REPLACED IN KIND. ALL DAMAGE TO MOWED LAWNS SHALL BE REPLACED WITH AN APPROVED SOD, AND ALL DAMAGE TO UNMOWED FIELDS SHALL BE SEEDED IN ACCORDANCE WITH STANDARD SPECIFICATIONS 252 AND 250 RESPECTIVELY.

4. IT SHALL BE THE CONTRACTOR'S RESPONSIBILITY TO VERIFY EXISTING BOLT PATTERN ON EXISTING FOUNDATIONS THAT ARE SPECIFIED TO BE RE-USED.
5. ANY ADDITIONAL CABLE LENGTHS NECESSARY FOR THE PROPOER INSTALLATION OF AN UNINTERRUPTABLE POWER SUPPLY, GROUND MOUNTED DUE TO THE LARGER DISTANCE AWAY FROM THE CONTROLLER CABINET SHALL NOT BE PAID FOR SEPARATELY, BUT SHALL BE INCLUDED IN THE UNINTERRUPTABLE POWER SUPPLY, GROUND MOUNTED PAY ITEM.
6. IT SHALL BE THE CONTRACTOR'S RESPONSIBILITY TO VERIFY ALL DIMENSIONS AND CONDITIONS EXISTING IN THE FIELD PRIOR TO ORDERING MATERIALS AND BEGINNING CONSTRUCTION. THIS SHALL INCLUDE LOCATING THE MAST ARM FOUNDATIONS AND VERIFYING THE MAST ARM LENGTHS.
7. THE EXACT LOCATION OF ALL UTILITES SHALL BE FIELD VERIFIED BY THE CONTRACTOR BEFORE ORDERING ANY MATERIALS AND STARTING ANY WORK. FOR LOCATIONS OF UTILITIES, LOCALLY OWNED EQUIPMENT, LEASED ENFORCEMENT CAMERA SYSTEM FACILITIES AND IDOT UNDERGROUND FACILITIES, CONTACT THE LOCAL COUNTIES, MUNICIPALITIES AND IDOT FOR LOCATES. THE CONTRACTOR SHALL CALL "JULIE" AT (800) 892-0123 OR 811, IN THE CITY OF CHICAGO CONTACT DIGGER AT (312) 744-7000 FOR FIELD LOCATIONS OF BURIED UTILITIES (48 HOURS NOTIFICATION REQUIRED).
8. THE CONTRACTOR SHALL COORDINATE CONSTRUCTION ACTIVITIES WITH UTILITY COMPANIES, LOCAL GOVERNMENT AGENCIES AND IDOT.
9. AT THE LOCATIONS ON THE PLANS WHERE TRAFFIC SIGNAL POST REMOVAL AND NEW TRAFFIC SIGNAL POST INSTALLATIONS ARE SPECIFIED, THE CONTRACTOR SHALL INSPECT THE EXISTING FOUNDATIONS. PRIOR TO REMOVING THE EXISTING TRAFFIC SIGNAL POST TO BE REPLACED, THE CONTRACTOR SHALL VERIFY THAT THE EXISTING CONDITION OF THE ANCHOR BOLT IS ACCEPTABLE. IF THE EXISTING ANCHOR IS NOT ACCEPTABLE, THE EXISTING TRAFFIC SIGNAL POST SHALL REMAIN IN PLACE AND NOT BE REMOVED AFTER THE CONTRACTOR HAS VERIFIED THE CONDITION OF ANCHOR BOLT WITH THE ENGINEER. THE CONTRACTOR SHALL BE PAID FOR THE NUMBER OF TRAFFIC SIGNAL POST INSTALLED AND NO OTHER COMPENSATION WILL BE PROVIDED.

Rev. 6-4-13

FILE NAME *	USER NAME *	DESIGNED -	REVISED -	<b>STATE OF ILLINOIS DEPARTMENT OF TRANSPORTATION</b>	SCALE: SHEET OF SHEETS STA. TO STA.	F.A. RTE.	SECTION	COUNTY	TOTAL SHEETS	SHEET NO.	
67\pww\k\pww\d01\rosado-vozevzey\08338	7810121713-st1-FS.dgn	DRAWN -	REVISED -			VAR	2013-004-1		58	2	
#MODELNAME*	PLOT SCALE * 40,0000 / in.	CHECKED -	REVISED -			CONTRACT NO. 60W22					
	PLOT DATE * 3/29/2013	DATE -	REVISED -			ILLINOIS FED. AID PROJECT					

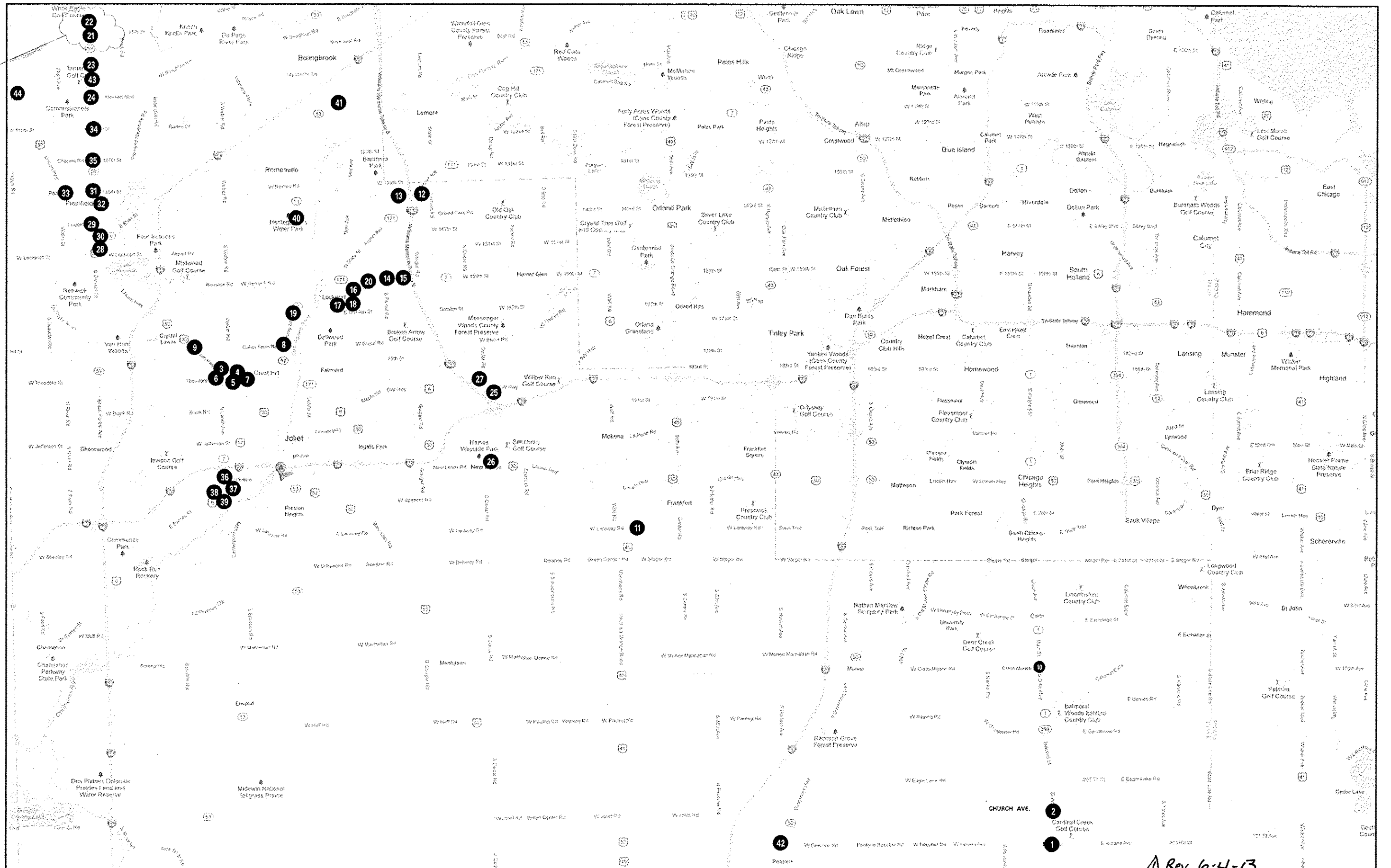

FILE NAME :	USER NAME :	DESIGNED :	REVISED :
c:\pwwork\pwwork\rosadovazquez\1083367	rosadovazquez	7/20/13-shr-TS.dgn	IRV 5-15-13
Default	PLDT SCALE :	CHECKED :	REVISED :
	PLDT DATE :	DATE :	REVISED :
	6/3/2013		

**STATE OF ILLINOIS  
DEPARTMENT OF TRANSPORTATION**

SCALE:		SHEET		OF		SHEETS		STA.	TO STA.
		1		1		1			

F.A. RTE.	SECTION	COUNTY	TOTAL SHEETS	SHEET NO.
VAR	2013-001-1	WILL	58	3
CONTRACT NO. 60W22			ILLINOIS FED. AID PROJECT	

Rev. 6-4-13

**TRAFFIC SIGNAL PLANS**

NO.	TS#	MUNICIPALITY	INTERSECTION
1.	7505	BEECHER	IL ROUTE 1 (DIXIE HIGHWAY) AND INDIANA AVENUE
2.	7503	BEECHER	IL ROUTE 1 (DIXIE HIGHWAY) AND CHURCH ROAD
3.	4290	CREST HILL	US ROUTE 30 (PLAINFIELD RD.) AT LARKIN AVE.
4.	7420	CREST HILL	IL ROUTE 7 (THEODORE ST.) AT US ROUTE 30 (PLAINFIELD RD.)
5.	4295	CREST HILL	IL ROUTE 7 (THEODORE ST.) AT IL ROUTE 7 (LARKIN AVE.)
6.	4730	CREST HILL	IL ROUTE 7 (LARKIN AVE.) AT HILLCREST S.C.
7.	7535	CREST HILL	IL ROUTE 7 (THEODORE ST.) AT ARBOR LANE
8.	20561	CREST HILL	IL ROUTE 53 AT CATON FARM ROAD
9.	7430	CREST HILL	US ROUTE 30 (PLAINFIELD RD.) AT CATON FARM ROAD
10.	924	CRETE	IL ROUTE 1 (DIXIE HIGHWAY) AT CRETE-MONEE RD.
11.	7412	FRANKFORT	US ROUTE 45 AT LARAWAY ROAD
12.	7609	LOCKPORT	IL ROUTE 171 (ARCHER AVENUE) AT I-355 NORTHBOUND RAMP
13.	7608	LOCKPORT	IL ROUTE 171 (ARCHER AVENUE) AT I-355 SOUTHBOUND RAMP
14.	7526	LOCKPORT	IL ROUTE 7 (159TH STREET) AT FARREL ROAD
15.	7529	LOCKPORT	IL ROUTE 7 (159TH STREET) AT ADELMAN DRIVE
16.	7521	LOCKPORT	IL ROUTE 7 (9TH STREET) AT 7TH STREET
17.	7523	LOCKPORT	IL ROUTE 7 (9TH STREET) AT HAMILTON STREET
18.	7522	LOCKPORT	IL ROUTE 7 (9TH STREET) AT MADISON STREET
19.	7545	LOCKPORT-CREST HILL	IL ROUTE 53 AT DIVISION STREET
20.	7524	LOCKPORT	IL ROUTE 7 (9TH STREET) AT LOCH LANE
21.	21895	NAPERVILLE	IL ROUTE 59 AT 95TH STREET
22.	21893	NAPERVILLE	IL ROUTE 59 AT CANTORE ROAD
23.	21465	NAPERVILLE/WEATLAND TWP	IL ROUTE 59 AT 103RD STREET
24.	21860	NAPERVILLE/WEATLAND TWP	IL ROUTE 59 AT 111TH STREET
25.	7432	NEW LENOX	US ROUTE 6 AT 1355 EAST RAMP (B & D)
26.	7437	NEW LENOX	US ROUTE 30 AT PRAIRIE ROAD
27.	7433	NEW LENOX	US ROUTE 6 AT CEDAR ROAD
28.	7585	PLAINFIELD	<del>US ROUTE 30 / IL ROUTE 59 AT IL ROUTE 126</del>
29.	7588	PLAINFIELD	US ROUTE 30 / IL ROUTE 59 AT US ROUTE 30 / 143RD STREET
30.	7586	PLAINFIELD	US ROUTE 30 / IL ROUTE 59 AT PLAINFIELD-NAPERVILLE ROAD
31.	21864	PLAINFIELD	IL ROUTE 59 AT 135TH STREET
32.	7587	PLAINFIELD	IL ROUTE 59 AT MEIJER ACCESS
33.	20972	PLAINFIELD	US ROUTE 30 AT 135TH STREET
34.	21863	PLAINFIELD/WEATLAND TWP	IL ROUTE 59 AT 119TH STREET
35.	21862	PLAINFIELD/WEATLAND TWP	IL ROUTE 59 AT 127TH STREET
36.	7532	ROCKDALE	IL ROUTE 7 (LARKIN AVE.) AT MEADOW AVE. / FRONTAGE ROAD
37.	7530	ROCKDALE	IL ROUTE 7 (LARKIN AVE.) AT MOEN AVENUE
38.	20600	ROCKDALE	US ROUTE 6 AT BRANDON ROAD
39.	7405	ROCKDALE/JOLIET	IL ROUTE 7 (LARKIN AVE.) AT US ROUTE 6
40.	9130	ROMEOVILLE	IL ROUTE 53 (INDEPENDENCE BLVD) AT TAYLOR ROAD
41.	7567	ROMEOVILLE	JOLIET ROAD AT BLUFF ROAD
42.	7550	UNIVERSITY PARK	IL 50 (CICERO AVE.) AT GOVERNOR HIGHWAY
43.	21861	WHEATLAND TWP	IL ROUTE 59 AT ROYAL WORLINGTON DRIVE
44.	21393	WHEATLAND TWP	US ROUTE 30 AT 111TH STREET



Rev. 6-4-13

FILE NAME =	USER NAME = rosadovazquez	DESIGNED = IRV	REVISED = IRV 5-15-13	<b>STATE OF ILLINOIS DEPARTMENT OF TRANSPORTATION</b>	<b>LOCATION MAP INTERSECTION NUMBERS</b>				F.A. RTE.	SECTION	COUNTY	TOTAL SHEETS	SHEET NO.
c:\pvc\work\pvd\rosadovazquez\023367	75NDI21713-shr-15.dgn	DRAWN = IRV	REVISED = IRV 6-3-13		SCALE:	SHEET	OF	SHEETS	STA.	TO STA.	ILLINOIS	58	4
Default	PLOT SCALE = 40,0000' / in.	CHECKED = SM	REVISED =						VAR	2013-004-1	WILL	CONTRACT NO. 60W22	
	PLOT DATE = 6/2/2013	DATE =	REVISED =									ILLINOIS FED. AID PROJECT	

SUMMARY OF QUANTITIES HEADING LEGEND

FUNDING PARTICIPATION

NO.	COLUMN NUMBER	TS#	MUNICIPALITY	INTERSECTION	STATE	FUNDING PARTICIPATION											TOTAL		
						WILL COUNTY	BEECHER	CREST HILL	CRETE TWP	LOCKPORT	LOCKPORT TWP	NAPERVILLE	NEW LENOX	PLAINFIELD	ROCKDALE	ROMEDEVILLE		WHEATLAND TWP	
1.	8	7505	BEECHER	IL ROUTE 1 (DIXIE HIGHWAY) AND INDIANA AVENUE	95%	5%													100%
2.	11	7503	BEECHER	IL ROUTE 1 (DIXIE HIGHWAY) AND CHURCH ROAD	95%		5%												100%
3.	1	4290	CREST HILL	US ROUTE 30 (PLAINFIELD RD.) AT LARKIN AVE.	100%														100%
4.	1	7420	CREST HILL	IL ROUTE 7 (THEODORE ST.) AT US ROUTE 30 (PLAINFIELD RD.)	100%														100%
5.	2	4295	CREST HILL	IL ROUTE 7 (THEODORE ST.) AT IL ROUTE 7 (LARKIN AVE.)	97.5%			2.5%											100%
6.	12	4730	CREST HILL	IL ROUTE 7 (LARKIN AVE.) AT HILLCREST S.C.	95%			5%											100%
7.	5	7535	CREST HILL	IL ROUTE 7 (THEODORE ST.) AT ARBOR LANE	96.7%			3.3%											100%
8.	5	20561	CREST HILL	IL ROUTE 53 AT CATON FARM ROAD	96.7%			3.3%											100%
9.	5	7430	CREST HILL	US ROUTE 30 (PLAINFIELD RD.) AT CATON FARM ROAD	96.7%			3.3%											100%
10.	9	924	CRETE	IL ROUTE 1 (DIXIE HIGHWAY) AT CRETE-MONEE RD.	95%	2.5%			2.5%										100%
11.	8	7412	FRANKFORT	US ROUTE 45 AT LARAWAY ROAD	95%	5%													100%
12.	1	7609	LOCKPORT	IL ROUTE 171 (ARCHER AVENUE) AT I-355 NORTHBOUND RAMP	100%														100%
13.	1	7608	LOCKPORT	IL ROUTE 171 (ARCHER AVENUE) AT I-355 SOUTHBOUND RAMP	100%														100%
14.	13	7526	LOCKPORT	IL ROUTE 7 (159TH STREET) AT FARREL ROAD	95%					5%									100%
15.	13	7529	LOCKPORT	IL ROUTE 7 (159TH STREET) AT ADELMAN DRIVE	95%					5%									100%
16.	13	7521	LOCKPORT	IL ROUTE 7 (9TH STREET) AT 7TH STREET	95%					5%									100%
17.	13	7523	LOCKPORT	IL ROUTE 7 (9TH STREET) AT HAMILTON STREET	95%					5%									100%
18.	13	7522	LOCKPORT	IL ROUTE 7 (9TH STREET) AT MADISON STREET	95%					5%									100%
19.	2	7545	CREST HILL	IL ROUTE 53 AT DIVISION STREET	97.5%			2.5%											100%
20.	13	7524	LOCKPORT	IL ROUTE 7 (9TH STREET) AT LOCH LANE	95%					5%	2.5%								100%
21.	14	21895	NAPERVILLE	IL ROUTE 59 AT 95TH STREET	95%							5%							100%
22.	14	21893	NAPERVILLE	IL ROUTE 59 AT CANTORE ROAD	95%							5%							100%
23.	14	21465	NAPERVILLE	IL ROUTE 59 AT 103RD STREET	95%							5%							100%
24.	23	21860	NAPERVILLE	IL ROUTE 59 AT 111TH STREET	95%	2.5%						2.5%							100%
25.	1	7432	NEW LENOX	US ROUTE 6 AT 1355 EAST RAMP (B & D)	100%														100%
26.	15	7437	NEW LENOX	US ROUTE 30 AT PRAIRIE ROAD	95%								5%						100%
27.	15	7433	NEW LENOX	US ROUTE 6 AT CEDAR ROAD	95%								5%						100%
28.	1	7505	PLAINFIELD	US ROUTE 30 / IL ROUTE 59 AT IL ROUTE 126	100%														100%
29.	1	7588	PLAINFIELD	US ROUTE 30 / IL ROUTE 59 AT US ROUTE 30 / 143RD STREET	100%														100%
30.	6	7586	PLAINFIELD	US ROUTE 30 / IL ROUTE 59 AT PLAINFIELD-NAPERVILLE ROAD	96.7%									3.3%					100%
31.	16	21864	PLAINFIELD	IL ROUTE 59 AT 135TH STREET	95%									5%					100%
32.	16	7587	PLAINFIELD	IL ROUTE 59 AT MEIJER ACCESS	95%									5%					100%
33.	16	20972	PLAINFIELD	US ROUTE 30 AT 135TH STREET	95%									5%					100%
34.	22	21863	PLAINFIELD/WHEATLAND TWP	IL ROUTE 59 AT 119TH STREET	95%									2.5%			2.5%		100%
35.	22	21862	PLAINFIELD/WHEATLAND TWP	IL ROUTE 59 AT 127TH STREET	95%									2.5%			2.5%		100%
36.	4	7532	ROCKDALE	IL ROUTE 7 (LARKIN AVE.) AT MEADOW AVE. / FRONTAGE ROAD	97.5%											2.5%			100%
37.	17	7530	ROCKDALE	IL ROUTE 7 (LARKIN AVE.) AT MOEN AVENUE	95%											5%			100%
38.	10	20600	ROCKDALE	US ROUTE 6 AT BRANDON ROAD	95%	2.5%										2.5%			100%
39.	1	7405	ROCKDALE/JOLIET	IL ROUTE 7 (LARKIN AVE.) AT US ROUTE 6	100%														100%
40.	7	9130	ROMEDEVILLE	IL ROUTE 53 (INDEPENDENCE BLVD) AT TAYLOR ROAD	96.7%												3.3%		100%
41.	18	7567	ROMEDEVILLE	JOLIET ROAD AT BLUFF ROAD	95%												5%		100%
42.	1	7550	UNIVERSITY PARK	IL 50 (CICERO AVE.) AT GOVERNOR HIGHWAY	100%														100%
43.	19	21861	WHEATLAND TWP	IL ROUTE 59 AT ROYAL WORLINGTON DRIVE	95%													5%	100%
44.	19	21393	WHEATLAND TWP	US ROUTE 30 AT 111TH STREET	95%													5%	100%

FILE NAME *	USER NAME *	DESIGNED -	REVISED -	STATE OF ILLINOIS DEPARTMENT OF TRANSPORTATION	SUMMARY OF QUANTITIES (SHEET 1 OF 4)	P.A. RTE. VAR.	SECTION	COUNTY	TOTAL SHEETS	SHEET NO.		
c:\pwork\plndot\rosado\rosadoqzzy\08336	79\C121713-sht-15.dgn	DRAWN -	REVISED -				2013-004-1	WILL	58	5		
	PLOT SCALE: 48.8888' / in.	CHECKED -	REVISED -			SCALE:	SHEET	OF	SHEETS	STA.	TO	STA.
	PLOT DATE: 3/29/2013	DATE -	REVISED -						CONTRACT NO. 60W22			
										ILLINOIS FED. AID PROJECT		

Rev. 6-4-13

Rev.

0710 0710(1) 0720(2) 0720(3) 0720(4) 0720(5) 0720(6) 0720(7) 0720(8) 0720(9) 0720(10) 0720(11) 0720(12) 0720(13) 0720(14) 0720(15) 0720(16)

CODE NO.	ITEM	UNIT	TOTAL QUANTITY	CONSTRUCTION CODE																						
				TRAFFIC SIGNAL																						
				0021 URBAN																						
1	2	3	4	5	6	7	8	9	10	11	12	13	14	15	16	17	18	19	20	21	22	23				
67000400	ENGINEER'S FIELD OFFICE, TYPE A	CAL MO	2	2																						
67100100	MOBILIZATION	L SUM	1	1																						
70102635	TRAFFIC CONTROL AND PROTECTION, STANDARD 701701	L SUM	1	1																						
81028200	UNDERGROUND CONDUIT, GALVANIZED STEEL, 2" DIA.	FOOT	15		15																					
85000200	MAINTENANCE OF EXISTING TRAFFIC SIGNAL INSTALLATION	EACH	43	82		1	3	1	1	2	1	1	1	1	6	3	2	3	1	1	2	+	+	2	1	
87502480	TRAFFIC SIGNAL POST, GALVANIZED STEEL 14 FT.	EACH	5	2											3											
87502500	TRAFFIC SIGNAL POST, GALVANIZED STEEL 16 FT.	EACH	5	2											3											
88030010	SIGNAL HEAD, LED, 1-FACE, 1-SECTION, MAST-ARM MOUNTED	EACH	1	1																						
88030012	SIGNAL HEAD, LED, 1-FACE, 1-SECTION, BRACKET MOUNTED	EACH	1	1																						
88030020	SIGNAL HEAD, LED, 1-FACE, 3-SECTION, MAST-ARM MOUNTED	EACH	6	1	2																3					
88030050	SIGNAL HEAD, LED, 1-FACE, 3-SECTION, BRACKET MOUNTED	EACH	8	3	1										4											
88030100	SIGNAL HEAD, LED, 1-FACE, 5-SECTION, BRACKET MOUNTED	EACH	3		1																	2				
88030110	SIGNAL HEAD, LED, 1-FACE, 5-SECTION, MAST-ARM MOUNTED	EACH	11		4										2							5				
88030210	SIGNAL HEAD, LED, 2-FACE, 3-SECTION, BRACKET MOUNTED	EACH	2												2											

Rev. 6-3-13



CODE NO.	ITEM	UNIT	TOTAL QUANTITY	CONSTRUCTION CODE																							
				TRAFFIC SIGNAL																							
				0021																							
				URBAN																							
1	2	3	4	5	6	7	8	9	10	11	12	13	14	15	16	17	18	19	20	21	22						
88030220	SIGNAL HEAD, LED, 2-FACE, 5-SECTION, BRACKET MOUNTED	EACH	2		1																	1					
88030240	SIGNAL HEAD, LED, 2-FACE, 1-3 SECTION, 1-5 SECTION, BRACKET MOUNTED	EACH	6		3							2										1					
88055150	OPTICALLY PROGRAMMED SIGNAL HEAD, LED, 1-FACE, 3-SECTION, BRACKET MOUNTED	EACH	2	2																							
88055160	OPTICALLY PROGRAMMED SIGNAL HEAD, LED, 1-FACE, 3-SECTION, MAST ARM MOUNTED	EACH	2	2																							
88102717	PEDESTRIAN SIGNAL HEAD, LED, 1-FACE, BRACKET MOUNTED WITH COUNTDOWN TIMER	EACH	42			4		6				24	2	2	4							8					
88102747	PEDESTRIAN SIGNAL HEAD, LED, 2-FACE, BRACKET MOUNTED WITH COUNTDOWN TIMER	EACH	18	1				2		4		6	2	2	1												
88102757	PEDESTRIAN SIGNAL HEAD, LED, 3-FACE, BRACKET MOUNTED WITH COUNTDOWN TIMER	EACH	2	2																							
88200210	TRAFFIC SIGNAL BACKPLATE, LOUVERED, ALUMINUM	EACH	18	4	6																	8					
88800100	PEDESTRIAN PUSH-BUTTON	EACH	20					2				16		2								8					
89502210	MODIFY EXISTING CONTROLLER CABINET	EACH	43	8	2		1	3	1	1	2	1	1	1	1	1	6	3	2	3	1	1	2	+	2	2	1
89502375	REMOVE EXISTING TRAFFIC SIGNAL EQUIPMENT	EACH	24	3	1		1		1	2		1	1	1	5	2	1	2	1	1	1	1	+				
X8620050	UNINTERRUPTABLE POWER SUPPLY, GROUND MOUNTED	EACH	1	1																							
X8620200	UNINTERRUPTABLE POWER SUPPLY, SPECIAL	EACH	40	7	2		1	3	1	1	2	1	1	1	1	5	3	1	3	1	1	2	+	2	2	1	
X8803038	SIGNAL HEAD, LED, 2-FACE, 1-3 SECTION, 1-4 SECTION, BRACKET MOUNTED, RETROFIT	EACH	1	1																							

23

FILE NAME *	USER NAME *	DESIGNED -	REVISED -
21\pwr\work\p\1dot\rosadovazquez\140338	rosadovazquez	78\0121713-gnt-15.dgn	
MODEL NAME *	PLOT SCALE = 1/8" = 1' / in.	CHECKED -	REVISED -
	PLOT DATE = 3/29/2013	DATE -	REVISED -

STATE OF ILLINOIS  
DEPARTMENT OF TRANSPORTATION

SUMMARY OF QUANTITIES (SHEET 3 OF 4)			
SCALE:	SHEET	OF	SHEETS
	STA.	TO	STA.

F.A. RTE.	SECTION	COUNTY	TOTAL SHEETS	SHEET NO.
VAR	2013-004-1	WILL	58	7
			CONTRACT NO. 60W22	
ILLINOIS FED. AID PROJECT				

Rev. 6-4-13 Rev.

