

SOUTH EDGE OF APPROACH SLAB

Location	Station	Offset	Theoretical Grade Elevations
E. End of E. Appr. Pvmf.	98+88.04	-24.77	600.61
A	98+98.04	-24.77	600.81
B	99+08.04	-24.77	601.01
W. End of E. Appr. Pvmf.	99+18.04	-24.77	601.19
E. End of W. Appr. Pvmf.	100+88.04	-24.77	601.56
C	100+98.04	-24.77	601.46
D	101+08.04	-24.77	601.36
W. End of W. Appr. Pavmt.	101+18.04	-24.77	601.26

SOUTH EDGE OF ROADWAY

Location	Station	Offset	Theoretical Grade Elevations
E. End of E. Appr. Pvmf.	98+86.96	-16.00	600.73
A	98+96.96	-16.00	600.93
B	99+06.96	-16.00	601.13
W. End of E. Appr. Pvmf.	99+16.96	-16.00	601.31
E. End of W. Appr. Pvmf.	100+86.96	-16.00	601.70
C	100+96.96	-16.00	601.61
D	101+06.96	-16.00	601.51
W. End of W. Appr. Pavmt.	101+16.96	-16.00	601.41

☉ PROPOSED BRIDGE STREET & P.G.L.

Location	Station	Offset	Theoretical Grade Elevations
E. End of E. Appr. Pvmf.	98+85.00	0.00	600.94
A	98+95.00	0.00	601.14
B	99+05.00	0.00	601.34
W. End of E. Appr. Pvmf.	99+15.00	0.00	601.52
E. End of W. Appr. Pvmf.	100+85.00	0.00	601.97
C	100+95.00	0.00	601.87
D	101+05.00	0.00	601.78
W. End of W. Appr. Pavmt.	101+15.00	0.00	601.68

STAGE CONSTRUCTION LINE

Location	Station	Offset	Theoretical Grade Elevations
E. End of E. Appr. Pvmf.	98+85.29	-2.35	600.91
A	98+95.29	-2.35	601.11
B	99+05.29	-2.35	601.31
W. End of E. Appr. Pvmf.	99+15.29	-2.35	601.49
E. End of W. Appr. Pvmf.	100+85.29	-2.35	601.93
C	100+95.29	-2.35	601.84
D	101+05.29	-2.35	601.74
W. End of W. Appr. Pavmt.	101+15.29	-2.35	601.64

NORTH EDGE OF ROADWAY

Location	Station	Offset	Theoretical Grade Elevations
E. End of E. Appr. Pvmf.	98+83.04	16.00	600.65
A	98+93.04	16.00	600.85
B	99+03.04	16.00	601.05
W. End of E. Appr. Pvmf.	99+13.04	16.00	601.24
E. End of W. Appr. Pvmf.	100+83.04	16.00	601.74
C	100+93.04	16.00	601.64
D	101+03.04	16.00	601.55
W. End of W. Appr. Pavmt.	101+13.04	16.00	601.45

NORTH EDGE OF APPROACH SLAB

Location	Station	Offset	Theoretical Grade Elevations
E. End of E. Appr. Pvmf.	98+82.00	24.40	600.50
A	98+92.00	24.40	600.70
B	99+02.00	24.40	600.90
W. End of E. Appr. Pvmf.	99+12.00	24.40	601.09
E. End of W. Appr. Pvmf.	100+82.00	24.40	601.62
C	100+92.00	24.40	601.52
D	101+02.00	24.40	601.43
W. End of W. Appr. Pavmt.	101+12.00	24.40	601.33

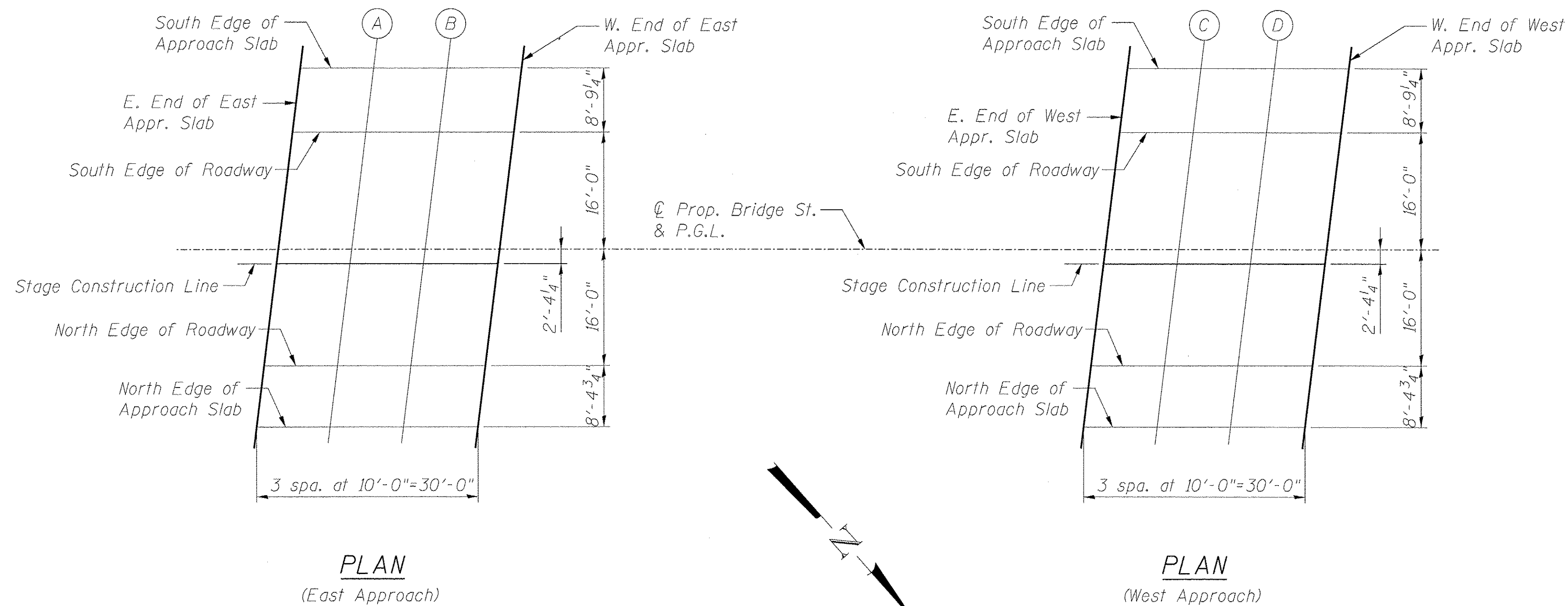

**benesch**  
engineers · scientists · planners

Alfred Benesch & Company  
205 North Michigan Avenue, Suite 2400  
Chicago, Illinois 60601  
312-565-0450 Job No. 10055.02

FILE NAME =	USER NAME = eship	DESIGNED - MJF	REVISED -
0166953.011.ApprSlabEL1.dgn		CHECKED - JHG	REVISED -
	PLOT SCALE =	DRAWN - RMG	REVISED -
	PLOT DATE = 2/19/2013	CHECKED - JHG	REVISED -

**STATE OF ILLINOIS**  
**DEPARTMENT OF TRANSPORTATION**

**TOP OF APPROACH SLAB ELEVATIONS**  
**STRUCTURE NO. 016-6953 BRIDGE ST. OVER THE NORTH SHORE CHANNEL**

SHEET NO. S11 OF S50 SHEETS

F.A.I. RTE.	SECTION	COUNTY	TOTAL SHEETS	SHEET NO.
	08-00251-00-BR	COOK	118	64
ILLINOIS FED. AID PROJECT			CONTRACT NO. 63817	

X:\100005\10055.02\Eng\_Docs\_Phase\_II\Bridg.Street\_016-6953\Final\0166953.011-ApprSlabEL1.dgn 2:50:34 PM 2/19/2013