

EXISTING HORIZONTAL & VERTICAL CONTROL

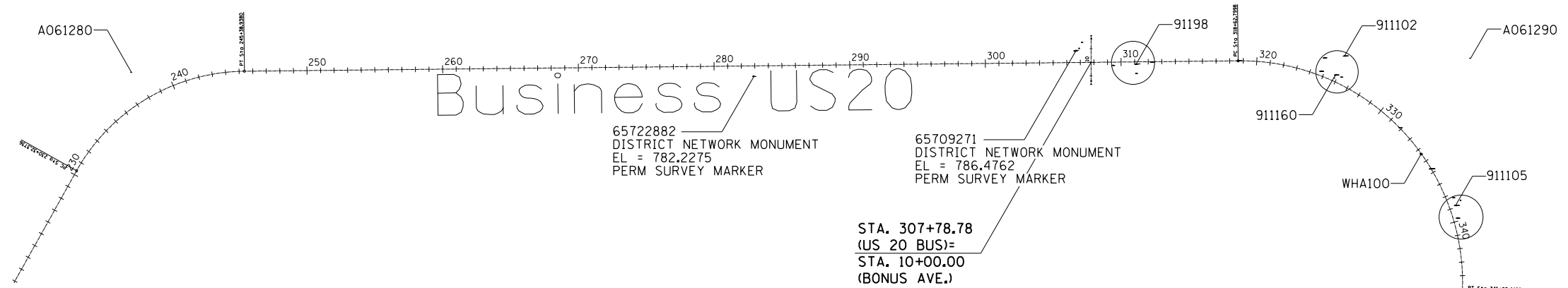

Chain US20BUS contains:
 A06110 CUR A061250 A08028 CUR A061260 A061370 CUR A061280 CUR A061290 CUR A061-
 300 A06113 CUR A061310 A061360

Beginning chain US20BUS description

Point A061370 N 2,042,205.9634 E 841,409.5612 Sta 220+84.4181
 Course from A061370 to PC A061280 29° 11' 20.4292" Dist 947.9555'

Curve Data

Curve A061280
 P.I. Station 238+63.5926 N 2,043,759.2106 E 842,277.2507
 Delta = 60° 12' 31.9807" (RT)
 Degree = 3° 59' 47.1700"
 Tangent = 831.2190'
 Length = 1,506.5644'
 Radius = 1,433.6718'
 External = 223.5366'
 Long Chord = 1,438.1960'
 Mid. Ord. = 193.3844'
 P.C. Station 230+32.3736 N 2,043,033.5434 E 841,871.8716
 P.T. Station 245+38.9380 N 2,043,767.9455 E 843,108.4238
 C.C. N 2,042,334.3528 E 843,123.4896

Course from PT A061280 to PC A061290 89° 23' 52.4098" Dist 7,323.8618'

Curve Data

Curve A061290
 P.I. Station 335+75.8936 N 2,043,862.9111 E 852,144.8804
 Delta = 92° 36' 28.8817" (RT)
 Degree = 3° 30' 01.4143"
 Tangent = 1,713.0938'
 Length = 2,645.6465'
 Radius = 1,636.8385'
 External = 732.5350'
 Long Chord = 2,366.9193'
 Mid. Ord. = 506.0584'
 P.C. Station 318+62.7998 N 2,043,844.9089 E 850,431.8812
 P.T. Station 345+08.4463 N 2,042,150.8670 E 852,084.9176
 C.C. N 2,042,208.1607 E 850,449.0820

Course from PT A061290 to PC A061300 182° 00' 21.2916" Dist 5,119.2313'

Curve Data

Curve A061300
 P.I. Station 405+26.8687 N 2,036,136.1326 E 851,874.2568
 Delta = 4° 29' 38.1807" (LT)
 Degree = 0° 15' 00.0578"
 Tangent = 899.1911'
 Length = 1,797.4602'
 Radius = 22,916.8395'
 External = 17.6341'
 Long Chord = 1,796.9994'
 Mid. Ord. = 17.6205'
 P.C. Station 396+27.6776 N 2,037,034.7727 E 851,905.7309
 P.T. Station 414+25.1377 N 2,035,237.7892 E 851,913.2912
 C.C. N 2,036,232.6224 E 874,808.5273

Course from PT A061300 to A06113 177° 30' 43.1109" Dist 302.4899'

Point A06113 N 2,034,935.5845 E 851,926.4224 Sta 417+27.6276

Course from A06113 to PC A061310 180° 29' 49.5479" Dist 3,870.5426'

Curve Data

Curve A061310
 P.I. Station 457+45.1358 N 2,030,918.2275 E 851,891.5671
 Delta = 17° 00' 20.4922" (LT)
 Degree = 5° 49' 42.4319"
 Tangent = 146.9656'
 Length = 291.7702'
 Radius = 983.0357'
 External = 10.9251'
 Long Chord = 290.7005'
 Mid. Ord. = 10.8050'
 P.C. Station 455+98.1702 N 2,031,065.1875 E 851,892.8421
 P.T. Station 458+89.9405 N 2,030,777.3202 E 851,933.3287
 C.C. N 2,031,056.6588 E 852,875.8409

Course from PT A061310 to A061360 163° 29' 29.0556" Dist 10.0370'

Point A061360 N 2,030,767.6970 E 851,936.1808 Sta 458+99.9775

Ending chain US20BUS description

CURVE POINT NUMBERS					
CHAIN	CURVE	PI	CC	PC	PT
US20BUS	A061260	061260	61261	61262	61263
US20BUS	A061280	061280	61281	61282	61283
US20BUS	A061290	061290	61291	61292	61293
US20BUS	A061300	061300	61301	61302	61303
US20BUS	A061310	061310	61311	61312	61313

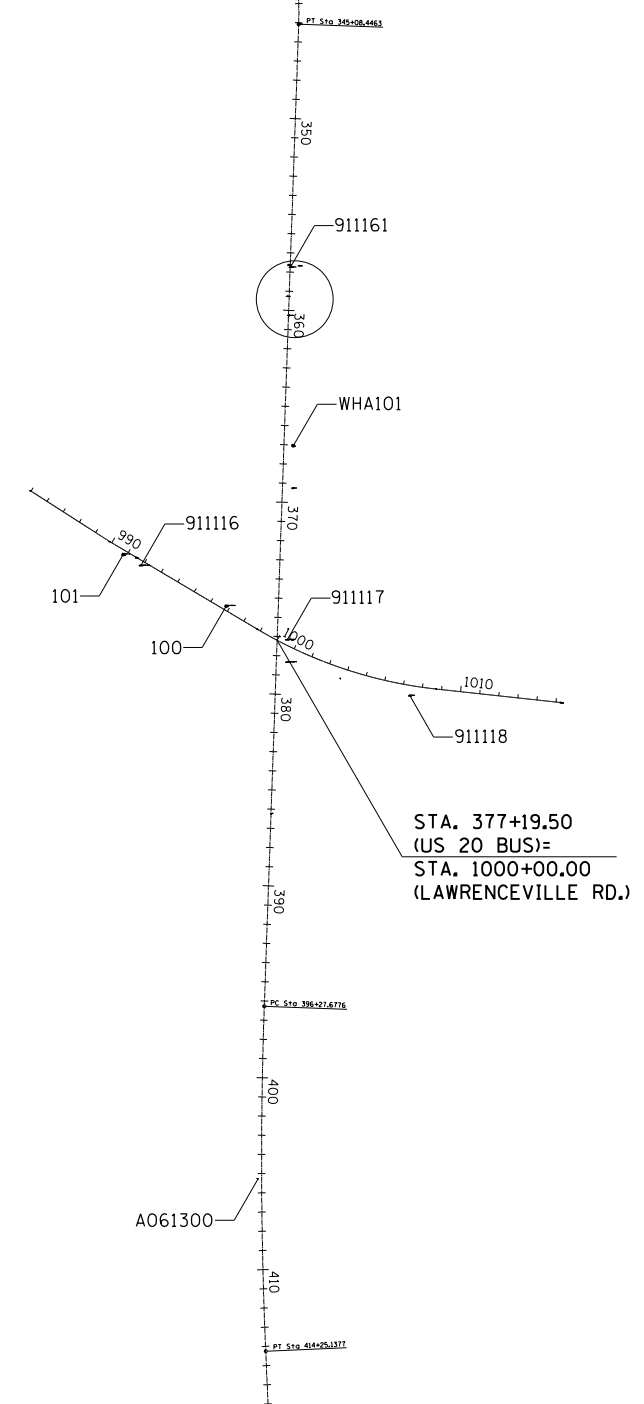

FILE NAME =	USER NAME = rundbladerr	DESIGNED -	REVISED -
et:\pw\work\p\dot\rundbladerr\d0275077	D206211-sh1-hvc.dgn	DRAWN -	REVISED -
Default	PLOT SCALE = 1000.0000 ' / in.	CHECKED -	REVISED -
	PLOT DATE = Fri Mar 15 13:38:17 2013	DATE -	REVISED -

**STATE OF ILLINOIS
 DEPARTMENT OF TRANSPORTATION**

**US BUS 20
 HORIZONTAL & VERTICAL CONTROL**

SCALE: SHEET OF SHEETS STA. TO STA.

F.A.P. RTE.	SECTION	COUNTY	TOTAL SHEETS	SHEET NO.
517	IR	BOONE	126	18
CONTRACT NO. 64C97				
ILLINOIS FED. AID PROJECT				