

PLAN	SURVEYED	DATE
	PLOTTED	
	ALIGNED	
	CHECKED	
	FILED	
	NO.	
	BY	

PROFILE	SURVEYED	DATE
	PLOTTED	
	GRADES	
	CHECKED	
	STRUCTURE	
	NOTATIONS	
	CHKD	
	NO.	
	BY	

EXIST. CURVE A061290  
 PI STA. = 335+75.89  
 $\Delta = 92^\circ 36' 29''$  (RT)  
 $D = 3^\circ 30' 01''$   
 $R = 1,636.84'$   
 $T = 1,713.09'$   
 $L = 2,645.65'$   
 $E = 732.53'$   
 $S.E. = 5.70\%$   
 $T.R.M.L. = 35'$   
 $S.E. RUN (L.M.L.) = 231'$   
 $P.C. STA. = 318+62.80$   
 $P.T. STA. = 345+08.45$   
 Normal Crown STA 316+73.80  
 Full S.E. STA 319+39.80  
 Full S.E. STA 344+31.45  
 Normal Crown STA 346+97.45

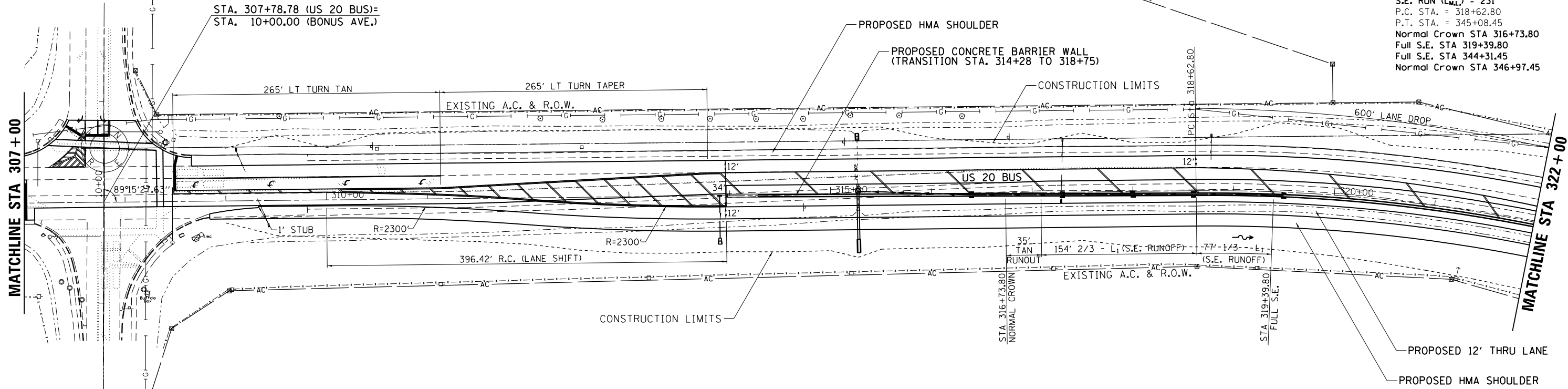

NOTE:  
 PIPE UNDERDRAIN, 6" RUNS FROM  
 STA. 313+96 TO 360+50. UNDERDRAINS  
 WILL BE PLACED UNDER THE SUBGRADE  
 UNDERNEATH THE BARRIER WALL AND  
 OUTLET INTO THE MEDIAN DRAINAGE STRUCTURES.

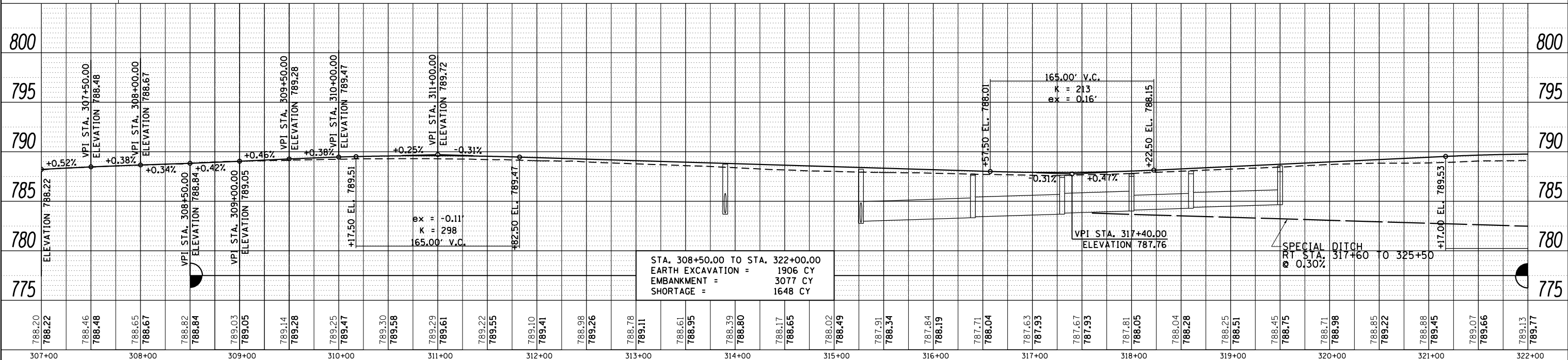
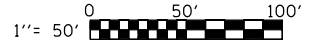

FILE NAME =	USER NAME = rdnbladerr	DESIGNED -	REVISED -	<b>STATE OF ILLINOIS DEPARTMENT OF TRANSPORTATION</b>	<b>US 20 BUS</b>	F.A.P. RE.	SECTION	COUNTY	TOTAL SHEETS	SHEET NO.	
Default	Plot Scale = 100.0000' / in.	CHECKED -	REVISED -			517	IR	BOONE	37	37	
	PLOT DATE = Fri May 15 13:38:30 2013	DATE -	REVISED -			CONTRACT NO. 64C97					
ILLINOIS FED. AID PROJECT											