

EXIST. CURVE A061290
 PI STA. = 335+75.89
 $\Delta = 92^\circ 36' 29''$ (RT)
 $D = 3^\circ 30' 01''$
 $R = 1,636.84'$
 $T = 1,713.09'$
 $L = 2,645.65'$
 $E = 732.53'$
 $S.E. = 5.70\%$
 $T.R.M.L. = 35'$
 $S.E. RUN (L.M.L.) = 231'$
 P.C. STA. = 318+62.80
 P.T. STA. = 345+08.45
 Normal Crown STA 316+73.80
 Full S.E. STA 319+39.80
 Full S.E. STA 344+31.45
 Normal Crown STA 346+97.45

PLAN	SURVEYED	DATE
	PLOTTED	
	ALIGNED	
	CHECKED	
	FILE NAME	
	NO.	

PROFILE	SURVEYED	DATE
	PLOTTED	
	GRADES CHECKED	
	STRUCTURE NOTATIONS CHECKED	
	NO.	

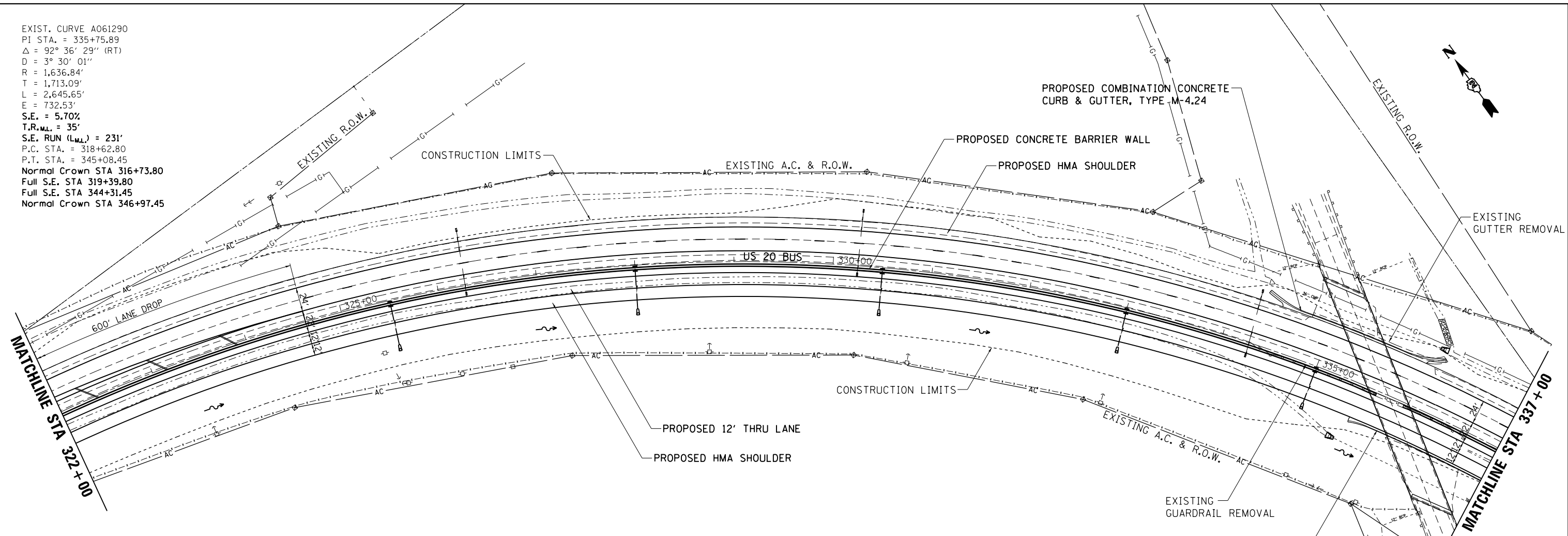

NOTE:
 PIPE UNDERDRAIN, 6" RUNS FROM STA. 313+96 TO 360+50. UNDERDRAINS WILL BE PLACED UNDER THE SUBGRADE UNDERNEATH THE BARRIER WALL AND OUTLET INTO THE MEDIAN DRAINAGE STRUCTURES.

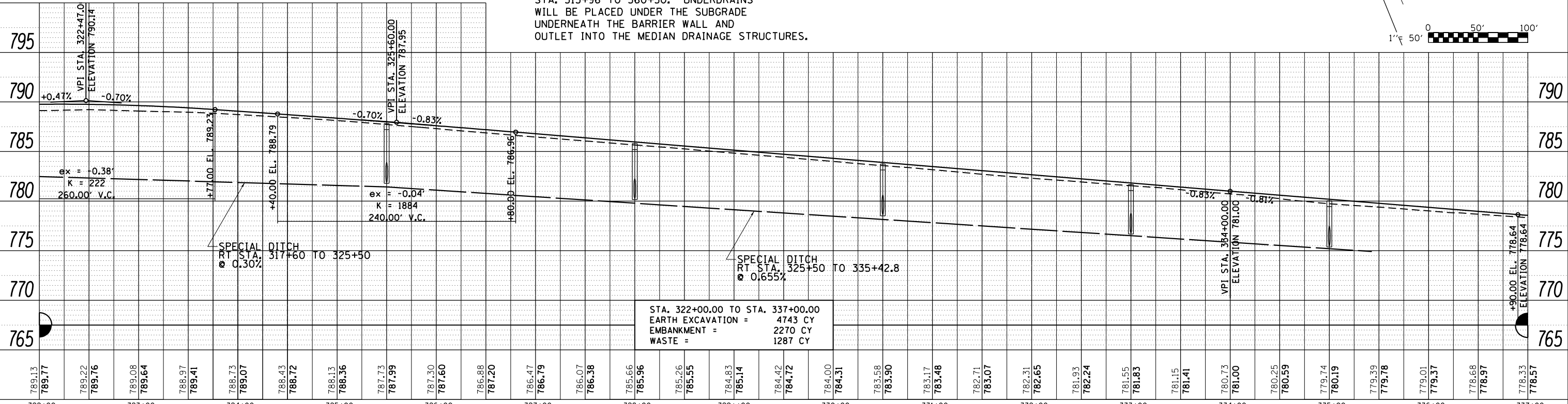

FILE NAME =	USER NAME = rundbladerr	DESIGNED -	REVISED -	STATE OF ILLINOIS DEPARTMENT OF TRANSPORTATION	US 20 BUS	F.A.P. RT. 517	SECTION IR	COUNTY BOONE	TOTAL SHEETS 126	SHEET NO. 38
Default	PLOT SCALE = 100.0000' / in.	CHECKED -	REVISED -			CONTRACT NO. 64C97				
	PLOT DATE = Fri May 15 13:38:35 2013	DATE -	REVISED -			ILLINOIS FED. AID PROJECT				
						SCALE:	SHEET OF SHEETS STA. TO STA.			