

# STAGE 1

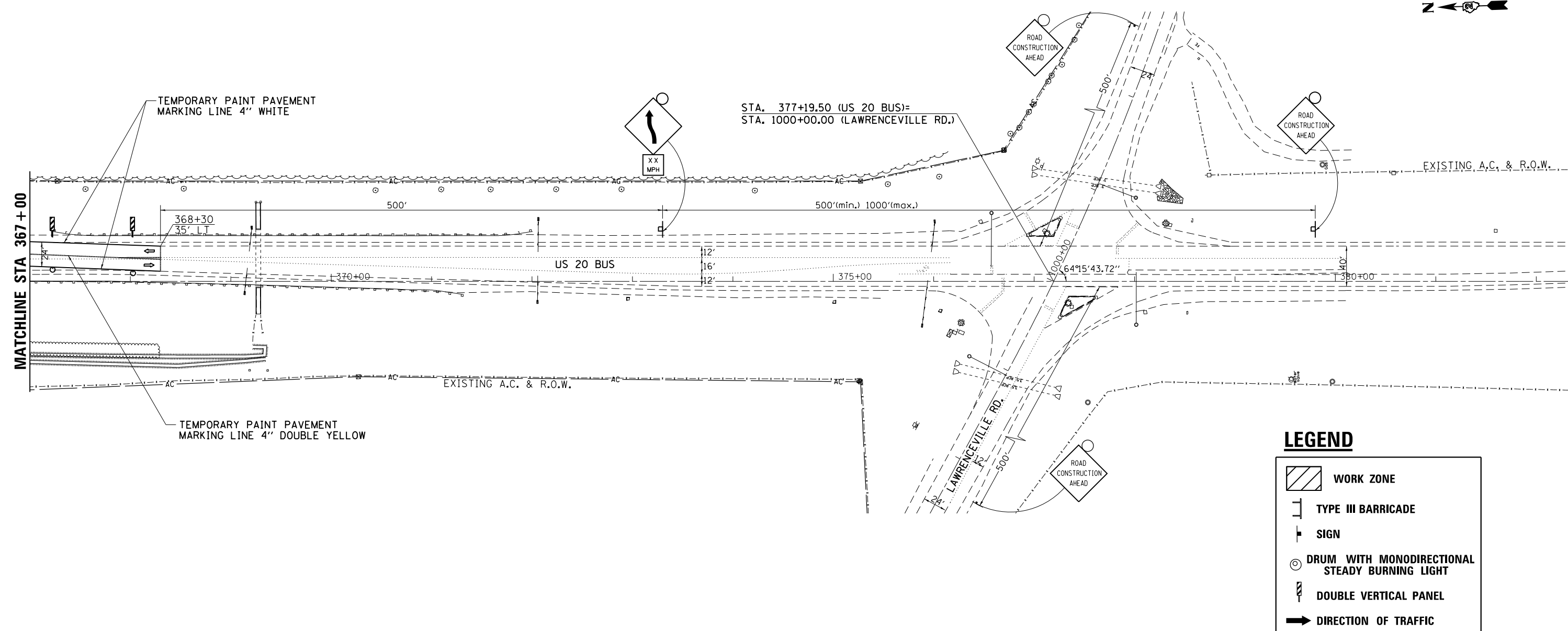

# STAGE 2

STAGE 2 NOTES:  
STA. 300+97 TO 366+75

1. SETUP & USE TRAFFIC CONTROL & PROTECTION 701201, 701421, & TRAFFIC CONTROL AT TRANSITION AREAS (DIST. STD 38.1)
2. MILL THROUGH BONUS AVE
3. PLACE THE VARIABLE DEPTH LEVELING BINDER (MACHINE METHOD)
4. PLACE THE POLYMERIZED LEVELING BINDER (MACHINE METHOD), N70, & POLYMERIZED HOT-MIX ASPHALT SURFACE COURSE, MIX "F", N70



FILE NAME =	USER NAME = rundbladerr	DESIGNED -	REVISED -	<b>STATE OF ILLINOIS DEPARTMENT OF TRANSPORTATION</b>	<b>US 20 BUS STAGING DETAIL</b>			F.A.P. RTE.	SECTION	COUNTY	TOTAL SHEETS	SHEET NO.
Default	Plot Date = Fri May 15 13:38:41 2013	DRAWN -	REVISED -					517	IR	BOONE	126	46
		CHECKED -	REVISED -		CONTRACT NO. 64C97							
		DATE -	REVISED -		SCALE:	SHEET	OF	SHEETS	STA.	TO	STA.	ILLINOIS FED. AID PROJECT