

- NOTES:**
1. ALL TEMPORARY PAVEMENT MARKINGS SHALL BE PAINT.
  2. INSTALL TEMPORARY RUMBLE STRIP. SEE STD. 701321 FOR ADDITIONAL INFORMATION.
  3. BARRIER WALL OFFSETS ARE TO TRAFFIC SIDE OF BARRIER WALL.
  4. PERMANENT PAVEMENT MARKINGS SHALL BE DONE IN STAGE III.

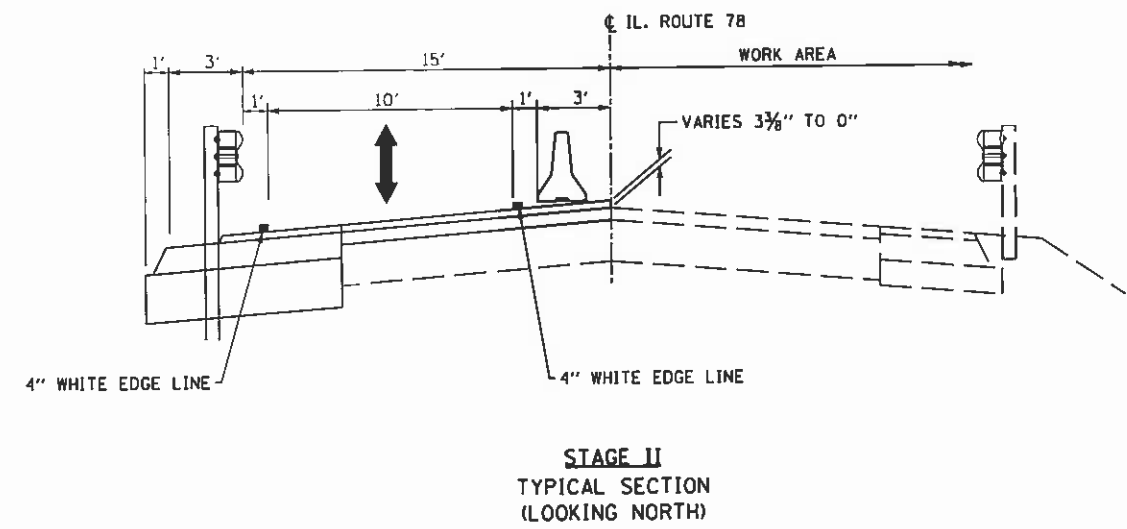

**TRAFFIC CONTROL AND STAGING LEGEND**

- WORK ZONE
- DIRECTION OF TRAFFIC
- TEMPORARY CONCRETE BARRIER
- TYPE III BARRICADES WITH FLASHING LIGHTS
- BARRICADES, TYPE II OR DRUMS WITH STEADY BURNING BI-DIRECTIONAL LIGHTS @ 25' c-c.
- DOUBLE VERTICAL PANELS @ 25' c-c.
- SIGN ON PORTABLE OR PERMANENT SUPPORT
- PAVEMENT MARKING REMOVAL
- TRAFFIC SIGNAL

FILE NAME = D264J95-shl-mot-Stage2.dgn  
 USER NAME = JDOT  
 PLOT SCALE = 1/8" = 1'-0"  
 PLOT DATE = 3/15/2013

**CHRISTIAN-ROGE & ASSOCIATES, INC.**  
 ENGINEERS-PLANNERS-SURVEYORS  
 211 WEST WACKER DRIVE  
 CHICAGO, ILLINOIS 60606  
 PHONE: (312)372-2023 FAX: (312)372-5274

DESIGNED - M.P.	REVISED -
DRAWN - B.X.	REVISED -
CHECKED - G.F.L.	REVISED -
DATE - JANUARY, 2013	REVISED -

**STATE OF ILLINOIS  
 DEPARTMENT OF TRANSPORTATION**

**TRAFFIC CONTROL AND PROTECTION - STAGE II  
 IL ROUTE 78 OVER EAST FORK PLUM RIVER**

SCALE: SHEET NO. OF SHEETS STA. 30+39.41 TO STA. 34+48

F.A.I.L. R.T.E.	SECTION	COUNTY	TOTAL SHEETS	SHEET NO.
642	D2 DECK REPAIR 2013-4	CARROLL	25	10
CONTRACT NO. 64J55				
FED. ROAD DIST. NO. 1 (ILLINOIS) FED. AID PROJECT				