

BILL OF MATERIAL

Bar	No.	Size	Length	Shape
a ₁ (E)	140	#5	17'-6"	C
b(E)	93	#5	24'-11"	—
Concrete Wearing Surface, 5"		Sq Yd	223	
Reinforcement Bars, Epoxy Coated		Pound	4,970	
Bar Splicers		Each	70	

Bars indicated thus 3lx3-#5 etc., indicates 31 lines of bars with 3 lengths per line

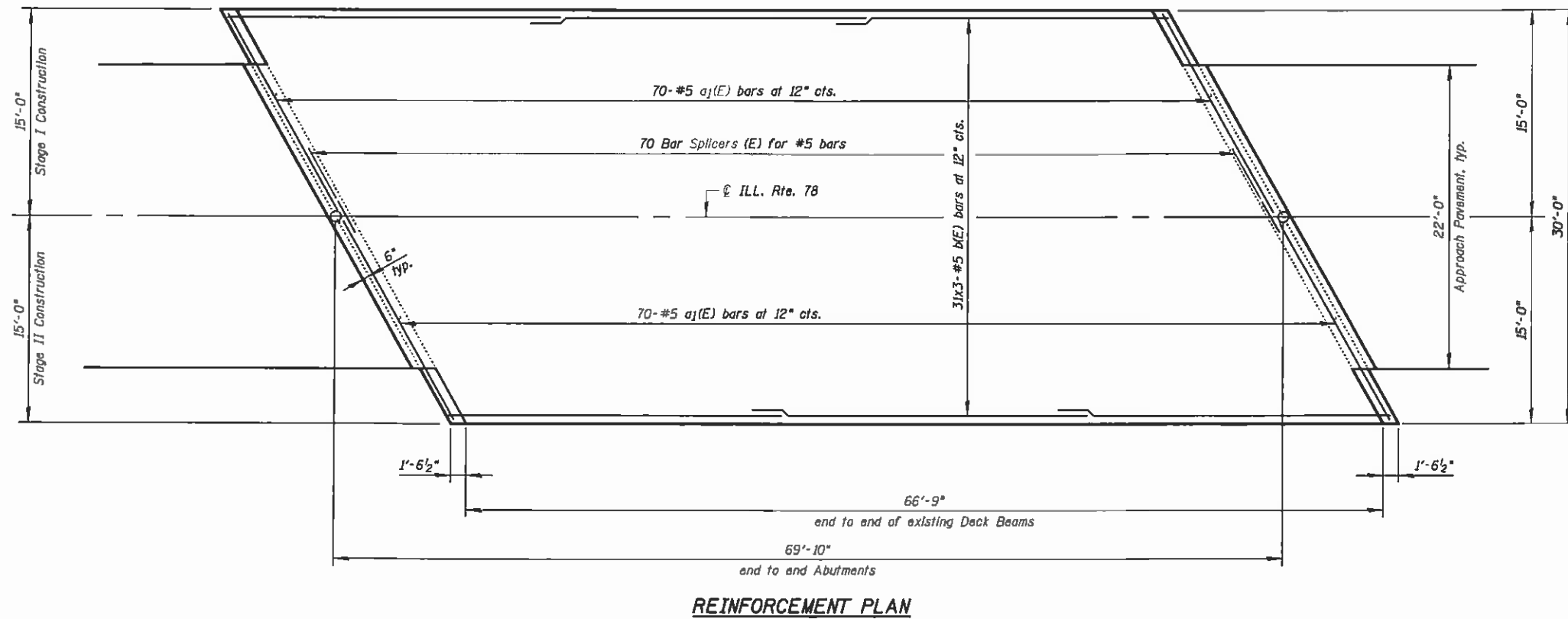
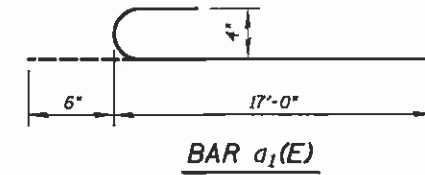

MIN. BAR LAP:
#5 bars = 2'-7"

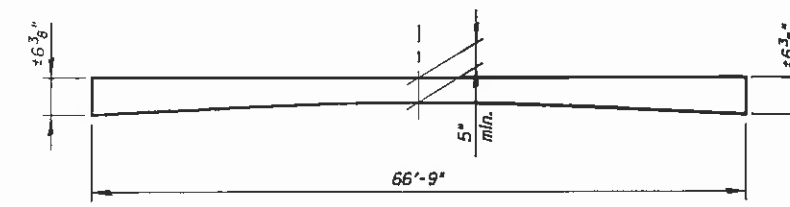

REINFORCED CONCRETE WEARING SURFACE PROFILE
(Proposed)

FILE NAME = I:\02709_Plum River\Structural\CADD Sheets\0264J55-04-reinf-plan.dgn

CHRISTIAN-ROGE & ASSOCIATES, INC.

USER NAME = IDDT	DESIGNED - B.N.S./J.W./H.S.J.	REVISED -
PLOT SCALE = 50,0001' / 1"	CHECKED - B.N.S./H.S.J./J.W.	REVISED -
PLOT DATE = 3/7/2013	DRAWN - F.M.	REVISED -
	DATE - MARCH, 2013	REVISED -

**STATE OF ILLINOIS
DEPARTMENT OF TRANSPORTATION**

**REINFORCEMENT PLAN
STRUCTURE NO. 008-0035**

SHEET NO. 54 OF 57 SHEETS

F.A.P. RTE.	SECTION	COUNTY	TOTAL SHEETS	SHEET NO.
642	D2 DECK REPAIR 2013-4	CARROLL	25	17
CONTRACT NO. 64J55			ILLINOIS FED. AID PROJECT	