

STATE OF ILLINOIS
DEPARTMENT OF TRANSPORTATION

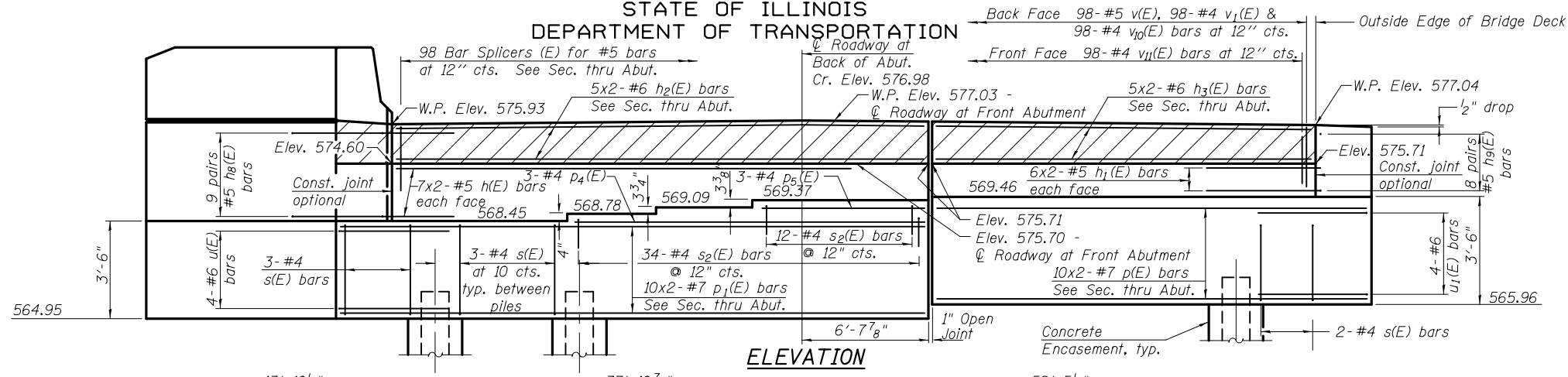

ELEVATION

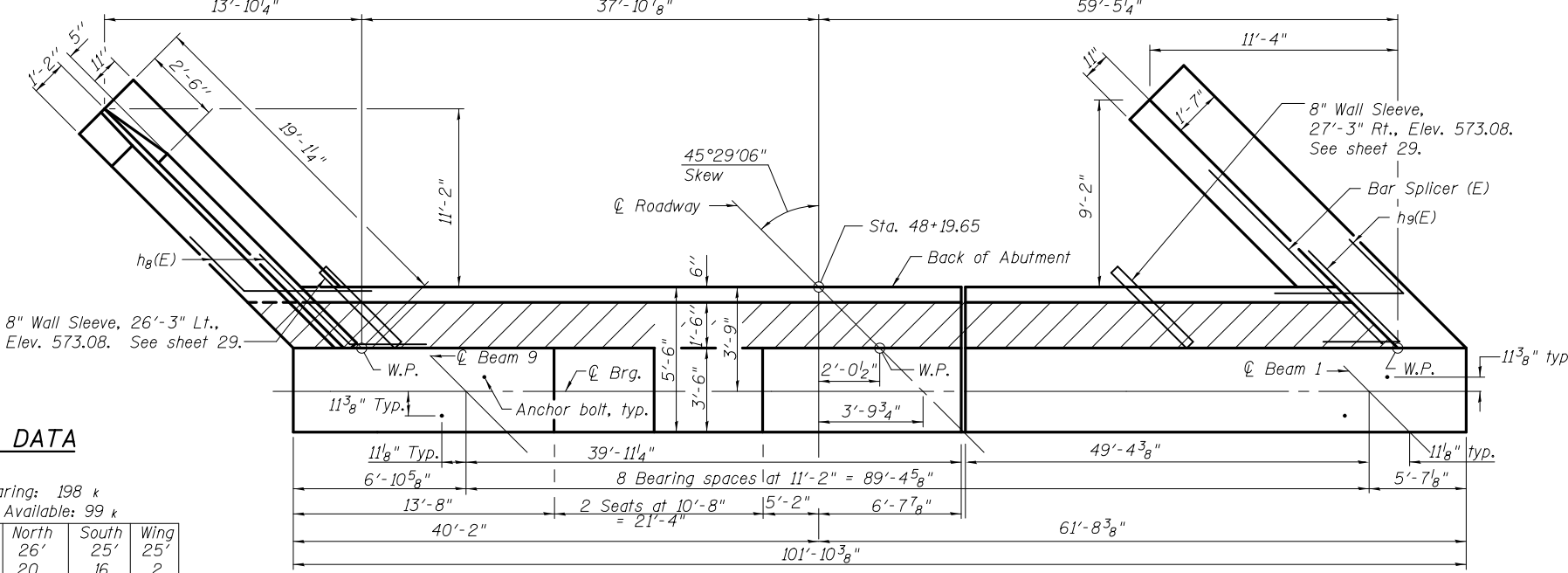

TOP VIEW

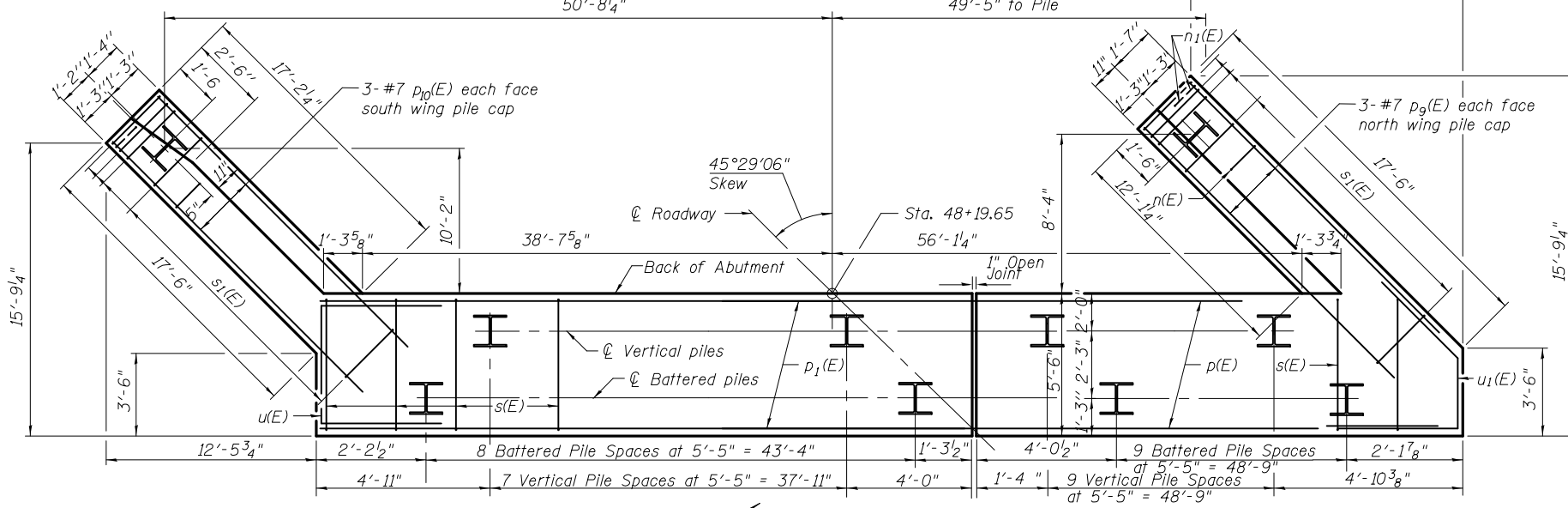

PLAN-PILE CAP

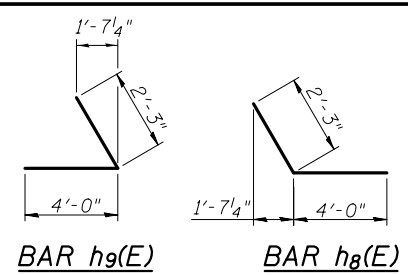

BAR h9(E) BAR h8(E)

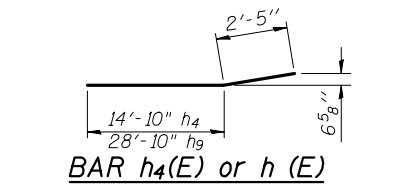

BAR h4(E) or h(E)

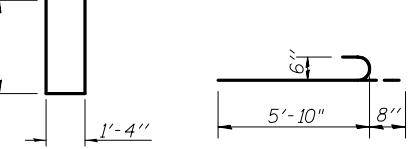

BAR n(E) BAR n1(E)

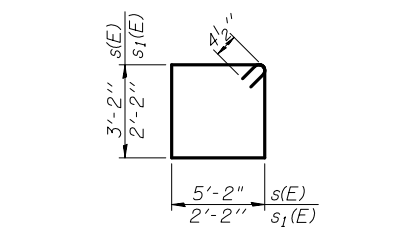

BARS s(E) & s1(E)

BAR s2(E)

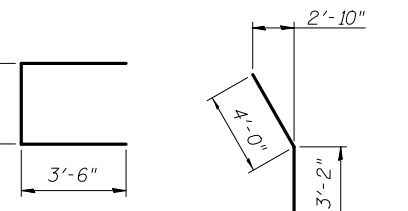

BAR u(E) BAR u1(E)

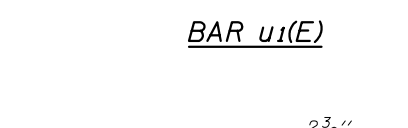

BAR v1(E) BAR v3(E) BAR v4(E)

Minimum Lap Lengths		
Bar Size	Length	Top Bar
#4	1'-8"	
#5	2'-2"	
#5 Top Bar	3'-0"	h, h1
#6	2'-7"	
#7	3'-5"	
#7 Top Bar	4'-10"	p, p1

ABUTMENT
BILL OF MATERIAL

Bar	No.	Size	Length	Shape
h(E)	28	#5	24'-9"	
h1(E)	24	#5	27'-8"	
h2(E)	10	#6	24'-3"	
h3(E)	10	#6	28'-4"	
h8(E)	18	#5	6'-3"	
h9(E)	16	#5	6'-3"	
h10(E)	10	#4	17'-3"	
h11(E)	8	#4	18'-7"	
h12(E)	2	#4	18'-1"	
h13(E)	8	#4	16'-10"	
h14(E)	8	#4	15'-8"	
n(E)	34	#6	13'-0"	
n1(E)	6	#6	6'-6"	
p(E)	20	#7	29'-9"	
p1(E)	20	#7	25'-9"	
p4(E)	3	#4	32'-10"	
p5(E)	3	#4	11'-6"	
p9(E)	6	#7	17'-2"	
p10(E)	6	#7	18'-4"	
s(E)	113	#4	17'-5"	
s1(E)	49	#4	9'-5"	
s2(E)	46	#4	10'-0"	
u(E)	4	#6	12'-1"	
u1(E)	4	#6	10'-8"	
v(E)	98	#5	4'-2"	
v1(E)	98	#4	4'-9"	
v2(E)	19	#6	9'-6"	
v3(E)	3	#6	9'-6"	
v4(E)	16	#6	9'-8"	
v5(E)	34	#6	6'-9"	
v10(E)	98	#4	7'-0"	
v11(E)	98	#4	8'-7"	
Structure Excavation			Cu. Yd.	437
Concrete Structures			Cu. Yd.	147.8
Reinforcement Bars, Epoxy Coated			Pound	11,070
Furnishing Steel Piles HP 10 x 42			Foot	970
Driving Piles			Foot	970
Test Pile Steel HP 10 x 42			Each	1
Concrete Encasement			Cu. Yd.	14
Concrete Sealer			Sq. Ft.	1196

For details of Bar Splicers, see sheet 30 of 33.
For details of piles and Concrete Encasement, see sheet 31 of 33.

WEST ABUTMENT
STRUCTURE NO. 032-0119

DESIGNED - JSI/MAJ/JFS
CHECKED - JFS/MJB
DRAWN - MLB/JLP
CHECKED - JFS/MJB

Note:
Bars indicated thus:
18 x 2-#6 etc. indicates
18 lines of bars with 2
lengths per line



Foth
Foth Infrastructure & Environment, LLC
7500 North Harker Drive
Peoria, IL 61615
Phone: 309-691-5300 Fax: 309-691-1892
Illinois Registration Number 184.004913

SHEET NO. 22 33 SHEETS	F.A.U. RTE.	SECTION	COUNTY	TOTAL SHEETS	SHEET NO.
	400	(32,47-4) HBR-2	GRUNDY	143	83
		S.N. 032-0119	CONTRACT NO. 66873		
FED. ROAD DIST. NO.		ILLINOIS FED. AID PROJECT			