

SOUTH EDGE OF SHOULDER

Location	Station	Offset		Theoretical Grade Elevations
E. End East Appr. Pav't	1035+32.69	18.00	Lt	692.60
A5	1035+42.69	18.00	Lt	692.71
A6	1035+52.69	18.00	Lt	692.83
W. End East Appr. Pav't	1035+62.69	18.00	Lt	692.93

SOUTH EDGE OF PAVEMENT

Location	Station	Offset		Theoretical Grade Elevations
E. End East Appr. Pav't	1035+27.35	12.00	Lt	692.66
A5	1035+37.35	12.00	Lt	692.78
A6	1035+47.35	12.00	Lt	692.89
W. End East Appr. Pav't	1035+57.35	12.00	Lt	693.00

℄ I-57, PGL & STAGE CONSTR. LINE

Location	Station	Offset		Theoretical Grade Elevations
E. End East Appr. Pav't	1035+16.68	0.00		692.72
A5	1035+26.68	0.00		692.84
A6	1035+36.68	0.00		692.96
W. End East Appr. Pav't	1035+46.68	0.00		693.07

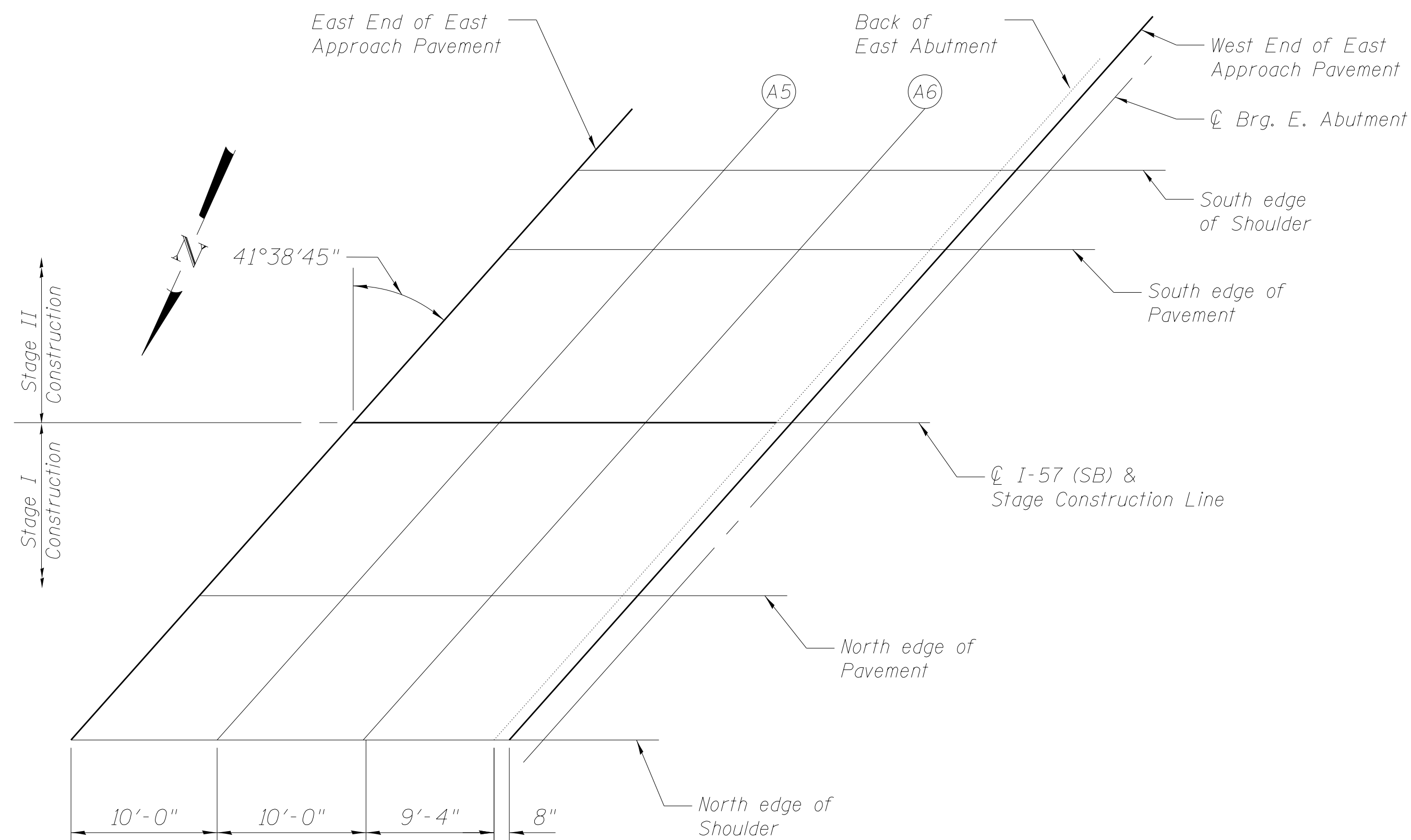

PLAN  
East Approach  
(SB Bridge)

NORTH EDGE OF PAVEMENT

Location	Station	Offset		Theoretical Grade Elevations
E. End East Appr. Pav't	1035+06.01	12.00	Rt	692.40
A5	1035+16.01	12.00	Rt	692.52
A6	1035+26.01	12.00	Rt	692.65
W. End East Appr. Pav't	1035+36.01	12.00	Rt	692.76

NORTH EDGE OF SHOULDER

Location	Station	Offset		Theoretical Grade Elevations
E. End East Appr. Pav't	1034+97.12	22.00	Rt	692.08
A5	1035+07.12	22.00	Rt	692.20
A6	1035+17.12	22.00	Rt	692.33
W. End East Appr. Pav't	1035+27.12	22.00	Rt	692.45

Note: Offsets are measured from Profile Grade Line, not from ℄ of I-57.

M:\157\_OVER\_CNRR & OLD\_45\Drawings\CADD Drawings\Structural\Final Plans\SHTS\0366942-018-T05-East appr-SB.dgn

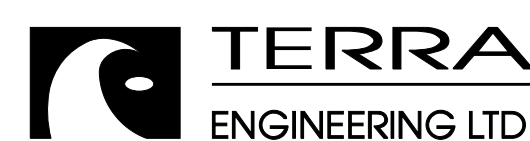

USER NAME =	DESIGNED - EA	REVISED
	CHECKED - OY	REVISED
PLOT SCALE =	DRAWN - CM	REVISED
PLOT DATE	CHECKED - JB	REVISED

**STATE OF ILLINOIS  
DEPARTMENT OF TRANSPORTATION**

**TOP OF EAST APPROACH SLAB ELEVATIONS (SB)  
STRUCTURE NOS. 038 - 0013 & 0014**

SHEET NO. S18 OF S71 SHEETS

F.A.I. RTE.	SECTION	COUNTY	TOTAL SHEETS	SHEET NO.
57	38-2HVB, HVBR-1	IROQUOIS	146	57
ILLINOIS FED. AID PROJECT			CONTRACT NO. 66942	