

PLAN
STAGE III TRAFFIC CONTROL

① DRUMS AT 25' CTS. TYPICAL

SYMBOLS

- ↑ ARROW BOARD
- DRUM
- ⊥ SIGN ON PORTABLE OR PERMANENT SUPPORT
- ▨ WORK AREA
- ⚡ TYPE III BARRICADE WITH FLASHING LIGHTS
- FLAGGER WITH TRAFFIC CONTROL SIGN
- ▩ TEMPORARY IMPACT ATTENUATORS

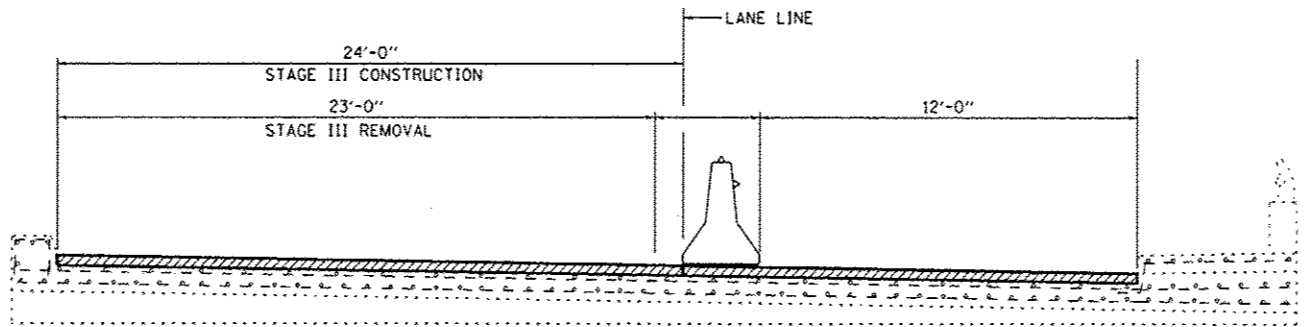

SECTION B-B

GENERAL NOTES

THIS STANDARD IS USED WHERE AT ANY TIME, DAY OR NIGHT, ANY VEHICLE, EQUIPMENT, WORKERS OR THEIR ACTIVITIES ENCOACH ON THE PAVEMENT REQUIRING THE CLOSURE OF ONE OR MORE TRAFFIC LANES IN AN URBAN AREA.

TRAFFIC CONTROL AND PROTECTION FOR STAGE I AND STAGE IV CONSTRUCTION OPERATIONS SHALL BE ACCORDING TO TRAFFIC CONTROL AND PROTECTION, STANDARD 701601 AND AS DIRECTED BY THE ENGINEER.

FILE NAME: c:\pwwork\pwwork\woodshank\1\d8322461\366C80-shd-details.dgn	USER NAME: woodshank1	DESIGNED - RW	REVISED -	STATE OF ILLINOIS DEPARTMENT OF TRANSPORTATION	TRAFFIC CONTROL AND PROTECTION STANDARD 701601 (SPECIAL)	F.A.P. R.I.E. 623	SECTION (HBR)I-2	COUNTY LASALLE	TOTAL SHEETS 11	SHEET NO. 7
PLOT SCALE: 1/80,000	CHECKED -	REVISED -	SCALE: SHEET NO. 1 OF 1 SHEETS			STA. TO STA.	ILLINOIS FED. AID PROJECT			
PLOT DATE: 4/8/2013	DATE -	REVISED -	CONTRACT NO. 66C80							