

I:\Terra_Bentley\Bentley\Standards\ILDOT\Std\Tables\penn\PLDTLABEL.tbl

ILDOT_PDFNLAVERS.BWp1.ctb

T:\Projects\10-221\DOT\TazBridges-Ten Mile Creek-Phase II\Drawings\CADD Sheets\0468671-plt\pmb.dgn

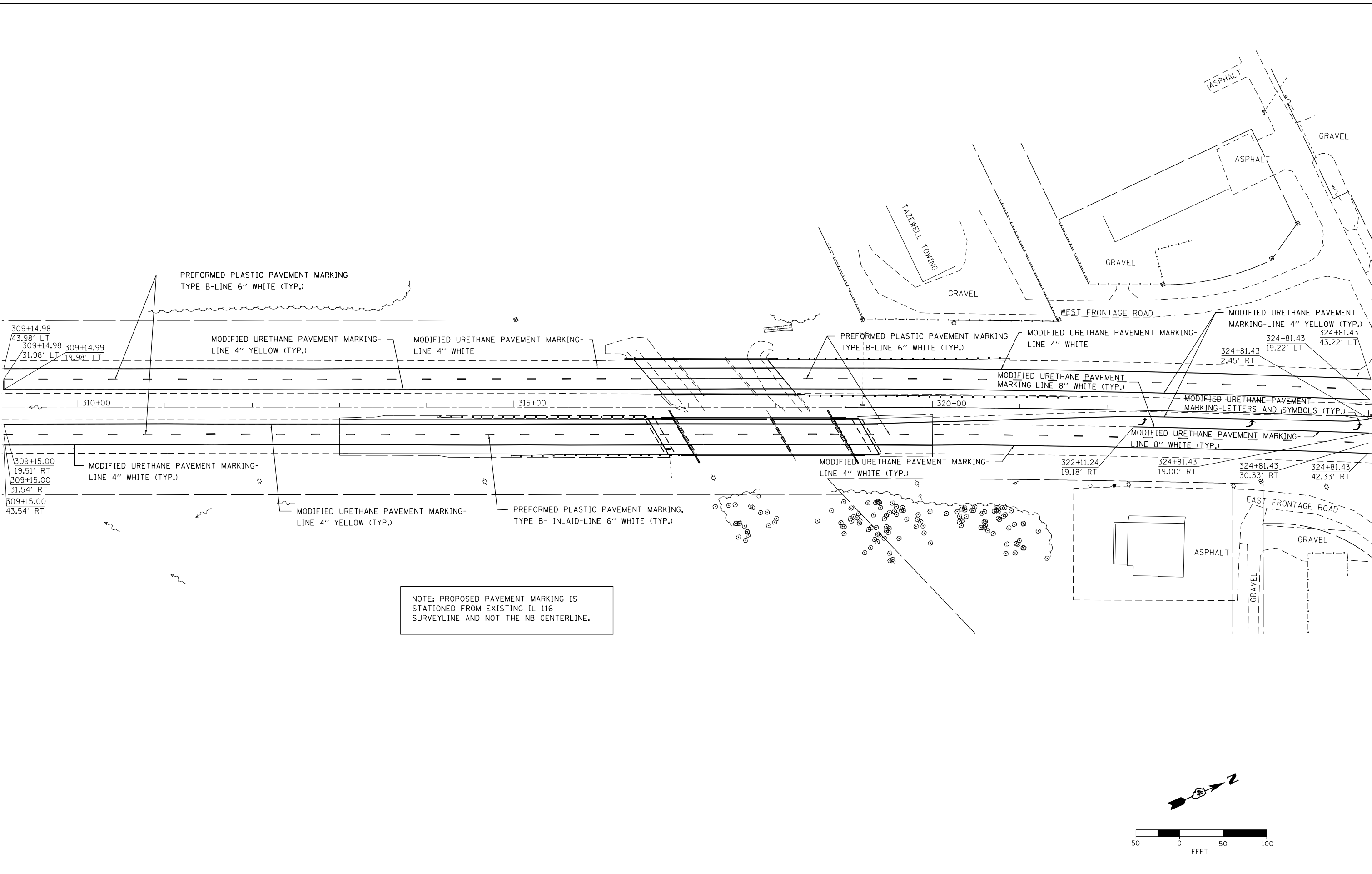

NOTE: PROPOSED PAVEMENT MARKING IS STATIONED FROM EXISTING IL 116 SURVEYLINE AND NOT THE NB CENTERLINE.



USER NAME = WAH	DESIGNED - CL	REVISED -
DRAWN - WAH	REVISIONS -	
PLLOT SCALE = 100.0000' / in.	CHECKED - KJC/HTL	REVISED -
PLLOT DATE = 12/13/2012	DATE - 10/04/12	REVISED -

STATE OF ILLINOIS
DEPARTMENT OF TRANSPORTATION

PAVEMENT MARKING PLANS
IL 116 OVER TEN MILE CREEK

SCALE: 1" = 50' SHEET NO. 1 OF 1 SHEETS STA. 309+00 TO STA. 325+00

F.A.P. RTE.	SECTION	COUNTY	TOTAL SHEETS	SHEET NO.
673	(102B-1)BR	TAZEWELL	89	43
CONTRACT NO. 68671				
ILLINOIS FED. AID PROJECT				