

EXIST. CURVE CURV91
 PI STA. = 105+36.76
 $\Delta = 85^\circ 51' 34''$ (LT)
 $D = 3^\circ 07' 31''$
 $R = 1,833.37'$
 $T = 1,705.45'$
 $L = 2,747.37'$
 $E = 670.59'$
 $e = \text{-----}$
 $T.R. = \text{-----}$
 $S.E. \text{ RUN} = \text{-----}$
 $P.C. \text{ STA.} = 88+31.31$
 $P.T. \text{ STA.} = 115+78.68$

LEGEND

- CLASS B PATCH, TYPE IV, 10 3/4" WITH HMA OVERLAY
- PORTLAND CEMENT CONCRETE SHOULDERS 8"
- VARIABLE DEPTH PATCH, TYPE IV, 10 3/4" TO 12 3/4"
- PORTLAND CEMENT CONCRETE SHOULDERS 10 3/4"
- CLASS B PATCH, TYPE IV, 10 3/4"
- PORTLAND CEMENT CONCRETE SHOULDERS 12"
- PERIMETER EROSION BARRIER

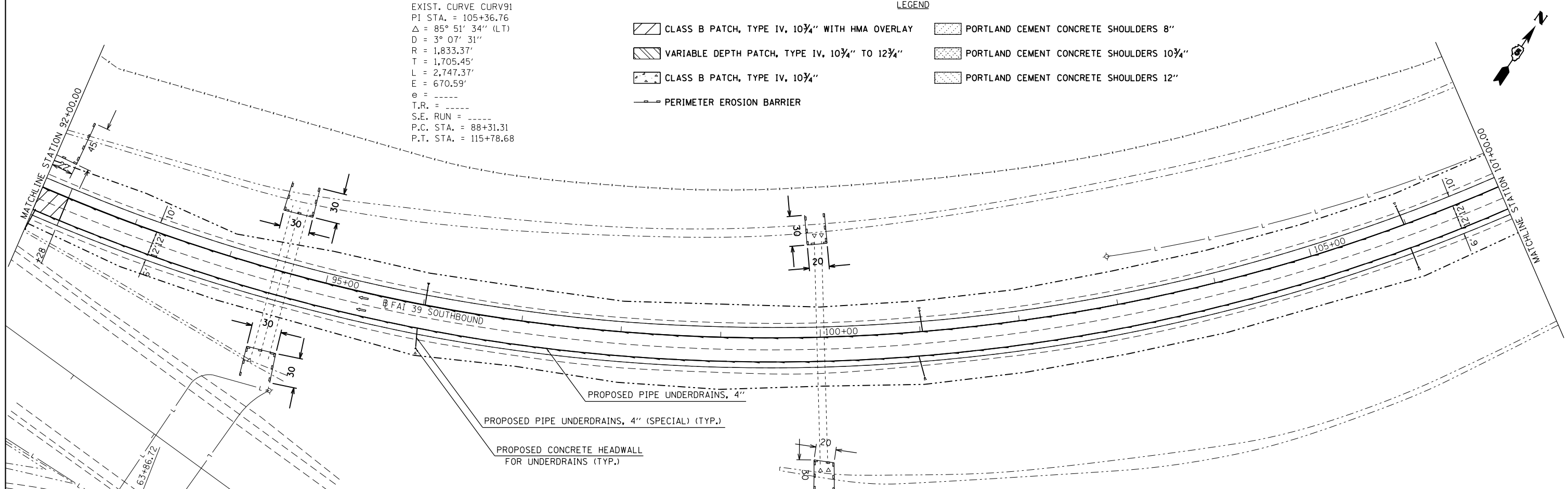

FILE NAME =	USER NAME = hoganbj	DESIGNED -	REVISED - BJH 03/07/2013
es:\pwork\pwork\hoganbj\d0339150\0570634-shd-dblpln.dgn		DRAWN -	REVISED -
PLOT SCALE = 100.0000' / in.		CHECKED -	REVISED -
PLOT DATE = 3/13/2013		DATE -	REVISED -

STATE OF ILLINOIS
 DEPARTMENT OF TRANSPORTATION

SOUTH BOUND RAMP
 PLAN SHEET

SCALE: SHEET 1 OF 3 SHEETS STA. 77+00 TO STA. 107+00

F.A.I. RTE.	SECTION	COUNTY	TOTAL SHEETS	SHEET NO.
39	57(2,3)RS(SB)	McLean	140	30
CONTRACT NO. 70634				
ILLINOIS FED. AID PROJECT				