

STATE OF ILLINOIS
DEPARTMENT OF TRANSPORTATION
DIVISION OF HIGHWAYS

**PROPOSED
HIGHWAY PLANS**

FAS ROUTE 522 (SIDNEY-LONGVIEW RD.)
SECTION (41,41-15D)Q
PROJECT F-0522(119)
SEAL COAT
CHAMPAIGN COUNTY

C-95-001-13

BLOCK RD. TO BROADLANDS RD.

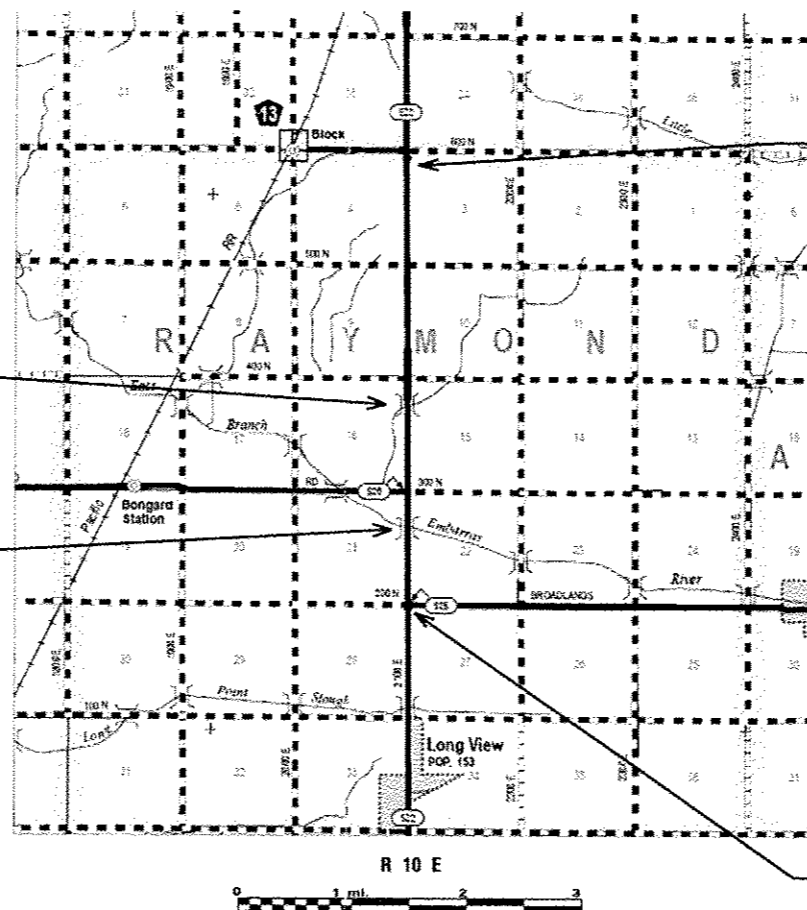

PROJECT BEGINS, STA. 217 + 49

PROJECT ENDS, STA. 425 + 66.3

FOR INDEX OF SHEETS, SEE SHEET NO. 2
FOR SUMMARY OF QUANTITIES, SEE SHEET NO. 4

DESIGN DESIGNATION:
MAJOR COLLECTOR

CURRENT ADT: (2012)
750

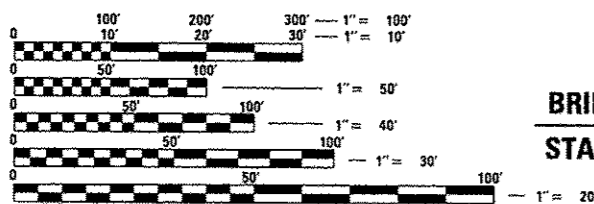

FULL SIZE PLANS HAVE BEEN PREPARED USING STANDARD ENGINEERING SCALES. REDUCED SIZED PLANS WILL NOT CONFORM TO STANDARD SCALES. IN MAKING MEASUREMENTS ON REDUCED PLANS, THE ABOVE SCALES MAY BE USED.

J.U.L.I.E.
JOINT UTILITY LOCATION INFORMATION FOR EXCAVATION
1-800-892-0123
OR 811 RAYMOND TOWNSHIP

PROJECT ENGINEER: JASON STULTS (217-465-4181)
PROJECT MANAGER: RUSTIN KEYS
DESIGNER : KARY DAWSON
CONTRACT NO. 70A09

GROSS LENGTH = 20,817.30 FT. = 3.943 MILE
NET LENGTH = 20,698.80 FT. = 3.920 MILE

F.A.S. RTE.	SECTION	COUNTY	TOTAL SHEETS	SHEET NO.
522	(41,41-15D)Q	Champaign	15	1
		ILLINOIS	CONTRACT NO. 70A09	

D-95-001-13



STATE OF ILLINOIS
DEPARTMENT OF TRANSPORTATION
DIVISION OF HIGHWAYS

SUBMITTED January 30 20 13

DEPUTY DIRECTOR OF HIGHWAYS, REGION ENGINEER *[Signature]*

May 10 20 13
John D. Baranzelli, P.E.
ENGINEER OF DESIGN AND ENVIRONMENT

May 10 20 13
Omer Osman, P.E.
DIRECTOR OF HIGHWAYS, CHIEF ENGINEER

PRINTED BY THE AUTHORITY
OF THE STATE OF ILLINOIS