

Existing Structure: SN 054-0062. The existing structure is a curved, 6-span vaulted structure consisting of four continuous steel spans and two PPC I-beam approach spans with a 7/2" reinforced concrete deck. The original structure was built in 1974 as Section 54-5HVB. The original neoprene expansion joints were removed and replaced with a silicone joint sealer in 1999. The abutment joint seals will be replaced utilizing short-term lane closure on T.R. 65A.

No Salvage

GENERAL NOTES

Plan dimensions and details relative to existing plans are subject to nominal construction variations. The Contractor shall field verify existing dimensions and details affecting new construction and make necessary approved adjustments prior to construction or ordering of materials. Such variations shall not be cause for additional compensation for a change in scope of the work, however, the Contractor will be paid for the quantity actually furnished at the unit price bid for the work.

SCOPE OF WORK

1. Remove existing silicone joint sealer.
2. Install new silicone joint sealer at the east and west abutments.

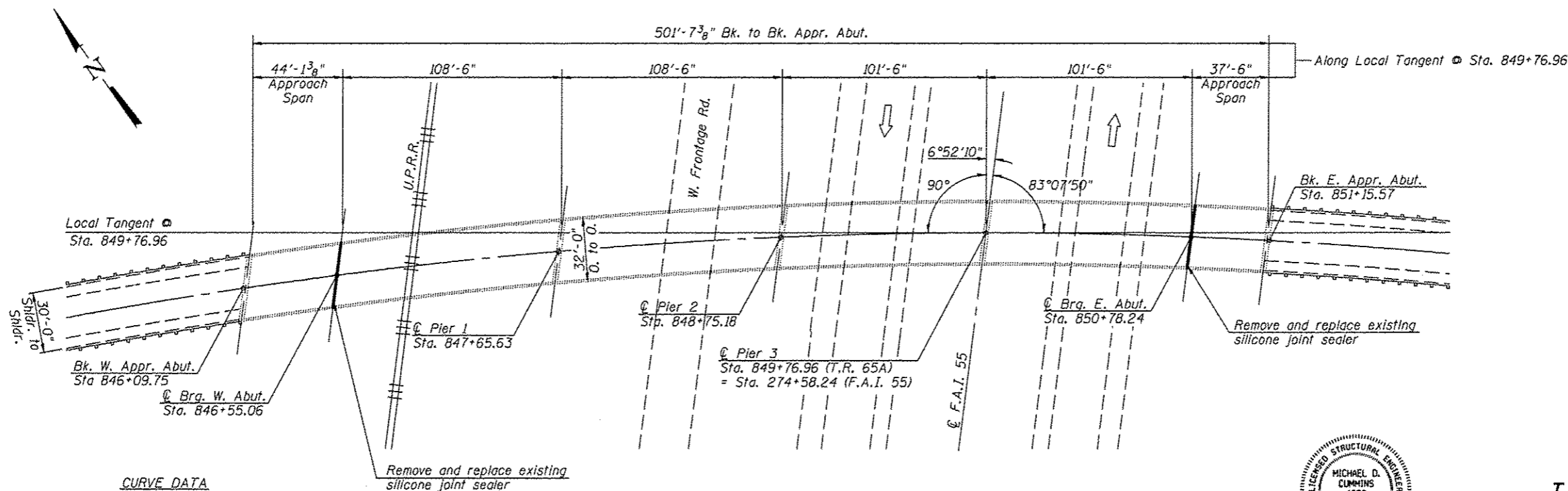
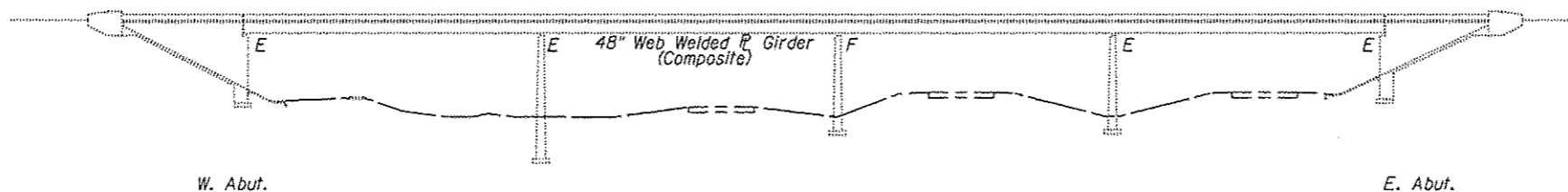

CURVE DATA
 P.I. Sta. 849+31.26
 $\Delta = 25^\circ 00' 02''$
 $D = 2^\circ 18' 10''$
 $R = 2487.87'$
 $T = 551.26'$
 $L = 1085.56'$
 $E = 60.41'$
 $S.E. = 4.2\%$

PLAN

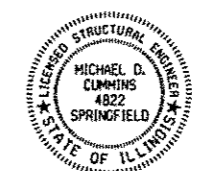
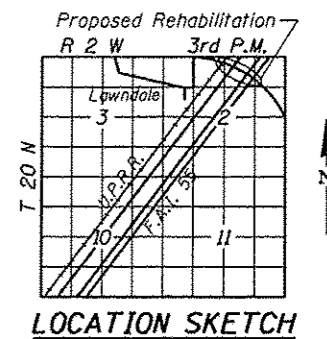

Michael D. Cummins 3/14/13
 (Expires 11/30/14)

GENERAL PLAN
T.R. 65A OVER I-55, WEST
FRONTAGE ROAD AND U.P.R.R.
SECTION D6 LOGAN CO BR 2011-1
LOGAN COUNTY
STATION 274+58.24
STRUCTURE NO. 054-0062



JOB	• 2236.10	DESIGNED	- AAM	REVISED	-
FILE	• 0548062-72E11-B01-GPE.dgn	CHECKED	- ENV	REVISED	-
DATE	• 2/12/2013	DRAWN	- SJS	REVISED	-
		CHECKED	- MDC	REVISED	-

STATE OF ILLINOIS
DEPARTMENT OF TRANSPORTATION

GENERAL PLAN
STRUCTURE NO. 054-0062

SHEET NO. OF SHEETS

F.A.I. RTE.	SECTION	COUNTY	TOTAL SHEETS	SHEET NO.
55	D6 LOGAN CO BR 2011-1	LOGAN	429	284
CONTRACT NO. 72E11			ILLINOIS FED. AID PROJECT	